

Table 1.—CHARACTERISTICS OF HOUSING FOR THE CITY: 1950

Subject	Number	Percent	Subject	Number	Percent
<b>OCCUPANCY AND TENURE</b>			<b>PERSONS PER ROOM</b>		
All dwelling units.....	111,169	100.0	Occupied dwelling units.....	108,825	...
Owner occupied.....	51,971	46.7	Number reporting.....	107,631	100.0
Renter occupied.....	56,854	51.1	1.50 or less.....	97,859	90.9
Vacant nonseasonal not dilapidated, for rent or sale.....	1,245	1.1	1.51 or more.....	9,772	9.1
Other vacant and nonresident.....	1,099	1.0	Not reported.....	1,194	...
<b>CONDITION AND PLUMBING FACILITIES</b>			<b>CONTRACT MONTHLY RENT</b>		
All dwelling units.....	111,169	...	Renter-occupied, and vacant nonseasonal not dilapidated units, for rent—Number reporting.....	54,480	...
Number reporting.....	108,092	100.0	Total contract monthly rent..... dollars.....	1,981,331	...
With private bath, not dilapidated.....	74,463	68.9	Average monthly rent..... dollars.....	36.37	...
No private bath, with running water, not dilapidated.....	22,195	20.5	<b>VALUE OF ONE-DWELLING-UNIT STRUCTURES</b>		
No running water or dilapidated.....	11,434	10.6	Owner-occupied, <sup>1</sup> and vacant nonseasonal not dilapidated units, for sale only—Number reporting.....	40,155	...
Condition or plumbing facilities not reported.....	3,077	...	Total value or sale price..... dollars.....	308,413,700	...
No private bath or dilapidated.....	33,629	31.1	Average value..... dollars.....	7,681	...
<b>COLOR OF OCCUPANTS</b>					
Occupied dwelling units.....	108,825	100.0			
White.....	91,933	84.5			
Nonwhite.....	16,892	15.5			

<sup>1</sup>Restricted to 1-dwelling-unit properties.

Table 2.—CHARACTERISTICS OF HOUSING BY CENSUS TRACTS: 1950

Census tract	All dwelling units by occupancy and tenure					All dwelling units by condition and plumbing facilities			Occupied dwelling units			Contract monthly rent <sup>1</sup>		Value <sup>2</sup> of one-dwelling-unit structures		
	Total	Owner occupied	Renter occupied	Vacant nonseasonal not dilap., for rent or sale	Other vacant and nonresident	Number reporting	No private bath or dilap.	No running water or dilap.	Total	Persons per room	Occupied by non-white	Number reporting	Average monthly rent (dollars)	Number reporting	Average value (dollars)	
<b>TOTAL</b>	111169	51971	56854	1245	1099	108092	33629	11434	108825	107631	9772	16892	54480	3637	40155	7681
1	521	322	196	1	2	513	113	43	518	518	45	9	175	31.3	255	5.972
2	1234	589	605	23	17	1211	493	152	1194	1186	133	42	563	26.93	396	4.121
3	772	589	165	12	6	767	92	24	754	744	25	1	157	38.59	507	7.152
4	1513	1193	284	21	15	1500	102	4	1477	1471	19	1	277	45.07	1061	8.629
5	818	482	318	11	7	814	236	74	800	797	82	1	306	30.05	387	4.874
6	1478	848	620	5	5	1460	333	90	1468	1462	79	210	577	32.92	687	6.235
7	1433	933	485	9	3	1420	115	13	1418	1408	32		463	44.42	748	7.709
8	956	716	229	8	6	948	73	4	945	936	9		215	51.31	571	9.248
9	1035	610	404	15	8	1014	83	5	1014	1008	7	4	385	55.88	462	9.303
10	1904	1196	684	16	6	1880	306	24	1880	1863	83	439	655	38.18	956	6.319
11	1578	1148	396	14	20	1570	118	17	1544	1535	26	61	362	49.70	994	9.132
12	632	467	105	51	9	625	52	8	572	565	9	56	97	45.85	413	7.380
13	801	485	296	8	12	785	444	259	781	775	112	731	266	23.00	437	3.651
14	395	254	133	2	6	388	275	189	387	384	61	315	128	21.86	241	3.431
15	1707	1004	599	98	6	1656	328	11	1603	1590	85	49	571	42.07	793	7.479
16	1827	1257	555	11	4	1802	207	12	1812	1801	105	14	519	38.09	1037	7.233
17	1234	800	418	13	3	1219	164	6	1218	1210	26	6	400	39.17	646	7.150
18	1246	721	506	14	5	1235	382	69	1227	1214	79	33	489	33.68	539	5.615
19	1257	547	693	7	10	1208	559	180	1240	1230	155	907	658	26.46	368	4.885
20	1574	657	871	19	27	1523	640	110	1528	1513	150	753	822	28.72	441	4.892
21	1755	809	931	6	9	1744	659	163	1740	1736	187	29	859	27.69	576	4.476
22	1399	685	701	3	10	1359	711	314	1386	1361	292	66	654	24.77	523	3.473
23	2192	973	1186	12	21	2132	933	253	2159	2136	341	4	1116	26.02	688	3.830
24	1409	507	880	4	18	1311	708	248	1387	1371	191	11	833	24.28	338	4.247
25	1411	301	1091	7	12	1315	938	543	1392	1344	233	55	1053	20.85	171	4.077
26	1248	562	665	12	9	1206	568	107	1227	1200	183	337	645	29.77	408	4.100
27	1953	1018	912	10	13	1872	794	425	1930	1913	236	119	861	24.75	774	4.564
28	1056	559	489	2	6	1050	74	10	1048	1042	46	55	464	26.90	477	6.682
29	783	45	727	13	8	743	571	216	772	757	222	190	715	24.46	14	5.014
30	2156	174	1945	17	20	2071	1124	641	2119	2081	328	40	1917	21.05	82	3.581
31	861	51	771	21	18	803	499	373	822	810	154	736	768	23.69	16	4.512
32	714	119	579	2	14	671	466	342	698	691	134	535	561	21.92	72	3.527
33	978	320	645	2	7	941	698	298	965	963	196	66	624	18.24	230	3.404
34	822	256	554	3	9	798	511	284	810	801	142	29	533	24.46	181	3.277
35	861	215	643	2	1	852	221	60	858	855	120	31	627	29.78	165	3.558
36	2118	1571	500	41	6	2092	297	36	2071	2063	283	96	468	43.77	1365	7.008
37	1218	580	617	7	14	1203	408	113	1197	1195	114	152	591	37.60	420	5.496
38	1648	999	634	9	7	1623	262	45	1633	1626	101	52	608	38.33	847	6.731
39	1365	1028	324	6	6	1348	233	24	1352	1340	54	4	299	41.23	893	6.914
40	896	589	297	4	6	881	163	9	886	877	36	1	284	41.65	466	7.056
41	1314	682	615	3	14	1302	232	33	1297	1285	36	3	591	44.40	403	7.421
42	630	312	310	4	4	626	95	31	622	620	32	2	304	55.67	275	6.581
43	731	545	164	13	9	721	252	36	709	709	55	5	155	40.84	489	5.723
44	1540	1116	406	9	9	1527	93	7	1522	1510	13	4	322	61.40	944	9.746
45	669	475	176	8	10	606	161	60	651	649	49	30	148	36.91	396	5.916
46	1376	1028	319	9	20	1358	90	16	1347	1341	16		297	52.40	908	9.735
47	333	25	298	2	8	312	214	159	323	313	51	15	288	30.01	3	1
48	397	33	343	1	21	347	297	191	376	371	101	15	304	28.77	33	4.200
49	920	57	839	6	18	848	483	183	896	868	180	0	312	33.82	3	35000
50	2339	175	2060	59	45	2183	137	23	2235	2193	442	300	605	40.65	35	7908

<sup>1</sup>For renter-occupied dwelling units and vacant nonseasonal not dilapidated units, for rent.

<sup>2</sup>For owner-occupied dwelling units and vacant nonseasonal not dilapidated units, for sale only.

## HOUSING—BLOCK STATISTICS

Table 2.—CHARACTERISTICS OF HOUSING BY CENSUS TRACTS: 1950—Con.

Census tract	All dwelling units by occupancy and tenure					All dwelling units by condition and plumbing facilities			Occupied dwelling units				Contract monthly rent <sup>1</sup>		Value <sup>2</sup> of one-dwelling-unit structures	
	Total	Owner occupied	Renter occupied	Vacant non-seasonal not dilap., for rent or sale	Other vacant and non-resident	Number reporting	No. private bath or dilap.	No running water or dilap.	Total	Persons per room		Occupied by non-white	Number reporting	Average monthly rent (dollars)	Number reporting	Average value (dollars)
										Number reporting	1.51 or more					
51	2547	321	2130	54	42	2473	952	167	2451	2391	249	112	2096	51.05	90	9374
52	2300	383	1803	76	38	2222	614	48	2186	2147	103	40	1776	53.57	113	13106
53	1297	289	961	26	21	1261	469	76	1250	1236	75	26	950	45.05	123	5191
54	240	128	107	2	3	238	165	123	235	234	42		97	29.80	101	3330
55	1576	874	685	7	10	1550	684	202	1559	1549	201	163	615	29.48	671	4363
56	1513	618	843	21	31	1475	194	46	1461	1446	59		815	62.55	526	6905
57	1547	256	1243	19	29	1525	1161	603	1499	1495	388	73	1221	21.66	121	3442
58	881	63	783	12	23	829	555	126	846	835	177	168	772	30.04	10	5750
59	2284	276	1963	17	28	2215	1021	440	2239	2224	409	567	1928	25.02	89	3997
60	1133	352	750	15	16	1112	750	395	1102	1092	196	190	721	19.56	239	3441
61	1407	155	1128	96	28	1363	924	159	1283	1263	322	161	1168	34.60	54	6805
62	1883	500	1357	7	19	1680	853	357	1857	1830	295	1536	1311	22.99	361	12290
63	1835	970	843	10	12	1792	599	99	1813	1789	180	33	809	27.18	730	4776
64	1241	555	678	2	6	1230	408	201	1233	1227	48	22	649	37.70	340	6739
65	1096	538	543	7	8	1078	445	217	1081	1073	90	89	509	30.44	388	6005
66	2338	627	1635	43	33	2304	1045	274	2262	2242	193	132	1610	39.08	288	6867
67	852	462	381	1	8	832	303	91	843	834	98	349	353	25.64	363	4750
68	1186	767	411	4	4	1178	282	22	1178	1171	77	27	389	27.39	632	6017
69	1091	728	350	7	6	1080	161	9	1078	1071	49	3	338	32.57	628	6407
70	1223	972	241	2	8	1208	87	8	1213	1210	29		228	42.05	878	8923
71	1516	949	546	13	8	1484	228	43	1495	1482	64	10	505	38.47	804	6606
72	839	325	500	4	10	814	384	158	825	815	92	237	478	29.99	224	4970
73	589	178	392	1	18	572	451	356	570	567	140	7	344	23.20	96	3385
74	446	150	289	2	5	371	239	102	439	437	94	13	270	17.90	84	3413
75	1051	565	477	3	6	973	198	39	1042	1010	55	23	426	36.04	363	6790
76	896	570	303	13	10	879	86	26	873	861	13	55	281	60.11	476	11454
77	520	393	116	2	9	513	10	2	509	503	4	2	101	57.84	344	14848
78	486	392	89	1	4	477	16		481	474	2		78	45.41	345	11181
79	947	515	412	12	8	937	97	8	927	918	9	3	389	47.68	368	9692
80	455	273	180	1	1	425	84	22	453	448	23	32	152	30.88	224	5662
81	1602	836	748	9	9	1547	552	205	1584	1544	115	45	692	28.06	628	4908
82	2074	806	1218	28	22	2012	1052	29	2024	1975	18	43	1143	70.07	498	13546
83	1153	686	445	13	9	1133	41	5	1131	1117	9		435	59.25	554	14698
84	1475	943	515	10	7	1433	61	4	1458	1446	13		487	51.09	792	9766
85	965	484	457	9	15	921	21	1	941	916	5	5	422	75.63	351	15922
86	215	185	25	1	4	211	37	1	210	206	2	4	14	79.42	131	20587
87	1074	403	663	5	3	1049	2	1	1066	1051	24	1	652	35.62	378	23386
88	1295	795	489	7	4	1271	10	4	1284	1269	3	5	457	70.41	702	17613
89	1413	1136	257	7	13	1386	38	6	1393	1375	4	20	219	56.31	1012	13206
90	1671	926	715	18	12	1656	52	9	1641	1627	21		701	70.89	854	8584

<sup>1</sup>For renter - occupied dwelling units and vacant nonseasonal not dilapidated units, for rent.<sup>2</sup>For owner - occupied dwelling units and vacant nonseasonal not dilapidated units, for sale only.

Table 3.—CHARACTERISTICS OF HOUSING FOR CENSUS TRACTS, BY BLOCKS: 1950

[Detailed statistics not shown for blocks containing fewer than 3 dwelling units, nor for dwelling units not allocated by blocks (designated by NR)]

Census tract	Block	All dwelling units by occupancy and tenure					All dwelling units by condition and plumbing facilities			Occupied dwelling units			Contract monthly rent <sup>1</sup>		Value <sup>2</sup> of one-dwelling-unit structures		
		Total	Owner occupied	Renter occupied	Vacant non-seasonal not dilap., for rent or sale	Other vacant and non-resident	Number reporting	No private bath or dilap.	No running water or dilap.	Total	Persons per room		Occupied by non-white	Number reporting	Average monthly rent (dollars)	Number reporting	Average value (dollars)
											Number reporting	1.51 or more					
1	1	55	30	25		54	21	14	55	55	14		23	220.4	20	4,420	
	2	30	16	14		30	3	2	30	30	5		11	317.2	13	7,176	
	3	31	18	13		26	5	3	31	31	1	2	12	374.1	14	6,571	
	4	51	24	26		51	4	1	50	50	1		24	368.3	19	9,815	
	5	29	22	7		29	6	1	29	29	1		6	265.0	20	4,480	
	6	41	24	17		41	15	3	41	41	1	4	16	235.0	17	4,505	
	7	10	6	3		9	5		9	9	3		3	226.6	4	6,450	
	8	13	10	3		13			13	13			3	550.0	9	9,277	
	9	17	8	9		17	8	5	17	17			9	253.3	5	5,900	
	10	13	8	5		13	3		13	13	2		4	260.0	6	5,750	
	11	14	12	2		14			14	14			1		11	6,045	
	12	6	3	3		6			6	6	1		3	533.3	3	6,666	
	13	25	10	15		25			25	25	1		13	386.1	7	6,714	
	14	72	43	29		72	24	11	72	72	11	2	26	298.8	33	31,339	
	15	29	15	13	1	28	9	1	28	28	1		12	338.3	9	4,722	
	16	40	34	6		40	10	2	40	40	4		4	375.0	29	61,79	
	17	21	16	5		21			21	21			4	267.5	14	6,642	
	18	24	23	1		24			24	24			1		22	7,800	
	5	9	4	5		9	4		9	9			4	242.5	3	4,166	
	6	68	45	19	1	67	46	33	64	64	22		19	197.8	25	3,120	
	7	45	24	19	1	43	16		43	42	4		20	276.5	15	4,113	
	8	18	8	8	2	18	8	2	16	16			10	339.0	3	5,833	
	10	36	16	18		34	12		34	34	4		18	260.0	12	3,600	
	11	24	13	10		24	13	3	23	23	2		9	363.3	8	5,250	
	12	27	21	6		27	11	1	27	27	2		5	302.0	17	3,564	
	13	23	17	5		23	3		22	22	3		5	252.0	17	4,229	
	14	26	8	15	1	26	16	2	23	23	3		16	267.5	2		
	15	26	7	18	1	26	14	4	25	25	2		15	243.3	3	5,466	
	16	18	13	5		18	5		18	18			3	183.3	11	4,581	
	17	41	22	19		40	20	1	41	41	3		16	243.7	16	3,893	
	19	47	29	15	2	47	9	4	44	44	4		13	276.9	27	4,759	
	20	22	14	7	1	22	8	1	21	21	1		6	320.0	12	4,450	
	21	2															
	22	10	2	8		10	2		10	10			6	236.6	2		
	23	33	8	21	4	31	14	2	29	29	3		21	244.7	5	4,800	
	24	16	8	8		16	7		16	16	2		8	142.5	6	3,566	
	25	25	12	12		24	15		24	24	1		10	172.0	9	3,377	
	26	17	11	6	1	17	3		17	17			6	331.6	6	3,483	
	27	38	17	21		37	18	1	38	37	6		17	234.7	5	5,400	
	28	13	7	6		13	8		13	13	3		6	253.3	5	2,700	
	29	32	15	17		31	11	7	32	31	6		16	223.1	12	4,075	
	30	19	9	10		19	6	3	19	19	1		9	373.3	4	4,750	
	31	14	6	7		14	4	2	13	13			5	210.0	4	3,250	
	32	17	8	9		17	7	1	17	17	2		4	182.5	7	4,714	
	33	12	5	6	1	12	5		11	11			7	232.8	3	4,500	
	34	33	8	23	1	31	14	11	31	31	7		23	199.5	4	4,550	
	35	27	20	7	1	25	10		27	26	2		7	291.4	16	3,581	
	36	23	14	9		23	8		23	23			9	266.6	9	5,422	
	37	102	42	54	5	99	40	9	96	96	10	8	54	325.3	23	4,478	
	38	92	31	61		91	42	22	92	92	13	13	59	236.7	17	3,729	
	39	49	32	17		49	14	10	49	48	1		15	300.0	28	3,592	
	40	52	19	32		52	22	14	51	51	10	4	31	332.2	16	3,831	
	41	102	48	51	2	99	31	7	99	99	5		48	307.9	28	4,189	
	42	76	25	50	1	75	27	11	75	72	10		43	278.1	15	4,686	
	1	17	12	5		17	2	2	17	17	1		5	428.0	11	4,845	
	2	2															
	3	43	25	15	2	43	8	4	40	40	4		14	450.7	19	5,710	
	4	109	87	20	1	109	25	14	107	105	8		19	290.5	83	6,202	
	5	39	33	5	1	39			38	38	2		5	266.0	31	6,809	
	6	21	16	5		21	21		21	21			5	364.0	15	6,640	
	7	35	25	6	4	35			31	31	2		6	428.3	22	5,977	
	8	25	23	1		25			24	24			1		22	6,845	
	9	33	22	9	2	32	8		31	30			11	509.0	13	7,707	
	10	23	18	5		23	2		23	23	1		4	425.0	13	7,884	
	11	24	21	3		24			24	23	1		3	336.6	19	7,115	
	12	28	25	2		27	1		27	27			2		23	7,486	
	13	23	19	4		23	4		23	23	1		4	317.5	18	8,733	
	14	78	66	12		76	5		78	77	1		10	367.0	57	8,522	
	15	42	31	10	1	42	2		41	41		1	9	392.2	27	8,751	
	16	31	19	11		30	6		30	30			11	383.6	16	8,656	
	17	32	24	8	1	32	7		32	31	2		3	400.0	19	6,563	
	18	23	18	5		23	2		23	22			2	323.3	16	7,431	
	19	15	13	2		15	1		15	15			3		11	6,363	
	20	28	22	6		28	5		28	28	1		5	350.0	18	6,111	
	21	52	36	15		52	10	2	51	50			14	395.0	26	7,065	
	22	49	34	14	1	49	2		48	46			14	452.8	28	7,921	
	1	71	50	21		69	4	1	71	70	1		20	521.0	38	11,610	
	2	18	14	3		18	3	2	17	17			2		10	8,550	
	3	56	45	9		56	5		54	54	2		8	335.0	42	7,223	
	4														4	11,250	

<sup>1</sup>For renter - occupied dwelling units and vacant nonseasonal not dilapidated units, for rent.  
<sup>2</sup>For owner - occupied dwelling units and vacant nonseasonal not dilapidated units, for sale only.

## HOUSING—BLOCK STATISTICS

Table 3.—CHARACTERISTICS OF HOUSING FOR CENSUS TRACTS, BY BLOCKS: 1950—Con.

Census tract	Block	All dwelling units by occupancy and tenure					All dwelling units by condition and plumbing facilities			Occupied dwelling units			Contract monthly rent <sup>1</sup>		Value <sup>2</sup> of one-dwelling-unit structures	
		Total	Owner occupied	Renter occupied	Vacant non-seasonal not dilap., for rent or sale	Other vacant and non-resident	Number reporting	No private bath or dilap.	No running water or dilap.	Total	Persons per room		Number reporting	Average monthly rent (dollars)	Number reporting	Average value (dollars)
											Number reporting	1.51 or more				
4	5	21	16	2		3	20		18	18		2		15	9,760	
	6	21	13	8			21		21	21		8		12	8,250	
	7	44	37	7			44	6	44	44	1	6	3,537	34	11,338	
	8	22	19	3			22		22	22		3	5,233	19	12,263	
	9	4	3				4		4	4		1	5,640	3	14,166	
	10	16	16	1			16		16	16		1		16	12,812	
	11	19	19				19		19	19				19	12,894	
	12	21	20	1			21		21	21		1		20	10,650	
	13	134	110	21	1	2	134	2	131	130	2	22	370.9	102	8,090	
	14	3	3				3		3	3				3	11,000	
	15	36	25	9	1	1	35	1	34	34		9	463.3	21	7,500	
	16	41	36	2	3		41		38	38	1	2		34	8,658	
	17	13	8	5			13		13	13		5	5,680	8	16,425	
	18	16	8	4	4		15	4	12	12	1	4	42.50	6	6,366	
	19	24	20	3		1	24	1	23	23	2	3	30.66	19	7,905	
	20	24	22	2			24		24	24		2		22	9,022	
	21	16	16				16		16	16				16	8,768	
	22	23	18	2	3		22	2	20	20		2		16	9,150	
	23	36	28	6	2		35	7	34	34		7	46.42	27	8,529	
	24	37	28	6	3		37	8	34	34	1	5	44.00	23	7,204	
	25	21	18	3			21		21	21		3	26.66	18	8,144	
	26	20	19	1			20		20	20		1		17	7,905	
	27	22	19	3			22	3	22	22		3	33.33	17	7,294	
	28	37	28	9			36	4	37	37	1	9	45.55	22	7,386	
	29	39	37	2			39		39	39		2		36	7,286	
	30	43	30	13			43	9	43	42	1	11	48.45	18	7,483	
	31	33	25	8			32	6	33	33		8	43.62	19	8,200	
	32	35	27	8			35	5	35	34		8	37.00	24	7,254	
	33	37	34	1		2	37	2	35	35		1		31	8,100	
	34	36	21	13	2		36		34	34	1	15	54.80	17	8,647	
	35	30	22	8			30	2	30	30		8	46.25	20	6,275	
	36	30	30				35	2	35	35		4	55.00	26	9,703	
	37	43	28	15			43	3	43	43	2	15	46.13	21	6,195	
	38	37	32	5			37	2	37	37		5	47.20	29	7,320	
	39	32	21	11			32	4	32	32		11	53.81	19	7,136	
	40	84	61	22		1	84	5	83	83		21	49.42	53	8,711	
	41	23	23				23	2	23	23	1			21	8,623	
	42	59	41	17	1		59	5	58	58		17	31.82	37	7,637	
	43	116	91	22	1	2	114	9	113	113		21	48.57	81	8,076	
	44	11	8	3			9	1	11	9		2		6	9,666	
5	1	49	33	15		1	48	10	48	48		14	23.28	29	4,475	
	2	17	10	7			17	7	17	17	1	6	43.16	7	4,257	
	3	277	162	109	4	2	277	106	271	271	40	106	32.02	118	5,061	
	4	22	14	6	1		22	9	20	20		7	16.00	13	4,684	
	5	19	7	7	4	1	19	4	14	14	2	7	33.85	4	5,050	
	6	31	23	8			30	7	31	31	5	8	24.62	22	4,090	
	7	47	27	20			46	12	47	47	2	20	31.20	23	4,600	
	8	47	23	22	1	1	47	20	45	45	2	20	19.20	21	3,971	
	9	56	27	29			56	16	56	55	6	28	22.00	19	4,989	
	10	35	26	9			35	5	35	34	2	8	26.87	22	4,545	
	11	8	5	2	1		8	2	7	7	1	3	52.66	4	4,450	
	12	21	14	7			21	6	21	21		7	36.71	12	4,466	
	13	17	11	6			17	3	17	17	2	5	27.20	10	4,850	
	14	22	8	14			22	8	22	22	4	14	26.42	6	6,750	
	15	22	12	10			22	5	22	22		10	42.20	9	5,166	
	16	20	16	4			20	3	20	20	1	4	30.25	15	4,906	
	17	3	2	1			3		3	3		1		2		
	18	20	12	8			20	2	20	20		8	48.12	11	5,754	
	19	17	14	3			17	1	17	17	1	2		14	5,557	
	20	10	7	3			10		10	10		2		7	6,571	
	21	19	9	9		1	18	2	18	17	1	8	41.12	9	5,166	
	22	17	10	7			17	1	17	17	2	6	28.00	6	5,750	
	23	22	10	12			22	7	22	22	1	12	21.25	4	4,000	
6	1	66	23	43			64	34	66	66	10	41	25.34	16	4,943	
	2	124	56	68			123	44	124	124	11	66	28.37	50	4,238	
	3	19	10	9			19	9	19	19	3	9	13.66	7	4,614	
	4	23	12	11			23	13	23	23	4	11	15.81	7	3,985	
	5	58	35	23			52	9	58	57	3	21	22.19	28	4,496	
	6	44	27	17			44	9	44	44	2	17	34.58	23	6,113	
	7	40	33	7			40	7	40	40	1	4	23.50	30	6,123	
	8	38	21	16	1		37	7	37	37		13	22.46	18	5,683	
	9	46	15	31			46	7	46	46	1	31	44.35	15	5,966	
	10	52	33	18	1		52	7	51	51	2	18	32.33	31	6,380	
	11	37	23	14			37	11	37	37		14	41.57	17	5,911	
	12	53	31	21	1		53	1	52	51		18	33.72	27	6,203	
	13	64	30	33	1		64	30	63	63	1	33	25.90	25	4,664	
	14	14	12	2			14	1	14	14	1	4	24.50	11	5,727	
	15	35	27	8			35	8	35	35	3	7	21.42	25	4,336	
	16	44	21	22		1	44	18	43	43	4	18	30.72	13	4,115	
	18	36	21	15			34	13	36	34	1	13	27.84	18	5,266	
	19	40	22	18			39	17	40	40	4	18	26.50	17	5,300	
	20	54	33	21			54	5	54	54	2	21	30.52	24	6,545	
	21	32	20	12			32	8	32	32		9	42.11	14	6,200	

<sup>1</sup>For renter-occupied dwelling units and vacant nonseasonal not dilapidated units, for rent.<sup>2</sup>For owner-occupied dwelling units and vacant nonseasonal not dilapidated units, for sale only.

Table 3.—CHARACTERISTICS OF HOUSING FOR CENSUS TRACTS, BY BLOCKS: 1950—Con.

Census tract	Block	All dwelling units by occupancy and tenure					All dwelling units by condition and plumbing facilities			Occupied dwelling units			Contract monthly rent <sup>1</sup>		Value <sup>2</sup> of one-dwelling-unit structures	
		Total	Owner occupied	Renter occupied	Vacant non-seasonal not dilap., for rent or sale	Other vacant and non-resident	Number reporting	No private bath or dilap.	No running water or dilap.	Total	Persons per room	Occupied by non-white	Number reporting	Average monthly rent (dollars)	Number reporting	Average value (dollars)
										Number reporting	1.51 or more					
6	22	36	23	12		1	36	5	35	35	1		10	47.80	21	7,238
	23	45	30	15			45	7	45	44			15	45.40	24	7,316
	24	45	37	8		1	45	2	52	51	1		11	40.72	32	6,021
	25	5	1	4			5	3	5	5	1		4	42.75	1	
	26	39	17	22			39	17	39	39	2	18	20	30.50	9	6,555
	28	3	1	2			3		3	3			2			
	30	16	2	14			16		16	16	1		14	29.57	2	
	32	34	21	13			34	11	34	34	1		12	44.08	8	5,950
	33	31	17	14			31	8	31	31	1		14	32.35	11	6,372
	34	25	10	15			24	6	25	25	5		14	37.28	6	8,583
	35	14	11	3			14		14	14			3	43.33	8	7,675
	36	25	20	5			25		25	25			4	35.50	17	8,447
	37	82	64	17		1	80	6	81	81			7	50.52	51	8,594
	38	83	49	32	1	1	81	16	81	81	2		27	46.14	37	7,964
	39	66	40	26			66	7	66	66	1		24	40.16	34	8,141
7	1	28	19	8		1	28		27	24			7	56.00	18	6,994
	2	25	17	8			25		25	25			7	51.71	13	7,023
	3	73	47	23	3		72		70	70	1		24	39.29	35	6,611
	4	36	24	12			33	1	36	35	1		12	32.08	20	7,005
	5	24	14	9		1	23		23	23	1		9	56.22	14	8,857
	6	62	39	12		1	52	6	51	51	1		11	45.45	30	9,396
	7	26	23	3			26	2	26	25	1		2		19	7,663
	8	17	15	2			17	1	17	17			2		15	6,713
	9	21	14	7			21		21	21	1		7	46.42	12	7,975
	10	70	49	21			68	1	70	68	2		20	37.00	42	6,447
	11	87	62	23	1	1	82	7	85	84	6		21	33.23	44	6,288
	12	35	18	16		1	35		34	34	2		16	54.81	14	6,535
	13	31	18	12	1		31	5	30	30			13	36.38	13	7,307
	14	26	23	3			26	2	26	26	1		3	51.00	22	7,854
	15	41	30	11			41	2	41	41	1		9	43.44	27	8,185
	16	33	21	11		1	33		32	31	1		9	35.66	18	7,833
	17	34	24	10			34		34	34			9	40.00	21	9,166
	18	60	36	24			60	5	60	60	2		23	43.65	29	7,713
	19	51	31	19	1		51	3	50	50			19	43.57	30	7,556
	20	51	34	17			51	13	51	51	2		16	40.43	27	7,388
	21	53	36	17			53	5	53	53			17	36.05	29	6,365
	22	51	22	28	1		51	18	50	50	1		28	42.96	18	6,650
	23	41	29	12			41	6	41	41	1		9	43.00	26	7,369
	24	80	47	33			80	17	80	80	3		31	43.09	32	7,750
	25	129	91	38			129	9	129	129	2		35	40.77	63	8,888
	26	71	50	20	1		71	1	70	70			19	56.52	37	9,513
	27	107	40	66	1		106	5	106	105	2		66	53.25	29	8,813
	28	80	60	20			80	6	80	80			19	50.89	51	7,984
8	1	50	35	15			49	6	50	50			14	44.21	23	7,891
	2	29	14	14	1		28	4	28	27			13	46.23	10	7,670
	3	47	40	6	1		47	2	46	46			6	66.66	32	8,053
	4	42	30	11	1		42	6	41	41			12	50.83	21	8,038
	5	47	36	11			47	1	47	47			10	55.60	30	9,223
	6	48	39	9			48	2	48	47			8	49.75	25	10,060
	7	65	38	25	1	1	65	14	63	62	3		24	45.33	27	8,448
	8	3		3			3	3	3	3						
	9	43	31	12			43		43	43	1		12	59.16	22	10,772
	10	42	30	11		1	39		41	38			8	61.12	21	11,522
	11	65	47	18			64	7	65	65	1		18	53.94	32	11,140
	12	49	43	6			49		49	49	2		5	72.80	41	9,768
	13	52	41	11			51	2	52	52			11	41.81	39	8,628
	14	43	31	12			43	5	43	43			10	59.90	27	8,888
	15	38	32	5	1		38		37	37	1		5	41.00	22	9,340
	16	64	56	6	1	1	64		62	62			6	39.66	49	7,977
	17	31	28	3			31		31	31			3	66.66	28	9,867
	18	38	21	16	1		38	5	37	36	1		16	51.56	13	9,846
	19	61	47	14			61	3	61	61			14	49.07	42	7,952
	20	56	45	11			56	8	56	56			9	48.55	40	9,490
	21	42	32	9	1		41	5	41	39			10	55.60	27	11,600
	22	1														
9	1	127	77	49		1	127	8	126	125	1		44	46.18	55	7,840
	2	48	31	15		2	48	7	46	46	1		15	40.60	25	7,460
	3	18	15	3			18		18	18			3	38.33	15	7,966
	4	52	36	15	1		52	3	51	50			14	50.35	29	8,420
	5	50	34	16			50	7	50	50	1		13	50.46	27	8,685
	6	46	39	7			46	2	46	46			5	50.00	31	9,312
	7	46	30	16			45	4	46	46			16	46.81	26	9,269
	8	81	30	50		1	79	2	80	79		4	47	79.27	24	10,812
	9	28	17	10	1		24	3	27	27			9	52.66	6	12,333
	10	49	14	33	2		46	3	47	47			34	59.23	11	10,400
	11	67	23	44			65	2	67	66			43	64.16	16	14,781
	12	72	35	36	1		72	2	71	71	1		35	65.20	26	9,857
	13	88	52	29	6		87		81	80	1		28	52.21	42	8,880
	14	55	42	12		1	53	3	54	54			12	48.00	37	10,405
	15	74	48	24	2		68	18	72	72	1		25	48.80	35	9,505

<sup>1</sup>For renter-occupied dwelling units and vacant nonseasonal not dilapidated units, for rent.  
<sup>2</sup>For owner-occupied dwelling units and vacant nonseasonal not dilapidated units, for sale only.

## HOUSING—BLOCK STATISTICS

Table 3.—CHARACTERISTICS OF HOUSING FOR CENSUS TRACTS, BY BLOCKS: 1950—Con.

Census tract	Block	All dwelling units by occupancy and tenure					All dwelling units by condition and plumbing facilities			Occupied dwelling units			Contract monthly rent <sup>1</sup>		Value <sup>2</sup> of one-dwelling-unit structures	
		Total	Owner occupied	Renter occupied	Vacant non-seasonal not dilap., for rent or sale	Other vacant and non-resident	Number reporting	No private bath or dilap.	No running water or dilap.	Total	Persons per room		Number reporting	Average monthly rent (dollars)	Number reporting	Average value (dollars)
											Number reporting	1.51 or more				
9	16	58	43	15					58	57	1	13	475.3	28	10,342	
	17	76	44	30	2		58	2	76	74		29	437.2	29	7,982	
10	1	42	25	17					42	42		17	460.5	24	7,104	
	2	100	82	38					100	100		38	397.3	57	8,170	
	3	88	57	31					88	88		30	405.3	49	7,706	
	4	111	74	37					111	110	1	35	413.1	61	6,644	
	5	107	60	46					107	106	1	45	390.4	55	6,383	
	6	47	33	14					47	47	1	13	511.5	25	7,552	
	7	54	39	13					54	51	3	14	425.7	31	6,461	
	8	93	45	46					93	88	5	41	352.1	34	5,755	
	9	67	50	16					67	65	2	13	466.9	41	7,007	
	10	36	26	10					36	36	1	10	443.0	18	6,527	
	11	33	21	12					33	33	4	12	352.5	19	4,642	
	12	39	27	12					39	39	3	12	284.1	21	5,380	
	13	55	26	29					55	55	2	22	365.6	16	5,386	
	14	23	8	15					23	23	1	7	343.3	29	7,100	
	15	51	33	18					51	49	2	15	100.3	39	4,937	
	16	74	37	37					74	74	1	22	323.3	29	5,703	
	17	49	40	8					49	48	1	3	290.0	27	5,961	
	18	74	46	28					74	73	1	25	348.8	34	5,670	
	19	71	43	27					70	68	2	25	267.2	35	5,122	
	20	59	37	22					59	59	3	21	336.6	31	5,187	
	21	74	27	43					74	68	6	44	347.2	13	5,923	
	22	37	17	19					37	35	2	20	365.0	11	5,890	
	23	44	40	4					44	44	1	4	425.0	40	5,772	
	24	68	59	8					67	67	1	6	358.3	57	5,361	
	25	42	33	9					41	42	1	8	271.2	31	5,166	
	26	66	54	11					65	65	2	11	381.8	51	5,686	
	27	64	42	21					64	63	1	21	317.6	28	6,396	
	28	62	28	33					62	60	2	32	387.1	19	7,357	
	29	63	30	32					62	62	2	32	344.3	16	8,731	
	30	3	2	1					3	3		1			1	
31	56	34	17					56	50	6	18	385.5	28	7,057		
32	52	41	10					51	50	1	34	289.0	34	7,050		
11	1	43	28	14				42	42		14	445.0	24	7,387		
	2	38	27	10				37	37	1	10	511.0	22	7,022		
	3	41	26	15				41	41	1	13	476.1	22	7,636		
	4	39	27	12				39	39	1	11	501.8	21	6,904		
	5	40	31	9				40	40	1	7	481.4	25	8,184		
	6	41	30	11				41	41	1	10	434.0	24	10,875		
	7	23	15	8				23	23	1	6	443.3	13	9,307		
	8	39	26	13				38	39	1	13	366.9	21	10,490		
	9	57	35	22				57	56	1	22	536.8	23	9,891		
	10	77	45	31				76	75	1	29	535.1	34	8,461		
	11	34	30	3				34	33		3	543.3	28	9,589		
	12	53	42	10				53	52		9	482.2	36	12,333		
	13	48	18	29				48	47		1	27	529.6	14	13,714	
	14	42	19	23				42	42		1	19	692.6	13	8,500	
	15	87	21	6				86	87		2	5	692.0	18	8,861	
	16	18	17	1				18	18			5	1353.1	16	13,531	
	17	28	27	1				28	27			27	1411.4	27	14,114	
	18	32	27	3				31	30			3	400.0	25	13,616	
	19	26	21	5				26	25			4	612.5	20	11,960	
	20	22	20	2				21	22			2	19	11,484		
	21	15	14	1				15	14			2	14	10,285		
	22	45	24	3				45	45			3	26	10,000		
	23	8	8					8	8			8	8	8,837		
	24	8	8					8	8			8	8	14,125		
	25	24	20	4				24	24			2	20	8,960		
	26	25	20	5				25	25			5	18	8,650		
	27	32	23	9				32	32			9	21	7,790		
	28	35	26	9				35	35			8	22	9,022		
	29	28	23	5				28	28			5	20	9,125		
	30	40	28	12				40	40			9	25	7,460		
31	34	27	7				34	34			6	24	7,220			
32	38	25	13				38	38			12	19	10,594			
33	38	27	11				38	37			11	23	7,226			
34	52	38	14				52	51			14	29	6,627			
35	43	34	8				43	41			5	33	7,045			
36	44	34	10				44	44			10	28	7,414			
37	51	39	12				51	51			11	36	8,041			
38	23	18	5				23	22			4	15	9,133			
39	20	18	2				20	19			1	16	8,756			
40	16	15	1				16	16			1	14	9,214			
41	24	24					24	24			2	23	8,052			
42	19	16	2				19	18			2	14	8,471			
43	38	26	10				38	36			10	21	7,433			
44	25	23	2				25	25			1	21	9,272			
45	12	11	1				12	12			1	11	9,272			
46	12	12					12	12			2	6	6,200			

<sup>1</sup>For renter - occupied dwelling units and vacant nonseasonal not dilapidated units, for rent.  
<sup>2</sup>For owner - occupied dwelling units and vacant nonseasonal not dilapidated units, for sale only.







Table 3.—CHARACTERISTICS OF HOUSING FOR CENSUS TRACTS, BY BLOCKS, 1950—Con.

Census tract	Block	All dwelling units by occupancy and tenure					All dwelling units by condition and plumbing facilities			Occupied dwelling units			Contract monthly rent <sup>1</sup>		Value <sup>2</sup> of one-dwelling-unit structures		
		Total	Owner occupied	Renter occupied	Vacant non-seasonal not dilap., for rent or sale	Other vacant and non-resident	Number reporting	No private bath or dilap.	No running water or dilap.	Total	Persons per room		Occupied by non-white	Number reporting	Average monthly rent (dollars)	Number reporting	Average value (dollars)
											Number reporting	1.51 or more					
16	29	49	29	20		48	13		49	49	3		20	411.5	18	9,327	
	30	51	27	24		50	2		51	51	3		22	408.1	14	7,542	
	31	43	28	15		43	1	1	43	43			14	397.1	21	8,728	
	32	39	26	13		38	3		39	39			11	460.0	19	6,315	
	33	29	21	8		28	4		29	29			8	385.0	17	5,558	
	34	35	26	9		34	6		35	34			9	417.7	21	6,233	
	35	51	41	10		49	12	1	51	49			9	44.66	31	6,538	
	36	36	25	10	1	36			35	35			10	54.50	19	8,028	
	37	37	33	5		37			37	37			5	47.60	27	8,259	
	38	44	33	11		43	5		44	43			10	48.00	28	7,114	
	39	35	26	9		34	2		35	35			8	39.87	22	6,909	
	40	30	27	2	1	30	2		29	29			3	39.33	23	9,239	
	41	34	27	7		32			34	33			4	23.50	24	8,347	
	42	33	28	5		33	1		33	33			5	51.00	25	9,052	
	43	28	21	7		28	1		28	28			5	43.42	17	9,311	
	44	21	15	5	1	20			19	19			5	51.00	1	9,000	
	45	18	12	6		18	3	1	18	18				45.00	1	8,600	
	46	16	16			16			16	16						9,573	
	47	23	22	1		23			23	23			2		22	9,836	
	48	87	61	26		85	5	2	87	86			22	581.3	53	9,556	
	49	63	50	13		61	6	1	63	63			11	60.00	41	9,329	
	50	30	22	3	1	30	2		29	29			8	53.50	18	11,605	
	51	28	23	3	2	28			26	25			3	42.00	22	10,704	
	52	42	26	15		41	2		41	40			15	53.53	22	9,936	
	53	35	27	8		35			35	35			7	61.85	22	8,331	
	54	13	12	1		13			13	13			1		11	7,636	
	55	20	16	4		20			20	20			4	53.00	16	9,781	
17	1	37	24	13		36	11		37	36			11	38.09	20	7,075	
	3	41	33	8		40	2		41	41			7	42.71	29	6,355	
	4	24	22	2		23			24	24			1		17	8,023	
	5	83	56	26	1	82	7	1	81	81			25	341.6	51	5,509	
	6	92	52	38	2	90	9	1	90	90			39	297.6	46	6,723	
	7	16	1	1		16			16	16			1		16	8,143	
	17	18	17	1		18			18	18			1		17	7,337	
	18	61	51	10		57	3		61	61			10	49.50	14	8,327	
	10	28	22	2		28			28	28			6	42.16	20	6,410	
	11	33	21	12		33	16	1	33	33			11	40.18	12	7,558	
	12	39	36	3		39			39	39			3	41.00	31	7,445	
	13	29	22	3	1	29			28	28			7	31.85	20	7,260	
	14	17	12	4		17			17	17			3	43.33	12	7,191	
	15	88	54	33		88	17	2	87	86			33	383.9	42	6,469	
	16	80	52	28		80	4		80	80			7	39.57	17	7,058	
	17	37	37	1		37	2		37	36			11	35.36	23	8,369	
	18	42	29	13		42	2		42	42			12	49.25	28	8,089	
	19	30	23	7		30	10		30	30			5	45.40	17	7,647	
	20	42	23	18		42	4		41	41			17	30.58	18	7,305	
	21	44	31	13		44	8		44	44			10	37.20	21	8,523	
	22	37	24	12	1	37	2		36	36			12	42.75	21	7,928	
	23	20	14	6		20	2		20	20			6	37.50	13	7,569	
	24	102	49	50	3	100	10	1	99	97			51	44.88	21	8,314	
	25	60	20	38	2	59	31		58	58			37	42.16	7	7,671	
	26	31	11	19	1	31			30	30			19	40.36	8	6,387	
	27	68	43	24		67	8		67	66			20	41.45	34	6,044	
	28	50	30	19	1	50			49	49			19	39.89	28	6,232	
	29	34	17	16		34	6		33	33			16	33.06	14	6,857	
18	1	1															
	2	92	41	51		91	43		92	90			11	349.4	25	4,624	
	3	16	7	9		16	5		16	16			9	41.66	3	7,000	
	4	61	29	31	1	61	25	3	60	59			32	30.81	17	4,400	
	5	42	26	16		41	13	2	42	42			15	33.73	21	5,461	
	6	30	14	15		30	2		29	29			15	34.26	6	6,666	
	7	63	26	36		61	37	22	62	62			32	34.00	17	4,852	
	8	12	2	10		12	3		12	12			10	26.00	1		
	9	19	10	9		19	5	3	19	18			8	18.62	8	4,500	
	10	1				1			1	1							
	13	21	13	8		21	7	7	21	21			7	27.71	12	4,766	
	14	28	16	11	1	28	13	1	27	27			12	32.16	10	5,120	
	15	37	19	17		37	12		36	36			18	35.05	16	5,237	
	16	44	29	14		44	14	3	43	41			14	35.35	26	4,896	
	17	33	19	14		31	5		33	31			14	25.28	15	4,146	
	18	25	7	17	1	25	23		24	24			15	31.46	1		
	19	40	18	21		39	7	1	39	39			21	34.23	13	6,076	
	20	41	28	13		40	14		41	41			8	26.50	20	5,325	
	21	48	26	20		47	15		46	45			19	31.94	14	4,928	
	22	54	28	26	1	54	21		54	54			26	32.34	20	4,550	
	23	30	18	11	1	30	11	9	29	29			10	37.40	16	5,093	
	24	31	28	3		30	7	5	31	31			3	33.33	26	5,969	
	25	39	26	13		39	9	6	39	38			13	33.61	22	5,718	
	26	57	38	19		57	15	2	57	56			17	27.47	31	5,338	
	27	99	56	40	3	98	27	3	96	94			40	29.15	47	4,893	
	28	46	26	19	1	46	9		45	45			18	35.11	16	6,343	
	29	38	27	11		38	6		38	38			10	37.40	21	6,571	
	30	44	37	6	1	44	2		43	43			6	53.66	31	6,283	

<sup>1</sup>For renter - occupied dwelling units and vacant nonseasonal not dilapidated units, for rent.  
<sup>2</sup>For owner - occupied dwelling units and vacant nonseasonal not dilapidated units, for sale only.

HOUSING—BLOCK STATISTICS

Table 3.—CHARACTERISTICS OF HOUSING FOR CENSUS TRACTS, BY BLOCKS: 1950—Con.

Census tract	Block	All dwelling units by occupancy and tenure					All dwelling units by condition and plumbing facilities			Occupied dwelling units			Contract monthly rent <sup>1</sup>		Value <sup>2</sup> of one-dwelling-unit structures		
		Total	Owner occupied	Renter occupied	Vacant non-seasonal not dilap., for rent or sale	Other vacant and non-resident	Number reporting	No private bath or dilap.	No running water or dilap.	Total	Persons per room	Occupied by non-white	Number reporting	Average monthly rent (dollars)	Number reporting	Average value (dollars)	
18	31	35	24	10	1				34	34		11	409.0	17	61.58		
	32	32	20	11		1			31	31		10	38.40	14	7.678		
	33	50	37	13					50	50		13	46.53	32	7.359		
	34	37	26	11					37	37		11	50.90	21	7.895		
19	1	30	8	22					30	30	8	3	21	35.61	4	8.000	
	2	37		37				32	37	37	10	2	37	20.70			
	3	55	14	34	3	4			48	48	6	12	33	36.60	6	4.683	
	4	12	5	7					12	12	1	7	7	26.85	1		
	5	42	25	16	1				41	41	2	2	15	27.73	16	5.662	
	6	144	51	91		2	1	1	131	84	15	142	19	79	84	5.003	
	7	61	24	37					60	41	26	6	33	24.48	14	2.971	
	8	20	11	9					19	13	4	20	8	8	22.75	8	3.375
	9	84	25	56	2	1			82	63	20	81	15	79	52	3.700	
	10	54	19	35					53	26	1	54	7	53	34	4.308	
	11	36	18	18					36	22	7	36	5	36	18	6	41.33
	12	42	18	23		1			42	13	3	41	3	41	21	9	4.322
	13	49	26	23					49	23	3	49	6	49	22	19	3.626
	14	45	27	18					43	19	3	45	2	45	17	21	4.657
	15	63	34	29					63	19		63	3	63	25	22	4.759
	16	15	9	6					15	4		15	1	15	5	8	3.762
	17	37	19	18					34	6	6	37	4	37	15	15	7.113
	18	52	42	10					49	5	4	52	2	52	8	40	5.510
	19	7	1	6					6			7	7	7	6		
	20	24	6	16		2			23	3	1	22	1	22	14	5	92.00
	21	28	15	13					27	13	7	28	2	28	13	12	6.250
22	29	19	10					27	11	6	29	2	29	9	16	4.887	
23	31	20	21					30	15	8	31	3	31	21	7	5.214	
24	64	33	41					63	22		64	14	62	39	15	6.426	
25	50	25	24	1				49	16	2	49	5	37	24	17	4.482	
26	75	33	42					73	37	11	75	10	25	38	22	4.622	
27	71	40	31					70	21	13	71	7	40	31	29	3.975	
20	1	55	30	24	1	1			55	20	2		24	30.04	20	5.235	
	2	34	15	29					31	14	2		27	35.25	1		
	3	53	18	35	1	1			52	23	9		31	31.58	8	2.775	
	4	69	21	48	1	3			67	29	7	1	41	30.80	11	5.118	
	5	46	25	20		3			43	17	2		16	30.81	19	5.436	
	6	113	34	76	2	1			111	71	22	110	13	66	71	21	4.523
	7	118	47	69	1				116	51	5	116	17	48	64	30	3.703
	8	40	14	28	1	2			40	15	3	37	2	37	22	13	3.476
	9	29	16	12		2			29	9	3	28	2	17	12	15	3.073
	10	54	29	25		2			52	28	10	52	5	21	20	3.900	
	11	41	11	30					40	13	3	41	1	40	29	12	6.666
	12	26	11	15					25	16	11	26	3	26	15	8	5.562
	13	19	12	7					18	6	2	19	1	19	6	11	3.581
	14	38	18	20					37	14	4	38	4	33	20	11	2.690
	15	37	22	14		1			36	5	2	36	2	31	14	14	2.971
	16	89	36	52	1				88	32	4	88	6	82	50	21	5.809
	17	73	36	37	1				72	15	4	73	2	73	35	21	6.785
	18	60	31	28		1			56	19	5	59	5	45	26	22	4.090
	19	39	18	20	1	1			37	12		38	6	25	20	12	3.475
	20	47	19	27	1	3			46	17	3	46	3	19	24	17	5.158
	21	29	13	15	1				27	21	2	28	5	13	14	7	5.285
22	29	11	17	1				27	17	1	28		16	16	5	7.700	
23	130	67	58	1	4			123	57	11	125	14	90	54	51	5.388	
24	50	18	29		3			48	22	2	47	4	3	28	11	5.000	
25	55	24	30	1				54	20	1	54	5	30	30	17	5.147	
26	34	10	22	2				32	14		32	3	22	6	6	5.250	
27	15	8	6	1				15	6	3	14	1	7	7	6	7.083	
28	39	24	11	3	1			38	8		35	1	11	11	21	5.823	
29	112	29	79	1	3			108	51	3	108	9	7	72	16	5.537	
21	1	35	10	25					35	22	7		25	25.76	7	4.214	
	2	35	11	23					34	16	2		20	20.30	11	3.281	
	3	42	15	26		1			42	19	4		23	17.65	9	5.244	
	4	43	19	24					43	16	1		21	40.47	14	4.228	
	5	84	38	46					84	22	7	1	43	29.60	23	4.130	
	6	87	60	25	1	1			87	19	4	85	7	25	51	4.068	
	7	68	42	26					68	13	3	68	5	24	29	4.648	
	8	71	34	36	1				69	35	2	70	11	30	20	4.625	
	9	52	23	28		1			52	31	7	51	8	27	15	3.093	
	10	25	12	13					25	15	6	25	4	13	10	3.530	
	11	41	10	30		1			41	15		40	3	30	9	4.611	
	12	32	14	17	1	1			32	4	4	31	7	12	12	4.441	
	13	53	20	32	1				53	19	19	52	51	27	10	3.916	
	14	16	6	10					16	10	2	16	2	10	5	4.360	
	15	60	25	34		1			59	22	2	59	8	32	16	3.700	
	16	28	14	14					28	10		28	2	14	9	4.222	
	17	25	14	11					25	8		25	3	11	10	3.580	
	18	31	9	22					31	7	6	31	3	19	7	4.857	
	19	40	14	26					38	15	8	40	6	23	11	4.254	
	20	115	63	51	1				115	29	5	114	10	47	54	4.592	
	21	58	27	30		1			58	13	2	57	4	29	22	4.468	

<sup>1</sup>For renter - occupied dwelling units and vacant nonseasonal not dilapidated units, for rent.  
<sup>2</sup>For owner - occupied dwelling units and vacant nonseasonal not dilapidated units, for sale only.

Table 3.—CHARACTERISTICS OF HOUSING FOR CENSUS TRACTS, BY BLOCKS: 1950—Con.

Census tract	Block	All dwelling units by occupancy and tenure					All dwelling units by condition and plumbing facilities			Occupied dwelling units			Contract monthly rent <sup>1</sup>		Value <sup>2</sup> of one-dwelling-unit structures		
		Total	Owner occupied	Renter occupied	Vacant non-seasonal not dilap. for rent or sale	Other vacant and non-resident	Number reporting	No private bath or dilap.	No running water or dilap.	Total	Persons per room		Occupied by non-white	Number reporting	Average monthly rent (dollars)	Number reporting	Average value (dollars)
											Number reporting	1.51 or more					
21	22	50	32	18					50	50	3		16	30.68	27	4.766	
	23	41	23	17		1			40	40	1		17	26.94	18	4.783	
	24	19	8	11					19	19	2		10	24.50	5	3.300	
	25	26	15	11					26	26	2		11	29.90	11	3.645	
	26	30	11	19					30	30	7		19	19.57	10	3.780	
	27	45	32	13					45	45	3		13	25.92	25	4.256	
	28	34	27	7					34	34	1		7	37.57	27	6.051	
	29	69	19	50					68	68	10		44	17.02	8	4.400	
	30	25	15	10					25	25			9	35.11	10	3.800	
	31	21	11	10					21	21	4		8	15.25	5	4.060	
	32	67	17	50					65	44	34		44	27.36	9	3.788	
	33	71	36	34	1				71	21			34	43.67	19	5.357	
	34	61	24	37					61	15	4		34	34.41	13	6.176	
	35	38	14	24					38	18	6		24	29.25	10	4.420	
	36	14	4	10					14	9	1		8	29.00	3	3.733	
	37	17	6	10		1			17	6	1		8	27.75	3	3.833	
	38	35	15	20					35	7	1		19	23.31	9	6.433	
	39	51	20	31					50	18	6		29	42.68	8	7.250	
	22	1	73	49	24				72	35	24		1	22	27.77	34	4.041
		2	16	13	3				16	4	1			7	16.33	12	5.533
		3	15	8	7				15	5				3	31.28	6	5.916
		4	20	10	10				19	5				9	39.22	8	3.625
		5	27	12	14		1		25	7	1			14	39.57	10	5.550
		6	54	17	37				53	30	11			35	28.22	11	5.681
		7	35	18	17				35	23	4			15	25.40	14	2.978
		8	63	20	43				59	37	21			40	30.00	9	3.088
		9	78	43	32		3		75	50	39			22	16.17	33	2.793
		10	64	24	39		1		62	44	19			37	22.21	19	3.036
		11	28	13	15				28	25	21			15	15.46	9	2.344
		12	32	19	13				32	19	11			12	29.00	15	2.486
		13	37	10	27				36	33	22			12	14.96	6	1.666
		14	59	5	53		1		58	53	27			32	24.15	4	3.500
		15	8	2	6				8	6	6			5	9.80	2	
		16	44	14	30		1		43	32	13			22	31.28	13	2.076
		17	36	17	19				36	32	29			14	21.33	13	2.761
		18	28	16	10		2		27	25	21			9	16.11	12	2.208
		19	63	45	18				62	20	3			12	20.06	39	2.638
		20	97	48	47		2		93	23	2			19	23.60	33	3.187
		21	2											1			
22		77	36	41				72	29	1			8	26.65	24	3.845	
23		93	51	42				89	31	4			14	29.22	39	4.407	
24		120	76	43	1			117	30	8			17	26.24	66	3.659	
25		60	27	32	1			59	30	5			7	26.82	21	4.285	
26		89	49	39	1			86	31	1			15	19.80	38	3.450	
27		24	15	9				24	16	15			8	25.50	10	3.010	
28		57	28	29				56	36	5			14	20.40	23	3.000	
23		1	21	15	6			20	5	3				6	20.16	14	3.735
		2	4	3	1			4	2	1				1	16.33	3	4.466
		3	15	7	5			15	5	3				5	30.60	3	5.333
		4	18	11	5			18	9	3				6	28.12	8	2.812
		5	45	30	13			41	21	6				12	28.66	24	3.379
		6	17	10	6			16	5	1				6	25.16	9	3.300
		7	34	16	18			33	19	1				17	21.58	13	3.323
		8	15	10	5		1		14	9				10	28.20	3	3.233
		9	37	28	4			35	11					7	34.42	22	4.740
		10	50	30	19	1		50	14					19	32.36	22	4.816
		11	27	12	15			26	15					6	22.00	7	3.771
	12	18	4	14			17	11	7				4	22.22	2		
	13	33	16	17			33	11					16	26.75	12	3.208	
	14	36	21	15			35	19					14	24.22	14	3.242	
	15	31	13	18			31	24	2				18	33.22	6	4.033	
	16	26	14	12			26	16	2				12	23.50	13	2.400	
	17	25	12	13			25	12					11	22.90	11	3.572	
	18	43	22	21			40	26	18				19	16.32	15	3.160	
	19	27	17	10			27	18	12				9	21.66	15	3.713	
	20	22	14	8			22	5	3				8	17.50	12	4.383	
	21	38	19	18		1		36	25	24			3	33.93	10	4.200	
	22	21	17	4			20	1	1				4	26.75	17	4.923	
	23	27	11	16			27	20	9				4	16.00	6	3.700	
	24	35	20	15			35	14	1				15	22.95	15	3.740	
	25	19	10	9			19	12					4	22.58	5	3.500	
	26	43	22	21			43	20	1				11	27.57	17	3.317	
	27	49	17	32			48	22					12	25.33	10	3.080	
	28	41	13	27		1		40	23	19			15	22.76	9	3.666	
	29	2															
	30	10	9	1			10	5	3				1		6	2.900	
	31	17	5	12			16	14	6				4	16.08	4	2.650	
	32	43	24	19			40	26	1				12	19.28	18	2.766	
	33	52	23	29			52	33	2				11	26.66	20	3.465	
	34	47	4	4			10	7	0				3	12.28	2		
	35	41	40	3			70	15					28	25.17	31	3.993	
	36	29	16	13		3		29	12	2			12	20.66	11	3.427	
	37	29	11	6			17	8					6	16.00	8	3.600	

<sup>1</sup>For renter - occupied dwelling units and vacant nonseasonal not dilapidated units, for rent.  
<sup>2</sup>For owner - occupied dwelling units and vacant nonseasonal not dilapidated units, for sale only.

HOUSING—BLOCK STATISTICS

Table 3.—CHARACTERISTICS OF HOUSING FOR CENSUS TRACTS, BY BLOCKS: 1950—Con.

Census tract	Block	All dwelling units by occupancy and tenure					All dwelling units by condition and plumbing facilities			Occupied dwelling units			Contract monthly rent <sup>1</sup>		Value <sup>2</sup> of one-dwelling-unit structures					
		Total	Owner occupied	Renter occupied	Vacant non-seasonal not dilap. for rent or sale	Other vacant and non-resident	Number reporting	No private bath or dilap.	No running water or dilap.	Total	Persons per room		Number reporting	Average monthly rent (dollars)	Number reporting	Average value (dollars)				
											Number reporting	1.51 or more					Occupied by non-white			
23	39	37	36	11					35	9	2	37	35	5		10	16.90	24	4.033	
	40	32	13	15	2	2			32	12		28	28	5		17	15.52	7	4.285	
	41	38	19	18	1				35	9	1	37	35	6		17	27.05	16	3.675	
	42	33	23	10					33	5		33	33	1		9	29.33	18	4.744	
	43	23	10	13					23	5		23	23	1		13	19.30	8	4.587	
	44	23	11	12					23	4		23	23			11	31.45	7	5.357	
	45	24	13	11					24	9		24	24	5		10	21.40	10	4.080	
	46	38	22	16					38	2		38	38	3		16	30.06	13	4.230	
	48	21	4	17					21	12	2	21	21	1		13	25.23	2		
	49	25	19	6					25	3		25	25			6	24.00	17	3.376	
	50	16	10	6					15	9		16	16	2		5	42.20	5	5.800	
	51	29	19	9		1			26	7		28	28	8		8	24.75	8	4.200	
	52	30	15	15					28	9	1	30	28	3		13	31.30	10	5.280	
	53	25	11	14					25	8		25	25	3		9	36.44	7	4.328	
	54	43	21	22					43	15	6	43	42	8		19	28.10	13	4.653	
	55	17	5	12					15	6	3	17	17	1		11	23.81	2		
	56	39	12	27					35	24	13	39	39	11		27	22.22	10	3.700	
	57	17	5	12					16	14	5	17	17	1		12	26.33	3	3.266	
	58	30	2	28					29	16	10	30	30	6		27	16.59			
	66	22	7	15					22	18	4	22	22	6	7	14	21.00	3	3.066	
	67	7	3	4					6	4		7	7			3	16.66	3	2.666	
	68	10	4	6					10	3		10	10	1		6	29.83	3	4.000	
	69	37	13	23		1			37	17	2	37	35	5		23	26.26	10	3.870	
	70	35	13	22					35	14		35	35	4		22	25.36	6	3.083	
	71	36	15	20		1			36	18	5	36	35	4		21	63.90	8	4.625	
	72	34	13	21					34	12		34	34	8		19	27.15	11	3.409	
	74	17	2	15					17	2		17	17	2		13	24.38	2		
	75	38	17	19		1			37	2		36	36	3		20	30.75	9	3.522	
	76	42	12	29		1	1		42	19	4	41	41	3		28	21.17	7	3.428	
	77	38	9	28		1			37	16		37	37	2		28	30.42	7	3.714	
	78	46	19	26		1			45	9	2	45	43	5		27	56.11	15	3.633	
	79	37	7	29			1		36	1		36	35	2		27	26.55			
	80	44	11	31		2			44	16	3	42	42	8		33	29.45	4	2.750	
	81	59	5	52		1	1		58	31	4	57	57	8		50	25.26	1		
	82	26	2	24		1			24	16	3	26	26	9		24	20.00			
	83	48	1	45		2			47	42	12	46	46	11	1	44	23.25			
	24	1	30	7	22				27	17	9	29	29	6		20	23.70	2		
		2	34	5	28		1		33	17	10	33	33	4		28	27.57	3	4.333	
		3	42	14	28		1		42	26	10	42	42	5	12	28	25.55	6	4.416	
		4	43	14	29				38	12	8	43	43	14	10	29	29.65	7	5.285	
		5	17	4	13				14	10	2	17	17	2	8	11	21.45	1		
		6	7	4	3				29	19	1	35	35	2	6	29	25.17	2		
		7	100	18	78		1	3		99	68	16	96	96	25	62	75	27.20	13	4.530
		8	87	37	50				70	27	25	87	87	21	69	49	24.65	23	3.452	
		9	48	14	34				47	29	6	48	48	10	44	34	30.64	10	4.690	
		10	64	14	49		1		63	36	18	63	63	9	59	44	19.59	12	4.166	
		11	48	18	30				48	34	16	48	48	4	47	29	23.79	14	3.185	
		12	52	24	28		2		49	34	16	50	49	4	45	25	23.88	18	3.472	
		13	43	13	30			1		43	36	11	42	42	12	28	22.75	6	4.000	
		14	42	11	16				27	16	6	27	27	12	25	15	19.73	7	3.928	
		15	27	7	47		1		74	16	11	74	74	5	73	48	26.10	17	4.388	
		16	66	21	46		1		67	16	11	67	63	11	67	43	19.11	15	5.186	
		17	44	19	23		1		42	20	3	42	42	2	42	23	17.78	14	3.300	
		18	35	22	13				29	20	1	35	35	3	35	13	23.38	19	4.473	
		19	77	35	40		2		70	34	14	75	75	7	73	37	24.00	23	4.734	
		20	57	19	37		1		57	36	18	56	56	3	56	35	21.91	9	6.500	
		21	76	30	45		1		76	35	22	75	75	9	73	44	20.38	25	4.148	
		22	25	10	13		2		23	12	6	23	23	1	23	13	17.53	8	4.950	
		23	12	7	5				12	6	1	12	12	2	12	7	16.28	4	3.475	
		24	42	16	26				42	15	4	42	42	2	40	25	23.08	12	4.708	
		25	21	15	6				21	8	1	21	21	2	20	8	23.40	14	4.428	
		26	12	3	8			1		12	8	4	11	11	10	5	13.87	1		
		27	47	22	25				42	14	1	47	47	3	33	24	36.83	13	3.730	
		28	35	18	16		1		26	11	2	34	34	3	34	16	22.43	12	3.291	
		29	53	28	25				44	16	6	53	52	7	33	23	36.26	15	4.326	
30		17	6	11				10	2		17	17	2	15	10	25.30	5	4.800		
31		43	15	28				35	8	2	43	38	2	24	21	21.42	8	3.875		
25	1	17	9	8			17	10	5	17	17	3	4	8	15.00	2				
	2	23	8	15			21	14	1	23	21	6	5	13	30.30	2				
	3	28	3	24		1		26	19	10	27	25	6	22	27.95					
	4	31	2	27		2		31	17	3	29	29	5	27	19.37	1				
	5	50	4	46				50	34	9	50	50	16	7	45	23.00	1			
	6	39	4	34				38	33	5	38	37	13	8	35	19.71	1			
	7	52	7	44		1		47	30	7	51	51	17	36	42	25.02				
	8	34	2	32				32	28	7	34	33	5	30	31	19.06	1			
	9	25	3	22				22	17	4	25	25	6	25	21	18.80	1			
	10	41	8	33				41	35	26	41	41	9	41	32	17.03	4	2.250		
	11	39	6	33				39	39	23	39	39	7	36	33	16.24	3	2.500		
	13	19	13	6				19	9	1	19	19	2	19	6	15.50	13	3.753		

<sup>1</sup>For renter - occupied dwelling units and vacant nonseasonal not dilapidated units, for rent.  
<sup>2</sup>For owner - occupied dwelling units and vacant nonseasonal not dilapidated units, for sale only.

Table 3.—CHARACTERISTICS OF HOUSING FOR CENSUS TRACTS, BY BLOCKS, 1950—Con.

Census tract	Block	All dwelling units by occupancy and tenure					All dwelling units by condition and plumbing facilities			Occupied dwelling units			Contract monthly rent <sup>1</sup>		Value* of one-dwelling-unit structures			
		Total	Owner occupied	Renter occupied	Vacant non-seasonal not dilap., for rent or sale	Other vacant and non-resident	Number reporting	No private bath or dilap.	No running water or dilap.	Total	Persons per room		Number reporting	Average monthly rent (dollars)	Number reporting	Average value (dollars)		
											Number reporting	1.51 or more					Occupied by non-white	
25	15	38	9	29			37	25	3	38	38	7	37	29	17.20	8	4,025	
	16	47	9	37			45	34	8	46	45	10	44	37	23.67	8	4,140	
	17	102	28	70	1	3	96	64	34	98	98	21	94	39	16.05	20	3,635	
	18	47	7	38	2		44	27	13	45	45	10	44	33	19.28	4	4,000	
	19	43	9	34			35	29	28	43	37	10	44	33	16.27	5	2,240	
	20	37	7	30			32	22	19	37	28	9	33	29	14.37	3	1,166	
	21	53	2	51			34	29	28	53	38	20	35	49	22.24			
	22	24	7	17			19	10	6	24	20	2	22	14	19.57	3	5,000	
	23	65	13	52			65	40	33	65	65	10	65	51	21.96	9	4,611	
	24	53	10	43			53	35	31	53	53	6	53	43	20.83	6	3,916	
	25	56	24	31		1	55	25	17	55	55	9	55	29	24.24	16	3,875	
	26	56	15	40		1	53	47	41	55	55	5	55	38	17.50	5	3,820	
	27	24	10	13		1	21	15	14	23	22	2	23	12	25.66	5	3,000	
	28	43	5	36		2	38	32	22	41	38	7	41	34	15.58	3	3,433	
	29	43	7	35	1		43	33	23	42	42	4	40	35	20.94	3	5,666	
	30	26	6	20			26	15	10	26	26	7	26	19	25.94	6	7,166	
	31	37	17	20			37	29	19	37	37	8	36	20	21.30	13	3,576	
	33	26	5	21			22	21	13	26	26	4	26	15	14.00	4	3,300	
	34	18	5	13			16	14	11	18	17	4	18	13	14.92	2		
	35	1																
	36	27	7	20			24	20	20	27	26	4	27	19	13.63	6	3,683	
	38	38	11	26		1	38	30	28	37	37	5	36	26	18.50	8	3,162	
	39	50	12	38			50	28	8	50	50	17	48	36	45.33	3	3,500	
	40	10		10			10	7	5	10	10	2	9	9	22.66			
	41	43	6	37			35	15	4	43	42	5	36	24	24.36	3	4,933	
	42	6		6			3	3	3	6	6	4	6	6	21.83			
	26	1	72	27	44	1	63	41	4	71	62	2	12	44	27.43	14	7,285	
		2	18	13	5		17	5	1	18	16	4	10	5	32.80	9	3,633	
		3	75	18	52	1	4	73	44	11	70	68	22	48	25.08	7	4,142	
		4	83	39	44	1	4	82	19	1	83	83	15	18	27.04	3	4,171	
		5	47	22	24	1		47	20		46	45	4	24	34.83	13	5,230	
		6	12	6	6			12	1		12	12	1	6	29.83	5	3,800	
		7	54	26	26	2		54	26	2	52	52	8	1	33.79	18	3,527	
		8	40	25	13	2		35	13	2	38	35	5	13	25.00	24	4,283	
		9	42	18	22	2		40	30	8	40	39	4	10	24.81	11	4,409	
		10	18		18			17	15	12	18	17	4	18	16.50			
		12	42	16	26			41	26	4	42	42	4	25	57.52	11	3,545	
		13	50	32	18			50	10		50	50	11	8	16	28.93	30	4,013
		14	24	12	12			24	3		24	23	1	10	10	24.60	11	3,645
		15	82	20	60	2		80	6		80	80	4	61	29.83	14	6,250	
		18	99	41	58			93	66	28	99	95	22	91	56	22.01	30	3,046
		19	104	36	67			100	77	22	103	102	23	88	62	22.70	24	3,054
20		41	25	14	1		39	25	3	39	39	3	14	21.28	19	3,305		
21		76	29	45	1	2	74	48	3	74	74	19	36	45	41.68	21	2,352	
22		54	33	20	2		53	20	1	53	53	9	7	20	19.95	24	2,958	
23		98	43	55		1	96	61	5	98	98	20	17	53	39.37	27	3,355	
24		57	39	18			57	7		57	57		17	31.58	31	4,935		
25		60	42	18			59	5		60	58	1	18	35.72	33	5,924		
27	1	76	38	37		76	67	66	75	75	20	65	36	20.69	35	2,814		
	2	63	41	22		57	20	2	63	62	6	34	21	22.47	31	4,148		
	3	26	12	14		26	11	2	26	26	3	11	11	30.36	7	5,642		
	4	24	6	18		19	9	7	24	24	5	2	18	22.50	3	5,000		
	5	54	29	23	2		50	10	1	52	51	3	23	47.52	23	6,260		
	6	60	30	29	1		59	13		59	59	2	28	35.28	21	6,309		
	7	24	8	16			23	11	7	24	24	1	16	26.62	3	2,800		
	8	9	15	6			22	12	1	21	21	1	7	20.50	10	3,340		
	9	105	51	53	1		100	65	18	104	99	26	97	47	17.23	28	4,185	
	10	72	31	39	1		71	66	63	70	70	16	68	38	19.65	22	3,459	
	11	93	44	46		3	93	87	85	90	90	23	89	45	18.84	32	2,787	
	12	50	28	22			48	26	5	50	48	9	41	21	16.00	15	4,060	
	13	41	22	18			33	13	1	40	39	2	10	15	28.20	20	3,360	
	14	23	7	15	1		21	9	3	22	22	2	14	14	32.35	3	5,066	
	15	43	30	13			42	14		43	43	2	12	12	36.75	20	6,500	
	16	43	25	18			41	5		43	43	2	18	33.61	22	6,468		
	17	22	4	16			17	5		20	19	2	13	28.92	1			
	18	50	24	26		2	38	26	23	50	49	1	29	25	19.84	14	4,421	
	19	131	37	92		2	118	49	45	129	129	17	122	92	18.80	28	5,678	
	20	55	33	22			55	31	19	55	55	1	53	17	24.47	20	2,975	
	21	39	30	9			39	29	20	39	39	7	39	9	21.55	24	3,079	
	22	52	32	20			52	18	4	52	52	2	46	20	17.75	25	4,276	
	23	63	35	28			62	24	5	63	63	15	54	27	18.74	30	4,106	
	24	29	6	23			29	6		29	29	6	23	5	24.40			
25	15	11	11	3		17	17		18	18	1	11	11	37.09	14	6,785		
26	18	7	11			17	5		18	18	1	10	10	31.40	5	6,740		
27	79	55	23		1	74	18	11	78	78	4	55	20	29.05	50	4,070		
28	67	40	27			67	15	3	67	67	5	27	25	27.64	32	6,071		
29	58	37	21			57	14	6	58	58	6	26	18	24.27	32	4,325		
30	76	34	42			74	17	5	76	76	6	41	41	26.92	26	4,538		
31	52	24	28			52	20	7	52	51	2	9	26	30.11	20	4,235		
32	109	55	54			108	31	11	109	109	16	78	52	24.90	47	4,912		
33	108	57	51			108	32		108	107	14	41	47	30.95	38	4,823		
34	45	20	23		2	44	12		43	43	2	27	23	17.82	18	4,822		

<sup>1</sup>For renter - occupied dwelling units and vacant nonseasonal not dilapidated units, for rent.  
<sup>2</sup>For owner - occupied dwelling units and vacant nonseasonal not dilapidated units, for sale only.

HOUSING—BLOCK STATISTICS

Table 3.—CHARACTERISTICS OF HOUSING FOR CENSUS TRACTS, BY BLOCKS: 1950—Con.

Census tract	Block	All dwelling units by occupancy and tenure					All dwelling units by condition and plumbing facilities			Occupied dwelling units			Contract monthly rent <sup>1</sup>		Value <sup>2</sup> of one-dwelling-unit structures		
		Total	Owner occupied	Renter occupied	Vacant non-seasonal not dilap., for rent or sale	Other vacant and non-resident	Number reporting	No private bath or dilap.	No running water or dilap.	Total	Persons per room		Number reporting	Average monthly rent (dollars)	Number reporting	Average value (dollars)	
											Number reporting	1.51 or more					Occupied by non-white
27	35	30	25	5		30	3	1	30	29	3		5	52.20	22	4,877	
	36	23	18	5		22	4		23	23	1		3	21.66	16	4,962	
	37	22	18	4		22	3	1	22	22	2		3	23.00	16	4,843	
28	1	15	10	5		15			15	15			5	26.20	9	4,000	
	2	7		7		7			7	7			7	43.00			
	3	133	92	38		3	132	25	6	130	130	13	5	32	29.96	78	4,485
	4	49	34	15		49	4		49	49			14	30.07	28	4,767	
	5	58	29	29		58	8		58	58	5		29	30.17	16	6,500	
	6	66	35	31		66	6		66	66	3		27	28.92	28	5,821	
	7	56	31	24		56	1		55	55			22	32.59	25	5,592	
	8	62	42	20		62	2		62	60	4		14	36.71	30	6,560	
	9	58	37	19		58	6		56	56			19	43.00	29	5,586	
	10	62	39	23		62	11	1	62	62	13		20	39.80	33	6,000	
	11	8	4	4		8			8	8			4	43.25	3	7,666	
	12	1				1			1	1							
	13	3	3			3			3	3							
	14	210		209	1		210	2	2	209	208	8		210	34.38	3	17,333
	15	227	172	54	1		227	6	1	226	225	6		52	55.94	166	8,319
	16	31	22	9		31			31	29				8	56.50	21	8,261
	17	31	22	9		31			31	29				8	56.50	21	8,261
	18	10	8			10	2		10	10				1		7	6,685
29	6	1			6			6	6								
	7	22	3	18		19	17	16	21	19	6	1	16	24.31			
	10	1				1			1	1							
	11	34	5	28	1	33	28	10	33	32	9	2	26	24.84	3	4,333	
	12	39	1	38		39	35	10	39	39	16	8	38	22.50	1		
	13	46		46		45	38	1	46	46	15	7	46	28.41			
	14	41	1	40		41	30	1	41	41	11	11	39	29.35			
	15	37	2	35	4	36	30	11	37	32	12	3	34	24.05			
	16	17		15		16	13	11	17	16	4		15	22.46			
	17	16		16		14	13	5	16	16	5		16	39.81			
	18	53	5	48		45	40	27	53	53	20	1	48	36.37			
	19	54		51		45	44	43	53	52	22	7	49	31.12			
	20	46		43	2	44	40	23	43	42	19	2	41	23.73			
	21	25		22		22	18	3	24	24	1		20	29.20			
	22	58		53	3	55	38	9	55	55	20	10	52	24.23			
	23	11	2	9		11	9	3	11	11	2	11	10	19.40			
	24	53		51		52	40	6	53	51	11	50	50	15.76	2		
	25	63	1	62		62	23	6	63	61	10	9	61	15.65	1		
26	55		53		55	41	2	55	52	12	10	53	20.94				
27	15	6			12	4		15	15		12	12	24.00	3	3,433		
28	37	2	35		37	24	13	37	37	2	33	33	17.87	2			
29	55	3	49	2	51	44	18	49	48	17	33	49	25.69				
30	14		10	1	12	7		13	13	1	6	9	15.44	1			
30	1	241	4	237		238	24	14	241	234	22	240	230	26.24	1		
	2	212		212		204	2	2	212	208	17	211	210	27.32			
	3	224	2	221		220	1	1	223	220	21	221	218	26.67			
	4	59		57	1	57	3		58	58	4	57	58	24.58	1		
	5	41	8	29	1	39	33	15	37	37	6	37	29	13.65	7	3,714	
	6	88	7	81		85	66	32	88	88	16	88	77	15.23	6	4,583	
	7	47	4	42		47	39	24	46	46	13	45	43	17.97	3	3,600	
	8	85	9	70		82	68	43	79	79	14	78	73	19.90	3	2,833	
	9	67	9	54		67	45	15	63	63	7	63	52	19.61	4	4,750	
	10	68	3	63		62	59	52	66	63	16	66	61	12.37	1		
	11	65	6	55	2	60	55	55	61	57	8	61	54	18.87	4	4,750	
	12	60	5	55		50	37	31	60	59	12	60	54	19.05			
	13	63	10	52	1	56	45	21	62	62	11	62	51	15.94	3	2,666	
	14	103	12	90		98	83	41	102	102	20	93	90	13.75	4	6,500	
	15	119	18	96		116	99	48	114	114	13	113	96	19.97	9	3,488	
	16	78	14	62		69	43	24	76	72	18	76	60	24.55	8	4,125	
	17	23	2	20		22	15	5	22	20	4	22	18	20.22	1		
	18	15	4	11		15	12	7	15	15	6	15	10	11.10	3	2,733	
	19	63	17	46		63	45	14	63	61	8	60	44	20.43	7	3,357	
	20	96	1	95		96	96	86	96	96	24	93	94	11.35			
	21	32	7	25		32	22	8	32	32	5	30	25	18.96	2		
22	78		73	4	71	47		74	73	2	74	75	19.77				
23	89		89		89	88	75	89	89	24	86	88	12.39				
24	53	19	34		49	41	13	53	46	9	52	33	21.33	11	2,127		
25	9	5	4		9	9	9	9	9	2	9	4	10.75	4	1,850		
26	6	1	5		6	4		6	6		6	5	19.80				
27	22	2	20		22	19	1	22	22	7	9	19	32.68				
28	22	3	19		22	7		22	22	6	4	19	29.84				
29	28		28		25	17	6	28	28	11	9	27	28.40				
31	1	29	1	28		27	24	23	29	29	7	8	25	26.36			
	3	129	3	126		129	2	1	129	129	11	126	126	27.07			
	4	5		5		5	4	4	5	5		5	29.60				
	5	44	3	41		38	37	37	44	44	15	44	41	23.39	2		
	6	28	4	21	1	26	23	23	25	25	9	25	21	25.04	1		
	7	39	1	37		34	25	20	38	38	10	38	36	19.27			

<sup>1</sup>For renter—occupied dwelling units and vacant nonseasonal not dilapidated units, for rent.  
<sup>2</sup>For owner—occupied dwelling units and vacant nonseasonal not dilapidated units, for sale only.

Table 3.—CHARACTERISTICS OF HOUSING FOR CENSUS TRACTS, BY BLOCKS: 1950—Con.

Census tract	Block	All dwelling units by occupancy and tenure					All dwelling units by condition and plumbing facilities			Occupied dwelling units			Contract monthly rent <sup>1</sup>		Value <sup>2</sup> of one-dwelling-unit structures				
		Total	Owner occupied	Renter occupied	Vacant non-seasonal not dilap., for rent or sale	Other vacant and non-resident	Number reporting	No private bath or dilap.	No running water or dilap.	Total	Persons per room		Occupied by non-white	Number reporting	Average monthly rent (dollars)	Number reporting	Average value (dollars)		
											Number reporting	1.51 or more							
31	8	101	8	82	6	5	93	85	73	90	87	18	90	84	162.22	4	3,750		
	9	48	4	35	8	1	41	17	9	39	39	1	38	39	24.89	1			
	10	46	5	37		4	46	38	32	42	42	1	40	35	33.91	1			
	11	27	2	24	1		27	6	4	26	26		26	25	21.08				
	12	109	4	104		1	108	54	24	108	108	25	106	103	193.39	1			
	13	90	4	86		1	82	71	48	90	88	23	83	85	242.22	1			
	15	56	4	51		1	44	39	26	55	54	11	55	51	231.5	1			
	16	27	7	16		2	21	10	10	25	21	1	19	17	30.23	1			
	17	36	1	34		1	36	32	25	35	34	13	17	32	25.71	4			
	18	47		42	5		46	32	14	42	41	7	16	43	27.41				
	32	1	47	1	46			45	44	44	47	46	20		45	321.3			5,000 3,700 3,500 4,260 3,071 3,760 2,350 4,125 3,200 2,763 2,500 4,785
		4	16		14			14	6	4	15	14		12	12	291.6			
		5	69		62		1	67	54	51	67	67	22	16	61	251.3		2	
		6	11		6		3	9	6	4	8	8		7	6	263.3			
		7	21	5	15		1	20	17	10	20	20	4	12	14	20.00		3	
		8	17	6	11			17	12	9	17	17	2	10	11	15.63		5	
10		6		6			6	6	3	6	6			6	15.50				
11		3		3		1	3	3	3	3	3			3	26.40	2			
12		73	9	59		5	69	68	68	68	68	9	63	57	174.3	5			
14		17	6	11			14	10	5	17	17	4	17	11	16.63	5			
15		28		26			26	26	23	28	28	4	28	22	19.09	1			
16		39	11	27		1	24	23	22	38	38	10	34	25	153.2	7			
17		15		8			15	4	1	15	15	1	1	8	29.25	5			
18		15		8			15	4	1	15	15	1	1	8	29.25				
19		124		124			124	1	1	124	124	8	122	122	26.98				
21		38	10	26		2	36	29	4	36	35	7	36	26	25.65	4			
22		19	7	12			18	17	11	19	19	6	19	11	14.90	4			
23		50	15	35			49	40	17	50	48	9	49	35	18.82	8			
24		92	16	76			87	78	42	92	90	22	86	74	11.81	11			
25		7	4	3			6	4	2	7	7		5	3	13.66	3			
27		14	9	5			14	10	10	14	14	2	13	5	27.80	7			
33		2	75	17	57	1	73	63	41	74	74	13	65	55	17.78	9	2,611 3,142 3,367 3,330 4,845 2,937 4,000 2,688 3,160 2,666 3,725 3,000 3,200		
		3	5	3	2		5	3	3	5	5		5	1					
		4	253	67	184	1	1	243	202	66	251	250	50	238	174	15.41		45	
		5	186	77	107	1	1	185	126	53	184	184	25	163	107	17.29		65	
		7	4	2	2			4	2	2	4	4	1	4	2	14.60		1	
		8	31	15	16			31	18	7	31	31	7	17	17	14.60		1	
	9	57	29	28			56	35	5	57	57	16	14	15	17.71	2			
	10	43	12	31			37	25	10	43	43	11	15	11	16.53	2			
	11	65	28	35		2	65	45	3	63	63	16	21	33	21.33	2			
	12	54	21	32		1	54	46	34	53	53	15	51	30	16.26	17			
	13	74	16	58		1	73	52	22	71	71	15	52	55	23.72	5			
	14	61	20	41		2	54	43	20	59	58	11	14	40	18.59	3			
	15	29	11	18			23	13	7	29	29	6	29	18	29.77	8			
	17	15	6	9			15	9	4	15	15	3	1	9	24.77	3			
	18	19	7	12			17	10	6	19	19	3	3	12	22.16	4			
	19	7	2	5			6	6	1	7	7	4	2	5	22.60	2			
	34	7	16	7	9		16	6	2	16	16		16	8	268.7	5		5,900 2,288 4,653 3,960 2,747 3,670 2,617 3,375 2,721 3,000 4,561	
		8	40	18	19	2	39	30	3	37	37	3	35	21	245.7	17			
9		77	19	58		76	50	37	77	77	10		57	25.77	13				
10		80	14	66		78	43	28	79	79	17		63	32.92	5				
11		63	42	20	1	61	42	26	62	62	11	62	18	23.66	36				
12		63	37	26		63	32	15	61	60	6	43	22	20.40	27				
21		31	5	26		30	27	23	31	29	3	3	22	12.31	2				
22		39	19	20		36	27	19	39	39	7	17	19	16.15	17				
24		6		6		6	6	6	6	6	4	4	6	13.00					
25		63	20	43		60	40	19	63	63	22		38	22.42	12				
26		61	33	28		2	58	39	19	59	59	10	23	21.73	28				
27		24	7	17		3	22	9	6	24	24	4	4	17	18.35	3			
28		259	35	221		3	253	160	81	250	246	45	110	217	25.44	16			
35		1	14	3	11		14	9		14	14	2		9	47.11		3,969 3,657 6,833 4,038 6,253 6,642		
		2	24	7	16	1	24	12	2	23	23	2		13	44.15	2			
		3	18	1	17		17	11	2	18	18	3		16	52.87	1			
	4	3		2		3	2		3	3		1	2	17.50	3				
	5	113	39	74		112	73	27	113	112	26		71	162.5	2				
	6	12		9		12	12	11	12	11	1		8	21.00	7				
	7	18		10		18	11	8	18	18			10	21.00					
	8	40	8	32		40	28	12	40	39	1		39	32.01	3				
	9	49	28	21	1	49	23	13	49	49	55	6	21	21.33	21				
	11	189	110	79		183	72	13	189	187	22	23	75	25.88	88				
	12	17		8		17	6		17	17			8	27.75	7				
	36	1	17	13	4		17	6	1	17	17		8	2		10		3,200	
		2	21	15	6		21	4		21	21	1		5	27.60	12			
3		23	12	11		23	4	1	23	23	2		9	31.66	9				
4		7	4	3		7	7		7	7			3	60.00	1				
5		21	14	3	4	21	4		17	17			2		11	6,545			
6		25	21	4		25	4		25	25	1		3	31.00	19	8,000			

<sup>1</sup>For renter - occupied dwelling units and vacant nonseasonal not dilapidated units, for rent.  
<sup>2</sup>For owner - occupied dwelling units and vacant nonseasonal not dilapidated units, for sale only.

## HOUSING—BLOCK STATISTICS

Table 3.—CHARACTERISTICS OF HOUSING FOR CENSUS TRACTS, BY BLOCKS: 1950—Con.

Census tract	Block	All dwelling units by occupancy and tenure					All dwelling units by condition and plumbing facilities			Occupied dwelling units			Contract monthly rent <sup>1</sup>		Value <sup>2</sup> of one-dwelling-unit structures		
		Total	Owner occupied	Renter occupied	Vacant non-seasonal not dilapidated for rent or sale	Other vacant and non-resident	Number reporting	No private bath or dilap.	No running water or dilap.	Total	Persons per room		Number reporting	Average monthly rent (dollars)	Number reporting	Average value (dollars)	
											Number reporting	1.51 or more					Occupied by non-white
36	7	32	25	7			31	6		32	31		7	33.28	22	6,636	
	8	23	21	2			23	6	2	23	23	1	2		21	5,166	
	9	24	22	2			24	12	1	24	24	2	2		20	3,575	
	10	28	21	5	2		28			26	26		5	70.60	21	7,728	
	11	64	55	6	3		63	2		61	61	2	5	63.60	53	7,737	
	12	36	31	5			36	2		36	36	4	5	64.00	30	6,873	
	13	30	24	5	1		30	2		29	29	3	4	44.50	23	6,691	
	14	29	27	2			29	1		29	29		2		25	7,440	
	15	32	30	1	1		32			31	31		1		30	8,816	
	16	39	30	8	1		38	1		38	37	1	7	57.42	26	8,923	
	17	28	22	5	1		28	2		27	27	1	5	45.00	19	8,605	
	18	36	33	2	1		36	1		35	35		3	72.66	32	7,793	
	19	42	37	5			42	5		42	41	1	5	55.80	33	9,390	
	20	38	30	8			38	6		38	38	1	8	50.62	27	8,911	
	21	37	34	3			37	3		37	37	1	3	47.00	32	8,415	
	22	34	26	2	6		34	2		28	28	1	1		25	8,124	
	23	121	93	23	5		120	22	3	116	116	6	23	45.43	84	6,527	
	24	30	24	5	1		30	2		29	29		4	46.00	21	6,838	
	25	33	24	9			32	8		33	33		8	40.62	20	7,030	
	26	58	46	12			55			58	56	4	10	56.60	37	8,035	
	27	20	18	1	1		20			19	19		1		17	8,123	
	28	40	31	9			39	2		40	40		9	50.11	28	8,135	
	29	27	20	7			26	7	1	27	27	4	6	30.16	15	4,000	
	30	14	10	4			14	4		14	14	3	4	30.25	10	5,020	
	31	25	17	8			25	12	3	25	25	5	8	26.37	14	4,700	
	32	6	5	1			6			6	6		1		5	5,740	
	33	15	15				15	1		15	15	3			15	4,966	
	34	26	19	6	1		26	4	2	25	25		6	39.50	16	6,550	
	35	21	17	4			20	4		21	21		4	73.75	16	9,231	
	36	22	17	5			21	3		22	22		5	46.00	12	8,941	
	37	9	7	2			9	2		9	9		2		6	8,666	
	38	22	22				22			22	22				20	8,340	
	39	30	24	6			30	4		30	30		6	60.83	19	8,463	
	40	33	25	8			33			33	33	1	8	65.00	25	8,640	
	41	60	45	15			60	2		60	60	1	15	60.33	39	8,153	
	42	53	42	10		1	52	11		52	52		9	47.88	31	9,216	
	43	60	52	8			59	7		60	59	1	5	55.80	48	6,614	
	44	30	24	6			30	4	1	30	30	2	5	33.80	21	5,052	
	45	14	9	3	2		14	5	2	12	12		3	35.00	8	6,200	
	46	9	9				9	2	1	9	9	1			8	5,162	
	47	1															
	48	36	27	6	1	2	35	7	3	33	33	2	5	41.40	23	5,369	
	49	23	13	10			23	8	3	23	23	1	10	37.40	8	5,287	
	50	31	25	6			31	5		31	31	5	6	32.16	21	6,238	
	51	8	6	1	1		8	2		7	7		1		6	5,050	
	52	24	13	10	1		24	12		23	23	3	9	26.66	9	5,288	
53	20	11	9			20	6		20	20	1	9	33.33	7	5,942		
54	23	10	12		1	23	5		22	22	2	10	39.20	8	5,147		
55	16	14	2			15	1		16	15		2		14	6,435		
56	15	10	5			15	2		15	15	1	5	40.80	9	6,233		
57	19	12	6	1		19	7		18	18	1	5	43.60	11	5,509		
58	5	3	2			3	1		5	5		2		2			
59	23	16	7			23	4	2	23	23	2	2	46.16	15	6,300		
60	15	11	4			15	2		15	15		1	67.25	7	5,285		
61	21	27	2			27	2		29	28	1	4	76.00	17	7,470		
62	31	14	16		1	30	2		30	30	1	16	64.87	14	8,142		
63	47	29	16	2		45	5		45	45	1	15	38.80	24	6,337		
64	31	23	8			31	1		31	31	2	7	34.85	21	5,219		
65	4	4				4			6	6		2		4	6,750		
66	19	14	4	1		19	2		18	18	1	5	42.66	2			
67	47	23	23	1		46	5		46	46	4	23	34.86	12	6,141		
68	61	29	1	2		61	21		59	59	5	29	34.21	22	6,818		
69	57	34	21		1	55	5		55	55	2	21	40.61	28	4,975		
70	47	30	17			47		1	47	47		17	38.64	26	6,361		
71	40	35	15			40	14	5	40	40	5	14	33.71	18	4,322		
37	1	29	5		1	29	18	8	28	28	5	21	28.23				
	2	12	12			12			12	12				12	8,150		
	3	48	21			48	8		46	46	4	27	64.22	16	8,812		
	4	43	30	2		43	1	1	43	43	1	28	67.00	13	8,292		
	5	53	24			51	32	30	53	53	6	24	30.75	24	5,262		
	6	50	35	14	1	50	6		49	49	1	15	50.53	28	7,675		
	7	15	14			15	1		15	15		1		12	8,100		
	8	44	27	17		44	13	7	44	43	3	16	26.87	24	6,120		
	9	51	26	25		51	23	4	51	51	4	24	47.79	17	5,864		
	10	24	7	17		24	8		24	24	1	16	40.25	3	6,833		
	11	94	38	53		94	23	2	91	91	6	48	33.91	18	3,761		
	12	56	29	27		54	15		56	56	1	25	34.52	20	4,415		
	13	48	33	14	1	48	10		47	47	4	15	70.46	26	5,307		
	14	17	6	11		17	9		17	17	2	10	50.30				
	15	39	24	15		39	16	3	39	39	7	15	25.93	20	3,715		
	16	51	24	26		49	31	19	50	50	10	23	17.73	21	2,366		
	17	47	31	16		46	7		47	47	4	16	27.31	29	4,386		
	18	23	10	13		23	13	1	23	23		11	37.90	4	3,625		
	19	62	25	35	1	61	5		60	60		33	36.87	11	6,790		
	20	30	16	13	1	30	13	4	29	29	4	12	34.25	10	4,930		

<sup>1</sup>For renter-occupied dwelling units and vacant nonseasonal not dilapidated units, for rent.<sup>2</sup>For owner-occupied dwelling units and vacant nonseasonal not dilapidated units, for sale only.



Table 3.—CHARACTERISTICS OF HOUSING FOR CENSUS TRACTS, BY BLOCKS: 1950—Con.

Census tract	Block	All dwelling units by occupancy and tenure					All dwelling units by condition and plumbing facilities			Occupied dwelling units			Contract monthly rent <sup>1</sup>		Value <sup>2</sup> of one-dwelling-unit structures			
		Total	Owner occupied	Renter occupied	Vacant non-seasonal not dilap., for rent or sale	Other vacant and non-resident	Number reporting	No private bath or dilap.	No running water or dilap.	Total	Persons per room		Occupied by non-white	Number reporting	Average monthly rent (dollars)	Number reporting	Average value (dollars)	
											Number reporting	1.51 or more						
37	21	43	20	21		2	42	18	7	41	41	9		21	40.57	15	6,926	
	22	13	8	4		1	13			12	12			3	33.00	6	9,166	
	23	32	8	24			32	7		32	32	3		24	41.08	3	6,333	
	24	40	17	23			40	20	3	40	40		1	23	26.39	13	3,938	
	25	13	8	4	1		13	5		12	12	1		4	42.50	6	3,333	
	26	36	22	14			35	17	1	36	36	5	1 4	14	25.07	19	3,052	
	27	38	15	21		2	36	12	1	36	36	3	2 9	18	23.72	11	4,363	
	28	34	12	22			34	20	16	34	34	4		22	15.40	11	4,818	
	29	53	28	23		2	51	30	3	51	50	8	1 4	23	30.47	18	4,361	
	30	29	5	23	1		28	16	1	28	28	4		24	28.95	3	8,666	
	31	51	12	39			51	11		51	51	5		35	34.51	5	9,000	
38	1	65	43	22			64	26	7	65	63	4		18	41.88	29	6,048	
	2	19	14	5			19	3	1	19	19			5	33.00	13	9,023	
	3	14	10	4			14	4	2	14	14	2		3	45.00	9	4,011	
	4	41	17	23		1	41	18		40	40	2		22	36.27	9	6,033	
	5	48	37	11			48	12	2	48	48			11	42.27	29	6,303	
	6	29	21	8			28	9	2	29	29			8	36.00	19	6,678	
	7	23	14	8	1		22	8		22	22	2		9	48.66	9	8,633	
	8	29	18	11			29	7	1	29	29	3		10	37.60	16	6,468	
	9	12	9	3			12	3		12	12	1		2		6	6,833	
	10	288	14	273	1		285	5	1	287	287	46		271	32.16	10	9,100	
	11	29	17	11	1		29	13	1	28	28	3		10	43.00	10	7,060	
	12	25	17	8			25	3		25	25	1		8	35.12	11	6,363	
	13	21	14	7			21	1		21	21	1		7	38.71	10	6,100	
	14	26	13	12	1		25	4		25	25			13	46.92	8	6,187	
	15	51	40	10	1		50	3	1	50	50	1		11	41.27	36	5,772	
	16	93	56	36		1	91	32	2	92	91	6		36	39.44	39	6,048	
	17	115	86	27	2		108	20	2	113	113	5		27	35.25	74	5,985	
	18	32	26	6			32	8	1	32	31	2		5	29.00	22	6,363	
	19	25	21	4			25	3	1	25	25	2		4	48.25	20	6,885	
	20	29	27	2			29	3		29	29			1		26	6,546	
	21	80	65	15			79	7		80	80	3		14	50.21	61	6,985	
	22	44	33	10		1	43	1		43	43			7	48.71	30	8,610	
	23	34	32	2			32			34	32			2		31	7,187	
	24	43	36	7			42	15	2	43	42	1		6	53.33	28	7,107	
	25	30	23	7			30	2		30	30			6	44.16	20	6,700	
	26	30	26	4			30	6		30	30			2		21	7,095	
	27	39	31	8			38	7	2	39	39	2		7	44.14	27	5,514	
	28	34	16	17	1		34			33	33			16	53.12	17	7,476	
	29	27	23	4			27	2		27	27	2		4	41.00	20	8,175	
	30	11	7	4			11			11	11			4	36.25	7	7,714	
31	27	25	2			27			27	27			2		23	7,439		
32	35	16	18	1		35			34	34	2		17	57.35	17	8,347		
33	35	30	5			35	9	4	35	35			4	38.75	28	5,535		
34	32	22	8		2	32	4	1	30	30	2		8	44.87	22	6,313		
35	32	25	6		1	31	7	2	31	31			5	42.60	22	6,718		
36	31	23	8			30	10	7	31	31	2		6	32.00	23	6,652		
37	34	25	9			34	2	1	34	34			8	67.87	23	7,000		
38	25	19	6			25	6		25	25	3		6	44.16	16	6,356		
39	11	8	3			11			11	11			3	55.00	6	9,500		
39	1	35	11	24		35			35	35	2		23	63.26	11	7,227		
	2	46	26	18	1	46	7	2	44	44			18	54.51	23	6,939		
	3	46	31	14	1	45	12	8	45	45	6		12	40.41	28	7,521		
	4	68	51	17		66	12		68	67	4		14	47.78	37	7,897		
	5	7	5	1	1	7	2		6	6				4		6	8,825	
	6	6	6			6			6	6				4	8.666	6	8,666	
	7	48	45	3		48			48	48				2		45	8,484	
	9	8	8			8			8	8					8	8.125	8	8,125
	10	21	19	2		21	4		21	21				2		17	8,505	
	11	19	19			19			19	19					19		19	8,552
	12	18	13	5			17	3		18	18	1		4	61.00	9	8,088	
	13	12	12			12			12	12					12		12	9,083
	14	35	28	7		35	2		35	33	1			6	49.16	28	7,060	
	15	26	22	4		26	1		26	25				4	49.50	21	7,795	
	16	84	61	21	1	83	20	1	82	80	5			20	34.35	50	5,024	
	17	47	41	6		47	5		47	47				6	55.16	39	6,792	
	18	8	6	2		8	2		8	8				2		5	7,320	
	19	44	29	14		44	10	2	43	42	1			12	31.00	26	7,073	
	20	55	46	8		55	5	1	54	54	1			8	36.62	43	6,820	
	21	52	40	12		52	9	2	52	52	3			12	46.16	35	6,054	
	22	45	37	8		45	3	1	45	45	3			8	37.87	33	6,121	
	23	67	50	15	2	67	13	1	65	65	2			15	37.00	45	6,873	
	24	16	14	2		16	3	1	16	15				1		12	7,139	
	25	20	13	7		20	6		20	20	3			7	27.85	11	5,518	
	26	28	18	10		26	5		28	27	1			10	41.70	15	7,980	
	27	8	5	3		8			8	8				3	34.33	5	6,120	
	28	29	18	11		28	10		29	29	1			11	51.54	13	6,076	
	29	23	20	3		23	1	1	23	23	1			2		19	7,452	
	30	16	14	2		15	1		16	16	2			2		10	6,430	
	31	22	18	4		22	3		22	22				4	26.50	15	6,493	
	32	19	17	2		17	4		19	19	2			2		15	7,033	
33	21	9	10		21	7		19	19	1			9	36.88	6	5,916		

<sup>1</sup>For renter - occupied dwelling units and vacant nonseasonal not dilapidated units, for rent.  
<sup>2</sup>For owner - occupied dwelling units and vacant nonseasonal not dilapidated units, for sale only.

## HOUSING—BLOCK STATISTICS

Table 3.—CHARACTERISTICS OF HOUSING FOR CENSUS TRACTS, BY BLOCKS: 1950—Con.

Census tract	Block	All dwelling units by occupancy and tenure					All dwelling units by condition and plumbing facilities			Occupied dwelling units			Contract monthly rent <sup>1</sup>		Value <sup>2</sup> of one-dwelling-unit structures		
		Total	Owner occupied	Renter occupied	Vacant non-seasonal not dilap., for rent or sale	Other vacant and non-resident	Number reporting	No private bath or dilap.	No running water or dilap.	Total	Persons per room		Number reporting	Average monthly rent (dollars)	Number reporting	Average value (dollars)	
											Number reporting	1.51 or more					Occupied by non-white
39	34	27	20	7					27	26	1		28.00	15	5,280		
	35	1						1									
	36	6	3	3				6	6	1		31.66	2				
	37	23	18	3		1		21	21	1		38.33	16	5,525			
	38	19	17	2				19	19				16	8,853			
	39	29	20	9				28	29				39.88	16	6,800		
	40	27	21	6				27	27	2			32.83	18	6,122		
	41	26	25	1				26	26	1				24	6,522		
	42	26	21	5				25	26					20	6,633		
	43	30	23	7				30	30	1			31.20	20	6,633		
													39.66	16	6,900		
	44	36	17	19				36	36				30.27	10	7,030		
	45	23	17	6				22	23			18	35.50	14	7,428		
	46	25	19	6				23	25			6	30.66	17	5,817		
	47	23	15	8				23	23	1	2		41.57	8	6,350		
	49	20	19	1				20	20	1	1			18	6,022		
	50	21	18	3				21	21	2	1			16	6,022		
	51	5	2	3				5	5	1	1			2	6,081		
	40	1	77	16	58	3		75	27	2	74	72		58	31.58	1	
		2	23	8	15			22	3	1	23	21	1	14	42.92	4	6,500
		3	62	40	21		1	61	24	1	61	61	8	19	35.68	34	5,032
		4	50	42	8			50	9		50	48	2	8	48.87	35	6,165
5		37	17	20			37	10		37	37	1	17	46.17	12	6,333	
6		36	16	20			36	8	1	36	36	1	19	51.57	11	9,211	
7		82	60	22			79	14		82	81	1	22	44.00	46	6,691	
8		51	33	18			50	12	1	51	51	1	18	36.83	24	6,762	
9		71	53	17		1	68	11	1	70	69	1	17	43.17	43	7,346	
10		15	11	4			15	2		15	15		4	67.50	8	7,837	
11		28	23	5			28			28	28	1	5	36.20	19	8,868	
12		83	57	26			83	29	1	83	83	9	26	41.30	42	7,369	
13		84	67	15		1	84	3	1	82	81	4	13	38.84	60	6,411	
14		97	78	18		1	96	9		96	96	3	18	44.66	70	7,325	
15		34	18	16			33			34	34	2	13	52.76	11	9,334	
16		35	23	11		1	34	1		34	34		10	53.90	19	10,894	
17		10	9				9		1	9	9				9	5,422	
18		21	18	3			21	1	1	21	21	1	3	46.33	18	5,877	
41		1	12		12			12	9		12	11	2	12	17.00		
		2	76	38	38			75	21	9	76	76	1	36	37.83	24	5,079
		3	80	23	54		3	79	19	1	77	77	9	53	30.71	12	7,008
		4	53	28	28			53	16		53	53	3	25	34.20	13	5,192
	5	51	24	27			50	7		51	50	1	25	34.88	12	7,491	
	6	38	22	15		1	38	18	7	37	37	3	14	33.00	17	3,447	
	7	50	33	15		2	50	11		48	48	2	14	43.21	24	7,479	
	8	27	16	11			27	2		27	26	1	11	47.81	13	6,407	
	9	26	18	8			26	2		26	26	1	7	46.00	16	10,875	
	10	64	29	34		1	63	20	5	63	62	2	34	37.70	15	6,666	
	11	23	15	8			23	4		23	23		7	40.00	7	8,142	
	12	31	24	7			31	3	1	31	31	2	7	42.28	21	6,614	
	13	23	18	5			23	5	1	23	22		5	31.00	16	6,006	
	14	19	13	6			19	6		19	19	1	6	38.66	10	5,900	
	15	24	20	4			24	2		24	24	1	4	42.50	20	4,415	
	16	6	4	2			6	2		6	6		2		4	4,500	
	17	28	19	9			28	4	1	28	28		9	47.33	12	6,916	
	18	41	19	20		2	40	10		39	39	2	19	47.47	13	7,638	
	19	42	17	17			42	12		42	42		16	33.62	17	6,894	
	20	40	20	20			40	5		40	40		16	50.56	12	8,958	
	21	48	26	22			48	11	1	48	48		22	44.68	15	7,360	
	22	55	24	30		1	55	12	2	54	54	2	30	34.23	17	6,929	
23	26	18	6		2	26	4		24	24		5	53.40	16	7,868		
24	33	17	16			33	4		33	33		16	54.56	13	9,138		
25	33	27	6			33	3		33	33		26	54.73	4	8,325		
26	58	17	41			58	11	1	58	56		39	44.43	8	8,937		
27	30	20	9		1	30	4	1	29	29		9	54.55	16	10,062		
28	33	18	14			32	2	1	32	32		14	67.00	12	9,500		
29	43	30	12		1	43	4		42	42		12	56.83	28	8,432		
30	19	11	8			19			19	19		8	31.75	9	7,566		
31	62	20	40		2	59	1		60	57	1	39	64.30	14	9,757		
32	45	24	21			44			45	45		20	72.25	15	10,466		
33	15	4				14			15	15	1	4	61.75	8	7,312		
34	25	9	16			25			25	23	1	16	66.75	7	6,800		
35	35	26	9			34	1		35	35		9	35.33	23	8,760		
42	1	34	21	12	1	33	8	2	33	33	4	11	42.81	19	6,715		
	2	26	18	7		26	7	2	26	26	3	8	46.50	17	6,358		
	3	28	7	21		28	4	2	28	28	3	21	52.85	6	5,133		
	4	31	27	4		31	4	2	31	30	1	4	30.23	24	7,058		
	5	19	13	6		19	4		19	19	1	6	61.66	8	8,155		
	6	18	12	6		18	4		18	18		6	47.50	8	6,625		
	7	30	17	13		30	2		30	30	2	6	58.46	16	6,643		
	8	29	29			29	1		29	29	1	2	56.55				
	9	32	23	7		2	32	11	6	30	30	1	7	27.28	20	5,165	
	10	27	22	5			27	5	2	27	27	1	5	36.80	21	5,209	
	11	24	19	5			24	4	1	24	24	3	4	37.50	18	5,194	

<sup>1</sup>For renter-occupied dwelling units and vacant nonseasonal not dilapidated units, for rent.<sup>2</sup>For owner-occupied dwelling units and vacant nonseasonal not dilapidated units, for sale only.

Table 3.—CHARACTERISTICS OF HOUSING FOR CENSUS TRACTS, BY BLOCKS: 1950—Con.

Census tract	Block	All dwelling units by occupancy and tenure					All dwelling units by condition and plumbing facilities			Occupied dwelling units			Contract monthly rent <sup>1</sup>		Value <sup>2</sup> of one-dwelling-unit structures			
		Total	Owner occupied	Renter occupied	Vacant non-seasonal not dilap., for rent or sale	Other vacant and non-resident	Number reporting	No private bath or dilap.	No running water or dilap.	Total	Number reporting	Persons per room	Occupied by non-white	Number reporting	Average monthly rent (dollars)	Number reporting	Average value (dollars)	
42	12	18	13	5			18	7	5	18	18			5	23.00	12	5,758	
	13	22	19	3			22	10	1	22	22			3	31.66	16	4,150	
	14	7	6	1			7	2	1	7	7					6	5,616	
	15	1																
	16	11	10	1			11	1	1	11	11					10	8,100	
	17	34	26	6		1	34	6		32	32			5	46.40	24	7,329	
	18	38	23	15			38	9	5	38	38			15	32.33	18	7,844	
	19	167	9	155		2	165	4		164	163			154	64.87	5	7,780	
	20	11	8	3			11	2		11	11			3	36.66	7	9,442	
	21	5	4	1			5			5	5			1		4	8,875	
	22	18	15	3			18	2		18	18			3	46.33	15	8,480	
	43	1	27	17	10			27	7		27	27			10	43.60	12	6,208
		2	26	21	5			26	5		26	26			5	31.20	19	5,536
		3	22	17	4		1	22	2		21	21	1		4	58.75	18	6,894
		4	23	19	4			23	8		23	23			3	31.66	15	6,160
		5	22	13	7		1	22	6		20	20			6	34.50	12	7,375
		6	26	22	4			26	6		26	26			4	50.00	20	6,065
		7	22	13	8		1	22	11	1	21	21	2		8	32.87	12	5,075
		8	15	7	7		1	15	8	2	14	14			7	39.42	5	7,160
		9	8	7	1			8			8	8			1		7	6,328
		10	21	21				21	1		21	21	3				21	6,409
		11	27	21	5		1	27	6		26	26			5	47.00	18	6,766
12		21	14	3		4	21	2		17	17	1		3	57.00	18	6,161	
13		27	22	4		1	27	5	1	26	26	1		5	57.20	22	6,950	
14		24	18	6			24	8		24	24	2		4	41.75	13	6,353	
15		25	18	5		2	25	5		23	23	3		4	61.25	17	6,776	
16		16	10	6			16	4		16	16	1		5	41.00	6	6,416	
17		22	15	7			22	2		22	22	2		7	40.28	10	5,810	
18		9	7	2			9	4	1	9	9			2		7	4,871	
19		75	61	13		1	74	55	11	74	74	14		13	23.46	59	4,162	
20		12	9	2			11			11	11	1		2		8	5,375	
21		22	16	6			22	3		22	22	1		6	43.50	11	6,390	
22		30	25	5			29	11		30	30			5	60.20	22	7,931	
23		13	12	1			13	2		13	13			1		11	6,527	
24		25	15	10			25	5		25	25			10	32.60	12	7,241	
25		34	29	2		3	31	20		31	31	4		2		27	3,914	
26		39	28	10		1	36	26		38	38	2		9	26.55	24	4,033	
27		20	14	4		2	18	6		18	18	2		4	34.50	15	4,206	
28		28	24	4			28	18	3	28	28	2		3	28.00	22	4,368	
29		9	5	4			9	5		9	9			3	29.66	4	4,175	
30		5	4	1			5	2		5	5					4	3,575	
31		5	3	1		1	4			4	4			1		3	6,666	
32		31	18	13			31	9		31	31	4		12	44.50	15	6,400	
44	1	44	39	5			44	1		44	43			4	65.00	35	11,040	
	2	39	33	6			39	2		39	37			6	53.66	26	10,865	
	3	49	35	12		2	48	2		47	44			12	52.08	28	9,839	
	4	73	47	25		1	73	4		72	72			19	58.26	38	13,781	
	5	69	43	25		1	68	4	1	68	68			24	55.75	31	12,735	
	6	29	18	11			29	2		29	29			11	58.45	11	8,718	
	7	49	37	12			49	6		49	49			11	55.58	26	9,723	
	8	53	37	17			53	6		54	54	1		16	40.81	29	10,103	
	9	36	21	15		1	35	10		36	36			12	44.16	17	11,235	
	10	20	15	4		1	19	2		19	19			4	51.25	11	9,609	
	11	20	14	6			20	4		20	20			6	60.50	10	10,800	
	12	53	35	18			52	4		53	50			17	57.05	24	8,387	
	13	40	28	11			39	5		39	39			9	44.77	20	10,120	
	14	38	19	18		1	37	5		37	35			9	50.86	12	12,500	
	15	104	39	63		2	104	4		102	102			62	67.19	28	12,300	
	16	50	36	14			50	2		50	50			14	55.28	33	10,787	
	17	57	37	19			57	4		56	56			20	10,685	30	9,246	
	18	60	45	13		1	58	4		58	58			14	54.64	43	10,130	
	19	57	53	4		1	56	1		57	57			4	63.50	52	8,115	
	20	11	11				11	1	1	11	11	1				11	8,081	
	21	43	39	3		1	43	5		42	40			3	64.00	39	8,043	
	22	37	33	4			37	2		37	37			4	78.25	27	7,888	
	23	21	15	6			20	2		21	21	1		6	41.50	13	7,923	
	24	30	26	4			30	4		30	30	1		3	22.00	21	8,090	
	25	40	37	3			40	2		40	40			2		36	10,513	
	26	50	35	14		1	50	4		49	49			14	73.71	34	10,585	
	27	54	48	6			54	2		54	54	1		4	51.75	45	7,542	
	28	17	17				17			17	16					17	8,070	
	29	24	20	4			24	2		24	24			4	70.00	19	7,331	
	30	19	18	1			19			19	19			1		18	9,650	
	31	30	27	3			30			30	30			3	54.00	25	9,000	
	32	46	40	4		2	46			44	43			3	76.33	39	8,507	
	33	40	35	5			40			40	39			5	45.80	30	9,066	
34	72	44	28			70	2		72	72	1		26	69.15	37	9,264		
35	64	40	23		1	64	7		63	63			23	70.00	29	10,551		
45	1	41	21	20			41	11		41	41			17	48.52	11	7,127	

<sup>1</sup>For renter - occupied dwelling units and vacant nonseasonal not dilapidated units, for rent.  
<sup>2</sup>For owner - occupied dwelling units and vacant nonseasonal not dilapidated units, for sale only.

HOUSING—BLOCK STATISTICS

Table 3.—CHARACTERISTICS OF HOUSING FOR CENSUS TRACTS, BY BLOCKS: 1950—Con.

Census tract	Block	All dwelling units by occupancy and tenure					All dwelling units by condition and plumbing facilities			Occupied dwelling units			Contract monthly rent <sup>1</sup>		Value <sup>2</sup> of one-dwelling-unit structures		
		Total	Owner occupied	Renter occupied	Vacant non-seasonal not dilap. for rent or sale	Other vacant and non-resident	Number reporting	No private bath or dilap.	No running water or dilap.	Total	Persons per room		Number reporting	Average monthly rent (dollars)	Number reporting	Average value (dollars)	
											Number reporting	1.51 or more					Occupied by non-white
45	2	56	46	9		1	55	8		55	55	3		8	51.25	40	6,787
	3	23	18	5			23	6		23	23			5	48.00	14	7,357
	4	19	13	6	1		19	3	1	18	18	1		3	56.66	9	6,633
	5	163	118	42	2	1	158	52	25	160	160	14	1	39	35.43	101	6,173
	6	3	2	1			2	2		3	3			1		2	
	7	21	15	6		1	5	2	1	20	20	5		5	24.80	14	3,157
	8	12	9	3	1		3	2	2	11	11	2		1		9	2,566
	9	13	8	5	1		5	5	5	12	12		7	4	25.00	5	3,060
	10	6	3	3			4	1	1	6	6			3	16.33	3	3,700
	11	10	5	5			4	2	2	10	10	2	8	5	16.80	4	3,000
	12	13	6	7			6	4	4	13	13	2	13	6	11.83	5	1,800
	13	8	4	4			3	1	1	8	8	2		4	13.75	4	5,325
	14	44	33	9	1	1	44	6	2	42	42	4		8	45.12	29	6,113
	15	82	50	31	1	1	81	32	4	81	80	4		18	37.50	30	6,613
	16	16	14	2			16	1	1	16	16			2		14	6,107
	17	17	11	6			17	5	3	17	17	1		5	48.00	10	3,690
	18	13	10	3	1		12	6	4	12	12	4		2		9	3,766
	19	20	16	4		2	20	5	4	18	18	1		2		16	4,975
	20	22	18	4		3	22	2	2	22	22			4	48.25	15	7,433
	21	29	21	4	1	3	29	5	5	25	25	1		2		22	6,750
	22	17	16	1			17	3		17	17	4		1		15	6,780
	23	18	16	2			17	5	2	18	17	3		2		13	5,069
	24	3	2	1			3	1		3	3			1		2	
	46	1	24	20	4			23	2		24	22			4	55.25	17
2		48	28	20			47	5	1	48	48			18	50.11	18	9,138
3		32	22	10			32	1		32	32			10	61.20	19	8,489
4		38	21	10		2	29	3	3	31	30			8	56.62	17	10,258
5		76	47	26	1	2	75	2		73	73			27	48.29	23	9,891
6		72	61	11			72	2		72	72			11	53.72	58	8,837
7		52	50	2			51	2		52	52			2		48	8,912
8		67	43	22	1	3	66	17		65	65	4		22	43.00	31	7,741
9		57	46	8		1	57	5	1	54	54			8	56.37	41	8,019
10		73	63	9		1	73	7	1	72	72	3		6	42.50	55	8,301
11		31	24	7			31	7		31	31			6	43.33	20	6,965
12		17	14	3			17	2		17	17			3	41.66	14	7,992
13		36	29	6	1		35	3	1	35	35			5	63.00	27	11,777
14		39	38	1			39			39	39			1		37	7,400
15		34	22	12			34	5		34	34			11	35.81	20	9,075
16		20	10	10			20	5		20	20	1		9	48.11	3	10,500
17		34	24	10			34	3	1	34	34	1		9	47.33	20	8,090
18		34	24	9		1	34	6	1	33	33	1		9	35.44	22	8,354
19		39	28	11		2	37	3		39	39	2		11	51.27	25	8,660
20		36	19	15		2	36	5		34	34			15	56.60	14	8,300
21		25	24	1			25	2		25	25			1		24	11,241
22		8	5			3	8			5	5					5	10,300
23		33	25	8			32	2		33	33	1		7	39.00	21	7,738
24		46	39	7			45	2		46	45			5	51.60	34	9,126
25	73	42	30		1	73	7		72	72	2		27	46.07	39	12,315	
26	17	7	9		1	15	7	3	16	16	1		7	27.85	6	12,050	
27	36	18	18			36	3		36	36			18	61.33	15	13,133	
28	37	34	3			37	3		37	37			1		33	13,109	
29	21	20	1		1	21	2		20	20					19	13,342	
30	25	25				25			25	25					24	13,420	
31	18	18				18			18	18					18	13,722	
32	25	17	8			25	5		25	25			8	81.75	17	9,941	
33	25	20	5			25	5		25	25			5	85.60	20	7,945	
34	38	23	8	5	2	38	4	4	31	30			7	82.28	28	10,160	
35	37	35	2		2	37	2		37	36			2		34	11,382	
36	59	43	14			57	2	1	57	57			14	64.21	42	11,083	
47	7	26	2	23	1		24	19	14	25	24	3		24	25.29		
	8	4	3	1			4	3	3	4	4			1		1	
	12	13	12	1		1	13	12	12	12	12			12	20.08	1	
	13	23	1	22			23	16	14	23	23	8	1	21	34.57		
	14	5	5				5	1		5	5			5	30.60		
	15	16	3	13			16	7		16	16	1		13	35.53		
	16	9	8	1		1	9	9	9	9	8			3	43.25		
	17	39	5	32	1	1	37	36	29	37	35	5		31	40.06		
	18	30	1	27		2	30	23	23	28	28		2	1	22.96		
	19	22		22			21	12	7	22	21	3		19	30.21		
	20	4		4			3	1		4	4			3	16.00		
	21	1					1			1	1						
	22	9		8		1	9	4	4	8	8	2		8	28.25		
	23	19	1	17		1	18	12	9	18	18	3	1	16	39.56		
	24	2					2			2	2						
	25	4		3			4		2	4	3			1			
	26	14	1	13			13	4	2	14	14	3		11	29.81		
27	15		15			15	13	8	15	15	7	5	15	21.46			
28	20	2	18			13	11	10	20	18	3		18	25.16			
29	12		12			11	3		12	12			12	22.16			
32	18		17		1	17	17	12	17	17	5		17	35.94			
34	7					7	1		7	7			6	32.50			
35	8		8			8	4		8	8			6	35.33			

<sup>1</sup>For renter—occupied dwelling units and vacant nonseasonal not dilapidated units, for rent.  
<sup>2</sup>For owner—occupied dwelling units and vacant nonseasonal not dilapidated units, for sale only.

Table 3.—CHARACTERISTICS OF HOUSING FOR CENSUS TRACTS, BY BLOCKS: 1950—Con.

Census tract	Block	All dwelling units by occupancy and tenure					All dwelling units by condition and plumbing facilities			Occupied dwelling units			Contract monthly rent <sup>1</sup>		Value <sup>2</sup> of one-dwelling-unit structures	
		Total	Owner occupied	Renter occupied	Vacant non-seasonal not dilap., for rent or sale	Other vacant and non-resident	Number reporting	No private bath or dilap.	No running water or dilap.	Total	Persons per room	Occupied by non-white	Number reporting	Average monthly rent (dollars)	Number reporting	Average value (dollars)
47	36	13	2	11		13	6		13	13	1	5	9	20.33		
48	9	8		8		8	8	8	8	8	2	8	7	19.14	2	
	10	51	8	42		49	39	24	50	50	15	26	42	15.11		
	11	19	1	16		17	15	6	17	17	4	16	34.00			
	12	5		5		5	5	5	5	5	5	4	5.80			
	13	18		18		18	18	18	18	18	2	18	36.50			
	14	39	3	31		39	35	29	34	34	4	31	23.59			
	15	43	2	38		43	39	30	40	39	16	12	37.02			
	16	31	3	28		31	18	14	31	30	10	27	27.82			
	17	33	2	26		33	23	22	28	27	8	21	21.09			
	18	58	10	43		57	51	44	53	53	15	43	30.93			
49	21	52	3	49		49	41		52	51	18	14	49	23.18	1	
	22	27		27		22	13		27	27	5	16	27	12.66		
	23	13	1	12		11	9	8	13	12	3	4	12	30.00		
	24															
50	1	40	8	37		34	28	24	39	36	11	12	37	22.62	1	
	2	27	3	23		16	13	10	26	23	2	21	21	35.76		
	3	3	1	2		1	1	1	3	1	1	1	1			
	4	3		3		3	3	3	3	3		2	2			
	5	11		8		10	5	3	8	8	1	2	7	5.77		
	6	10	1	9		9	9	9	10	9	1	10	8	22.50		
	7	19	1	16	1	19	15	13	17	17	1	16	16	12.00		
	8	46	3	42	1	38	26	14	45	42	9	45	41	19.36		
	9	176	10	162	4	171	132	45	172	170	41	151	162	25.67		
	10	2														
	11	35	3	31		32	21	6	34	34	5	2	29	48.62		
	12	27		27		26	26		27	25	2	26	26	49.07		
	13	12		11	1	12	5	4	11	11		11	11	32.09		
	14	5		5		5	5		5	5		5	5	37.80		
	15	89	3	84		72	19	17	87	82	12	22	81	41.83		
16	93	3	90		91	80	2	93	93	38	6	88	33.47			
17	55	15	40		53	33	1	55	54	17	3	39	36.28			
18	47	6	39		46	7	2	45	43	5	1	37	39.37			
19	36	1	35		36	3		36	36	3	3	35	45.88			
20	68	3	60		65	28		63	61	13	1	60	37.80			
51	24	12	1	11		11	3		12	12		1	10	37.00	1	
	25	104	1	102		96	55	34	103	101	19	32	99	35.76		
50	1	1													1	
	2	59	3	52	3	57	44	7	55	53	16	11	51	34.70		
	3	223	3	212	4	211	18	4	215	204	7	7	203	67.05		
	4	151	3	146		132	49		147	134	7		122	77.71		
	5	80	6	71	3	65	57	2	77	75	28	13	73	30.26		
	6	122	3	104	12	107	91	9	107	107	46	10	108	35.45		
	7	163	10	147	4	155	106	30	157	156	42	22	146	25.21		
	8	96	8	83	3	95	44	32	91	91	13	41	85	23.94		
	9	49	1	48		42	14	6	49	49	8	6	48	28.45		
	10	55	3	50	2	53	40	13	53	53	11		48	30.56		
	11															
	12	28	2	26		27	24	3	28	28	13		25	44.44		
	13	141	4	130	6	138	67		134	134	29		121	40.19		
	14	215	25	181	5	203	143	43	206	198	41	17	175	39.04		
	15	279	26	251	2	267	231	2	277	274	46	12	248	38.28		
	16	140	6	124	4	136	118	16	130	130	32		119	40.53		
	17	103	3	87	4	91	53	1	90	89	21		86	41.18		
	18	114	24	88	1	111	84	24	112	111	25		87	38.90		
	19	156	18	133	2	155	116	40	151	151	36	58	132	28.84		
	20	164	29	126	6	164	105	4	155	155	21	50	128	32.81		
51	1	131	15	112	1	124	68	42	127	125	28	11	109	44.10	5	8,800
	2	90	9	81		89	55	1	90	89	12	2	80	42.55		
	3	123	9	113		118	73	2	122	120	13	2	109	42.89		
	4	59	1	57		58	3	1	58	58	3	3	54	61.12		
	5	41	16	25		40	14	4	41	41	7	3	24	40.62		
	6	23	2	21	1	23	18	1	23	22	2	2	22	40.00		
	7	67	11	55		52	28	5	56	55	11	12	44	33.20		
	8	36	13	23		35	19	19	37	35	11	28	42	28.30		
	9	82	12	68	2	82	62	23	80	79	17	15	65	38.46		
	10	93	16	75	1	93	43	22	91	91	9	10	74	36.09		
	11	23	12	11		20	6	1	23	23	1		10	40.10		
	12	106	19	83	4	106	59	1	102	101	8	2	84	40.63		
	13	37	3	30	4	37	13		33	33	6		34	47.52		
	14	142	11	121	8	141	56	4	132	132	14		124	44.07		
	15	149	6	140		140	71	15	146	142	16	7	123	45.07		
	16	53	11	42		47	4		53	48	2		37	51.05		
	17	206	25	173		198	111	11	198	196	20	11	166	46.24		
	18	203	28	166	3	198	99	1	194	189	18	1	166	46.98		
	19	115	11	96	7	115	28		107	106	4		100	52.49		
	20	110	10	91	4	109	35		101	100	10	1	90	64.43		
	21	374	12	343	11	356	27	5	355	322	16		346	80.04		
	22	134	21	106	6	133	46		127	127	9		107	50.50		

<sup>1</sup>For renter - occupied dwelling units and vacant nonseasonal not dilapidated units, for rent.  
<sup>2</sup>For owner - occupied dwelling units and vacant nonseasonal not dilapidated units, for sale only.









Table 3.—CHARACTERISTICS OF HOUSING FOR CENSUS TRACTS, BY BLOCKS: 1950—Con.

Census tract	Block	All dwelling units by occupancy and tenure					All dwelling units by condition and plumbing facilities			Occupied dwelling units				Contract monthly rent <sup>1</sup>		Value <sup>2</sup> of one-dwelling-unit structures	
		Total	Owner occupied	Renter occupied	Vacant non-seasonal not dilap., for rent or sale	Other vacant and non-resident	Number reporting	No private bath or dilap.	No running water or dilap.	Total	Persons per room		Occupied by non-white	Number reporting	Average monthly rent (dollars)	Number reporting	Average value (dollars)
											Number reporting	1.51 or more					
62	3	50	12	38					50	48	9	42	37	22.89	7	3,500	
	4	6							8	8		6	5	20.80	2		
	6	74	1	72	1				73	73	7	73	71	29.08			
	7	66	25	41					66	65	11	64	37	19.35	19	3,347	
	8	47	20	27					47	47	3	37	27	22.77	15	3,640	
	9	51	25	26					51	51	4	22	24	16.83	18	3,705	
	10	172		171					169	162	16	171	170	29.96			
	11	82		82					80	82	3	82	82	30.67			
	12	148	2	145					139	146	38	18	130	24.01			
	13	15	6	9					15	15	8	2	15	19.55	4	6,000	
	14	100	29	70					96	72	41	99	67	17.14	19	4,357	
	15	85	35	50					57	57	19	85	49	21.20	29	3,327	
	16	69	17	50					63	47	7	67	47	21.46	10	1,585.00	
	17	55	31	24					53	22	2	55	42	41.05	24	3,431.2	
	18	90	48	39					86	45	15	87	37	21.97	44	3,097.9	
	19	62	20	40					61	47	26	60	39	15.51	13	3,638	
	20	13	2	11					13	13	11	13	11	20.54			
	21	40	15	23					39	37	8	38	23	19.78	13	2,815	
	22	94	27	65					63	52	27	92	60	16.00	15	4,753	
	23	80	28	52					31	25	19	80	51	14.45	22	3,859	
	24	87	26	58					42	18	10	84	56	18.53	17	4,594	
	25	55	14	37					36	29	26	51	36	14.63	6	5,050	
	26	33	8	25					20	10	4	33	25	16.84	8	5,000	
	27	40	23	17					39	17	1	40	15	21.06	20	3,225	
	28	104	45	58					102	53	14	103	55	24.14	33	3,413.6	
	63	1	118	55	63				94	28	7	118	102	17	33.96	38	3,494
		2	22	2	20				22	15		22	22	2	22.30		
		3	32		32				31	12	9	32	32	6	24.40		
4		35	15	20				35	15		35	35	3	25.05	10	5,120	
5		28	9	18				28	6	2	27	27	1	24.11	7	5,314	
6		23	6	16				23	12	10	22	22	4	19.68	6	4,200	
7		34	19	15				32	12	3	34	33	4	23.69	16	3,687	
8		152	55	95				152	77	28	150	148	23	25.03	36	4,677	
9		13	9	4				12	4		13	13	1	27.25	8	5,275	
10		48	13	34				47	23	5	47	47	7	36.06	7	4,714	
11		43	25	18				43	17		43	43	3	33.88	14	5,085	
12		42	25	16				41	12		41	41	6	29.37	17	5,217	
13		16	12	4				16	16		16	16	4	24.56	9	4,866	
14		29	9	20				29	16		29	29	7	28.36	6	4,666	
15		65	35	28				64	14		63	63	4	34.07	26	5,934	
16		75	51	23				74	10		74	74	8	24.45	42	5,850	
17		36	29	7				36	4	1	36	36	4	38.25	26	6,557	
18		47	31	16				47	4	1	47	47	1	36.31	30	5,200	
19		2															
20		29	14	15				29	4		29	29	1	33.80	13	6,938	
21		100	73	27				100	30	12	100	100	6	27.88	62	4,893	
22		63	31	31				62	18	1	62	62	5	31.40	21	5,900	
23		42	21	14				42	2		42	42	12	28.58	26	4,357	
24		27	18	9				27	5	1	27	27	3	31.44	16	2,912	
25		5	1	4				5			5	5	1	70.00			
26		14	10	4				13	1		14	14	3	30.00			
27		7	7					7			7	7	2		7	5,214	
28		10	10					10	2		10	10	2		10	4,950	
29		8	7	5				8	5	2	7	7	4	25.00	2	7,142	
30		7	7					6			7	6			7		
31		9	6	3				9	1		9	9	3	36.33	5	6,480	
32		4	2	2				4			4	4	2		5		
33		112	79	31				109	28		110	109	5	26.33	65	4,607	
34		30	13	17				30	12	1	30	30	2	20.43	11	4,000	
35		35	11	23				35	14		34	34	4	23.68	17	4,542	
36		34	16	18				34	21	1	34	34	4	22.29	11	4,000	
37		35	14	21				35	17	3	34	34	4	20.80	8	4,175	
38		32	10	21				32	14	3	31	31	5	18.31	5	4,320	
39		64	34	27				64	30	4	61	61	5	22.59	24	4,170	
40		109	74	34				109	38	2	108	108	5	27.48	58	4,006	
41		41	28	13				41	10	2	41	41	3	20.91	21	3,695	
42		29	15	13				28	8		29	29	4	22.00	11	3,923	
43		53	28	24				52	25		52	52	3	22.60	18	3,750	
44		29	13	14				29	11	2	27	27	15	30.86	4	4,400	
45		23	12	11				20	9		23	21	9	21.00	5	3,800	
46		24	11	13				24	13		24	24	1	23.07	2		
64	1	42	14	27			41	12	4	41	41	2	27	22.48	2	6,142	
	2	33	17	16			31	5		33	33	3	16	35.31	14	6,142	
	3	50	29	20			50	13		49	49	4	19	33.10	20	5,230	
	4	28	9	19			28	6		28	28	1	18	39.55	2		
	5	62	24	36			61	23	7	60	60	5	35	40.97	14	9,364	
	6	49	23	23			49	13	3	49	49	2	23	33.60	22	5,577	
	7	58	35	23			58	15	4	58	58	1	22	18.00	27	5,222	
	8	42	22	20			42	22	28	42	42	3	19	29.26	18	3,850	
	9	50	22	27			50	29	15	49	49	1	26	34.57	12	5,083	
	10	48	21	27			47	20	12	48	47	4	25	23.16	15	4,320	
	11	48	17	31			48	16	9	48	48	3	30	34.60	9	5,977	

<sup>1</sup>For renter - occupied dwelling units and vacant nonseasonal not dilapidated units, for rent.  
<sup>2</sup>For owner - occupied dwelling units and vacant nonseasonal not dilapidated units, for sale only.



Table 3.—CHARACTERISTICS OF HOUSING FOR CENSUS TRACTS, BY BLOCKS: 1950—Con.

Table with columns: Census tract, Block, All dwelling units by occupancy and tenure (Total, Owner occupied, Renter occupied, Vacant non-seasonal not dilap., for rent or sale, Other vacant and non-resident), All dwelling units by condition and plumbing facilities (Number reporting, No private bath or dilap., No running water or dilap.), Occupied dwelling units (Total, Persons per room (Number reporting, 1.51 or more), Occupied by non-white), Contract monthly rent (Number reporting, Average monthly rent (dollars)), Value of one-dwelling-unit structures (Number reporting, Average value (dollars)). Rows are categorized by census tracts 68, 69, and 70.

\*For renter - occupied dwelling units and vacant nonseasonal not dilapidated units, for rent.
\*\*For owner - occupied dwelling units and vacant nonseasonal not dilapidated units, for sale only.

HOUSING—BLOCK STATISTICS

Table 3.—CHARACTERISTICS OF HOUSING FOR CENSUS TRACTS, BY BLOCKS: 1950—Con.

Census tract	Block	All dwelling units by occupancy and tenure					All dwelling units by condition and plumbing facilities			Occupied dwelling units			Contract monthly rent <sup>1</sup>		Value <sup>2</sup> of one-dwelling-unit structures	
		Total	Owner occupied	Renter occupied	Vacant non-seasonal not dilap., for rent or sale	Other vacant and non-resident	Number reporting	No private bath or dilap.	No running water or dilap.	Total	Persons per room		Number reporting	Average monthly rent (dollars)	Number reporting	Average value (dollars)
											Number reporting	1.51 or more				
70	28	21	17	4		21			21	21		4	53.25	17	8,564	
	29	23	18	5		23			23	23		4	46.75	17	9,976	
	30	19	17	1		19			18	18		1		17	8,970	
	31	19	18	1		19			19	19		1		17	11,617	
	32	12	8	4		12			12	12		3	60.00	7	12,928	
	33	12	12			12			12	12				12	7,316	
	34	24	22	2		23			24	24	1	2		22	7,022	
	35	34	29	4		34			33	33		4	30.75	27	7,803	
	36	31	28	3		31	1		31	31	3	2		27	8,000	
	37	25	22	2		25		1	24	24		2		22	8,068	
	38	4	4			4			4	4				4	8,500	
	39	4	3			4			4	4				3	8,000	
	40	5	4	1		5			5	5		1		1	8,000	
	41	9	7	2		9			9	9		2		6	8,000	
	42	13	12	1		13		2	13	13		1		11	8,390	
	43	12	12			12			12	12				11	8,381	
71	1	52	39	12	1	52	16	6	51	51	3	9	231.0	33	4,893	
	2	59	37	22		59	12		59	59	1		22	23	5,326	
	3	79	52	25	2	79	8	1	77	77	3	21	307.1	47	6,574	
	4	31	25	6		31	1		31	31		4	48.25	20	8,600	
	5	28	23	5		27			28	27		5	63.00	20	8,495	
	6	18	15	3		18			18	18		3	59.66	12	7,541	
	7	33	24	9		32	3		33	33		8	45.25	20	7,250	
	8	91	63	28		89	19		91	88	1	3	36.28	47	6,665	
	9	13	7	6		13			13	13		6	38.83	5	4,500	
	10	15	11	4		14	1		15	15		3	35.00	10	5,210	
	11	13	6	7		12	1	1	13	12	2	3	39.66	5	3,800	
	12	22	19	3		22			22	22		3	34.66	18	4,805	
	13	86	56	27		85	32	8	83	83	5	25	28.00	52	4,111	
	14	129	84	41		129	20	2	125	125	4	39	29.71	72	5,627	
	15	40	27	13		40			40	40		12	39.50	26	7,873	
	16	105	38	66		104			104	104	2	64	30.56	36	5,730	
	17	47	22	24	1	42	21	5	46	45		20	24.55	16	4,543	
	18	48	21	27		48	14	6	48	48	2	26	29.11	16	5,200	
	19	24	17	7		24	2	1	24	23		4	32.25	14	5,678	
	20	23	18	5		21			23	22		2	26.25	16	5,506	
	21	60	33	25	2	56	2	1	58	56	3	25	45.88	29	6,651	
	22	53	38	14	1	53	12	1	52	52	3	13	42.69	34	4,788	
	23	89	56	33		85	35	4	89	89	20	4	23.25	50	3,424	
	24	79	43	32	4	75	12	2	75	75		33	46.06	16	6,261	
	25	52	24	28		50	5		52	52		33	48.04	13	10,169	
	26	24	8	16		23			24	24		15	62.40	8	14,562	
	27	1														
	28	10	7	9		10	6		10	10		9	66.66	1	5	
	29	7	6			6			6	5		1		6	13,000	
	30	8	6	2	1	8			8	8		1		6	10,333	
	31	45	35	10		45	1	1	45	45		9	103.22	34	9,250	
	32	24	18	6		23	1		24	24		4	72.50	16	10,937	
	33	31	21	10		31	4	2	31	31	1	10	51.90	20	10,500	
	34	39	32	7		38	4		39	39		7	44.42	26	9,942	
	35	38	24	13		36	2		37	35		12	49.75	18	11,000	
72	1	49	19	28	1	47	28	8	47	47	4	3	27	9	5,944	
	2	69	20	49		66	37	2	69	66	4	4	47	9	7,166	
	3	35	6	24		30	16		30	30		2	23	1		
	4	34	7	27		33	11	11	34	32		2	24	4	4,000	
	5	1														
	6	33	18	15		31	25	25	33	33	7	33	13	17	3,735	
	7	47	27	20		46	41	39	47	47	10	46	18	22	3,000	
	10	34	34			33	32	13	34	33	6	34	34	16	16,17	
	11	60	3	56	1	59	20	5	59	59	7	6	55	40	4,092	
	12	53	22	30	1	53	5	1	52	52	2	2	29	18	3,727	
	13	6	3	3		6			6	6		3	29.66	2		
	14	66	28	37		66	30	11	65	64	9	25	36	17	7,264	
	15	9	4	5		9	9		9	8	1	4	4	4	3,250	
	16	18	13	5		17	11	8	18	18	3	10	5	9	3,088	
	17	24	12	11		23	8		23	22	2	10	10	9	3,922	
	18	20	9	11		20	14	10	20	20	7	7	9	6	3,916	
	19	43	20	23		41	21	10	43	43	4	28	21	15	4,066	
	20	2														
	21	17	5	12		16	8		17	17	5	17	11	4	41.75	
	22	34	17	16		34	14		33	33	1	5	15	11	6,609	
	23	80	29	49	1	77	24	3	78	78	8	49	31.08	20	5,075	
	24	40	20	20		40	24		40	40	5	20	25.75	12	3,833	
	25	11	7	4		11			11	11	2	4	33.75	6	4,750	
	26	35	20	15		34	4	1	35	34	1	15	39.40	15	51.60	
	27	19	15	4		19			19	19		4	37.25	14	7,750	
73	1	3	1	2		3	3	3	3	3		2			1	
	2	3		3		3	2	2	3	3						
	4	2				2			2	2						
	6	10	5	4		9	8	4	9	9	3	4	17.50	2		

<sup>1</sup>For renter—occupied dwelling units and vacant nonseasonal not dilapidated units, for rent.  
<sup>2</sup>For owner—occupied dwelling units and vacant nonseasonal not dilapidated units, for sale only.



HOUSING—BLOCK STATISTICS

Table 3.—CHARACTERISTICS OF HOUSING FOR CENSUS TRACTS, BY BLOCKS: 1950—Con.

Census tract	Block	All dwelling units by occupancy and tenure					All dwelling units by condition and plumbing facilities			Occupied dwelling units			Contract monthly rent <sup>1</sup>		Value <sup>2</sup> of one-dwelling-unit structures	
		Total	Owner occupied	Renter occupied	Vacant non-seasonal not dilap., for rent or sale	Other vacant and non-resident	Number reporting	No private bath or dilap.	No running water or dilap.	Total	Persons per room		Number reporting	Average monthly rent (dollars)	Number reporting	Average value (dollars)
											Number reporting	1.51 or more				
76	14	38	31	7					38	38		7	9 4.71	29	12 413	
	15	39	22	16				39	38		16	16	4 8.62	20	12 800	
	16	53	26	26		1		51	52		23	23	5 8.04	23	9 456	
	17	44	33	11				42	43			37	9 9.59	2		
	18	100	50	50		1		99	96			45	7 4.86	41	8 890	
	19	86	51	35				86	85			33	4 4.18	42	10 283	
	20	93	70	23		2		89	90			29	5 4.13	38	9 581	
	21	32	20	11				32	31			11	5 1.09	15	7 766	
	22	14	9	5		1		14	14			5	4 5.80	9	9 000	
	23	6	6					6	6					6	1 6.833	
77	24	94	69	24				94	93			22	5 6.54	50	13 340	
	25	19	17	2				19	18			2	11 7.94	17	13 340	
	26	17	14	3				17	17			2	11 7.94	12	13 000	
	1	4	4					4	4					4	2 6.250	
	2	10	9			1		10	9					10	28 700	
	3	14	14					14	14					14	28 714	
78	4	2						2	2							
	5	4	3	1				4	4					3	2 6.566	
	6	4						4	4					11	12 727	
	7	40	15	25				40	40		1	1	23	7 5.43	11	12 727
	8	20	17	3				19	20				3	6 2.33	14	12 678
	9	31	27	4		1		31	29				2	27	10 759	
	10	21	18	3				20	20					15	9 700	
	11	17	17					17	17					17	27 558	
	12	7	7					7	7					7	2 6.714	
	13	5	4	1				5	5					4	42 750	
	14	8	8					8	8		1	1		8	33 625	
	15	7	7					7	7					7	32 000	
	17	58	37	19		2		56	56				19	53 6.8	33	11 742
	18	51	34	16		1		51	50				16	51 2.5	27	10 944
	19	32	25	6		1		32	31				5	5 6.00	18	10 888
	20	27	22	5				27	26				2	22	11 1.59	
	21	21	17	4		1		20	20				3	51 3.3	13	8 846
22	6	5	1				6	5				1	4	8 4.50		
23	3	2	1				3	3				1	2			
24	8	7	1				8	8				1	6	13 500		
25	55	45	9		1		52	51				7	4 6.85	37	9 591	
26	18	10	8		2		18	18		1		7	4 5.85	7	8 357	
27	51	37	12		2		50	49		1		9	4 7.55	32	9 790	
79	1	21	17	3		1		20	20			3	48 6.6	17	9 800	
	2	34	28	6				34	34			5	6 5.40	27	9 303	
	3	39	36	3				39	39			3	6 1.66	36	11 916	
	4	54	48	4		2		52	50			4	4 7.00	45	12 044	
	5	5	5					5	5					5	9 100	
	6	11	5	6				11	11			6	3 9.16	5	12 500	
	7	26	18	6		2		24	23			4	3 6.75	17	17 088	
	8	18	14	4		2		18	18			3	6 6.00	13	13 138	
	9	92	70	22				92	89			16	4 3.18	48	12 287	
	10	60	42	18				60	60			18	4 1.00	39	8 1.71	
	11	14	12	2				14	14			2		11	8 4.09	
	12	32	22	10				32	32			1		21	9 333	
	13	39	33	6				39	38			1		31	11 829	
	14	18	16	2				18	18					16	11 718	
	15	17	16	1				17	17					14	10 592	
80	1	49	22	27				49	49			26	4 8.23	10	8 670	
	2	74	34	39		1		73	73			37	4 1.94	18	10 555	
	3	15	8	7				14	14		1		5	6 2.00		
	4	76	39	37		1		74	73			33	6 1.27	30	9 280	
	5	169	91	77		1		165	162		2	2	67	4 6.61	65	9 041
	6	129	64	64				127	126			33	4 3.04	48	7 604	
	7	101	61	39				100	100			39	4 0.33	46	7 510	
	8	56	34	22				54	54			21	4 2.71	22	10 681	
	9	12	5	7				12	11			5	3 2.20	2		
	10	64	27	35		2		63	62			1		32	5 0.96	
	11	27	14	11		2		27	25				10	6 2.00	10	14 500
	12	93	50	40		2		93	90			38	4 8.31	40	8 892	
	13	14	12	2				14	14					7	11 285	
	14	33	29	4				33	33				2	3	5 7.33	
	15	24	18	6				24	22				5	7 8.00	26	12 884
	16	11	7	4				11	10				4	4 1.00	14	12 785

<sup>1</sup>For renter—occupied dwelling units and vacant nonseasonal not dilapidated units, for rent.  
<sup>2</sup>For owner—occupied dwelling units and vacant nonseasonal not dilapidated units, for sale only.



HOUSING—BLOCK STATISTICS

Table 3.—CHARACTERISTICS OF HOUSING FOR CENSUS TRACTS, BY BLOCKS: 1950—Con.

Census tract	Block	All dwelling units by occupancy and tenure					All dwelling units by condition and plumbing facilities			Occupied dwelling units			Contract monthly rent <sup>1</sup>		Value <sup>2</sup> of one-dwelling-unit structures	
		Total	Owner occupied	Renter occupied	Vacant non-seasonal not dilap., for rent or sale	Other vacant and non-resident	Number reporting	No private bath or dilap.	No running water or dilap.	Total	Persons per room		Number reporting	Average monthly rent (dollars)	Number reporting	Average value (dollars)
											Number reporting	1.51 or more				
83	1	42	14	28					42	41		27	45.77	6	8,383	
	2	57	13	42	2				55	54		44	70.72	8	7,950	
	3	48	21	25		1			46	46	1	26	42.57	10	8,030	
	4	55	26	28		1			55	54		26	56.03	18	9,611	
	5	3	2	1					3	3		1		1		
	6	36	32	4					36	35		3	44.33	29	11,355	
	7	81	57	24					79	80		22	65.95	50	13,640	
	8	75	38	34		2			73	72	3	35	44.20	29	10,310	
	9	33	19	14					33	33		13	55.23	18	13,305	
	10	34	19	14	1				33	32		13	48.76	13	18,046	
	11	22	18	4					22	21		4	38.50	15	11,766	
	12	25	22	3					25	25		3	58.66	21	15,095	
	13	86	59	27					83	85		27	66.48	56	22,723	
	15	78	47	30		1			75	77	1	28	61.96	37	19,567	
	16	18	11	4		3			18	15		4	15.62	10	22,500	
	17	30	25	5					30	30		5	64.00	21	24,380	
	18	23	22	1					22	23		1		22	25,772	
	19	11	10	1					11	11		1		8	24,812	
	20	2														
	24	61	43	17	1				61	60	1	17	50.05	36	15,486	
	25	91	48	39	3	1			89	85	1	39	54.76	31	9,183	
	26	76	52	23		1			75	72	2	22	57.40	43	9,725	
	27	34	17	16		1			34	33	1	16	58.50	13	9,161	
	28	27	18	9					27	27	2	6	43.16	13	9,630	
	29	46	40	5		1			46	45	1	5	62.20	37	11,537	
	30	59	12	46	1				56	57		46	75.71	8	14,625	
	84	1	7	1	6				7	7		6	45.00	1		
		2	45	12	31	2			41	40	1	28	54.39	7	13,571	
		4	63	34	28	1			61	61	1	29	65.51	29	14,631	
		5	26	20	6				26	26		6	55.66	16	10,156	
6		17	15	3		1			17	16		3	43.00	12	8,166	
7		23	18	5					23	23		5	32.60	17	9,794	
8		49	32	17					48	49		15	40.93	27	7,296	
9		16	16						16	16		6	40.93	9	8,444	
10		84	45	36		3			84	81	1	31	46.12	41	9,207	
11		44	27	17					44	43		15	43.20	25	6,820	
12		42	32	10					42	42	1	9	50.88	27	8,225	
13		40	24	15		1			39	39	1	14	43.57	22	9,840	
14		26	22	3					26	25		3		22	10,118	
15		36	24	12		1			36	36		11	48.90	19	8,778	
16		35	31	4					35	35	1	11	50.00	30	9,150	
17		56	28	28					56	56		28	51.73	22	8,322	
18		28	26	2					28	28	1	28	42.3	24	8,479	
19		32	29	3					31	32		2	65.00	25	9,980	
20		21	18	3					21	21		2		16	11,125	
21		11	8	3					11	11	1	2		6	8,583	
22		16	8	8					16	16		8	34.75	8	10,125	
23		10	9	1					10	10		8		8	9,187	
24		21	18	3					21	21		1		17	10,470	
25		24	20	4					24	24		4	64.50	19	10,894	
26		40	12	28					38	40	1	27	59.85	9	11,200	
27		66	40	24		2			65	64	2	23	42.22	33	8,651	
28		40	31	9					39	40		9	52.11	24	8,841	
29		78	42	36					68	78	1	36	46.88	28	8,335	
30		75	42	33					64	75		33	52.57	23	13,747	
31		79	50	28		1			78	77	1	29	53.68	42	8,492	
32		28	16	9		2			26	24		11	56.90	12	11,375	
33	102	61	39		2			100	98	1	37	59.02	52	11,000		
34	102	71	31					101	101	1	30	45.13	64	9,820		
35	93	69	24					92	92		20	54.80	56	10,957		
85	1	94	42	49	1	2		91	88		46	95.21	28	16,964		
	2	45	18	27				44	45	1	25	57.32	10	9,200		
	3	158	94	59	1	4		153	152	1	56	65.55	69	12,656		
	4	33	23	10				33	33		9	83.33	22	19,027		
	5	39	19	20				38	38		1	96.27	16	19,531		
	6	30	25	5				29	30		4	78.75	20	13,750		
	7	62	32	28		2		60	60		24	72.16	27	13,481		
	8	61	34	34				59	59		33	51.60	12	12,375		
	9	57	21	32	2	2		51	53	2	29	55.37	4	12,125		
	10	96	20	75		1		89	95		74	116.83	7	10,142		
	11	13	13					13	13				12	14,833		
	12	38	11	26		1		37	37		25	80.64	9	27,444		
	13	25	21	4				24	25		3	87.66	16	20,093		
	14	39	21	18				37	39	1	15	62.93	15	10,120		
	15	41	20	19		2		39	39		16	61.50	14	9,214		
	16	22	12	10				22	22		8	44.25	11	9,454		
	17	66	25	39		2		59	64	2	35	51.17	18	11,927		
	18	6	5					6	6				5	28,600		
	19	23	21	1		1		23	22				21	27,547		
	20	17	15			2		15	15				15	29,533		
86	1	9	8	1				9	9		1		8	17,750		

<sup>1</sup>For renter-occupied dwelling units and vacant nonseasonal not dilapidated units, for rent.  
<sup>2</sup>For owner-occupied dwelling units and vacant nonseasonal not dilapidated units, for sale only.



Table 3.—CHARACTERISTICS OF HOUSING FOR CENSUS TRACTS, BY BLOCKS: 1950—Con.

Census tract	Block	All dwelling units by occupancy and tenure					All dwelling units by condition and plumbing facilities			Occupied dwelling units			Contract monthly rent <sup>1</sup>		Value <sup>2</sup> of one-dwelling-unit structures			
		Total	Owner occupied	Renter occupied	Vacant non-seasonal not dilap., for rent or sale	Other vacant and non-resident	Number reporting	No private bath or dilap.	No. running water or dilap.	Total	Persons per room		Number reporting	Average monthly rent (dollars)	Number reporting	Average value (dollars)		
											Number reporting	1.51 or more					Occupied by non-white	
86	2	18	18			18			18	18				18	21,222			
	3	1																
	4	12	12			12			12	12				12	21,958			
	5	7	5			7			7	7				5	20,400			
	6	60	48	9	1	2	60	37	1	57	55	1	1	7	78.71	6,000		
	8	17	16	1			17			17	17			15	21,566			
	9	6	6				6			6	6			6	25,166			
	10	19	18	1			18			19	19			17	14,647			
	11	32	29	3			32			32	32			28	17,214			
	12	11	8	3			11			11	11	1	2	6	29,833			
	13	7	6	1			6			7	7			5	28,000			
	14	2	2				2			2	2			2	2			
	15	6	5	1			5			5	5			2	2			
	17	5	4	1			4			5	5			2	2			
	18	3	1	1			3			2	2			1	1			
	87	1	180	36	143		1	171			179	176	5	1	140	31.77	35	18,071
		2	18	16	1			17			17	17			15	15,633		
		3	7	7				7			7	7			7	23,285		
4		17	17				17			17	17			17	33,205			
5		32	26	4	1	1	27			30	25			23	40,869			
6		7	7				7			7	7			6	37,916			
7		14	13	1			13			14	14			13	33,846			
8		1					1			1	1			1	34,230			
9		17	15	2			17	1	1	17	16			13	34,230			
11		20	20				20			20	20	1		17	27,294			
12		21	20	1			21			21	21			19	27,500			
13		12	12				11			12	11			11	31,500			
14		91	81	7	3		87			88	87			7	76.28	75	24,253	
15		11	10	1			10			11	10			9	21,555			
16		10	10				10		1	10	9			9	24,888			
17		25	24	1			25			25	24			22	21,818			
18		19	17	2			19			19	19			17	14,176			
19		11	11				11			11	11			11	14,681			
20		4	4				4			4	4			4	15,250			
21		5	5				5			5	5	1		5	12,400			
22		1					1			1	1			1	10,310			
24		11	10	1			11			11	11			10	10,310			
25		39	39				39			39	39			38	12,473			
26		501	1	499	1		498			500	499	17		498	35.42			
88		1	43	39	3	1	43			42	41				36	31,269		
		2	17	16	1		17			17	17				16	28,812		
	3	64	32	32		61			64	62			26	27	24,685			
	4	10	9	1		10			10	10			1	9	17,777			
	5	15	9	6		14			15	15				6	51,500			
	6	25	10	15		25			25	24				14	77,78			
	7	57	41	16		57			57	57				16	89,75			
	8	24	10	12	1	1	22			22	22			9	54,11			
	9	32	21	11		32			32	32				10	56,30			
	10	70	40	30		70	1	1	70	70	70	2	1	27	66,44			
	11	38	33	5		36			38	38				3	65,33			
	12	33	6	27		33			33	33				25	78,88			
	13	36	10	25		34			35	35				25	84,92			
	14	92	15	77		91		2	92	91				77	66,68			
	15	44	22	22		42			44	42				21	83,90			
	16	43	11	30	2	43			41	41				30	80,23			
	17	25	25			24			25	25				24	21,470			
	18	2	2			2			2	2				2	18,375			
	19	19	12	6	1	19			18	18				6	63,00			
	20	22	22			22			22	22				22	22,718			
	22	4	4			4			4	4				3	25,333			
	23	6	6			6			6	6				5	28,800			
	24	7	7			7			7	7				7	29,142			
	25	24	20	4		24	1	1	24	24				3	100.00			
	27	19	18	1		19			19	19				17	28,831			
	28	15	10	4		15	1	1	14	14				10	28,882			
	29	9	7	2		9			9	9				6	33,200			
	30	7	6	1		7			7	7				6	22,750			
	31	19	17	2		19			19	19				1	21,250			
	32	50	35	15		50			48	48				15	15,433			
	33													33	12,666			
	34	74	38	36		73			74	73				36	53,38			
	35	29	27	2		29			29	29				28	34			
	36	27	19	8		27			27	27				8	64,37			
	37	41	30	11		41			41	41				6	48,56			
	38	46	30	16		44			46	46				14	64,50			
	39	23	11	12	2	23	3	1	22	22				14	69,31			
	40	8	6	2		8			8	8				10	67,70			
	41	27	22	5		27			27	27				5	8,500			
	42	28	24	4		28			28	28				10	9,790			
	43	4	4			4			4	4				5	78,00			
	44	13	13			13			13	13				2	11,047			

<sup>1</sup>For renter - occupied dwelling units and vacant nonseasonal not dilapidated units, for rent.  
<sup>2</sup>For owner - occupied dwelling units and vacant nonseasonal not dilapidated units, for sale only.

HOUSING—BLOCK STATISTICS

Table 3.—CHARACTERISTICS OF HOUSING FOR CENSUS TRACTS, BY BLOCKS: 1950—Con.

Census tract	Block	All dwelling units by occupancy and tenure					All dwelling units by condition and plumbing facilities			Occupied dwelling units			Contract monthly rent <sup>1</sup>		Value <sup>2</sup> of one-dwelling-unit structures		
		Total	Owner occupied	Renter occupied	Vacant non-seasonal not dilap., for rent or sale	Other vacant and non-resident	Number reporting	No private bath or dilap.	No running water or dilap.	Total	Persons per room		Occupied by non-white	Number reporting	Average monthly rent (dollars)	Number reporting	Average value (dollars)
											Number reporting	1.51 or more					
89	1	29	13	16					29	29			16	57.75	11	9,590	
	2	68	55	13					68	68	1		12	52.50	52	10,819	
	3	10	10						10	10					10	12,300	
	4	16	11	3	2			5	14	14			5	47.40	10	10,700	
	5	20	14	6					20	20			6	57.50	9	11,944	
	6	16	13	3				2	16	16	1		2		12	14,208	
	7	23	21	2					23	23			2		21	11,761	
	8	49	34	15					49	49			15	54.53	28	13,282	
	9	35	29	6					35	35			5	57.80	24	13,270	
	10	9	9						9	9					9	13,555	
	11	38	32	6					38	38			6	58.66	31	11,283	
	12	29	27	2					29	29			2		25	12,620	
	13	24	21	2		1			23	22			2		19	12,052	
	14	70	56	14				2	69	70		1	12	70.83	48	16,281	
	15	46	40	6					46	45		1	6	47.83	36	14,388	
	16	13	12	1					13	13			1		11	14,136	
	17	41	31	9		1			41	40			6	62.33	24	13,604	
	18	22	13	8		1			21	21			6	58.50	9	9,555	
	19	36	24	12				1	36	36		1	10	54.80	14	8,178	
	20	38	29	9					38	37			3	61.00	25	13,840	
	21	34	30	4					33	33			3	99.00	28	14,178	
	22	36	33	2		1			34	35			2		31	18,580	
	23	3	3						3	3					3	16,666	
	25	18	17	1					17	18		1	1		17	17,264	
	26	55	49	5		1			54	54			5	59.60	49	15,687	
	27	28	25	3					28	28			1		25	12,172	
	28	37	32	4		1			35	34			3	56.66	31	15,693	
	29	37	32	4		1			35	34			3	69.00	30	14,283	
	30	64	50	12		1			60	60		10	12	63.75	39	13,515	
	31	36	23	11		2			36	34		7	10	37.30	16	9,125	
	32	15	11	4					14	14			3	35.66	7	8,214	
	33	8	5	3					8	8			3	68.00	4	9,750	
	34	7	7						7	7					7	11,071	
	35	25	23	2					25	25			1		22	9,590	
	36	19	15	4				3	19	19			4	43.75	13	10,546	
	37	9	8	1					9	9			1		7	9,642	
	38	45	41	3		1			44	44			3	47.66	39	14,684	
	39	18	14	4					18	18			3	55.00	10	12,000	
	40	43	31	11		1			42	41		1	10	52.80	29	12,368	
	41	22	18	4				1	20	22		1	1		16	12,256	
	42	18	10	6		2			18	16			6	38.00	10	12,000	
	43	10	7	3					10	10			2		7	9,571	
	44	28	19	8		1			28	26			7	50.57	17	10,294	
	45	9	7	2					9	9			2		6	10,500	
	46	18	17	1					17	17					15	12,653	
	47	53	39	14				3	53	53			11	53.54	37	13,067	
	48	11	9	2					11	11			1		8	13,500	
	49	22	19	3					21	22			3	50.00	16	13,393	
	50	26	23	2		1			25	25			1		24	13,341	
	51	16	16	1		1			17	16			1		12	16,083	
	52	7	7						7	7					7	17,000	
	53	2															
90	1	27	24	2		1			27	26			2		25	9,040	
	2	24	22	2		1			24	24			2		19	9,368	
	3	29	26	2		1			29	28			3		22	9,413	
	4	37	32	4		1			36	35			2	53.66	26	9,684	
	5	43	38	5					43	42		1	4	50.25	29	9,479	
	6	37	35	2					37	37			1		33	9,327	
	8	135		134		1			134	133			134	8620			
	9	106		103		3			106	103		1	104	8647			
	10	34		33		1			34	33			34	7758			
	11	19		17		2			18	16			18	7750			
	12	13	13						13	13					13	12,538	
	13	16	16						16	16					16	12,843	
	14	16	15	1					16	16			1		15	15,473	
	15	12	12						12	12					12	12,583	
	16	186	72	113		1			185	185		7	111	61.06	65	6,240	
	17	23	21	2					23	23			2		19	6,242	
	18	38	38						38	38		1	1		37	6,805	
	19	40	36	3					39	38			3	48.33	33	9,384	
	20	28	22	5		1			27	26			3		22	9,150	
	21	36	29	6		1			36	35		2	6	63.16	28	6,735	
	22	21	19	2					21	21			2		18	5,850	
	23	97	84	13					95	97		5	13	43.15	78	6,908	
	24	37	33	3		1			36	36			3	37.66	30	7,013	
	25	6	5	1					6	6			1		5	6,900	
	26	35	29	5		1			35	34			6	57.83	24	6,933	
	27	1															
	28	8	8						8	8					8	12,875	
	29	7	7						7	7					7	6,428	
	30	38	36	2					38	38		1	1		34	6,641	
	31	21	20	1					21	21		1	1		19	9,136	
	32	21	20	1					21	21			1		20	8,460	
	33	20	17	3				4	20	19			3	54.33	15	8,866	

<sup>1</sup>For renter - occupied dwelling units and vacant nonseasonal not dilapidated units, for rent.  
<sup>2</sup>For owner - occupied dwelling units and vacant nonseasonal not dilapidated units, for sale only.

Table 3.—CHARACTERISTICS OF HOUSING FOR CENSUS TRACTS, BY BLOCKS: 1950—Con.

Census tract	Block	All dwelling units by occupancy and tenure					All dwelling units by condition and plumbing facilities			Occupied dwelling units			Contract monthly rent <sup>1</sup>		Value <sup>2</sup> of one-dwelling-unit structures		
		Total	Owner occupied	Renter occupied	Vacant non-seasonal not dilap., for rent or sale	Other vacant and non-resident	Number reporting	No private bath or dilap.	No running water or dilap.	Total	Persons per room		Occupied by non-white	Number reporting	Average monthly rent (dollars)	Number reporting	Average value (dollars)
											Number reporting	1.51 or more					
90	34	15	15						15	14						14	10.428
	35	31	28	3					31	30					28	28	6.635
	36	15	13	2					15	15			2		13	13	6.653
	37	22	19	2	1			1	1	22	21	1		2	17	17	10.652
	39	25	23			1			25	23					23	23	10.195
	40	6	6						6	6					6	6	10.833
	41	80	9	68	2	1			77	77	1			68	61.10	1	
	42	177	1	171	3	5			176	171				166	64.04		
	43	31	26	3	1	1			29	29				3	76.00	26	10.226
	44	14	12	1					13	13						11	12.072
	45	44	44						44	44						43	10.313

<sup>1</sup>For renter - occupied dwelling units and vacant nonseasonal not dilapidated units, for rent.  
<sup>2</sup>For owner - occupied dwelling units and vacant nonseasonal not dilapidated units, for sale only.

LOUISVILLE, KENTUCKY, BY CENSUS TRACTS: 1950  
KEY MAP

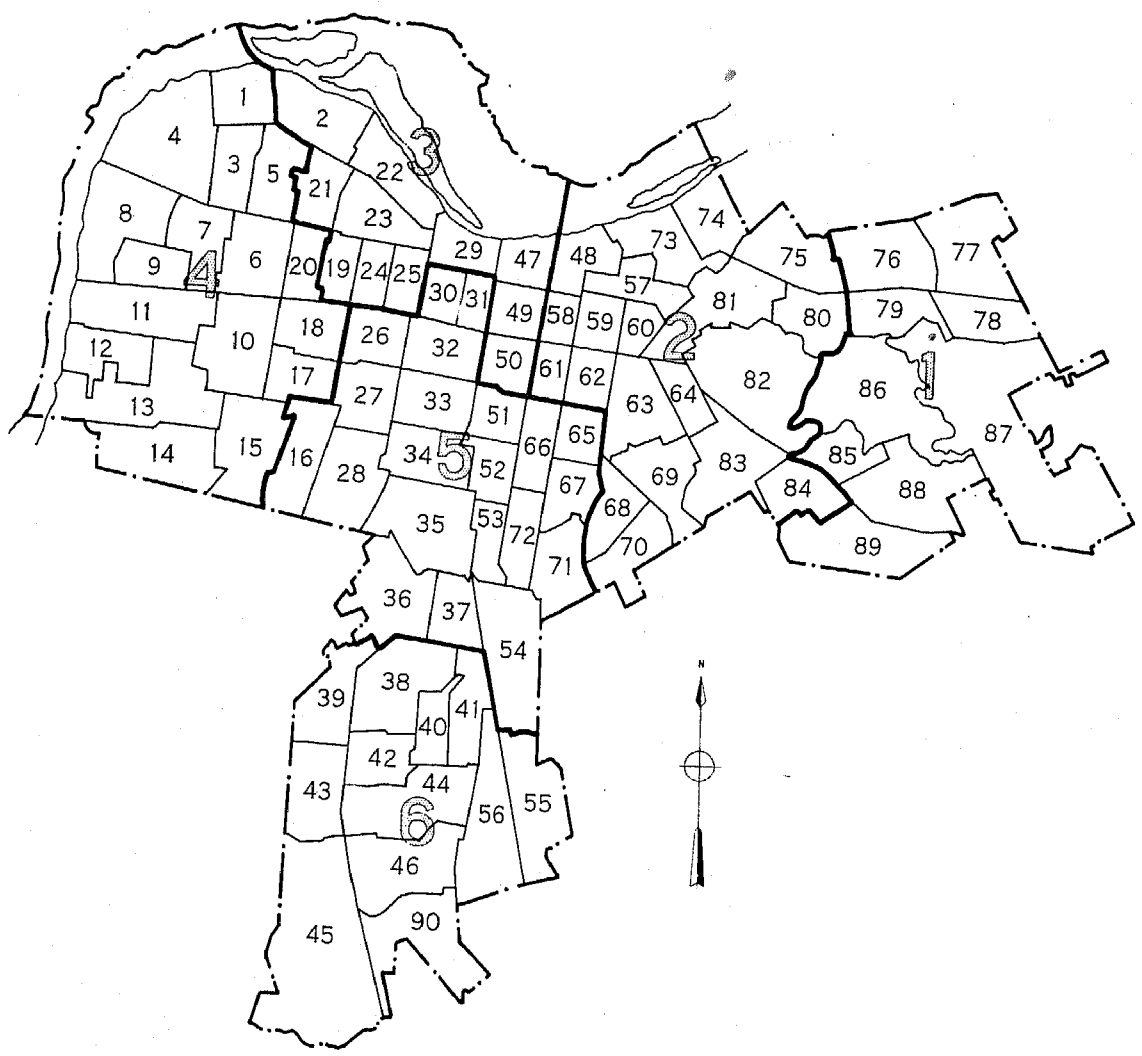

LEGEND  
TRACT NUMBER 9  
PART NUMBER 1

# LOUISVILLE, KENTUCKY, BY CENSUS TRACTS AND BLOCKS: 1950

PART I OF 6 PARTS

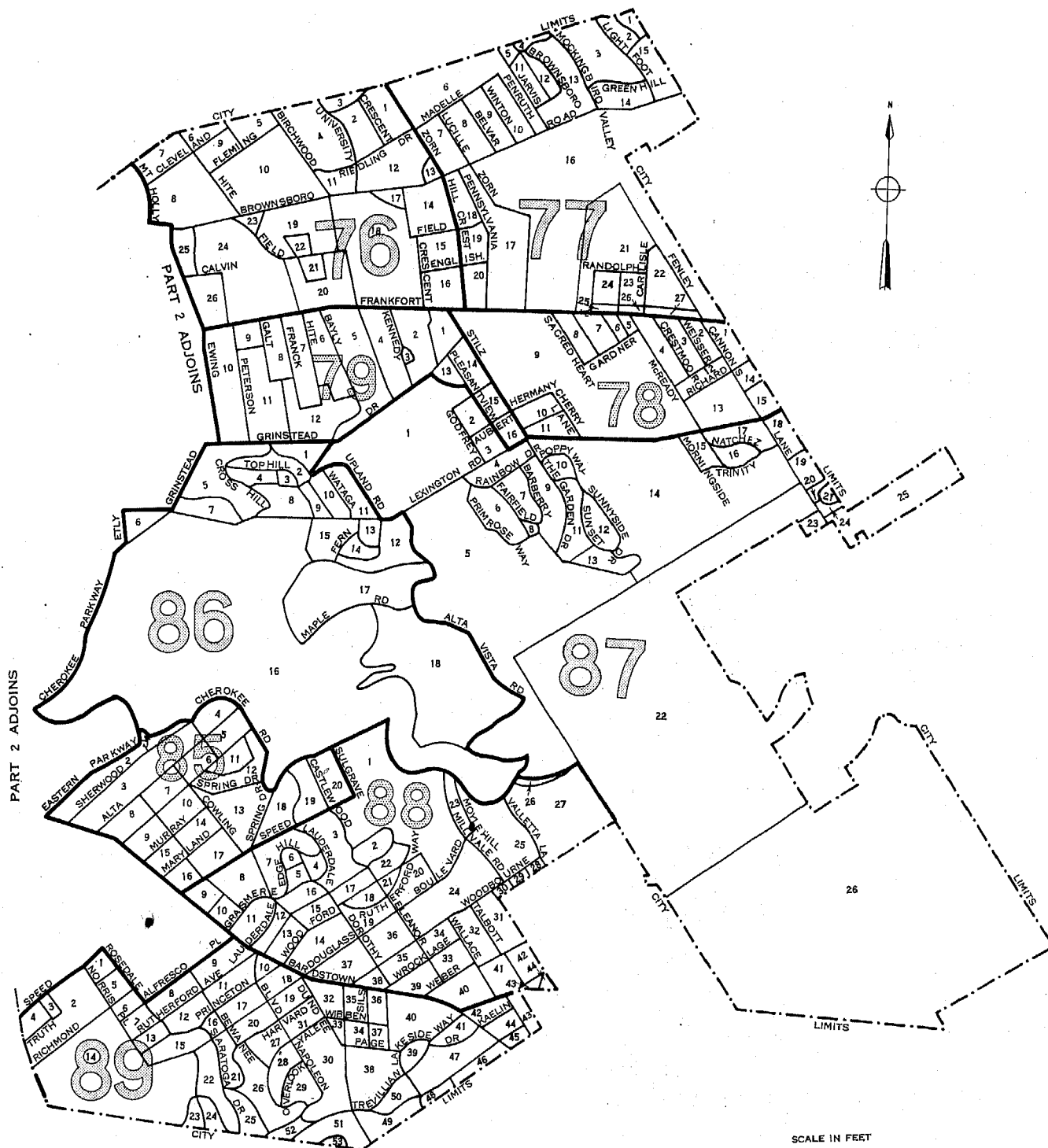

PART 2 ADJOINS

SCALE IN FEET  
0 1000 2000 3000

LEGEND

BLOCK NUMBERS  
TRACT NUMBERS  
TRACT BOUNDARIES  
U.S. DEPARTMENT OF COMMERCE. BUREAU OF THE CENSUS

# LOUISVILLE, KENTUCKY, BY CENSUS TRACTS AND BLOCKS: 1950

PART 2 OF 6 PARTS

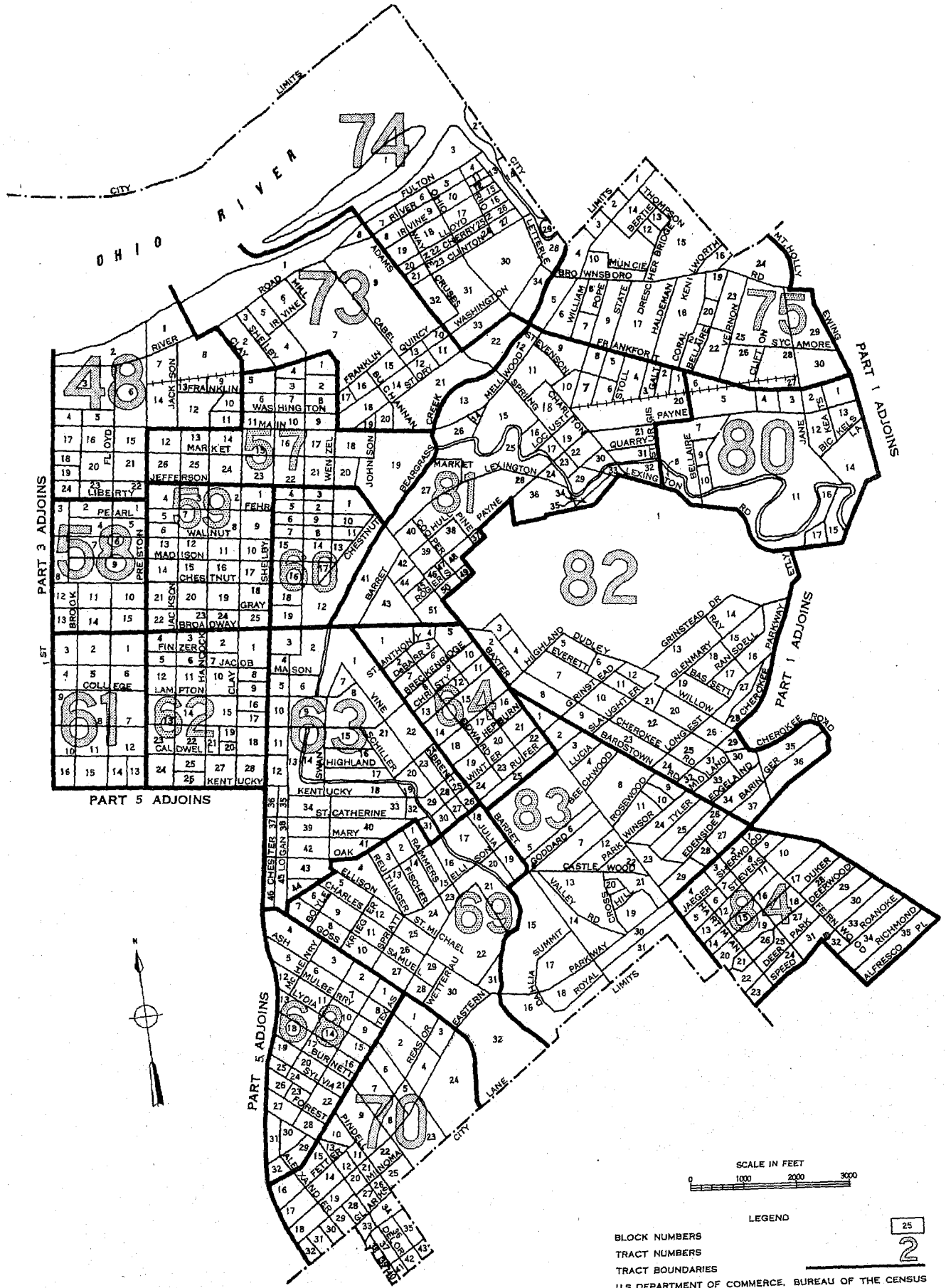

# LOUISVILLE, KENTUCKY, BY CENSUS TRACTS AND BLOCKS: 1950

PART 3 OF 6 PARTS

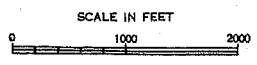

LEGEND

BLOCK NUMBERS  
 TRACT NUMBERS  
 TRACT BOUNDARIES  
 U.S. DEPARTMENT OF COMMERCE, BUREAU OF THE CENSUS

# LOUISVILLE, KENTUCKY, BY CENSUS TRACTS AND BLOCKS: 1950

PART 4 OF 6 PARTS



LEGEND

25  
2

BLOCK NUMBERS  
 TRACT NUMBERS  
 TRACT BOUNDARIES  
 U.S. DEPARTMENT OF COMMERCE, BUREAU OF THE CENSUS



# LOUISVILLE, KENTUCKY, BY CENSUS TRACTS AND BLOCKS: 1950

PART 5 OF 6 PARTS

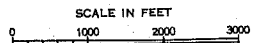
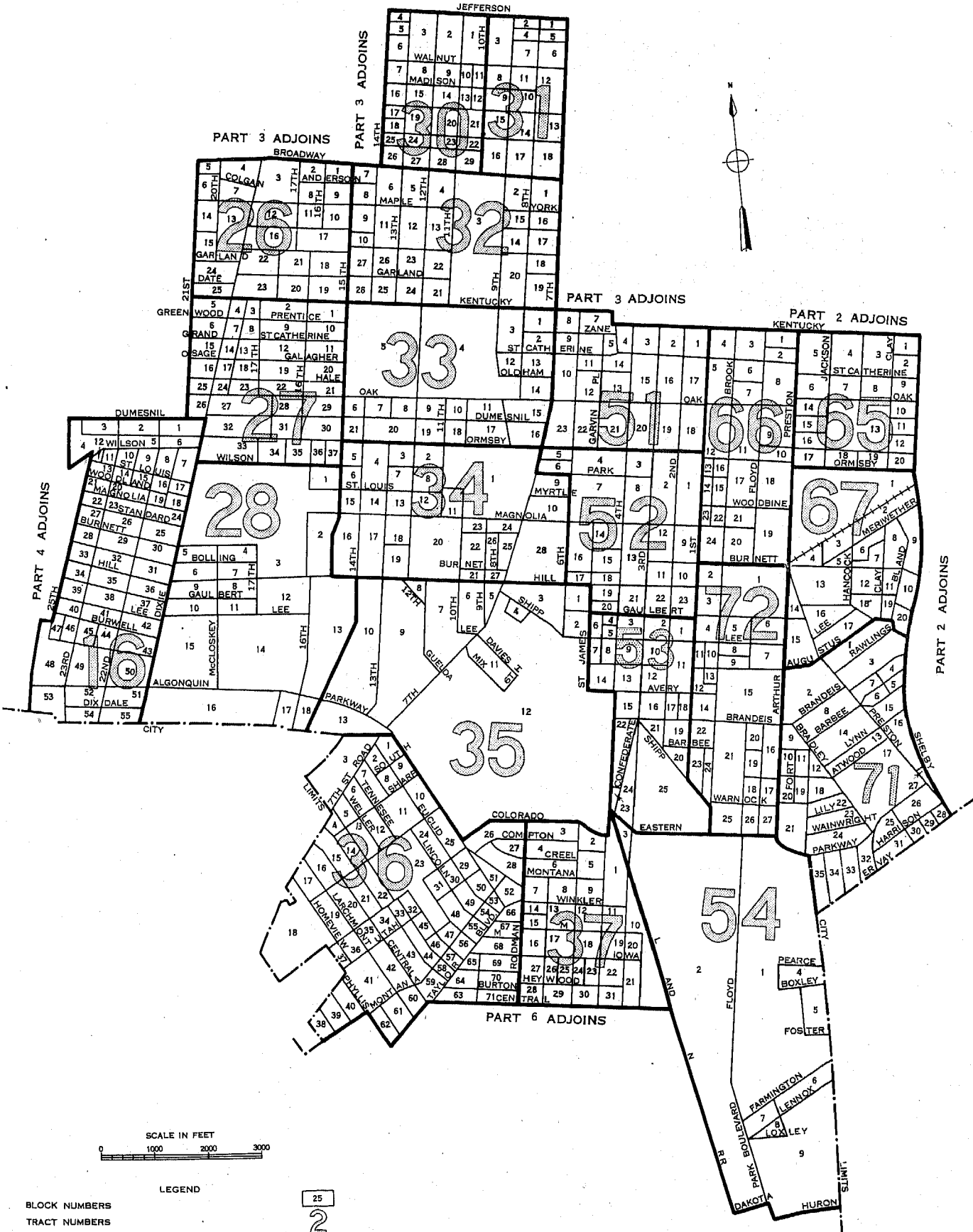

LEGEND

- BLOCK NUMBERS
- TRACT NUMBERS
- TRACT BOUNDARIES
- U.S. DEPARTMENT OF COMMERCE, BUREAU OF THE CENSUS

LOUISVILLE, KENTUCKY, BY CENSUS TRACTS AND BLOCKS: 1950

PART 6 OF 6 PARTS

PART 5 ADJOINS

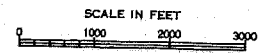
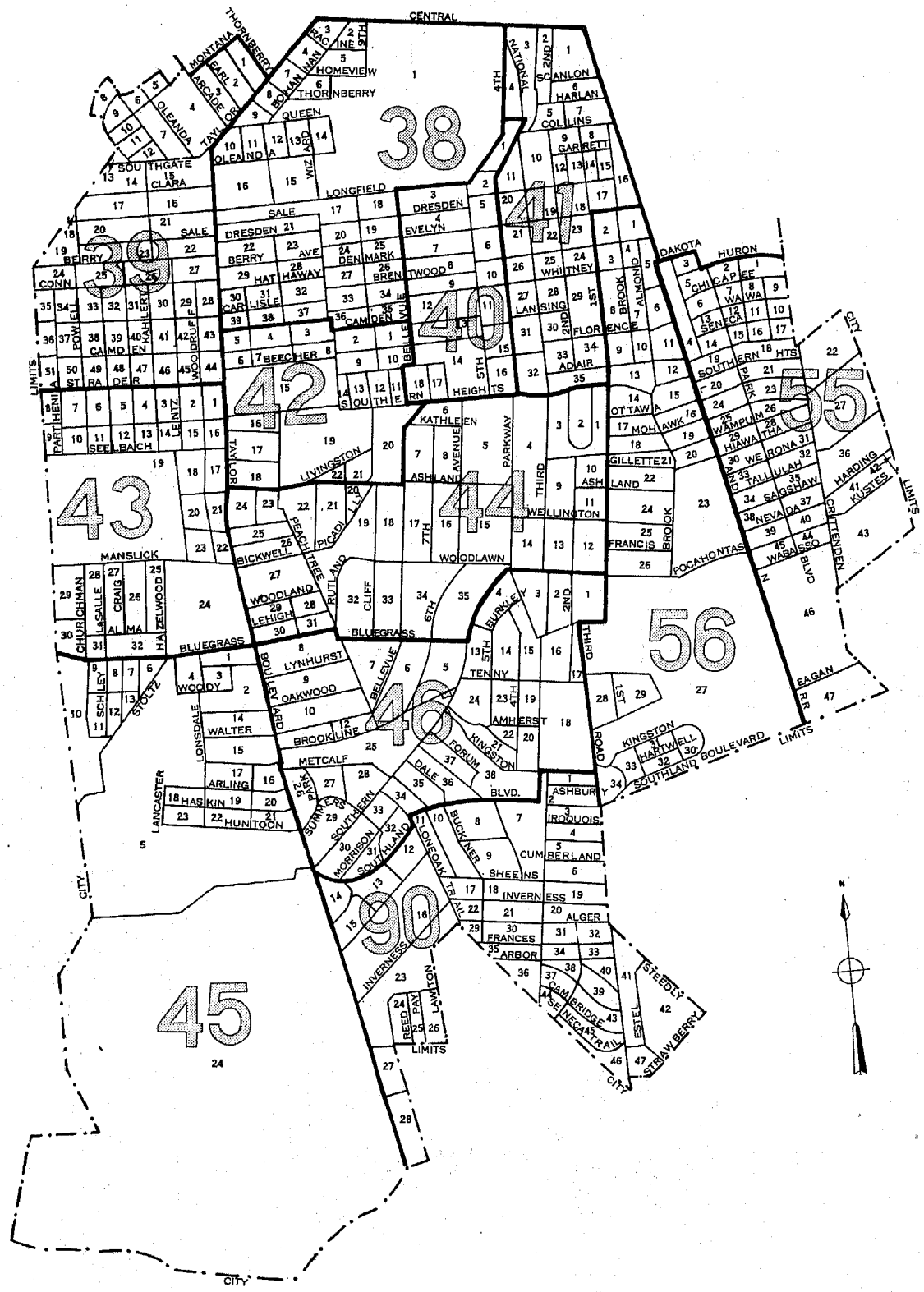

LEGEND

BLOCK NUMBERS

TRACT NUMBERS

TRACT BOUNDARIES

U.S. DEPARTMENT OF COMMERCE, BUREAU OF THE CENSUS