

# 1950 UNITED STATES CENSUS OF HOUSING

U. S. DEPARTMENT OF COMMERCE • BUREAU OF THE CENSUS

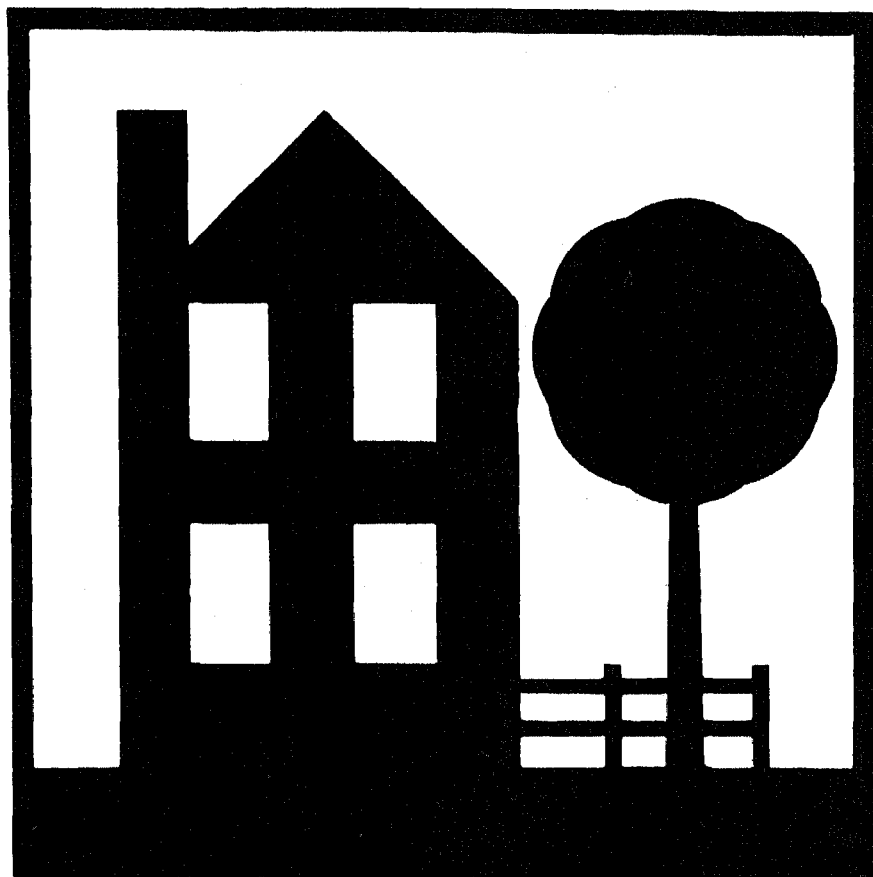

**OAKLAND, CALIF.**

**BLOCK  
STATISTICS**

## U. S. CENSUS OF HOUSING: 1950

### Volume

- I General Characteristics
- II Nonfarm Housing Characteristics
- III Farm Housing Characteristics
- IV Residential Financing
- V Block Statistics

Housing statistics for census tracts are to be included in the Population reports on census tracts.

## U. S. CENSUS OF POPULATION: 1950

### Volume

- I Number of Inhabitants
- II Characteristics of the Population

Succeeding volumes will cover the following subjects:

Census Tracts, Nativity and Parentage, Nonwhite Population by Race, Persons of Spanish Surname, Institutional Population, Differential Fertility, Labor Force Characteristics, Occupation, Industry, Income, Internal Migration, Education, Characteristics of Families and Households.

## CORRECTIONS

U. S. Bureau of the Census. U. S. Census of Housing: 1950.  
Volume V, Block Statistics,  
Part 133, Oakland, California

Page 3 (table 2) - In the total line the "Average monthly  
rent" should be \$59.65, not \$82.82.

**UNITED STATES CENSUS of HOUSING : 1950**  
U. S. DEPARTMENT OF COMMERCE  
CHARLES SAWYER, Secretary

BUREAU OF THE CENSUS  
ROY V. PEEL, Director



**BLOCK STATISTICS**

**OAKLAND  
CALIFORNIA**

*Prepared under the supervision of  
Howard G. Brunsman, Chief  
Population and Housing Division*

1950 HOUSING CENSUS REPORT

VOLUME V, PART 133

UNITED STATES GOVERNMENT PRINTING OFFICE 1952

**BLOCKS • CENSUS TRACTS**

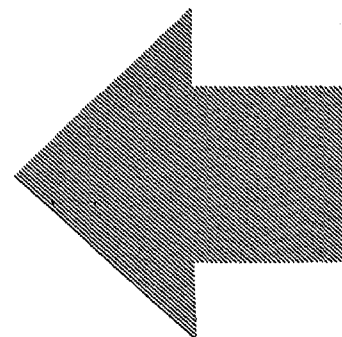



## BUREAU OF THE CENSUS

ROY V. PEEL, *Director*

A. ROSS ECKLER, *Deputy Director*  
HOWARD C. GRIEVES, *Assistant Director*  
CONRAD TAEUBER, *Assistant Director*  
MORRIS H. HANSEN, *Assistant Director for Statistical Standards*  
ROBERT Y. PHILLIPS, *Assistant Director for Operations*  
CALVERT L. DEDRICK, *Coordinator, International Statistics*  
FRANK R. WILSON, *Information Assistant to the Director*

### Population and Housing Division—

HOWARD G. BRUNSMAN, *Chief*  
WAYNE F. DAUGHERTY, *Assistant Chief for Housing*  
ROBERT B. VOIGHT, *Assistant Chief for Operations*  
HENRY S. SHRYOCK, Jr., *Assistant Chief for Population*  
EDWIN D. GOLDFIELD, *Program Coordinator*

Quality and Equipment Statistics—Robert C. Hamer, *Chief*  
Inventory Statistics—Carl A. S. Coan, *Chief*  
Developmental Programs—J. Hugh Rose, *Chief*  
Residential Financing—Junia H. Honnold, *Chief*  
Territories and Possessions—Joel Williams, *Chief*  
Statistical Sampling—Joseph Steinberg, *Chief*  
Statistical Procedure—Morton A. Meyer, *Chief*  
Processing Operations—Milton D. Lieberman, *Chief*

Administrative Service Division—WALTER L. KEHRES, *Chief*  
Agriculture Division—RAY HURLEY, *Chief*  
Budget Officer—CHARLES H. ALEXANDER  
Business Division—HARVEY KAILIN, *Acting Chief*  
Field Division—LOWELL T. GALT, *Chief*  
Foreign Trade Division—J. EDWARD ELY, *Chief*  
Geography Division—CLARENCE E. BATSCHELET, *Chief*  
Governments Division—ALLEN D. MANVEL, *Chief*  
Industry Division—MAXWELL R. CONKLIN, *Chief*  
Machine Tabulation Division—C. F. VAN AKEN, *Chief*  
Personnel Division—HELEN D. ALMON, *Chief*

### SUGGESTED IDENTIFICATION

U. S. Bureau of the Census. *U. S. Census of Housing: 1950. Vol. V, Block Statistics, Part 133.*  
U. S. Government Printing Office, Washington, D. C., 1952

For sale by the Superintendent of Documents, U. S. Government Printing Office, Washington 25, D. C.,  
or any of the Field Offices of the Department of Commerce - Price 35 cents

## PREFACE

This report presents statistics on characteristics of dwelling units by blocks for the city. The tabulations are based on data from the 1950 Census of Housing, taken as of April 1, 1950. Authorization for the 1950 Census of Housing as part of the Seventeenth Decennial Census was provided by the Housing Act of 1949, approved July 15, 1949.

The major portion of the information compiled from the 1950 Census of Housing appears in Volume I, *General Characteristics*; Volume II, *Nonfarm Housing Characteristics*; Volume III, *Farm Housing Characteristics*; Volume IV, *Residential Financing*; and Volume V, *Block Statistics*. Volume V consists of separate reports, issued as bulletins for each of the 209 cities which in 1940 or in a subsequent census had a population of 50,000 or more. These reports will not be bound into a single publication.

The subjects covered in both the 1950 and 1940 reports on characteristics of dwelling units by blocks are substantially similar.

This report was prepared under the direction of Howard G. Brunsman, Chief, Population and Housing Division, and Wayne F. Daugherty, Assistant Chief for Housing. Robert C. Hamer, Chief, Quality and Equipment Statistics Section, was in charge of coordinating the content and the format of the report with assistance from Carl A. S. Coan, Chief, Inventory Statistics Section; Floyd D. McNaughton, Chief, Equipment and Facilities Unit; Beulah Washabaugh, Chief, Tenure and Vacancy Unit; and Walter A. Hines. The compilation of the statistics was under the supervision of Robert B. Voight, Assistant Chief for Operations.

The collection of the information on which these statistics are based was under the supervision of Lowell T. Galt, Chief, Field Division. The geographic work, including the assignment of all block numbers and the preparation of maps, was under the supervision of Clarence E. Batschelet, Chief, Geography Division. The data were tabulated under the supervision of C. F. Van Aken, Chief, Machine Tabulation Division.

April 1952.

# OAKLAND, CALIF.

## CONTENTS

### INTRODUCTION

	Page		Page
General.....	1	Definitions and explanations—Continued	
Related reports.....	1	Condition and plumbing facilities.....	2
Census tracts.....	1	Persons per room.....	2
Use of data.....	1	Color of occupants.....	2
Comparability with 1940 Housing Census data.....	1	Contract monthly rent.....	2
Definitions and explanations.....	1	Value of one-dwelling-unit structures.....	2
Dwelling unit.....	1	Number reporting.....	2
Occupancy and tenure.....	2	Block identification.....	2

### TABLES

	Page
Table 1.—Characteristics of housing for the city: 1950.....	3
Table 2.—Characteristics of housing by census tracts: 1950.....	3
Table 3.—Characteristics of housing for census tracts, by blocks: 1950.....	3

Map of city, by blocks, appears following last page of tables.

# BLOCK STATISTICS

## INTRODUCTION

### GENERAL

Volume V of the Reports on Housing consists of a separate report for each of the 209 cities which in 1940, or in a subsequent census prior to 1950, had a population of 50,000 or more. Each report presents for the city, by blocks, tabulations for a limited number of subjects obtained in the Census of Housing. The subjects in these reports are similar to those in the block statistics supplements to Volume I of the reports of the 1940 Census of Housing. The subjects in this report present the number of dwelling units classified by occupancy and tenure, condition and plumbing facilities, persons per room, color of occupants, average contract monthly rent of renter-occupied and selected vacant units, and the average value of one-dwelling-unit owner-occupied and selected vacant structures. In table 1, the statistics for these subjects are summarized for the city. Table 2 contains the statistics for census tracts. In table 3, the data are presented by blocks within census tracts. Maps identifying the location of each block and the census tract boundaries are a part of this report.

**Related reports.**—Related statistics for this city are contained in the Reports on Housing, Volume I, *General Characteristics*; and in the Reports on Population, Volume I, *Number of Inhabitants*, and Volume II, *Characteristics of the Population*.

The Reports on Housing for each State in Volume I present data on the characteristics of dwelling units for the State by residence (urban, rural nonfarm, and rural farm), for standard metropolitan areas, urbanized areas, counties, for urban places, places of 1,000 to 2,500 inhabitants, and rural-nonfarm and rural-farm dwelling units for each county. Each report includes the following subjects: occupancy, tenure, race of occupants, type of structure, year built, condition and plumbing facilities, water supply, toilet and bathing facilities, number of rooms, number of persons, persons per room, electric lighting, heating equipment, heating and cooking fuels, refrigeration equipment, kitchen sink, radio, television, and, for nonfarm units, the contract monthly rent, gross monthly rent, and value of one-dwelling-unit structures.

Volume I of the Reports on Population shows the 1950 population of each county and of each minor civil division within the county. It also contains figures for each incorporated place, for each unincorporated place with 1,000 or more inhabitants, and for incorporated places of 5,000 or more by wards. A special series of tables presents data for each urbanized area giving the incorporated places and portions of minor civil divisions within it.

Volume II of the 1950 Population Reports contains statistics on the general characteristics of the population. Chapter A of this volume repeats the figures on number of inhabitants as shown in Volume I; Chapter B presents demographic, economic, and social characteristics of the population; and Chapter C gives more detailed cross-classifications for States and large cities and standard metropolitan areas.

**Census tracts.**—Census tracts are small areas into which certain large cities have been subdivided for statistical and local administrative purposes. In most cases the tracts are permanently established, so that comparison may be made from census to census. The boundaries of tracts are established so as to include approximately equal numbers of inhabitants or equal areas; and each tract is designed to represent an area that is fairly

homogeneous in population characteristics. Although the tracted areas of some cities extend into the suburbs, the data shown in this report are restricted to the tracts within the corporate limits of the city.

**Use of data.**—The tabulation of housing characteristics for areas as small as city blocks provides descriptive material of considerable value for technical studies of housing in the city. The statistics will be useful in compiling totals for special types of areas that may be defined to meet the requirements of individual investigators. Users of the data should bear in mind that in practically all cases the data for a given block represent the work of only one enumerator. Consequently, housing characteristics for blocks are subject to a wider margin of error than is to be expected in the figures for tracts or wards which represent returns made by a number of enumerators. Misinterpretation of instructions by one enumerator may cause a significant bias in the statistics for a block even though it may have a negligible effect upon the figures for larger areas. In particular, the enumeration of "condition" depended to a considerable extent upon the judgment of the individual enumerator. Also, failure to indicate the correct block number for a significant number of dwelling units may introduce errors into the block data.

**Comparability with 1940 Housing Census data.**—In the 1940 Census of Housing, reports entitled "Block Statistics" were issued as supplements to the first series of Housing bulletins. These supplements consisted of separate reports for each of the 191 cities which had 50,000 inhabitants or more in 1930.

In the 1950 reports, the block numbers used are different, in most cases, from those used in the 1940 reports. Therefore, to compare 1940 and 1950 data for a given block, it is necessary to locate the block on the maps to obtain the corresponding 1940 and 1950 block numbers.

The subjects in both the 1940 and 1950 reports are substantially similar. However, data on number of structures, year built, and mortgage status have been omitted from the 1950 report. Furthermore, in the 1940 reports average contract or estimated monthly rent was reported for all dwelling units while in 1950 average contract monthly rent is reported for some, and average value for other, dwelling units.

### DEFINITIONS AND EXPLANATIONS

More detailed and complete definitions are presented in Volume I of the Housing Reports.

**Dwelling unit.**—In general, a dwelling unit is a group of rooms or a single room, occupied or intended for occupancy as separate living quarters, by a family or other group of persons living together or by a person living alone.

A group of rooms, occupied or intended for occupancy as separate living quarters, is a dwelling unit if it has separate cooking equipment or a separate entrance. A single room, occupied or intended for occupancy as separate living quarters, is a dwelling unit if it has separate cooking equipment or if it constitutes the only living quarters in the structure. Also, each apartment in a regular apartment house is a dwelling unit even though it may not have separate cooking equipment. Excluded from the dwelling unit count are large rooming houses, institutions, dormitories, and transient hotels and tourists courts.

In the 1940 Census, a dwelling unit was defined as the living quarters occupied or intended for occupancy by one household.



A household consisted of a family or other group of persons living together with common housekeeping arrangements, or a person living entirely alone. However, the enumerator was not explicitly instructed to define rooms as dwelling units on the basis of cooking equipment or separate entrance.

The number of dwelling units in the 1950 Census may be regarded as comparable with the number of dwelling units in the 1940 Census. Some living quarters may have been classified as separate dwelling units in the one census and not in the other. Further, in the 1950 Census, living quarters with five or more lodgers were not tabulated as dwelling units; generally, such quarters were included in the 1940 dwelling unit count. However, the net effect of these changes is probably small.

**Occupancy and tenure.**—Dwelling units are classified by occupancy and tenure into four groups: owner-occupied; renter-occupied; vacant nonseasonal not dilapidated, for rent or sale; and other vacant and nonresident. A dwelling unit is classified as owner-occupied if it was owned wholly or in part by the head of the household or by some related member of his family living in the dwelling unit. All other occupied units are classified as renter-occupied whether or not cash rent was actually paid for living quarters. Rent-free units and living accommodations received in payment for services performed are thus included with the renter-occupied units.

A dwelling unit is considered vacant if no persons are living in it at the time of enumeration. New units not yet occupied were enumerated as vacant dwelling units if construction had proceeded to the extent that all the exterior windows and doors were installed and final usable floors were in place. The classification "Vacant nonseasonal not dilapidated, for rent or sale" is descriptive of the vacant dwelling units reported in this classification. "Other vacant and nonresident" units include all dilapidated and seasonal vacant units as well as the not dilapidated units which were not for rent or sale.

Because of changes in enumeration procedures, the counts of total vacant units in 1940 and 1950 are not strictly comparable. In 1940, vacant units were enumerated if they were habitable; units uninhabitable and beyond repair were excluded from the enumeration. In 1950, units were included regardless of condition if they were intended for occupancy as living quarters. Therefore, no comparison should be made between the data on "vacant nonseasonal not dilapidated, for rent or sale" units from the 1950 Census and data in the 1940 Census reports.

In both censuses, dwelling units occupied entirely by non-residents were included with vacant units not for rent or sale. Trailers, tents, houseboats, and railroad cars which were vacant were excluded from the dwelling unit inventory in both 1950 and 1940.

**Condition and plumbing facilities.**—Data on condition of a dwelling unit are shown in combination with data for selected plumbing facilities and are, therefore, limited to units for which both condition and plumbing facilities are reported. Plumbing facilities include water supply, toilet facilities, and bathing facilities.

The category "with private bath" includes those dwelling units reported with both a flush toilet and a bathtub or shower inside the structure for the exclusive use of the occupants of the unit. The category "no private bath" includes those dwelling units not having private flush toilet or not having private bathing facilities. The "no running water" category includes units with only piped running water outside the structure or with only other sources such as a hand pump.

A dwelling unit is "dilapidated" when it is run-down or neglected, or is of inadequate original construction, so that it does not provide adequate shelter or protection against the elements or it endangers the safety of the occupants.

**Persons per room.**—The number of persons per room has been computed for each occupied dwelling unit by dividing the number

of persons in the dwelling unit by the number of rooms in the dwelling unit. All persons enumerated in the Population Census as members of the household (including lodgers, servants, and other nonrelated persons) are counted in determining the number of persons that occupy the dwelling unit. The number of rooms in the dwelling unit includes all rooms available for living quarters throughout the year. Not counted as rooms are bathrooms, closets, pantries, halls, screened porches, and unfinished rooms in the basement and attic.

**Color of occupants.**—Occupied dwelling units are classified by color of head of household according to the definition used in the 1950 Census of Population. The group designated as "non-white" consists of Negroes, Indians, Japanese, Chinese, and other nonwhite races. Persons who are not definitely Indian or of other nonwhite race are classified as white.

**Contract monthly rent.**—Contract monthly rent is the rent, at the time of enumeration, contracted for by the renter regardless of whether it includes furniture, heating fuel, electricity, cooking fuel, water, or personal services.

Monthly rent for vacant dwelling units is the amount asked for the dwelling unit at the time of enumeration. The average monthly rent relates to renter-occupied dwelling units and vacant nonseasonal not dilapidated units for rent. Dwelling units which are occupied "rent-free" are not included with the units reporting rent.

**Value of one-dwelling-unit structures.**—Average value is shown for owner-occupied dwelling units and vacant nonseasonal not dilapidated units which are for sale only. Value is shown only if the unit is in a one-dwelling-unit structure without business and if it is the only dwelling unit included in the property. The value represents the amount for which the owner estimates that the property, including such land as belongs with it, would sell under ordinary conditions and not at a forced sale. For vacant units, value is the sale price asked by the owner.

**Number reporting.**—Occupancy and tenure are reported for all dwelling units, and color of occupants is reported for all occupied units. The corresponding distributions for these subjects in table 1 are based on all dwelling units and on occupied units, respectively. For all other subjects, the distributions are based on the units for which the specific characteristics are reported, that is, the "Number reporting."

The number of dwelling units for which the enumerator obtained no report on a particular item is shown for the city totals only; however, the number "not reported" can easily be derived for each area in tables 2 and 3 by subtracting the number reporting from the total number of dwelling units (or total occupied).

**Block identification.**—A map or series of maps is included in this report showing block numbers for each block, number and letter designations for tracts, and the names of principal streets.

Blocks are identified by serial numbers, a separate series of numbers being used for each tract. Thus, the location of each block for which data are presented in table 3 may be determined by referring to the tract and block number shown on the map. Similarly, data for a specific block may be located in the table by reference to the map for identification numbers of the tract and block.

If no dwelling units are reported for a block, the block number is not listed in table 3, although it is shown on the map. Dwelling units for which the block number was not reported are indicated in the table by the symbol "NR." Detailed data are not shown for such dwelling units, nor for blocks containing fewer than three dwelling units. Average monthly rent is not shown when the monthly rent was reported for fewer than three dwelling units. Average value is not shown when the value of one-dwelling-unit properties was reported for fewer than three dwelling units. All dwelling units are included, however, in the statistics for the city and for each tract.

Table 1.—CHARACTERISTICS OF HOUSING FOR THE CITY: 1950

Subject	Number	Percent	Subject	Number	Percent
<b>OCCUPANCY AND TENURE</b>			<b>PERSONS PER ROOM</b>		
All dwelling units.....	133,263	100.0	Occupied dwelling units.....	128,885	...
Owner occupied.....	63,303	47.5	Number reporting.....	127,503	100.0
Renter occupied.....	69,960	52.5	1.50 or less.....	123,468	96.8
Vacant nonseasonal not dilapidated, for rent or sale.....	2,725	2.0	1.51 or more.....	4,035	3.2
Other vacant and nonresident.....	1,653	1.2	Not reported.....	1,382	...
<b>CONDITION AND PLUMBING FACILITIES</b>			<b>CONTRACT MONTHLY RENT</b>		
All dwelling units.....	133,263	...	Renter-occupied, and vacant nonseasonal not dilapidated units, for rent—Number reporting.....	64,326	...
Number reporting.....	131,780	100.0	Total contract monthly rent..... dollars..	3,836,782	...
With private bath, not dilapidated.....	116,524	88.4	Average monthly rent..... dollars..	59.65	...
No private bath, with running water, not dilapidated.....	10,273	7.8	<b>VALUE OF ONE-DWELLING-UNIT STRUCTURES</b>		
No running water or dilapidated.....	4,983	3.8	Owner-occupied, <sup>1</sup> and vacant nonseasonal not dilapidated units, for sale only—Number reporting.....	50,347	...
Condition or plumbing facilities not reported.....	1,483	...	Total value or sale price..... dollars..	557,344,500	...
No private bath or dilapidated.....	15,256	11.6	Average value..... dollars..	11,070	...
<b>COLOR OF OCCUPANTS</b>					
Occupied dwelling units.....	128,885	100.0			
White.....	114,524	88.9			
Nonwhite.....	14,361	11.1			

<sup>1</sup>Restricted to 1-dwelling-unit properties.

Table 2.—CHARACTERISTICS OF HOUSING BY CENSUS TRACTS: 1950

Census tract	All dwelling units by occupancy and tenure					All dwelling units by condition and plumbing facilities			Occupied dwelling units			Contract monthly rent <sup>1</sup>		Value <sup>2</sup> of one-dwelling unit structures		
	Total	Owner occupied	Renter occupied	Vacant non-seasonal not dilap., for rent or sale	Other vacant and non-resident	Number reporting	No private bath or dilap.	No running water or dilap.	Total	Persons per room	Occupied by non-white	Number reporting	Average monthly rent (dollars)	Number reporting	Average value (dollars)	
<b>TOTAL</b>	<b>133263</b>	<b>63303</b>	<b>65582</b>	<b>2725</b>	<b>1653</b>	<b>131780</b>	<b>15256</b>	<b>4983</b>	<b>128885</b>	<b>127503</b>	<b>4035</b>	<b>14361</b>	<b>64326</b>	<b>82.82</b>	<b>50347</b>	<b>11,070</b>
1	196	147	38	4	7	196	8	8	185	184	1	3	68.75	137	19,182	
2	1432	887	510	24	11	1429	20	8	1397	1393	4	500	53.54	771	15,521	
3	1851	948	860	27	16	1834	49	28	1808	1793	10	844	45.69	736	10,387	
4	1881	857	990	25	9	1868	61	14	1847	1836	16	977	47.69	638	10,828	
5	2346	1095	1194	31	26	2334	90	23	2289	2263	16	72	116.3	815	9,898	
6	1818	864	914	22	18	1801	81	28	1778	1750	18	211	89.8	639	8,994	
7	2271	1053	1160	35	23	2255	222	65	2213	2203	70	553	111.9	731	7,885	
8	2223	947	1224	29	23	2194	142	60	2171	2144	28	205	120.1	646	8,564	
9	1607	657	923	31	9	1598	42	28	1580	1572	11	11	89.7	459	9,874	
10	2095	709	1336	18	19	2066	135	21	2045	2018	35	351	40.09	403	8,881	
11	2641	727	1823	53	38	2598	600	223	2550	2502	84	868	180.7	341	9,194	
12	2122	416	1641	49	16	2100	587	68	2057	2035	68	244	161.1	185	10,365	
13	1664	206	1369	67	22	1632	637	82	1575	1563	62	84	137.6	85	7,880	
14	2446	761	1578	63	44	2393	669	305	2339	2312	208	1454	154.7	372	7,494	
15	2611	721	1806	36	48	2547	676	508	2527	2494	258	1959	174.5	309	6,257	
16	2331	588	1673	43	27	2272	529	180	2261	2233	219	1658	165.6	259	8,395	
17	3087	598	2314	121	54	3034	1434	355	2912	2880	340	1631	233.9	199	8,212	
18	3869	418	3162	207	82	3832	2124	598	3580	3558	328	774	323.7	143	8,232	
19	1125	59	998	57	11	1098	644	66	1057	1035	71	17	102.3	8	7,687	
20	333	16	283	25	9	330	246	39	299	295	40	44	29.3	1		
21	2536	621	1824	44	47	2465	724	399	2445	2399	432	1661	176.1	255	5,410	
22	286	39	233	4	10	280	124	100	272	265	46	140	22.6	12	7,016	
23	295	33	251	7	4	283	37	8	284	272	36	254	24.3	8		
24	1661	167	1416	45	33	1642	210	51	1583	1569	64	394	141.2	91	8,680	
25	1667	328	1246	69	24	1635	510	110	1574	1561	102	67	124.5	135	8,236	
26	2223	525	1564	98	36	2179	426	24	2089	2051	71	39	157.5	264	9,527	
27	1951	308	1585	43	15	1915	174	43	1893	1857	21	10	153.5	123	11,008	
28	1219	39	1150	21	9	1192	255	11	1189	1170	29	17	112.8	2		
29	889	22	789	72	6	867	167	10	811	794	29	9	78.3	8	23,500	
30	1948	535	1337	59	17	1925	190	11	1872	1852	19	45	132.1	315	11,240	
31	8160	442	1651	42	25	2129	55	11	2093	2036	19	18	160.4	273	17,728	
32	1849	684	1095	54	16	1831	45	6	1779	1757	12	26	107.4	503	15,634	
33	2413	846	1458	73	36	2337	124	25	2304	2282	24	48	143.7	538	9,992	
34	1748	1089	612	24	23	1737	21	3	1701	1687	6	6	59.4	940	14,188	
35	1515	1351	145	11	8	1509	4	2	1496	1477	2	23	139	1296	19,942	
36	1553	670	830	33	20	1546	33	5	1500	1490	4	17	83.1	503	15,398	
37	1861	806	1009	31	15	1824	139	22	1815	1794	21	28	98.1	543	12,943	
38	1936	725	1171	16	24	1919	70	23	1896	1878	12	9	114.4	522	11,383	
39	1913	1667	206	22	18	1902	30	18	1873	1851	19	2	19.3	1562	20,579	
40	1024	885	110	10	19	1016	15	9	995	983	6	95	63.69	844	12,707	
41	1145	945	161	21	18	1133	5	2	1106	1091	1	15.7	89.47	892	19,055	
42	1097	972	93	9	23	1091	5	4	1065	1048	4	84	80.47	909	20,085	
43	2120	1702	366	28	24	2108	33	21	2068	2054	9	3	33.5	1572	12,217	
44	1662	1332	296	19	15	1647	32	24	1628	1607	7	4	270	500.1	12,210	
45	2209	1559	591	41	18	2192	38	16	2150	2127	17	2	56.9	548.1	137.3	
46	2586	1359	1134	66	27	2558	142	66	2493	2456	25	118	112.1	50.14	1045	
47	1924	1186	683	35	20	1899	62	29	1869	1835	23	39	65.5	48.97	96.7	
48	2172	1362	759	31	20	2164	83	32	2121	2079	16	4	73.4	50.77	114.4	
49	1910	1158	694	39	19	1907	85	30	1852	1846	26	5	68.5	47.35	99.9	
50	1947	1281	628	28	10	1939	62	13	1909	1889	24	14	60.3	46.78	107.7	

<sup>1</sup>For renter-occupied dwelling units and vacant nonseasonal not dilapidated units, for rent.  
<sup>2</sup>For owner-occupied dwelling units and vacant nonseasonal not dilapidated units, for sale only.

## HOUSING—BLOCK STATISTICS

Table 2.—CHARACTERISTICS OF HOUSING BY CENSUS TRACTS: 1950—Con.

Census tract	All dwelling units by occupancy and tenure					All dwelling units by condition and plumbing facilities			Occupied dwelling units			Contract monthly rent <sup>1</sup>		Value <sup>2</sup> of one-dwelling-unit structures		
	Total	Owner occupied	Renter occupied	Vacant non-seasonal not dilap., for rent or sale	Other vacant and non-resident	Number reporting	No private bath or dilap.	No running water or dilap.	Total	Persons per room		Occupied by non-white	Number reporting	Average monthly rent (dollars)	Number reporting	Average value (dollars)
										Number reporting	1.51 or more					
51	1400	836	527	20	17	1388	69	32	1363	1353	8	9	494	44.99	675	8613
52	1954	805	1048	36	65	1894	285	174	1853	1833	55	111	1001	39.75	514	6119
53	2032	722	1245	44	21	2003	177	23	1967	1959	50	14	1222	44.03	484	9505
54	1721	641	1030	33	17	1716	118	43	1671	1666	25	10	1014	41.74	437	8451
55	1736	607	1079	25	25	1722	236	46	1686	1676	98	121	1035	34.71	379	6472
56	1321	445	837	27	12	1299	132	53	1282	1258	205	40	823	38.69	316	6493
57	2199	1022	1081	65	31	2182	102	25	2103	2082	29	20	1077	45.48	817	8825
58	1724	1145	550	15	14	1712	38	22	1695	1685	22	7	529	46.38	1004	10026
59	1745	1452	269	14	10	1740	4	1	1721	1707	5	2	255	52.48	1389	11423
60	1631	1247	333	23	28	1611	50	30	1580	1564	12	6	309	51.06	1141	11259
61	424	341	67	10	6	422	29	22	408	407	9	5	49	60.93	309	14104
62	2675	2060	544	27	44	2662	51	35	2604	2579	34	6	512	57.26	1830	9980
63	2445	1768	608	33	36	2428	70	33	2376	2359	25	14	595	48.40	1597	9221
64	1598	1172	391	17	18	1591	45	34	1563	1554	11	20	386	47.29	1081	8842
65	2055	1404	597	36	18	2042	42	16	2001	1983	20	17	584	49.35	1259	9177
66	2336	1253	1025	39	19	2321	142	66	2278	2261	120	396	992	39.73	1104	7218
67	2358	1838	474	27	19	2349	239	11	2312	2303	79	19	441	52.04	1780	8573
68	2245	1940	217	53	35	2221	269	12	2157	2135	77	344	1198	46.76	1652	7962
69	2539	1628	810	34	67	2516	140	22	2438	2419	75	19	766	47.77	1353	8352
70	2586	1975	554	36	21	2567	96	44	2529	2503	38	11	532	50.50	1806	9541
71	1524	1149	315	45	15	1517	20	17	1464	1443	14	4	325	74.90	1089	11879
72	647	541	98	4	4	645	5	1	639	635	1	1	82	53.97	535	15680

<sup>1</sup>For renter-occupied dwelling units and vacant nonseasonal not dilapidated units, for rent.<sup>2</sup>For owner-occupied dwelling units and vacant nonseasonal not dilapidated units, for sale only.

Table 3.—CHARACTERISTICS OF HOUSING FOR CENSUS TRACTS, BY BLOCKS: 1950

[Detailed statistics not shown for blocks containing fewer than 3 dwelling units, nor for dwelling units not allocated by blocks (designated by NR)]

Census tract	Block	All dwelling units by occupancy and tenure					All dwelling units by condition and plumbing facilities			Occupied dwelling units			Contract monthly rent <sup>1</sup>		Value <sup>2</sup> of one-dwelling-unit structures		
		Total	Owner occupied	Renter occupied	Vacant non-seasonal not dilap., for rent or sale	Other vacant and non-resident	Number reporting	No private bath or dilap.	No running water or dilap.	Total	Persons per room		Occupied by non-white	Number reporting	Average monthly rent (dollars)	Number reporting	Average value (dollars)
											Number reporting	1.51 or more					
1	5	7	6	1		7			7	7			1		6	8,500	
	9	11	8	3		11	3	3	11	11			1		8	12,250	
	10	2															
	11	1															
	12	53	35	18		53	2	2	53	53			17	68.23	30	24,483	
	15	2															
	18	3	2		1	3			2	2					3	9,000	
	19	1															
	21	25	18	2	2	25	3		20	20	1		2		20	13,925	
	23	6	5			6	1		5	5					5	14,700	
	25	9	7	2		9			9	9			2		6	15,000	
	27	3	3			3			3	3					3	18,333	
	28	9	9			9			9	9					9	19,055	
	29	10	7	2	1	10			9	9			2		6	26,166	
	30	3	3			3			3	3					3	35,000	
	31	15	9	6		15	1	1	15	15			5	78.40	7	20,357	
	32	16	12	3		16			15	14			2		10	21,850	
	33	13	12			13	1		12	12					11	21,363	
	34	1															
	35	1															
	37	3	2	1		3			3	3			1		2		
	38	2															
2	1	3	3			3			3	3					3	17,166	
	2	12	10	2		12			12	12			2		10	15,500	
	3	24	22	2		24			24	24			2		22	13,763	
	4	26	24	2		26			26	26			1		24	15,716	
	5	37	33	3	1	37			36	36			3	63.33	33	17,984	
	6	3	3			3			3	3					3	30,833	
	7	34	31	1	1	34			32	31			1		31	25,596	
	8	13	13			13			13	13					13	19,307	
	9	14	14			14			14	14					14	18,928	
	10	16	16			16			16	16					16	14,656	
	11	4	4			4			4	4					4	19,000	
	12	15	6	9		15			15	15			9	48.77	5	16,500	
	13	4	4			4			4	4			4	39.25			
	14	60	18	41	1	60	1		59	59	1		40	41.27	14	10,428	
	15	32	23	8		32			31	31			6	65.00	21	21,523	
	16	10	9	1		10			10	9			1		8	23,562	
	17	18	17	1		18			18	18			1		17	16,058	
	18	69	38	31		68		1	69	69	1		27	64.81	31	17,806	
	19	98	44	51	1	97	2		95	95		1	50	51.16	32	16,062	
	20	13	12	1		13			13	13			1		12	27,333	
	21	18	14	4		18			18	18			4	78.75	14	20,928	
	22	32	27	4	1	32			31	30	1		2		26	18,288	
	23	64	51	11	2	64			62	61		2	10	67.70	48	14,743	
	25	77	45	29	2	77	1		74	74			31	60.80	33	15,418	
	26	61	37	23	1	61		1	60	60		2	24	65.62	32	13,859	
	27	66	36	29	1	66			65	65		2	30	54.26	29	14,465	
	28	64	36	26	2	64		2	62	62		2	27	54.00	30	15,423	
	29	42	28	13		42	1	1	41	41			12	69.00	23	13,152	
	30	74	46	26	2	74			72	72		2	25	41.48	40	13,787	
	31	118	59	54	4	117	1	6	113	113	1	1	53	50.69	49	11,361	
	32	72	55	17		72		3	72	72		2	14	67.50	48	11,812	
	33	60	43	16		60		1	59	59		1	16	45.18	40	11,325	
	34	39	17	21		39			38	38			21	48.38	12	11,250	
	35	59	17	38	3	59		4	55	55		1	39	39.61	7	10,857	
	36	81	36	42	3	81			78	78			44	57.31	27	10,611	
3	1	81	22	55	3	75		6	77	69			52	50.11	7	20,500	
	2	89	49	40		87		5	89	89		1	40	47.40	35	13,040	
	3	80	27	50	2	80		1	77	77		1	51	50.00	21	14,690	
	4	60	31	28	1	60		7	59	59			29	46.24	20	11,300	
	5	53	8	45		53		3	53	53			45	40.02	5	10,600	
	6	56	19	37		56		3	56	56			35	47.45	13	11,192	
	7	42	24	17		42		1	41	41		1	17	45.11	18	10,100	
	8	38	21	16		38			37	37			14	46.28	20	10,050	
	9	46	30	14	1	45			44	44			14	45.64	25	9,904	
	10	32	31	1		32			32	31					29	10,448	
	11	91	49	42		89			91	90			41	58.56	43	11,886	
	12	25	16	9		25			25	25			9	47.55	14	9,000	
	13	78	22	52	1	76		3	74	74		1	52	44.69	17	9,323	
	14	54	44	10		54			54	54			9	44.22	39	8,602	
	15	82	57	23		82		2	80	80		1	22	46.66	50	8,446	
	16	18	9	8		18		2	17	17			8	43.12	4	9,250	
	17	58	39	19	1	56			58	56			18	39.00	33	10,060	
	18	38	29	9		38			38	38			9	56.44	26	9,961	
	19	57	36	21		57			57	56		1	20	48.50	25	10,800	
	20	48	27	21		48		4	48	48		1	20	46.80	18	10,583	
	21	14	7	7		14			14	14			7	37.88	5	11,300	
	22	22	17	5		22			22	22			3	44.00	16	10,312	
	23	36	26	10		36		2	36	36		1	9	55.11	24	9,791	
	24	41	24	17		41			41	41			17	48.23	23	9,434	
	25	52	29	21	2	52		4	50	50		1	21	46.04	17	7,911	

<sup>1</sup>For renter - occupied dwelling units and vacant nonseasonal not dilapidated units, for rent.  
<sup>2</sup>For owner - occupied dwelling units and vacant nonseasonal not dilapidated units, for sale only.





















Table 3.—CHARACTERISTICS OF HOUSING FOR CENSUS TRACTS, BY BLOCKS: 1950—Con.

Census tract	Block	All dwelling units by occupancy and tenure					All dwelling units by condition and plumbing facilities			Occupied dwelling units			Contract monthly rent <sup>1</sup>		Value <sup>2</sup> of one-dwelling-unit structures			
		Total	Owner occupied	Renter occupied	Vacant non-seasonal not dilap., for rent or sale	Other vacant and non-resident	Number reporting	No private bath or dilap.	No running water or dilap.	Total	Persons per room		Number reporting	Average monthly rent (dollars)	Number reporting	Average value (dollars)		
											Number reporting	1.51 or more					Occupied by non-white	
21	12	14	1	12		1	14	13	13	13	13	1	13	12	39.66			
	14	21	9	10		2	21	20	18	19	19	4	19	19	65.33	2		
	15	59	14	43		2	56	25	16	57	54	12	53	39	37.71	5	5,400	
	16	60	21	35	2	2	58	15	9	56	56	6	46	34	30.32	8	4,837	
	17	42	13	29			41	8	1	42	41	1	31	28	36.78	6	5,233	
	18	7	3	4			6	1	1	7	7	1	7	2		1		
	19	21	7	13	1	1	17	1	1	20	20	2	20	13	34.84			
	20	20	12	8			18	1	1	20	20	1	16	7	41.85	6	5,250	
	21	27	13	14			26	2	2	27	27	3	19	13	39.84	6	3,933	
	22	19	6	13			19			19	19		18	11	41.09	2		
	23	33	5	28			32	2	2	33	32	6	31	27	44.96	3	2,833	
	24	1																
	26	19	7	12			19			19	19	4	16	12	41.75	3	6,666	
	27	39	17	21		1	39	5	5	38	38	7	33	20	42.30	8	4,037	
	28	43	14	29			43	1	1	43	43	3	29	24	42.37	7	5,785	
	29	37	14	23			36	3	3	37	36	3	21	20	38.00	8	3,375	
	30	2																
	31	46	17	28		1	45	2	2	45	45	4	36	28	41.46	9	4,866	
	32	28	5	21	2		28	2	2	26	26	7	20	22	32.90	2		
	33	9	3	6			9	1	1	9	9		6	6	39.33	1		
	35	537	11	515		11	527	19	2	526	510	149	496	502	34.44			
	36	2																
	37	9	6	3			9			9	9	1	7	3	35.00	2		
	38	2																
	39	52	20	31	1		49	3	2	51	51	3	46	30	35.53	7	3,857	
	40	72	27	42	1	2	70	23	17	69	68	11	48	39	36.69	4	4,375	
	41	65	30	32	1	2	64	20	10	62	62	11	40	30	44.36	14	5,035	
	42	61	23	35		3	61	17	9	58	58	9	43	34	34.88	10	4,450	
	43	40	13	24		3	37	34	34	37	36	8	31	23	32.73	4	8,125	
	46	22	5	17			22	18	18	22	22	6	11	16	38.56	2		
	47	5	4	1			4	3	3	5	5	1	3	1		2		
	50	52	27	23	2		50	3		50	50	7	11	24	25.16	17	5,447	
	51	68	24	44			68	9		68	68	17	25	44	27.70	17	7,529	
	52	74	20	47	6	1	74	28	1	67	67	20	38	52	29.01	6	4,816	
	53	53	15	35	2	1	53	28	2	50	50	9	29	36	30.61	3	6,000	
	54	50	17	33			49	17	1	50	50	5	22	30	29.13	6	6,750	
	55	87	13	71	2	1	86	50	42	84	84	3	20	69	21.79	3	5,866	
	56	32	6	25		1	31	6		31	31	6	4	25	27.68	4	8,250	
	57	55	22	33		1	54	13	2	55	54	9	23	28	34.46	12	4,450	
	58	19	14	5			18			19	18	3	3	4	44.00	12	6,083	
	59	26	10	16			26	9	2	26	26	2	14	14	32.28	3	2,833	
	60	22	2	19	1		22	14	14	21	21	8	8	18	19.66			
	61	1																
	69	24	1	22		1	24	5		23	23	2	14	22	31.00			
	71	11		11			11	10	10	11	11	2	2	10	18.40			
	72	10	3	7			8	5	5	10	9	1	3	6	22.00			
	73	5	3	1		1	5	5	5	4	4	1	1	1				
74	3	1	1		1	3	3	3	2	2								
75	2																	
76	6	1	5			5			6	5		1	3	130.00				
22	2	26	9	15	2	26	5	2	24	23		21	15	38.80	3	8,166		
	4	8	1	7		8			8	8		4	7	22.57				
	5	3	1	2		2			3	2			1					
	6	14		14		14	14	14	14	14		6	14	22.78				
	7	20		18		19	8	8	18	17		5	10	37.43				
	9	51	8	40		50	36	29	48	47	11	11	38	35.68	2			
	10	82	5	75	1	81	13	9	80	79	16	65	74	34.39	2			
	12	2																
	13	1																
	14	2																
	15	7	3	3		1	7	2	2	6	6		4	3	17.00	2		
	16	17	3	14			17	6	5	17	17	2	5	14	36.85	2		
	17	9	1	8			8	3	1	9	8	4	2	8	36.87			
	18	2																
	19	1																
	22	2																
	23	24	2	21		1	24	24	23	23	23	7	6	21	24.00			
	24	9	1	7		1	9	7	2	8	8		2	7	18.28			
	28	1																
29	1																	
31	1																	
37	1																	
44	2																	
23	9	1																
	11	3		3		3	2		3	3		2	3	71.66				
	13	1																
	14	12	3	8	1	9	2		11	8	1	6	6	35.00				
	15	3	1	2		3			3	3		2	2					
	17	19	8	11		18	7		19	18		13	11	27.63				
	18	2																
19	19	2	17			18	7		19	17	3	18	15	30.00	1			
20	4	1	3			3			4	3		3	3	50.00				
21	5	1	4			4	2	2	5	4	2	2	3	47.00				

<sup>1</sup>For renter-occupied dwelling units and vacant nonseasonal not dilapidated units, for rent.  
<sup>2</sup>For owner-occupied dwelling units and vacant nonseasonal not dilapidated units, for sale only.

















Table 3.—CHARACTERISTICS OF HOUSING FOR CENSUS TRACTS, BY BLOCKS: 1950—Con.

Census tract	Block	All dwelling units by occupancy and tenure					All dwelling units by condition and plumbing facilities			Occupied dwelling units			Contract monthly rent <sup>1</sup>		Value <sup>2</sup> of one-dwelling-unit structures	
		Total	Owner occupied	Renter occupied	Vacant non-seasonal not dilap., for rent or sale	Other vacant and non-resident	Number reporting	No private bath or dilap.	No running water or dilap.	Total	Persons per room		Number reporting	Average monthly rent (dollars)	Number reporting	Average value (dollars)
											Number reporting	1.51 or more				
39	19	8	8			8			8	8					8	23,587
	20	10	10			10			10	10					10	18,150
	21	10	9	1		10			10	10					8	19,750
	22	14	13	1		14			14	14					13	22,961
	23	11	10	1		11			11	11				1	9	17,388
	24	26	23	3		26	1		26	26				3	20	17,450
	25	10	9	1		10			10	10			65.00	1	8	15,250
	26	28	26	2		28			28	28				2	25	15,580
	27	20	20			20			20	20					19	16,736
	28	21	19	1		21		1	20	19				1	19	18,447
	29	31	29	2		31			31	31				2	28	20,982
	30	37	36	1		37	1	1	37	37	1			1	34	20,317
	31	9	8		1	9			8	8					9	18,166
	32	20	18	2		20			20	20				2	16	16,562
	33	13	10	3		13			13	13				2	10	16,350
	34	19	13	5	1	19			18	18			74.00	5	11	15,145
	37	14	14			14			14	14					14	23,250
	38	18	15	3		18			18	18			128.33	3	13	18,407
	39	19	19			19			19	19					19	22,500
	40	7	6	1		7			7	7				1	6	15,333
	41	6	5	1		6			6	6					5	22,800
	42	15	15			15			15	15					15	28,066
	43	17	17			17			17	16					15	21,600
	44	1														
	45	19	17	1		19		1	18	18					16	24,781
	46	43	28	13	2	42			41	39				13	22	22,886
	47	65	55	9	1	65			64	63		1		10	46	19,402
	48	50	43	6	1	48			49	47			90.00	4	41	26,414
	49	5	3	2		5			5	5					3	31,000
	50	8	7			8		1	7	7					7	25,000
	51	13	13			13			13	13					13	25,961
	53	34	31	2		33	1	1	33	32				1	29	36,327
	54	6	5	1		6			6	6					4	30,500
	55	17	16	1		17		1	17	17					15	17,133
	57	20	19	1		20			20	20					19	18,578
	58	16	15	1		16			16	16					15	16,120
	59	11	11			11			11	11					9	18,722
	60	70	64	5		69		1	69	69		1	115.00	5	57	19,000
	61	18	15	3		18			18	18			135.66	3	14	18,785
	62	29	28	1		29			29	29				1	27	23,170
	63	12	12			12			12	12					11	19,727
	64	16	16			16		1	16	16					15	21,933
	65	14	13	1		14		1	14	14					13	20,769
	66	19	18	1		19			19	19					17	23,647
	67	28	26	1	1	27			27	26		1		1	24	20,250
	68	50	50			50			50	50					50	18,766
	69	9	9			9			9	9					9	18,666
	70	15	15			15			15	15					15	21,433
	71	6	6			6			6	6					5	21,400
	72	107	95	8	1	107		3	103	103			67.57	7	95	18,888
	73	16	16			16			16	15					16	22,625
	74	14	14			14			14	14					14	21,642
	75	43	38	4		43		1	42	42				4	37	22,270
	76	18	17	1		18			18	18			101.75		17	13,429
	77	22	19	3		20			22	19					16	14,743
	78	8	3	5		7		1	8	8				5	3	13,833
	79	9	9			9			9	9					9	16,444
	80	8	8			8			8	8					8	16,687
	82	8	6		2	8			6	6					6	31,333
	83	7	7			7			7	7					7	34,857
	84	11	10		1	11			10	10					10	38,000
	85	15	15			15			15	15		1			14	35,892
	86	5	5			5			5	5					5	63,000
	87	11	11			11			11	11					11	45,409
	88	8	7		1	8			7	7					7	38,642
	89	24	24			24			24	23					24	47,791
	90	18	14	4		18			18	17				2	13	17,423
	92	39	37	1		39		1	38	37					35	19,528
	93	18	18			18			18	18					18	12,333
	94	12	9	3		12			12	11				2	9	12,611
	95	2														
	96	23	19	4		23			23	22			48.33	3	19	11,815
	97	17	13	3		17		1	16	16			98.66	3	12	12,558
	98	8	7	1		8		1	8	8				1	7	11,357
	99	21	8	13		21			21	21			70.07	13	7	12,500
	100	20	20			20			20	20					20	16,025
	101	35	31	4		34			35	34				4	31	15,016
	102	43	31	11	1	43			42	42			114.50	10	29	12,362
	103	40	24	14		40		2	38	38			53.07	13	16	11,562
	104	54	21	25	8	54		17	46	46		13	66.12	31	7	17,371
	105	21	19	2		21			21	21					18	16,666
	106	20	18	2		20			20	20					18	15,150
	108	1														
40	1	1														

<sup>1</sup>For renter-occupied dwelling units and vacant nonseasonal not dilapidated units, for rent.  
<sup>2</sup>For owner-occupied dwelling units and vacant nonseasonal not dilapidated units, for sale only.







HOUSING—BLOCK STATISTICS

Table 3.—CHARACTERISTICS OF HOUSING FOR CENSUS TRACTS, BY BLOCKS: 1950—Con.

Census tract	Block	All dwelling units by occupancy and tenure					All dwelling units by condition and plumbing facilities			Occupied dwelling units			Contract monthly rent <sup>1</sup>		Value <sup>2</sup> of one-dwelling-unit structures		
		Total	Owner occupied	Renter occupied	Vacant non-seasonal not dilap., for rent or sale	Other vacant and non-resident	Number reporting	No private bath or dilap.	No running water or dilap.	Total	Persons per room		Occupied by non-white	Number reporting	Average monthly rent (dollars)	Number reporting	Average value (dollars)
											Number reporting	1.51 or more					
43	6	26	26						26	26						25	12,696
	7	13	13						13	13						12	14,083
	8	21	19	2				2	21	21						17	15,205
	9	28	25	2	1				28	27						24	13,541
	10	21	21						21	21						21	14,023
	11	24	22	2					24	24						22	16,318
	12	39	37	2					39	39						36	14,375
	13	30	28	2					30	30						27	15,844
	14	19	18	1					19	19						17	15,235
	15	11	10	1					11	11						9	18,555
	16	11	11						11	11						11	20,636
	17	15	14		1				15	14						14	16,785
	18	180	146	27	3	4	17	9	173	172	1	2	23	52.34	126	12,290	
	19	6	4	1	1				5	3						4	8,625
	20	8	6	2					8	8						5	13,400
	21	9	8		1				9	8						8	12,187
	22	27	23	3		1			27	26						22	9,954
	23	29	21	8					29	29						20	9,620
	24	76	61	13	1	1			76	74						57	13,094
	25	53	51	2					53	53						48	14,495
	26	46	44		1	1			46	44						44	18,113
	27	41	38	1		2			39	39						38	12,200
	28	17	17						17	17						17	19,617
	29	45	41	3	1				45	44						41	15,048
	30	35	29	5		1			34	33						26	13,019
	31	52	32	19	1				51	51						26	11,673
	32	16	11	5					16	16		2	19	5	51.00	9	7,500
	33	19	16	2	1				19	18						16	8,543
	34	24	18	6					24	24		1	5	41.40	16	11,406	
	35	29	22	7					29	29						19	9,100
	36	36	27	7		2			36	34						25	9,212
	37	33	26	7					33	31						23	8,086
	38	33	30	2	1				33	32						29	8,534
	39	33	26	7					33	32		1	5	47.00	23	8,130	
	40	21	14	7					21	21						11	7,363
41	23	19	4					23	23						18	8,361	
42	116	98	15	2	1	11	4	114	111	1		13	54.69	95	11,728		
43	51	44	6	1				51	50						42	10,923	
44	67	51	13	2	1			67	64						46	10,806	
45	21	9	10	2				21	19						9	11,611	
46	21	17	4					21	21						16	9,468	
47	33	24	8		1			33	32						23	9,052	
48	16	7	8					16	14		1	7	71.66	6	7,166		
49	21	17	3	1				21	19						16	7,918	
50	34	22	11	1				33	32		1	2	45.85	17	8,688		
51	32	24	8					32	32						24	8,166	
52	23	15	7		1			22	22						14	8,007	
53	27	14	13					27	27						11	7,772	
54	25	27	8					25	25						26	6,069	
55	26	14	10	2				26	24						13	9,076	
56	76	47	27	1	1			74	74						25	4,348	
57	55	44	16	2				60	60						17	3,764	
58	70	50	19		1			69	67						18	3,794	
59	33	1	12					33	13						11	2,927	
60	33	9	5					33	14						5	6,120	
61	15	9	5					15	14						5	5,200	
62	16	10	6					16	16						5	5,200	
44	1	210	181	23	1	5	210	5	5	204	202	1	14	57.14	171	15,990	
	3	12	10	1					11	11					10	9,700	
	4	61	49	9	2	1			58	54					42	11,150	
	5	32	28	3					31	31		1	2	38.00	26	11,684	
	6	15	15						15	15						15	20,600
	7	184	154	29					183	181						139	12,333
	8	50	45	4		1			49	48		2	23	42.08	43	17,379	
	9	66	48	16		2			64	64						44	9,370
	10	34	31	3					34	34						29	12,482
	11	42	38	4					42	41						36	11,208
	12	49	39	8	2				47	47		1	7	50.14	37	10,594	
	13	53	48	3		2			51	50						46	10,130
	14	52	39	13					52	47						36	9,925
	15	43	39	3	1				42	42						38	9,678
	16	36	27	9					36	35						24	9,750
	17	40	38	2					40	40						38	12,460
	18	42	35	7					42	42		1	6	42.18	33	11,121	
	19	55	38	14	3				52	50						33	8,133
20	45	37	8					45	44		1	7	69.00	34	9,905		
21	25	19	5	1				24	23						16	9,375	
22	45	33	10	1	1			43	43		1	9	41.55	26	9,430		
23	112	71	37	3				111	108						54	9,874	
24	51	34	14	1				50	50						31	9,310	
25	50	35	11	2				47	47						29	11,293	
26	30	25	5		1			30	30						23	9,500	
27	43	42	6					43	43						41	9,317	
28	40	28	12					40	40		1	12	54.25	23	9,934		
29	32	26	6					32	32						24	9,166	
30	40	34	6					40	40						31	8,596	

<sup>1</sup>For renter - occupied dwelling units and vacant nonseasonal not dilapidated units, for rent.  
<sup>2</sup>For owner - occupied dwelling units and vacant nonseasonal not dilapidated units, for sale only.

Table 3.—CHARACTERISTICS OF HOUSING FOR CENSUS TRACTS, BY BLOCKS: 1950—Con.

Table with columns: Census tract, Block, All dwelling units by occupancy and tenure, All dwelling units by condition and plumbing facilities, Occupied dwelling units, Contract monthly rent, Value of one-dwelling-unit structures.

For renter - occupied dwelling units and vacant nonseasonal not dilapidated units, for rent. For owner - occupied dwelling units and vacant nonseasonal not dilapidated units, for sale only.



















HOUSING—BLOCK STATISTICS

Table 3.—CHARACTERISTICS OF HOUSING FOR CENSUS TRACTS, BY BLOCKS: 1950—Con.

Census tract	Block	All dwelling units by occupancy and tenure					All dwelling units by condition and plumbing facilities			Occupied dwelling units			Contract monthly rent <sup>1</sup>		Value <sup>2</sup> of one-dwelling-unit structures			
		Total	Owner occupied	Renter occupied	Vacant non-seasonal not dilap., for rent or sale	Other vacant and non-resident	Number reporting	No private bath or dilap.	No running water or dilap.	Total	Persons per room		Occupied by non-white	Number reporting	Average monthly rent (dollars)	Number reporting	Average value (dollars)	
											Number reporting	1.51 or more						
59	23	17	14	2		1			17						13	12,307		
	24	65	60	4		1			65				1	81.25	59	13,030		
	25	6	4	2					6				2		4	17,750		
	26	18	14	3	1				17				3	34.00	13	10,576		
	27	29	22	6					28				7	47.42	21	9,609		
	28	13	12	1					13						11	8,863		
	29	9	7	2					9				1		7	9,142		
	30	69	60	9					69				8	52.25	60	12,913		
	31	45	40	5					45				5	41.40	39	12,412		
	32	96	64	31		1		2	95		1		30	49.20	61	12,357		
	33	25	12	9	1	3			21				10	42.30	10	6,370		
	34	53	44	8	1			1	52			1	8	59.12	42	11,511		
	35	79	47	32					79				31	50.19	41	10,573		
	36	25	22	3					25				3	56.66	20	11,500		
	37	31	29	2					31				2		28	11,732		
	38	40	40						40						40	11,765		
	39	40	35	5					40				2	69.00	34	11,817		
	40	37	35	2					36				4		34	11,985		
	41	14	12	1		1			14				1		12	12,750		
	42	38	29	9					38				1	42.55	27	10,351		
	43	51	38	12	1				51				11	47.27	37	11,310		
	44	40	33	7					40				7	46.57	31	10,209		
	45	5		5					5				5	36.80				
	46	27	20	7					27				7	52.28	19	9,231		
	47	14	11	3					14				3	61.66	8	11,062		
	48	43	33	10					43				10	48.80	32	10,187		
	49	26	20	5	1				25				5	47.40	19	10,157		
	50	27	19	8					27				7	42.85	19	11,236		
	51	27	21	6				1	27				6	62.16	17	10,176		
	52	23	21	1		1			23			1	1		21	10,976		
	53	26	21	4	1				26				5	65.20	20	11,750		
	54	25	21	4					25				5	55.66	19	13,184		
	55	27	23	4					27				3	53.00	20	12,275		
	60	1	1						1									
		2	26	17	7	1	1		26		2			6	40.00	16	12,075	
		5	5	5					5							5	15,300	
		6	14	12	1		1		13				1			11	15,954	
		7	36	29	3		4		36				1			27	15,251	
		8	8	7			1			8		1				7	10,500	
		9	28							28								
		11	52	37	12		3			52		1			11	55.72	35	12,394
		12	28	24	4					28		1			4	46.00	23	12,652
		13	27	22	3	1	1			25		1				21	12,047	
		15	39	28	27					39				1	48.65	9	8,777	
		16	49	26	19	4				45		1		22	75.90	19	10,594	
		17	23	25	3					28				3	45.00	23	13,108	
		18	22	18	3					23					73.40	17	13,058	
		19	40	19	3	1	1			22		1		2		17	18,294	
		20	24	27	12	1	1			40				10	60.60	24	12,104	
		21	51	37	18	1	1			51		7		18	42.61	28	9,596	
		22	44	27	15	1	1			44		1		15	42.40	25	9,240	
		23	55	33	2					55				1		2		
		24	31	25	5		1			29		1		4	35.00	22	11,659	
		25	45	45						45						43	12,069	
		26	12	8	4					12				4	36.25	8	12,250	
27		11	9	2					11				2		9	11,111		
28		11	7	1	2	1			11				1		7	11,142		
29		14	14						14						13	11,846		
30		13	13						13						13	12,461		
31		12	12						12						11	11,545		
32		9	9						9						9	13,555		
33		56	48	7	1			3	55				7	43.57	47	9,982		
34		22	18	4					22		3		4	36.75	18	10,861		
35		45	39	4					44		1		2		38	9,481		
37		15	6	8		1			15		4		8		4	9,000		
38		7	7						7					51.62				
39		38	19	18		1			37				17	58.14				
40		17	14	3				3	17		2		3	48.05	14	9,492		
41		30	27	1	2				30		1		1	18.33	13	9,461		
42		35	32	2		1			34				2		25	9,376		
43		22	18	4					21		1		4	41.50	16	8,575		
44		14	7	7					13		1		6	66.66	3	10,000		
45		31	13	17	1			4	30		3		16	40.75	11	9,409		
46		58	39	18	1				57		2		14	60.35	32	9,365		
47		34	29	4		1			33				3	60.00	27	9,829		
48		25	13	10	1	1			25		2		10	45.60	12	10,081		
49		12	9	3					12		1		2		8	11,625		
50		42	34	8					42				8	61.87	33	9,957		
51		15	15						15						14	13,500		
52		29	27	2					29				2		27	13,737		
53		15	15						15						14	11,392		
54		23	20	2					23				2		19	11,473		
55		47	41	4	1	1			47		1		4	45.00	38	11,615		
56		22	18	4					22				4	33.75	16	11,214		

<sup>1</sup>For renter—occupied dwelling units and vacant nonseasonal not dilapidated units, for rent.

<sup>2</sup>For owner—occupied dwelling units and vacant nonseasonal not dilapidated units, for sale only.













## HOUSING—BLOCK STATISTICS

Table 3.—CHARACTERISTICS OF HOUSING FOR CENSUS TRACTS, BY BLOCKS: 1950—Con.

Census tract	Block	All dwelling units by occupancy and tenure					All dwelling units by condition and plumbing facilities			Occupied dwelling units			Contract monthly rent <sup>1</sup>		Value <sup>2</sup> of one-dwelling-unit structures			
		Total	Owner occupied	Renter occupied	Vacant non-seasonal not dilap. for rent or sale	Other vacant and non-resident	Number reporting	No private bath or dilap.	No running water or dilap.	Total	Persons per room	Occupied by non-white	Number reporting	Average monthly rent (dollars)	Number reporting	Average value (dollars)		
67	74	25	22	3			25			25	25	1		2		22	8.561	
	75	42	35	6	1		42			41	41	1		6	65.00	35	8.482	
	76	48	38	10			48	3	1	48	48	4		9	58.22	38	8.078	
	77	43	34	7	2		43			41	41	3		8	70.00	32	8.546	
	78	33	27	5	1		33			32	32			5	69.80	26	8.507	
	79	21	18	3			21			21	20	1		3	83.33	17	8.582	
	82	1																
	83	1																
84	4		4			3			4	4	1		3	93.00				
68	1	6	3	3			6			6	6			3	47.00	3	11.800	
	2	19	8	11			19			19	19			11	53.27	4	11.500	
	3	19	9	10			19			19	19			10	65.10	5	8.780	
	4	14	6	7	1		14	2	2	13	12			7	41.28	2		
	5	10	3	3			10			10	10			7	56.42	2		
	6	19	14	5			19			19	19	1		4	46.25	14	8.292	
	7	19	18	1			19			19	19			1		18	11.861	
	8	26	26				26			26	26					26	9.683	
	9	111	53	53	5		110	1		106	106			55	66.89	38	11.292	
	10	150	34	110	3	3	149	6	6	144	143	1		113	65.26	19	9.347	
	11	48	15	29	4		47	11		44	44			29	38.93	10	8.120	
	12	27	10	15	1	1	27	4	1	25	25	2		14	37.71	4	9.672	
	13	30	9	21			30	7		30	30	2		20	32.95	7	6.240	
	14	41	12	29			41	1		41	41	2		29	45.86	9	6.388	
	15	32	15	17			32	3		32	32	1		17	48.64	11	7.912	
	16	25	8	17			25	3		25	25	1		15	30.80	6	8.250	
	17	25	11	14			25	5		25	25	1		14	33.14	10	8.157	
	18	28	16	11	1		28	2		27	27		1	12	46.00	13	6.838	
	19	22	13	9			21	2	2	22	22	1		8	48.25	12	7.422	
	20	34	15	17		2	34	3	3	32	32	1		16	32.68	12	7.708	
	21	30	18	11	1		30	6	6	29	29	1		12	49.16	16	7.468	
	22	40	15	25			40	2	1	40	40	1		25	30.36	9	8.133	
	23	31	9	21		1	30	10	3	30	30	1		21	32.80	5	6.200	
	24	33	18	15			33	12		33	32	4		14	33.64	10	7.502	
	25	33	18	10		1	28	5	5	28	28	1		10	38.90	15	7.568	
	26	44	21	21		2	43	7	3	42	42	3		21	41.14	17	5.772	
	27	32	21	10		1	29	8	7	31	28			8	40.50	15	6.888	
	28	30	20	9		1	30	6		29	29	1		14	30.37	15	7.880	
	29	1																
	30	25	14	10	1		24			24	24	3		8	30.37	10	6.200	
	31	31	18	13			31	14	13	31	31	3		13	38.15	10	6.820	
	32	25	19	6			25	4		25	25	2		6	37.33	14	7.442	
	33	22	21	4	1		26	3	3	25	25	1		5	55.60	20	6.912	
	34	26	20	6			26	1		26	26	1		6	46.16	19	7.112	
	35	31	18	8			31	6	2	31	31			7	53.28	19	6.668	
	36	23	18	5			23	3		23	23	2		5	47.60	14	6.827	
37	35	13	12			25	7	6	25	25	1		11	28.09	9	5.477		
38	34	4	10			34			34	34			10	37.00	23	6.824		
39	21	14	7			21	1		21	21	1		7	40.14	13	7.262		
40	28	13	13		2	28	1	1	26	26			13	39.53	11	9.129		
41	29	22	6		1	29			28	28			6	45.00	19	9.278		
42	52	22	27	1	2	52	2	2	49	49			26	56.69	17	9.200		
43	34	22	2			34			34	34			2		31	9.967		
44	29	24	5			29			29	29			5	51.00	20	9.172		
45	36	21	12	2	1	36			33	33			14	58.71	19	8.402		
46	39	27	10	2		39			37	36			11	52.27	22	7.454		
47	27	22	5			27			27	26			4	70.00	19	8.257		
48	77	55	19	3	3	77	2	2	74	74		1	21	42.71	51	7.202		
49	16	13	2			15			15	14			2		11	8.318		
50	29	20	8	1		29	1	1	28	28			7	41.28	18	7.702		
51	29	21	7		1	29			28	28			7	53.85	21	8.028		
52	30	25	4	1		30	1	1	29	29	1		5	68.20	24	8.412		
53	33	30	2			33			32	32			2		30	10.382		
54	30	30				30			30	30					28	10.382		
55	42	20	20	1	1	42			40	40			21	62.71	14	9.982		
56	22	27				22	6	6	22	22	1		26	44.69	15	7.882		
57	34	19	14	1		33	2	2	33	33			15	47.93	14	7.724		
58	33	21	12			33			33	33		1	12	57.66	14	7.882		
59	19	9	10			19	6	6	19	19	2		10	35.20	7	8.257		
60	29	16	12	1		29	4	1	28	28	1		12	43.00	14	7.924		
61	27	20	6	1		27	1	1	26	26		1	7	43.85	18	8.582		
62	48	30	16		2	48	3	3	46	45	1		14	37.64	27	8.214		
63	37	31	6			37	3	1	37	36		2	3	38.33	29	7.414		
64	49	31	17	1		49	2	2	48	48			18	46.16	28	7.882		
65	21	15	5	1		20			20	20	1		5	36.80	13	9.414		
66	23	16	7			23			23	23			7	46.14	15	7.414		
67	19	14	3	2		19			17	17			3	33.75	4	7.882		
68	22	19	3			22	1		22	22			2		19	7.882		
69	21	12	8		1	21	2	2	20	20			5	31.60	10	8.257		
70	35	21	12		2	35	7	6	33	33	1		12	44.66	19	6.172		
71	25	17	7		1	25	1	1	24	24	2		7	44.00	14	6.714		
72	25	2				25			25	25	1		16	2	23	8.257		
73	26	20	6			26			26	26			9	41.25	19	8.257		
74	45	28	17			45	4	4	45	45	1		10	36.58	23	7.257		
75	22	21	1			22			22	22			16		21	8.257		
76	19	13	4	2		19	3	3	17	17	1		10	40.50	12	7.257		

<sup>1</sup>For renter-occupied dwelling units and vacant nonseasonal not dilapidated units, for rent.<sup>2</sup>For owner-occupied dwelling units and vacant nonseasonal not dilapidated units, for sale only.

Table 3.—CHARACTERISTICS OF HOUSING FOR CENSUS TRACTS, BY BLOCKS: 1950—Con.

Census tract	Block	All dwelling units by occupancy and tenure					All dwelling units by condition and plumbing facilities			Occupied dwelling units			Contract monthly rent <sup>1</sup>		Value <sup>2</sup> of one-dwelling-unit structures	
		Total	Owner occupied	Renter occupied	Vacant non-seasonal not dilap. for rent or sale	Other vacant and non-resident	Number reporting	No private bath or dilap.	No running water or dilap.	Total	Persons per room	Occupied by non-white	Number reporting	Average monthly rent (dollars)	Number reporting	Average value (dollars)
										Number reporting	1.51 or more					
68	77	25	21	4		25	2	2	25	25	1	10	4	42.75	21	7,361
	78	20	15	4		20	4	3	19	19	1	10	3	41.66	15	5,240
	79	18	14	3		18	4	3	17	17	1	8	2		12	6,708
	80	20	12	7	1	20	4	2	19	18		3	7	47.14	10	5,380
	81	21	16	4		21	4	4	20	20	1	6	4	48.00	15	7,693
	82	24	22	2		24	2	2	24	24	1	11	1		21	6,990
	83	35	28	7		35			35	35	3	10	6	46.83	27	7,307
	84	17	16	1		17			17	17	2	8	1		16	8,743
	85	11	9	2		11	1	1	11	11		2	2		9	8,822
	86	7	6	1		7			7	7		5	1		6	7,966
	87	16	14	2		16	2	2	16	16		11	2		14	7,321
	88	18	14	4		18	2	2	18	18		7	4	46.25	13	6,576
	89	24	15	7		23	1	1	22	20	2	9	7	33.14	12	7,458
	90	50	2	44	1	48	3	3	46	44		4	4	32.86	2	
	91	28		26	2	28			26	26		28	28	36.00		
	92	27	19	8		27	4	1	27	27		8	8	37.87	15	7,426
	93	2														
	94	2														
	95	10	10			10			10	10		5			9	6,733
	96	46	23	22		45	14	14	45	44	3	22	22	41.22	19	8,447
	97	51	24	25	2	50	11	7	49	48	1	1	24	35.87	18	7,544
	98	12	12			11			12	11					11	8,518
	99	25	21	4		24			25	25			4	79.50	20	7,195
	100	31	15	15	1	31			30	29		15		62.06	11	8,263
	101	18	11	5	2	18	2		16	15	2	5	5	68.20	9	8,055
	102	14	7	6	1	14			13	13		4	4	35.75	7	8,785
	103	17	3	13	1	17			16	16	1	13	13	53.30	2	
	104	16	4	12		16			16	16	1	12	12	43.83	3	9,000
	105	5	4	1		5	2		5	5	1	1	1		4	5,875
	106	19	15	4		19			19	19		4	4	44.75	13	6,546
	107	20	15	5		19	1		20	20	1	1	5	45.60	13	8,000
	108	15	8	7		15			15	15		7	7	55.00	6	7,583
	109	11	5	5	1	11			10	10		5	5	65.60	5	8,100
	110	12	10	2		11	1	1	12	12		1	1		10	8,790
	111	2														
	112	1														
	113	3	2	1		3	2	2	3	3	1	1	1		1	
	114	4	3	1		4			4	4		1	1		2	
	115	16	12	4		16	1	1	16	16	1	4	4	52.00	11	7,045
	116	14	6	8		14			14	14		8	8	60.62	6	8,250
	117	9	6	3		9			9	9		3	3	56.66	6	7,500
	118	25	18	6	1	25			24	24		6	6	46.83	17	7,188
	119	22	16	6		22	1	1	22	22	2	5	5	62.00	16	7,018
	120	26	19	7		25			26	25		6	6	35.83	17	7,229
	122	1														
	124	1														
	125	2														
69	1	32	21	9		31			30	29		8	8	69.12	15	10,333
	2	22	16	3	2	22			19	19		4	4	53.75	15	9,986
	3	8	5	2	1	8			7	7		3	3	48.66	4	8,500
	4	19	17	2		19			19	19		2	2		16	9,125
	6	123	74	28	2	116	73		102	101	14	27	27	49.51	13	8,807
	7	36	34	2		36			36	36		2	2		34	10,044
	8	18	16	1		18			17	17		1	1		16	9,756
	9	17	13	4		17			17	17		4	4	39.25	12	11,141
	10	43	32	10	1	43			42	42		9	9	51.77	30	9,453
	11	14	11	3		14	1	1	14	14		3	3	48.33	11	7,000
	12	12	12			12			12	12	1				12	7,250
	13	12	11			12			11	11					11	7,954
	14	86	17	55	14	86	1	1	72	72	26	53	53	70.69	14	8,357
	15	45	31	13		45			44	44		11	11	63.00	24	9,437
	16	79	43	33	2	78	3		76	76	1	31	31	39.54	34	8,335
	17	28	14	14		28			28	28		14	14	48.64	10	6,840
	18	24	13	11		24			24	24		10	10	36.00	9	8,833
	19	11	2	9		11			11	11		9	9	29.44	2	
	20	47	27	17	1	46	4		44	44		12	12	43.16	20	8,100
	21	60	41	13	2	60			54	53	1	12	12	53.00	37	8,440
	22	53	39	10		52			49	47	2	8	8	38.50	35	9,571
	23	30	24	6		29	2		30	29		6	6	37.16	23	8,913
	24	26	20	6		26	1		26	26	1	6	6	47.83	19	8,315
	25	44	32	11		44	2	1	43	42		10	10	50.80	28	8,464
	26	32	16	14		32			30	30		13	13	41.84	11	7,500
	27	21	9	12		20	2	2	21	20		11	11	46.36	5	8,200
	28	28	19	9		28	2	2	28	28	1	8	8	45.75	16	8,437
	29	41	27	14		41	1	1	41	41	3	13	13	42.69	18	7,777
	30	35	24	11		35	3		35	35	3	10	10	42.90	21	8,333
	31	24	22	2		24	3	1	24	24	1	1	2		18	7,055
	32	30	23	7		30	4	1	30	30	1	7	7	51.42	19	8,105
	33	24	17	6	1	23			23	21	1	1	4	42.50	16	7,587
	34	13	11	1		13			12	12		1	1		11	9,818
	35	13	13		1	13			13	13					13	6,730
	36	37	23	13	1	36			36	35		11	11	45.81	20	9,225
	37	50	30	20		50	5	5	50	50	1	19	19	51.00	26	7,942
	38	14	11	3		14			14	14		3	3	31.00	11	7,136
	39	24	16	4	3	24			20	20		7	7	55.00	15	8,600

<sup>1</sup>For renter—occupied dwelling units and vacant nonseasonal not dilapidated units, for rent.  
<sup>2</sup>For owner—occupied dwelling units and vacant nonseasonal not dilapidated units, for sale only.

## HOUSING—BLOCK STATISTICS

Table 3.—CHARACTERISTICS OF HOUSING FOR CENSUS TRACTS, BY BLOCKS: 1950—Con.

Census tract	Block	All dwelling units by occupancy and tenure					All dwelling units by condition and plumbing facilities			Occupied dwelling units			Contract monthly rent <sup>1</sup>		Value <sup>2</sup> of one-dwelling-unit structures			
		Total	Owner occupied	Renter occupied	Vacant non-seasonal not dilap., for rent or sale	Other vacant and non-resident	Number reporting	No private bath or dilap.	No running water or dilap.	Total	Persons per room		Occupied by non-white	Number reporting	Average monthly rent (dollars)	Number reporting	Average value (dollars)	
											Number reporting	1.51 or more						
69	40	29	20	8		1			29	1	1			6	36.66	18	7961	
	41	33	23	8	1	1			33					9	44.77	20	6875	
	42	26	19	5	2				25					5	45.83	17	8588	
	43	29	22	5		1			28					5	43.80	20	8925	
	44	31	23	8					31				1	7	48.00	20	7085	
	45	29	25	4					29				3	4	34.25	23	6982	
	46	31	17	13		1			31	1	1			10	57.20	15	8393	
	47	31	22	9					31					9	50.88	19	7510	
	48	29	21	8					29					7	47.85	20	6940	
	49	34	26	8				1		34			2	8	58.50	21	8414	
	50	29	19	9	1				28	26				8	50.12	19	6742	
	51	29	21	8					29	29			1	7	45.42	19	7731	
	52	28	21	7					28	28				7	51.57	19	8642	
	53	31	24	7					31	31	1			6	58.90	20	8615	
	54	29	18	10	1				29	27				10	52.90	18	7666	
	55	21	14	7					21	21				6	35.50	12	6833	
	56	28	15	10	1	2			28	25			1	10	41.20	12	6257	
	57	19	12	7					19	19			1	7	62.57	11	7754	
	58	34	22	10	2				34	32			1	10	39.90	20	10675	
	59	43	21	21		1			43	42			1	19	41.89	16	7656	
	60	21	11	9		1			21	20				9	58.88	9	7444	
	61	28	19	9					28	27	1		1	7	42.42	19	7742	
	62	29	22	5	2				27	26				5	49.00	20	7130	
	63	30	20	10					30	30	1			10	45.50	18	9094	
	64	33	21	9	2	1			33	30				8	51.12	21	10047	
	65	24	21	3					24	24	1			3	40.66	20	8850	
	66	44	19	23	1	1			44	42				24	34.43	11	8072	
	67	36	23	11	2				36	34			1	11	46.27	21	7404	
	68	28	16	10					28	28				9	43.44	15	7860	
	69	28	17	10					27	27				9	44.22	15	6866	
	70	24	17	7					24	24				7	57.42	17	7764	
	71	31	15	15		1			30	30			1	13	48.61	12	7491	
	72	22	14	8					22	22				7	47.85	12	8166	
	73	31	13	18					31	31	1			17	41.52	9	8433	
	74	19	16	3					19	19				4	46.66	14	9678	
	75	19	15	4					19	19			1	3	53.00	13	8615	
	76	25	16	9					24	25				4	37.88	13	8884	
	77	17	8	9					17	17				9	42.11	6	10166	
	78	18	7	11					18	17				7	43.36	6	9000	
	79	17	10	7					17	17				7	42.85	8	9937	
	80	37	25	11	1				36	36	2			12	50.25	22	7186	
81	40	22	17	1				40	39				17	46.11	13	7330		
82	19	9	9					19	18				8	46.12	6	8500		
83	22	8	14					21	21				14	49.28	4	10125		
84	29	11	18					29	29	1			18	40.55	6	9500		
70	1	23	18	5				23	23				5	51.00	18	10066		
	2	30	28	1				30	29					7	46.85	27	11322	
	3	37	29	7		1			36	35		1		3	50.00	27	10407	
	4	14	10	3					14	13				1	3	9.88	9	9888
	6	31	30	1	1				30	30				1	10.52	29	10320	
	7	25	21	3					25	24				2	7	10.71	18	10711
	9	22	13	8		1			21	19	2			2	70.71	12	10183	
	10	39	37	2					39	39				2	35	11.22	35	11222
	11	27	13	14					27	27	1		1	13	61.53	12	10333	
	12	14	10	4					14	14			1	4	40.25	8	10375	
	13	19	16	3					19	19				3	50.00	15	9866	
	14	13	12	1					13	13				1	11	10.45	11	10454
	15	10	3	7					10	9				7	47.00	2		
	16	22	16	6					22	20				5	55.00	11	8690	
	17	26	22	4					26	26				4	64.50	18	9250	
	18	28	17	10		1			27	26				10	37.90	14	5924	
	19	47	23	23					47	46				21	55.28	19	7368	
	20	65	43	19	2	1			65	62				21	62.14	42	9442	
	21	23	23						23	23				1	23	10.91	23	10913
	22	21	18	2		1			21	20				1	17	10.94	17	10941
	23	23	22	1					23	23				1	21	10.23	21	10238
	24	28	26		2				28	26				1	26	11.97	6	11976
	25	37	35	2					37	37				2	35	9.64	35	9645
	26	24	24						24	24				2	24	10.79	24	10795
	27	15	15						15	15				1	15	10.33	15	10333
	28	13	8	5					13	13				3	59.00	7	10142	
	29	14	13	1					14	14				1	14	9.84	13	9846
	30	23	21	2					23	23				2	21	9.60	21	9604
	31	24	21	2		1			24	23				2	21	8.92	21	8923
	32	24	19	5					24	24			2	5	52.00	19	9715	
	33	24	23	1					24	24				1	23	9.39	23	9391
	34	22	17	3	2				22	20				5	79.00	16	10068	
	35	27	22	4	1				27	26				5	97.00	20	10175	
	36	23	21	1	1				23	22				2	22	10.69	20	10690
	37	29	24	6		1			29	28				7	54.71	21	9295	
	38	28	24	4					28	28				3	63.66	23	10278	
	39	22	22						22	22				2	22	10.15	22	10150
	42	12	10	2					12	12			1	2	10	8.20	10	8200
	43	17	16		1				16	15				1	16	8.62	16	8625
	44	16	13	1	2				16	14				1	13	10.47	13	10476

<sup>1</sup>For renter—occupied dwelling units and vacant nonseasonal not dilapidated units, for rent.<sup>2</sup>For owner—occupied dwelling units and vacant nonseasonal not dilapidated units, for sale only.

Table 3.—CHARACTERISTICS OF HOUSING FOR CENSUS TRACTS, BY BLOCKS: 1950—Con.

Census tract	Block	All dwelling units by occupancy and tenure					All dwelling units by condition and plumbing facilities			Occupied dwelling units			Contract monthly rent <sup>1</sup>		Value <sup>2</sup> of one-dwelling-unit structures		
		Total	Owner occupied	Renter occupied	Vacant non-seasonal not dilap., for rent or sale	Other vacant and non-resident	Number reporting	No private bath or dilap.	No running water or dilap.	Total	Persons per room		Occupied by non-white	Number reporting	Average monthly rent (dollars)	Number reporting	Average value (dollars)
											Number reporting	1.51 or more					
70	45	12	10	2		12			12	12		1	2		9	9055	
	46	11	9			11	3	3	11	11					9	8544	
	47	6	6			6			6	6					6	8416	
	48	5	1	4		5			5	5					1		
	49	24	13	10		24			24	23		1	4	36.50	11	8381	
	50	30	22	8		30			30	30			10	39.00	21	8580	
	51	37	24	13		37	1	1	37	37		1	12	59.28	18	7683	
	52	22	21	1		22			22	22					20	9350	
	53	18	16	1		18			18	17			1		16	8581	
	54	18	16	1		18			18	18					16	8275	
	55	33	28	4		33	1	1	32	32			4	41.25	26	7430	
	56	33	28	4		32	1	1	33	33			4	50.00	28	7000	
	57	41	37	1		41	4	1	41	41			10	41.70	21	9523	
	58	37	30	6	1	37	1	1	36	35		1	2	42.00	27	9170	
	59	25	20	1	2	25		3	23	23			5		20	9740	
	60	14	14			14			14	14					14	12700	
	61	15	14	1		15			14	14			1		14	13392	
	62	13	12	1		13			13	13			1		11	12281	
	63	16	14	1	1	16			15	15			1		14	11671	
	64	16	14	1	2	16			16	16			2		14	12000	
	65	29	21	7	1	29			28	28			7	63.14	21	12004	
	66	30	30			30			30	30			1		30	13060	
	67	30	29	1		30			30	30			1		29	12672	
	68	29	28	1		29			28	28			1		28	11625	
	69	31	28	1	2	31	2	1	29	28		2	2		28	12028	
	70	34	29	4	1	34			33	33		2	2	65.00	26	7884	
	71	34	30	4	4	34		1	33	33			4	72.50	27	9003	
	72	35	32	2		35	2	2	33	34		2	2	40.16	26	8211	
	73	35	32	2	1	35			34	34			2		31	8629	
	74	22	18	4		22	1	1	22	22			4	32.25	16	7875	
	75	9	9			9			9	9					9	9766	
	76	26	19	6	1	26	3	3	25	25		2	2	63.33	16	7843	
	77	35	23	12		35	1	1	34	34			10	55.70	21	6766	
	78	30	23	7		30			30	30			11	51.27	14	7985	
	79	32	23	9		32	2	2	32	32			2	58.25	21	8323	
	80	37	25	11	1	37	2	2	36	36		2	2	52.75	22	7318	
	82	11	10	1		11			11	11					10	8940	
	83	22	16	1	5	22			22	22					16	9812	
	84	26	23	1		26	3	3	23	23			3	75.50	23	7426	
	85	39	23	16		39	7	6	39	39			16	42.31	19	7494	
	86	29	21	8		29			29	29		2	7	47.28	17	7429	
	87	29	18	9		29	4	2	27	27			9	36.00	16	8862	
	88	60	36	19	1	60	3	3	55	55			20	55.90	27	8674	
	89	25	19	6		25			25	24		1	6	49.66	16	8281	
	90	16	9	7		16	2	2	16	16			6	46.83	7	7142	
	91	20	14	6		20			20	20		1	6	54.00	12	8791	
	92	23	17	5	1	23	2	2	22	22		1	3	55.00	12	7750	
	93	16	13	1		16			16	16			5	46.66	11	9272	
	94	24	11	12	1	24	1	1	23	22			11	34.45	9	9277	
	95	27	19	7		27			26	25			6	54.16	15	8100	
	96	9	4	2		9	2	2	6	6		1	1		3	8566	
	97	35	19	15	1	35	1	1	34	34		1	15	39.46	18	9100	
	98	32	23	9		32	1	1	32	32			6	55.00	19	7294	
	99	32	24	8		32			32	32			8	45.75	21	9476	
	100	48	11	36	1	48	6	1	47	47		1	37	35.86	10	9400	
	101	19	13	5		19			18	18			3	55.00	11	8181	
	102	62	26	32	1	62	2	2	58	58			3	55.00	19	8457	
	103	97	77	19	3	97	10	13	96	94		10	19	50.78	61	9529	
	71	1	3	2	1		3			3	3				2		
		2	11	10	1		11			11	11			1	10	9400	
		3	18	18			18			18	18				18	8583	
		4	8	6	2		8			8	8			2	5	8800	
		5	16	12	3	1	16	1		15	15			55.00	10	10750	
		6	19	17	1		19			18	18			1	17	11041	
		7	20	19	1		20			19	19				19	10021	
		8	7	6	1		7			6	6				6	12080	
		9	7	6	1	1	7			7	7		1	1	5	11650	
		10	22	19	3		22	1	1	22	21			3	40.00	18	11244
		11	53	15	37		53			52	52		2	37	54.10	15	10886
		12	35	32	2	1	35			34	33			2		30	12410
13		26	24		1	26			24	24					24	11087	
14		18	14	3	1	18			17	17			3	46.00	14	9478	
15		30	26	3	1	30			29	29			3	50.00	24	9583	
16		22	21	1		22			22	21			1		21	10004	
17		74	68	5	1	74	1	1	73	69			4	52.75	14	11166	
18		33	29	4		33			33	30			3	28.66	27	9814	
19		36	25	10		36	3	3	35	31			4	37.75	22	11204	
20		39	31	4	1	39	1	1	35	35		1	8	58.25	30	9513	
21	20	16	4		20	1	1	20	20			3	44.33	16	10875		
22	25	19	4	2	25			23	23			4	41.50	19	9605		
23	16	12	2	1	16			14	14		1	4		10	8800		
24	13	10	3		13			13	13			4	60.33	10	9190		
25	36	30	6		36	1	1	36	35			4	47.50	24	10833		
26	31	23	7	1	31			30	30		1	6	60.83	19	10184		
28	27	21	6		27	2		27	27			6	43.16	17	9964		

<sup>1</sup>For renter - occupied dwelling units and vacant nonseasonal not dilapidated units, for rent.  
<sup>2</sup>For owner - occupied dwelling units and vacant nonseasonal not dilapidated units, for sale only.

HOUSING—BLOCK STATISTICS

Table 3.—CHARACTERISTICS OF HOUSING FOR CENSUS TRACTS, BY BLOCKS: 1950—Con.

Census tract	Block	All dwelling units by occupancy and tenure					All dwelling units by condition and plumbing facilities			Occupied dwelling units			Contract monthly rent <sup>1</sup>		Value <sup>2</sup> of one-dwelling-unit structures		
		Total	Owner occupied	Renter occupied	Vacant non-seasonal not dilap., for rent or sale	Other vacant and non-resident	Number reporting	No private bath or dilap.	No running water or dilap.	Total	Persons per room		Occupied by non-white	Number reporting	Average monthly rent (dollars)	Number reporting	Average value (dollars)
											Number reporting	1.51 or more					
71	29	40	32	8		40			40	40			6	721.6	30	964.3	
	30	17	14	2	1	17	1	1	16	16			3	653.9	14	1,164.2	
	31	26	19	5		26	3	3	26	26	2		7	404.2	19	1,107.8	
	32	6	5	1		6			6	6			1		5	1,090.0	
	33	3	3			3			3	3					3	983.1	
	34	24	21	3		24	3	3	24	23	1		2		19	1,003.6	
	35	24	23	1		24			24	24			1		23	1,213.0	
	36	29	24	5		29	1	1	29	29			2	50.80	21	1,064.2	
	37	10	8	2		10			10	10					6	1,558.0	
	38	13	13			13			13	13					13	1,470.0	
	40	3	1	2		3			3	3					1		
	41	2	1	1		2			2	2					1		
	42	3	3			3	1	1	3	3					3	13,794	
	43	6	3	3		6			6	6					3	10,666	
	44	3	3			3			3	3					1		
	45	21	18	3	1	21			20	20					18	16,466	
	46	26	25	1		26			26	26					24	15,295	
	47	24	22	2		24			24	24					21	16,452	
	48	28	26	2		28			28	26					25	17,376	
	49	147	136	11	2	147			142	142				5	135	13,215	
	50	290	122	140	27	290			262	261	2	2	164	91.81	112	12,571	
	51	22	19	3		22			22	21				3	77.33	18	12,805
	52	12	10	2		12			12	12				2	10	13,500	
	53	11	8	3		11			11	11				3	50.00	8	12,250
	54	26	20	5	1	26			25	23		1		3	18	12,972	
	55	27	26	1		27			27	27				1	26	13,980	
	72	1	108	90	14	1	3	107	3	1	104	102	1	9	85.66	90	14,004
		2	44	44				44			44	44				4	20,500
		3	3	3				3			3	3				3	20,666
		4	1	1				1			1	1				1	24,750
5		5	5				5			5	5				5	22,000	
6		5	5				5			5	5				5	22,000	
7		5	5				5			5	5				5	22,000	
8		4	4				4			4	4				4	22,500	
9		1	1				1			1	1				1	22,500	
10		3	3				3			3	3				3	27,333	
11		16	16				16			16	16				16	12,711	
12		37	33	4		37			37	37					37	12,862	
13		33	33			33			33	33					33	13,787	
14		20	20			20			20	21					20	12,250	
15		8	8			8			8	8					8	18,212	
16		14	14		1	14			14	14					14	15,714	
17		21	20	1		21			21	21					19	18,271	
18		30	29	1		30			30	30					29	15,706	
19		23	22	1		23			23	23					22	13,977	
20		18	18			18			18	18					18	18,972	
21		25	25			25			25	25					25	13,380	
22		27	27	6	2	27			27	33				5	27	10,701	
23		26	24	2		26			26	26					23	10,460	
24		9	8	1		9			9	9					8	16,250	
25		13	12	1		13			13	13					11	13,500	
26		27	24	3		27			27	27					22	16,818	
27		29	29			29			29	28					28	20,035	
28		4	4	55		4			4	63				54	9	19,222	
29		7	7	1		7			7	8					7	19,428	
30		13	13			13			13	13					13	24,153	
31	5	5			5			5	7					5	25,400		
32	7	7			7			7	7					7	24,214		
33	3	3			3			3	3					3	16,333		
34	5	5			5			5	7					5	27,800		
35	6	6			6			6	6					6	23,500		

<sup>1</sup>For renter-occupied dwelling units and vacant nonseasonal not dilapidated units, for rent.  
<sup>2</sup>For owner-occupied dwelling units and vacant nonseasonal not dilapidated units, for sale only.

OAKLAND, CALIFORNIA, BY CENSUS TRACTS: 1950  
KEY MAP

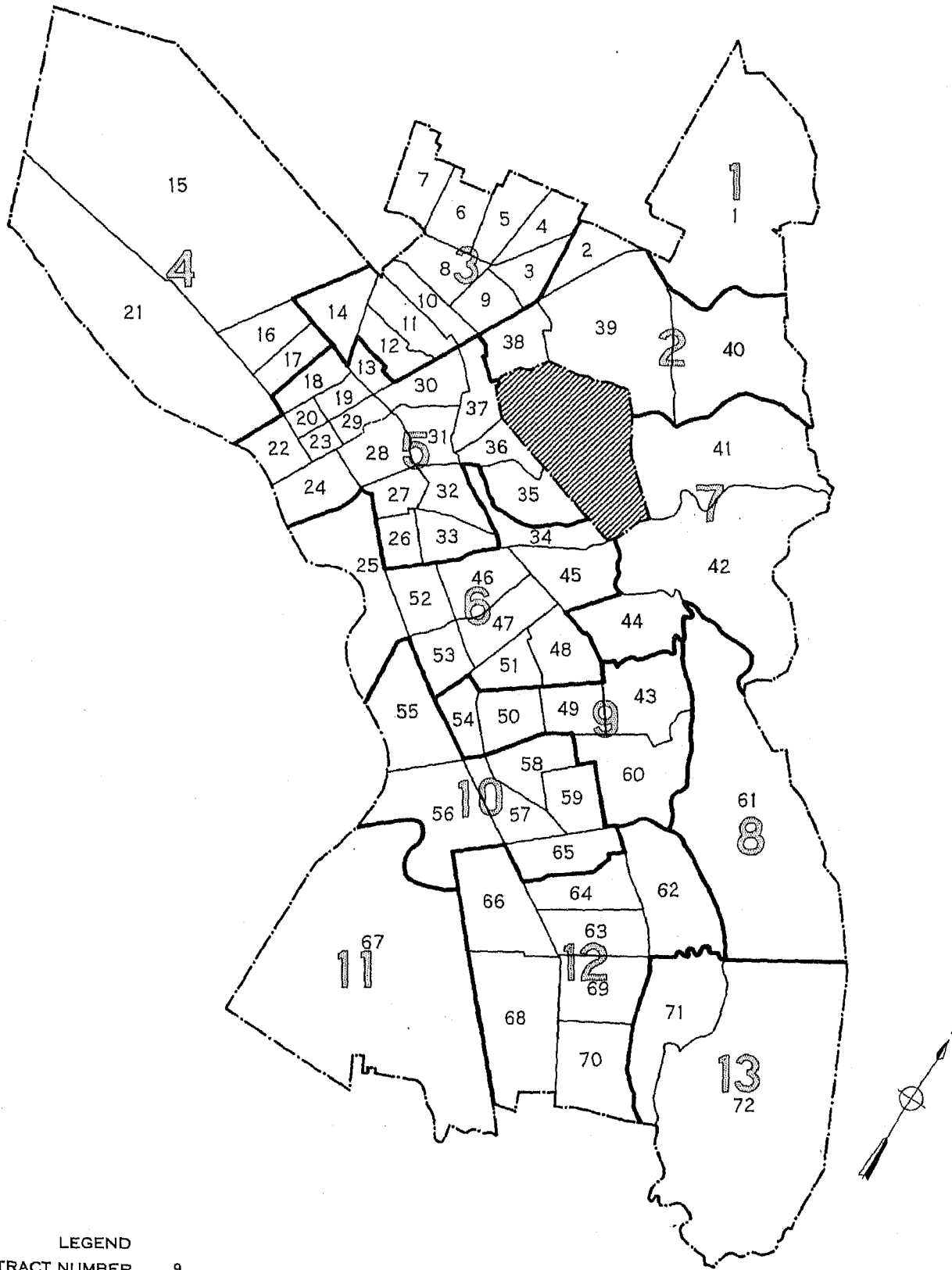

OAKLAND, CALIFORNIA, BY CENSUS TRACTS AND BLOCKS: 1950

PART 1 OF 13 PARTS

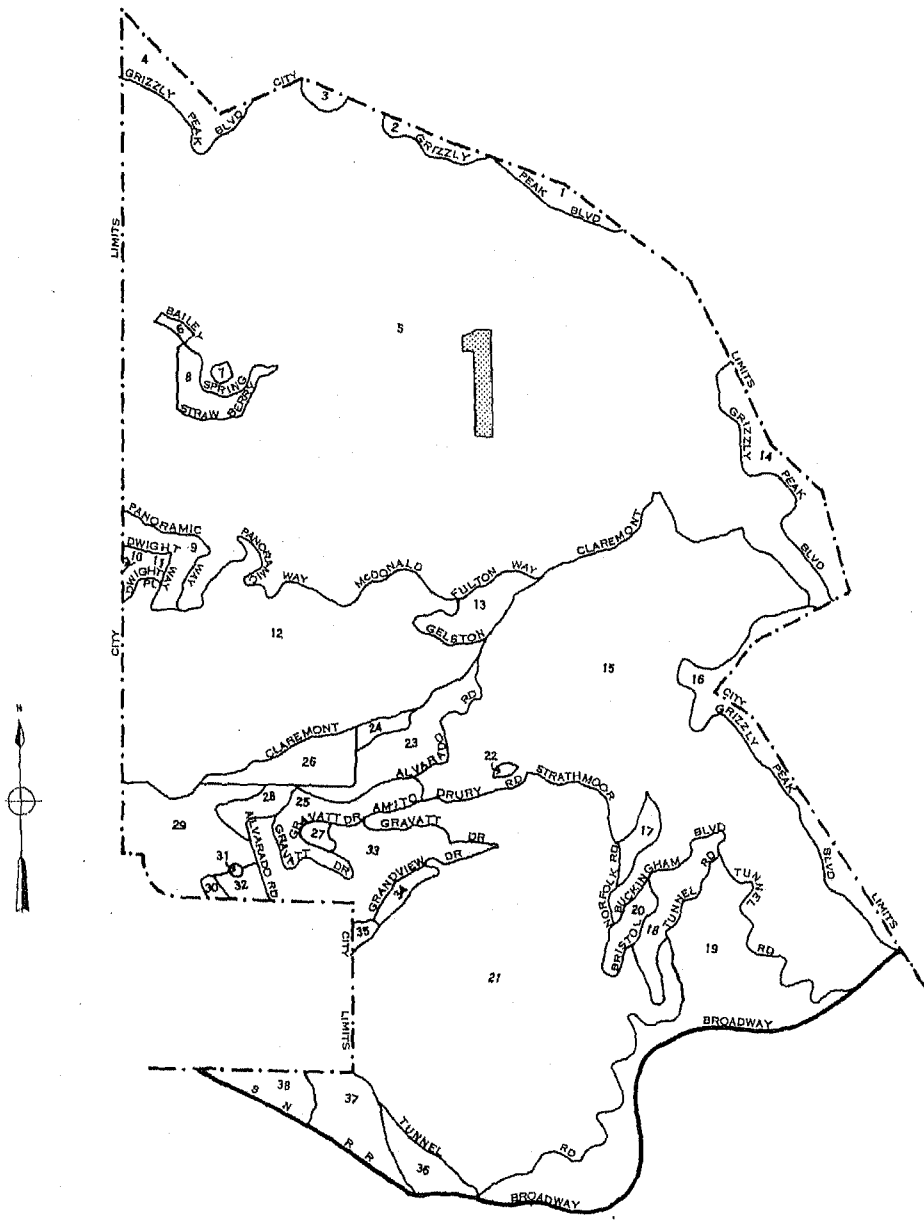

PART 2 ADJOINS

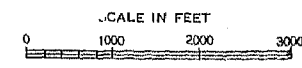

LEGEND

BLOCK NUMBERS 25

TRACT NUMBERS 2

TRACT BOUNDARIES

U.S. DEPARTMENT OF COMMERCE, BUREAU OF THE CENSUS

OAKLAND, CALIFORNIA, BY CENSUS TRACTS AND BLOCKS: 1950

PART 2 OF 13 PARTS

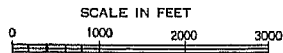

LEGEND

BLOCK NUMBERS

TRACT NUMBERS

TRACT BOUNDARIES

U.S. DEPARTMENT OF COMMERCE, BUREAU OF THE CENSUS

25

2



OAKLAND, CALIFORNIA, BY CENSUS TRACTS AND BLOCKS: 1950

PART 3 OF 13 PARTS

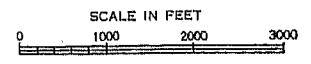

LEGEND

- BLOCK NUMBERS
- TRACT NUMBERS
- TRACT BOUNDARIES
- U.S. DEPARTMENT OF COMMERCE. BUREAU OF THE CENSUS

OAKLAND, CALIFORNIA, BY CENSUS TRACTS AND BLOCKS: 1950

PART 4 OF 13 PARTS

INSET

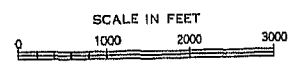
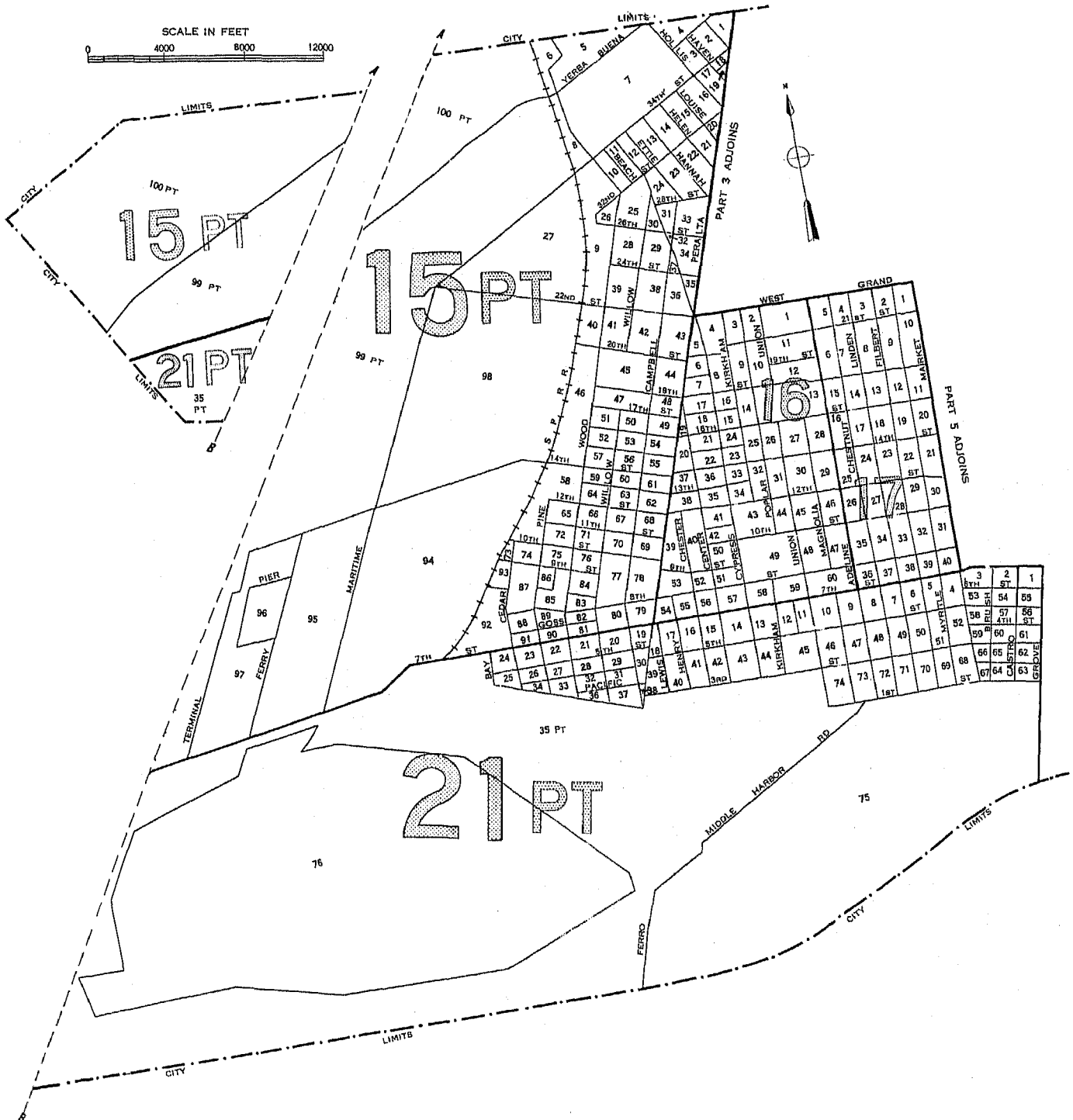

LEGEND

BLOCK NUMBERS

TRACT NUMBERS

TRACT BOUNDARIES

U.S. DEPARTMENT OF COMMERCE, BUREAU OF THE CENSUS

OAKLAND, CALIFORNIA, BY CENSUS TRACTS AND BLOCKS: 1950

PART 5 OF 13 PARTS



SCALE IN FEET



LEGEND

- BLOCK NUMBERS
- TRACT NUMBERS
- TRACT BOUNDARIES
- U.S. DEPARTMENT OF COMMERCE, BUREAU OF THE CENSUS

OAKLAND, CALIFORNIA, BY CENSUS TRACTS AND BLOCKS: 1950  
 PART 6 OF 13 PARTS

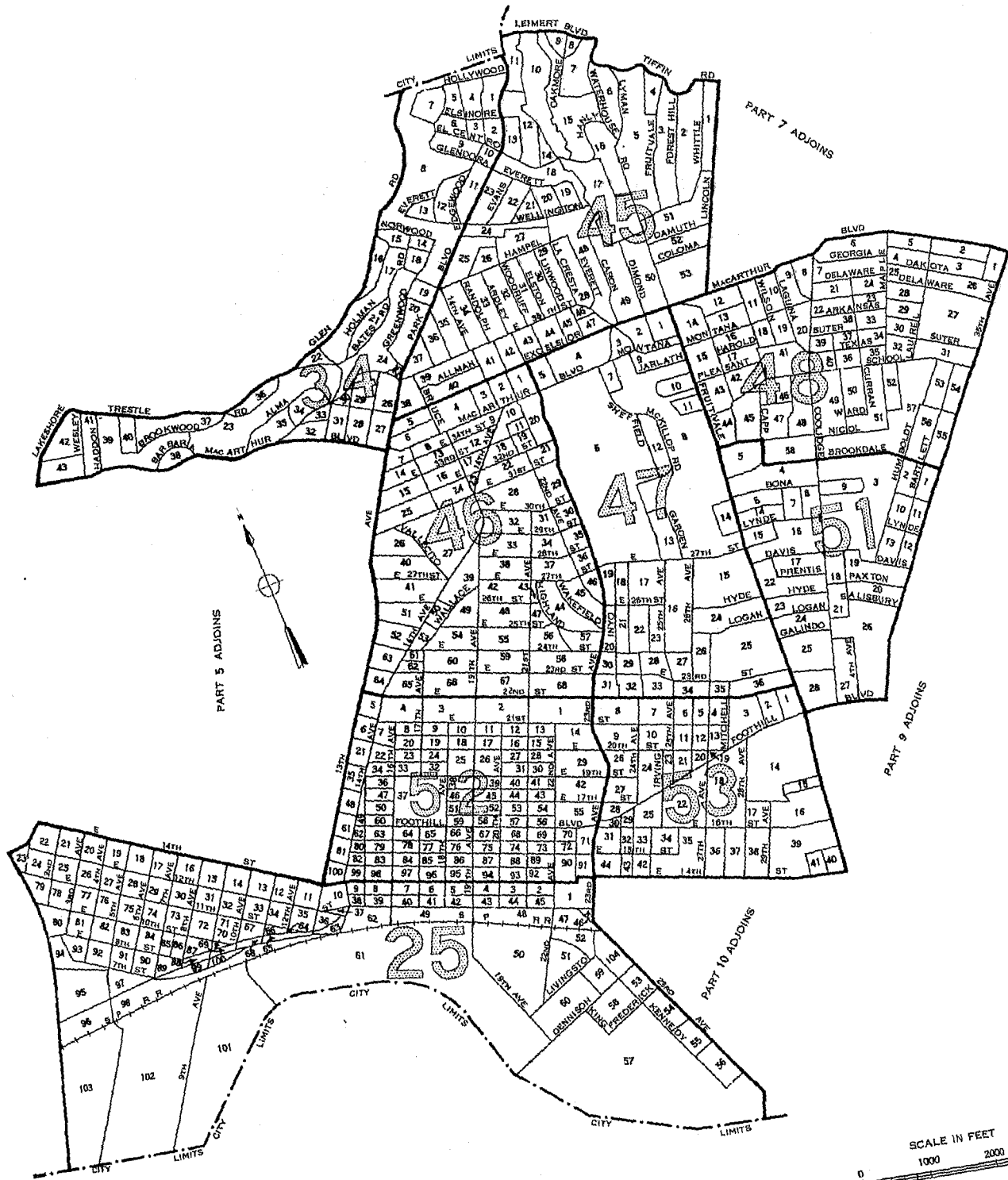

LEGEND

BLOCK NUMBERS  
 TRACT BOUNDARIES

U.S. DEPARTMENT OF COMMERCE, BUREAU OF THE CENSUS

OAKLAND, CALIFORNIA, BY CENSUS TRACTS AND BLOCKS: 1950

PART 7 OF 13 PARTS



LEGEND

- BLOCK NUMBERS
- TRACT NUMBERS
- TRACT BOUNDARIES
- U.S. DEPARTMENT OF COMMERCE, BUREAU OF THE CENSUS

OAKLAND, CALIFORNIA, BY CENSUS TRACTS AND BLOCKS: 1950

PART 8 OF 13 PARTS

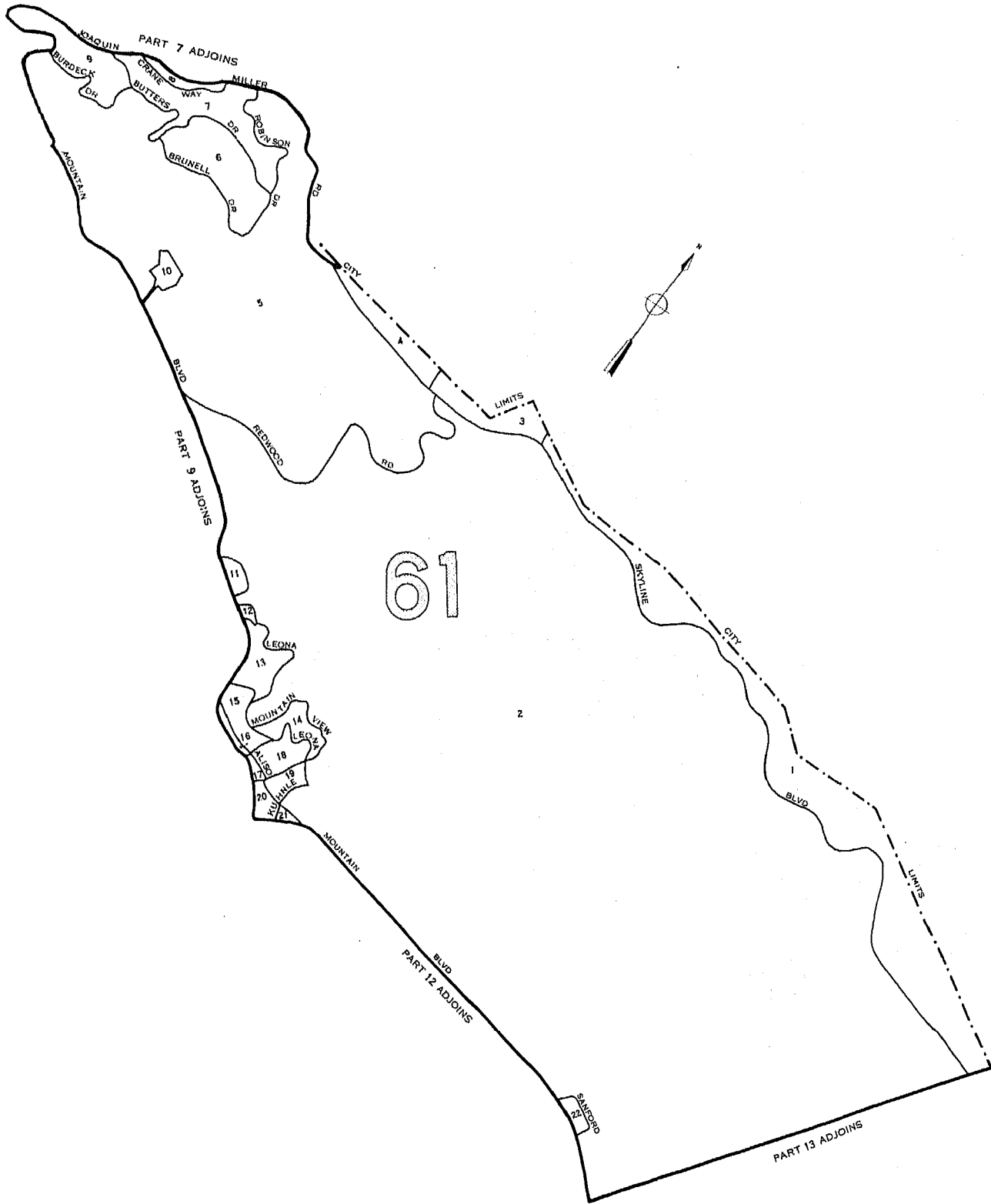

LEGEND

BLOCK NUMBERS  
TRACT NUMBERS  
TRACT BOUNDARIES

25  
2

U.S. DEPARTMENT OF COMMERCE, BUREAU OF THE CENSUS

OAKLAND, CALIFORNIA, BY CENSUS TRACTS AND BLOCKS: 1950

PART 9 OF 13 PARTS

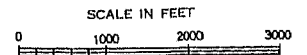
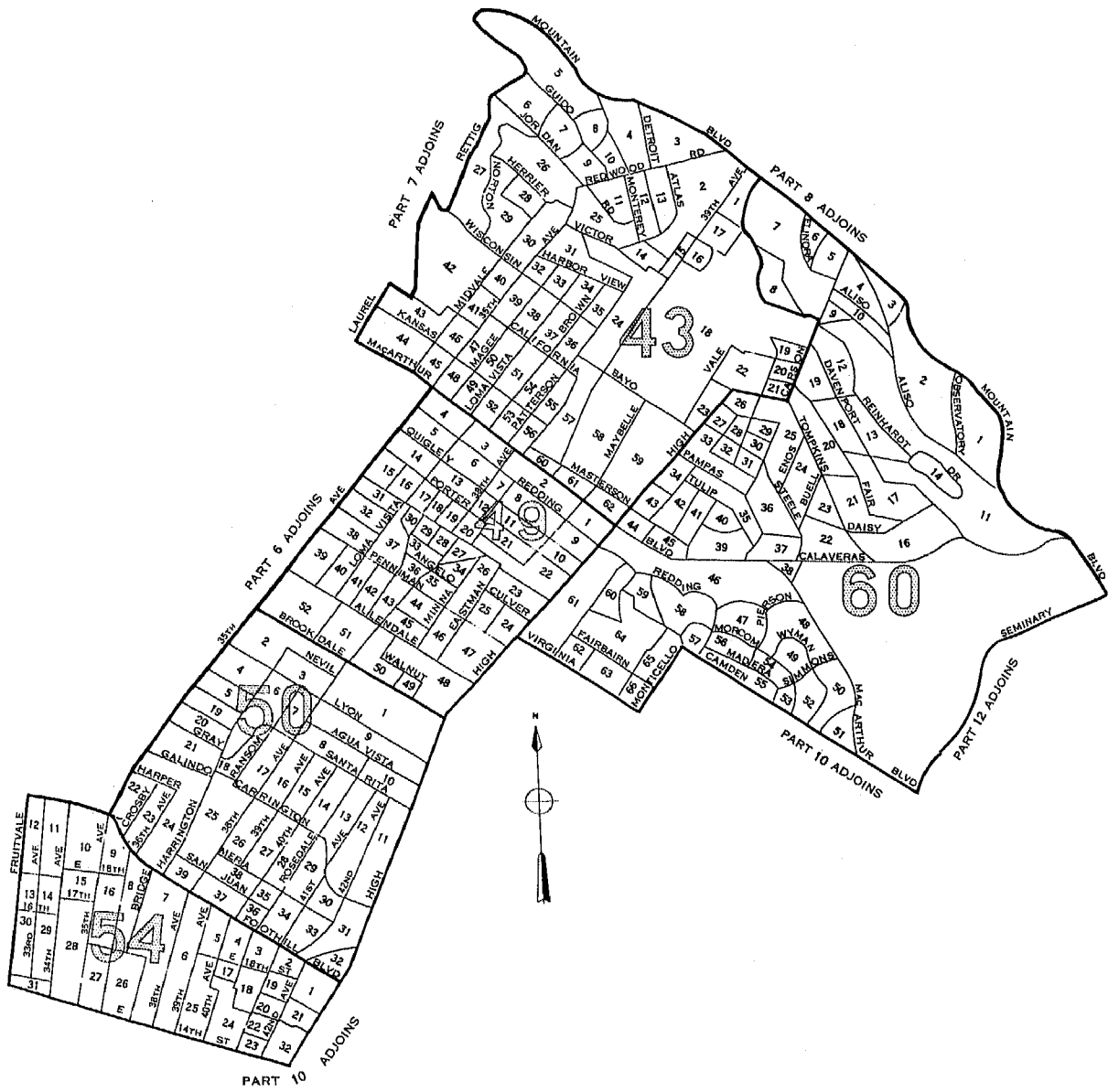

LEGEND  
BLOCK NUMBERS  
TRACT NUMBERS  
TRACT BOUNDARIES  
U.S. DEPARTMENT OF COMMERCE, BUREAU OF THE CENSUS

OAKLAND, CALIFORNIA, BY CENSUS TRACTS AND BLOCKS: 1950

PART 10 OF 13 PARTS

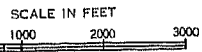

LEGEND  
BLOCK NUMBERS  
TRACT NUMBERS  
TRACT BOUNDARIES  
U.S. DEPARTMENT OF COMMERCE, BUREAU OF THE CENSUS



OAKLAND, CALIFORNIA, BY CENSUS TRACTS AND BLOCKS: 1950

PART 11 OF 13 PARTS

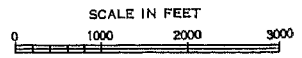
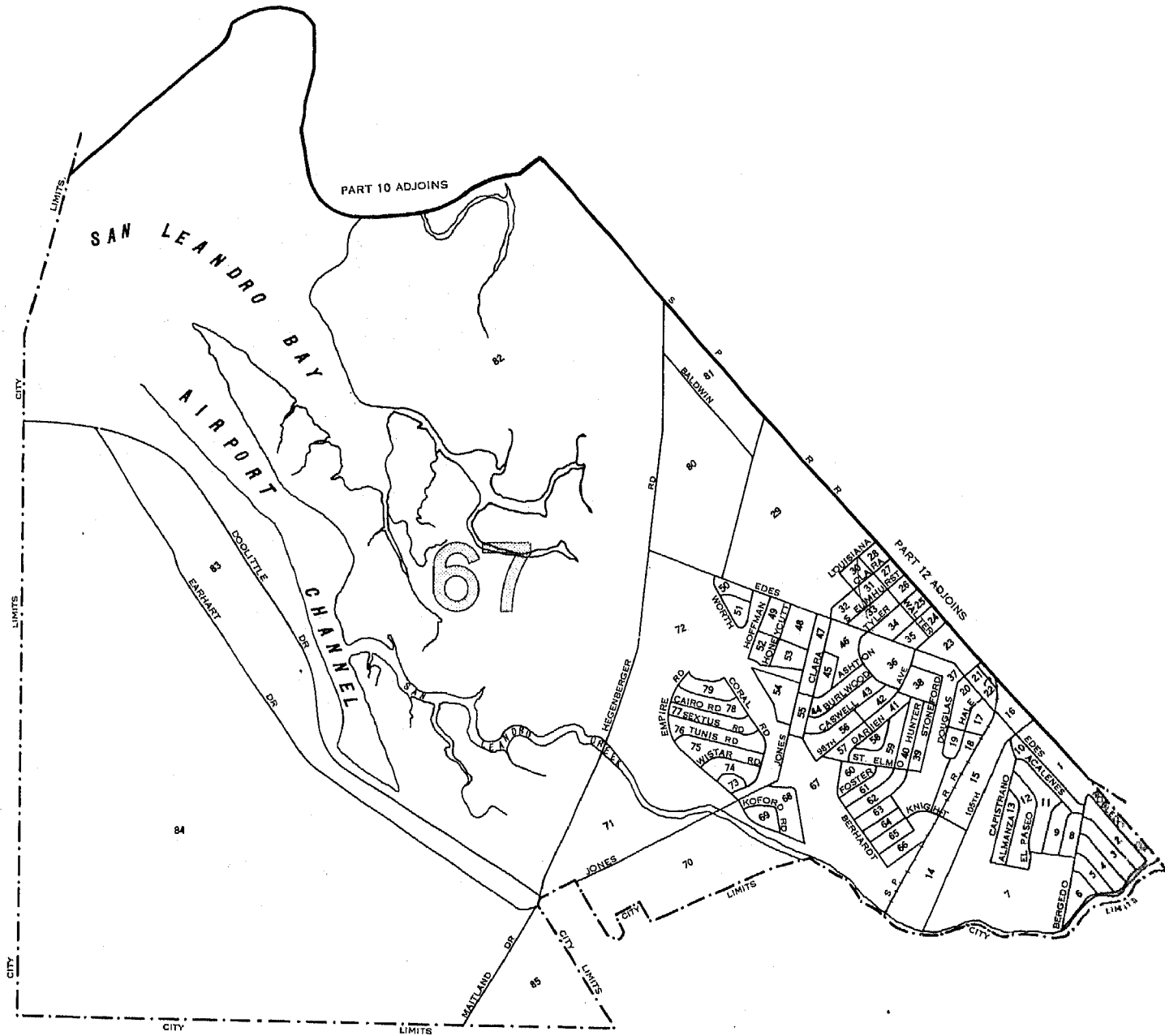

LEGEND

- BLOCK NUMBERS
- TRACT NUMBERS
- TRACT BOUNDARIES
- U.S. DEPARTMENT OF COMMERCE, BUREAU OF THE CENSUS

# OAKLAND, CALIFORNIA, BY CENSUS TRACTS AND BLOCKS: 1950

PART 12 OF 13 PARTS



LEGEND

BLOCK NUMBERS

TRACT NUMBERS

TRACT BOUNDARIES

U.S. DEPARTMENT OF COMMERCE, BUREAU OF THE CENSUS

OAKLAND, CALIFORNIA, BY CENSUS TRACTS AND BLOCKS: 1950

PART 13 OF 13 PARTS

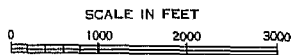
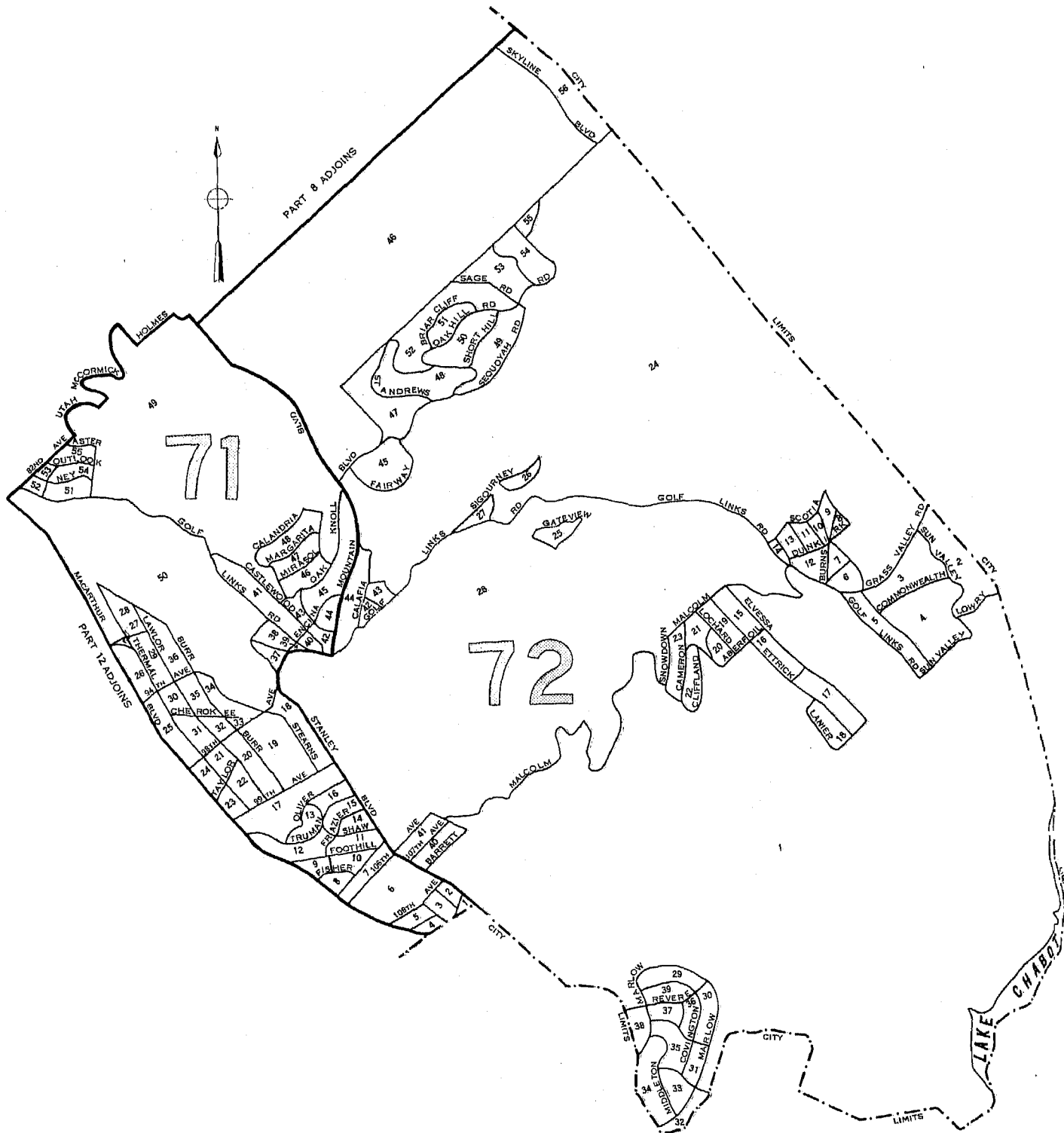

LEGEND

BLOCK NUMBERS 25

TRACT NUMBERS 2

TRACT BOUNDARIES

U.S. DEPARTMENT OF COMMERCE, BUREAU OF THE CENSUS