

U.S. CENSUS OF HOUSING: 1960

Series HC(3)-312

CITY BLOCKS

Dayton, Ohio

Prepared under the supervision of
WAYNE F. DAUGHERTY, Chief
Housing Division



U.S. DEPARTMENT OF COMMERCE

Luther H. Hodges, Secretary

BUREAU OF THE CENSUS

Richard M. Scammon, Director (From May 1, 1961)

Robert W. Burgess, Director (To March 3, 1961)

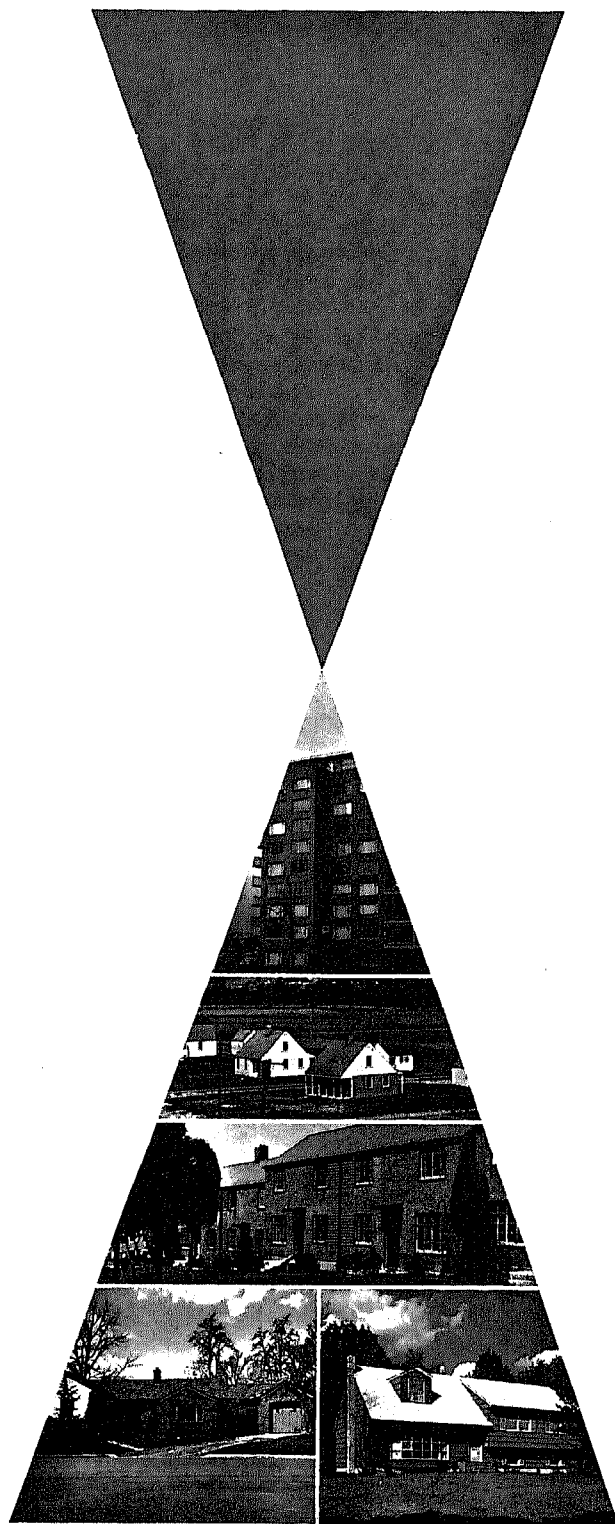



BUREAU OF THE CENSUS

RICHARD M. SCAMMON, *Director* (From May 1, 1961)
ROBERT W. BURGESS, *Director* (To March 3, 1961)

A. ROSS ECKLER, *Deputy Director*
HOWARD C. GRIEVES, *Assistant Director*
CONRAD TAEUBER, *Assistant Director*
MORRIS H. HANSEN, *Assistant Director for Statistical Standards*
CHARLES B. LAWRENCE, JR., *Assistant Director for Operations*
WALTER L. KEHRES, *Assistant Director for Administration*
CALVERT L. DEDRICK, *Chief, International Statistical Programs Office*
A. W. VON STRUVE, *Acting Public Information Officer*

Housing Division—

WAYNE P. DAUGHERTY, *Chief*
DANIEL B. RATHBUN, *Assistant Chief*
BRULAH WASHBAUGH, *Special Assistant*
MILTON D. LIBBERMAN, *Chief, Coordination and Research*

Decennial Operations Division—GLEN S. TAYLOR, *Chief*
Electronic Systems Division—ROBERT F. DRURY, *Chief*
Field Division—JEFFERSON D. MCPHIB, *Chief*
Geography Division—WILLIAM T. FAY, *Chief*
Population Division—HOWARD G. BRUNSMAN, *Chief*
Statistical Methods Division—JOSEPH STEINBERG, *Chief*

Library of Congress Card Number: A61-9347

SUGGESTED CITATION

U.S. Bureau of the Census. *U.S. Census of Housing: 1960. Vol. III, City Blocks.*
Series HC(3), No. 312.
U.S. Government Printing Office, Washington, D.C., 1961.

For sale by the Superintendent of Documents, U.S. Government Printing Office, Washington 25, D.C.
or any of the Field Offices of the Department of Commerce — Price 35 cents.

Table 1.—CHARACTERISTICS OF HOUSING UNITS, FOR THE CITY: 1960

Subject	Number	Percent	Subject	Number	Percent
All housing units.....	83,884	100.0	Occupied housing units—Con.		
CONDITION AND PLUMBING			COLOR		
Sound.....	71,738	85.5	White.....	65,155	81.3
With all plumbing facilities.....	66,726	79.5	Nonwhite.....	14,960	18.7
Lacking some or all facilities.....	5,012	6.0			
Deteriorating.....	10,013	11.9	PERSONS PER ROOM		
With all plumbing facilities.....	7,065	8.4	1.00 or less.....	71,123	88.8
Lacking some or all facilities.....	2,948	3.5	1.01 or more.....	8,992	11.2
With flush toilet.....	2,773	3.3			
No flush toilet.....	175	0.2	AVERAGE NUMBER OF ROOMS		
Dilapidated.....	2,133	2.5	Owner occupied.....	5.6	...
			Renter occupied.....	3.9	...
Occupied housing units.....	80,115	100.0	VALUE AND RENT		
TENURE			Average value.....dollars..	13,100	...
Owner occupied.....	44,231	55.2	Average contract rent.....dollars..	69	...
Renter occupied.....	35,884	44.8			

NOTE.—On the map for Dayton approximately 2,760 blocks are identified.

Table 2.—CHARACTERISTICS OF HOUSING UNITS, BY BLOCKS: 1960

["Total population" contains no persons in group quarters unless preceded by asterisk; one asterisk (*) denotes less than 10 percent; two asterisks (**), 10 percent or more]

Blocks within census tracts	Total population	All housing units by condition and plumbing									Occupied housing units							
		Total	Sound			Deteriorating			Dilapidated	Owner occupied			Renter occupied			Occupied by non-white	1.01 or more persons per room	
			Total	With all plumbing facilities	Lacking some or all facilities	Total	With all plumbing facilities	Lacking some or all facilities		Total	Average value (dollars)	Average number of rooms	Total	Average contract rent (dollars)	Average number of rooms			
1-1.....	**2158	744	637	442	195	99	51	48	...	8	43	29000	6.6	621	62	2.7	.9	128
2....	*289	118	103	72	31	15	3	12	1	115	66	3.0	2	17
5....	44	34	34	29	5	4	26	65	2.8	2	2
6....	**85	36	36	24	12	35	56	2.6	...	2
7....	**205	10	10	10	8	82	2.9
9....	**132	2
10....	2	2
11....	20	14	14	14	1	12	65	2.5
12....	*258	169	158	141	17	11	11	9	36000	6.4	135	67	2.3	...	19
16....	**28	10	8	6	2	2	2	1	3	2
17....	22	11	11	5	6	3	7	47	2.7	...	2
18....	**184	77	64	19	45	13	5	8	6	31000	6.3	64	55	2.2	...	12
19....	*231	78	50	38	12	28	22	6	6	...	7.2	68	62	4.0	...	14
20....	**253	4
21....	*86	39	36	17	19	2	...	2	4	27	51	2.6	2	10
23....	29	23	23	20	3	4	14	70	2.8	...	3
24....	290	117	82	40	42	28	8	20	7	3	...	100	57	2.5	2	44
1-2.....	**2522	935	557	292	265	282	115	166	1	96	71	14000	6.2	741	63	2.7	177	211
1....	**190	25	25	25	2	23	118	1.1
2....	31	23	23	18	5	20	61	2.9	...	1
3....	**92	40	40	39	1	2	37	83	2.2	1	3
4....	31	7	7	4	3	1	6	43	3.8	2	3
5....	410	165	23	21	2	96	36	60	...	46	7	14000	7.0	118	60	2.4	22	55
6....	199	83	18	4	14	29	8	21	...	36	3	58	59	2.6	...	30
7....	290	128	64	31	33	64	23	41	16	11500	5.4	90	51	2.5	7	28
8....	53	18	18	18	18	54	3.1	1	6
9....	75	23	23	13	10	23	60	2.8	...	11
10....	**158	50	50	21	29	49	91	2.2	...	1
11....	**39	12	12	4	8	1	11	50	2.0	...	1
12....	**230	66	47	15	32	18	9	9	8	15500	6.6	57	60	3.5	13	15
13....	*297	111	80	24	56	31	21	10	15	15500	5.0	91	54	2.8	24	32
14....	*180	86	63	28	35	17	7	10	6	15000	7.0	62	69	2.8	50	16
15....	4	2
16....	43	10	5	5	...	5	4	1	2	7	84	6.1	6	2
17....	**55	25	25	10	15	25	45	1.1	1	1
18....	**145	61	32	11	21	22	7	14	1	7	5	12000	9.0	45	52	3.8	49	7
1-3.....	*728	606	524	190	334	77	26	51	...	5	7	19500	6.3	545	62	1.7	1	34
8....	5	2	1	1	...	3	2
11....	12	3
15....	1	1
16....	2	1
22....	11	10	10	2	8	10	60	2.1
24....	49	45	45	41	4	1	42	71	2.4	1	...
26....	4
28....	1	1
32....	**31	15	15	1	14	15	31	1.2	...	2
33....	28	10	10	4	6	1	9	117	3.2	...	1
36....	10	4
37....	20	5	1	1	...	2	2	2	4	2
40....	22	11	9	...	9	2	...	2	1	9	41	2.1

City Block Characteristics

Table 2.—CHARACTERISTICS OF HOUSING UNITS, BY BLOCKS: 1960—Con.

["Total population" contains no persons in group quarters unless preceded by asterisk; one asterisk (*) denotes less than 10 percent; two asterisks (**), 10 percent or more]

Blocks within census tracts	Total population	All housing units by condition and plumbing								Occupied housing units								
		Total	Sound			Deteriorating			Dilapidated	Owner occupied			Renter occupied			Occupied by non-white	1.01 or more persons per room	
			Total	With all plumbing facilities	Lacking some or all facilities	Total	With all plumbing facilities	Lacking some or all facilities		Total	Average value (dollars)	Average number of rooms	Total	Average contract (dollars)	Average number of rooms			
								With flush toilet										No flush toilet
90...	140	34	30	28	2	4	4	23	9500	5.5	11	65	5.1	...	9
91...	35	18	18	12	6	11	7000	4.5	1
92...	75	20	20	20	7	12500	5.3	13	70	4.9	...	2
93...	99	32	32	21	11	12	7500	4.8	20	55	4.1	...	5
94...	43	16	16	15	1	13	7000	5.3	3
95...	45	18	18	16	2	7	...	5.0	11	54	4.4	...	1
96...	242	79	39	37	2	40	29	11	28	8000	5.7	44	64	3.8	...	16
97...	228	69	44	41	3	25	18	6	1	...	41	7500	5.3	27	59	5.0	...	6
98...	223	55	27	27	...	28	25	3	24	9000	5.5	30	68	4.1	...	18
99...	137	43	21	16	5	21	18	3	...	1	14	7500	4.9	27	64	4.7	1	9
100...	124	40	36	28	8	4	1	3	10	7000	5.3	29	51	4.4	...	4
101...	85	26	25	23	2	1	1	15	6500	5.1	11	69	4.9	...	2
102...	40	19	19	9	10	8	...	4.1	9	46	3.7	...	1
103...	160	48	20	18	2	28	21	7	7	...	6.3	37	67	4.3	...	9
104...	57	25	8	8	...	17	9	8	5	...	4.2	17	58	3.8	...	2
105...	88	33	14	13	1	19	5	14	10	6500	5.3	21	54	3.0	...	10
2-3.....	*1620	504	500	498	2	3	3	1	453	22000	5.8	37	134	4.6	...	25
1...	32	11	11	11	8	12000	5.9	3
2...	46	17	14	14	...	2	2	1	10	13500	5.2	5	183	4.0	...	2
4...	23	7	7	7	7	26000	5.9
5...	30	8	8	8	8	24000	5.9	1
6...	60	18	17	17	...	1	1	14	16000	5.2	2	2
8...	45	13	13	13	13	21000	5.6	2
9...	66	19	19	19	18	21000	5.6	1	2
12...	57	17	17	17	14	16000	5.6	3	1
13...	26	6	6	6	6	21000	5.3
14...	54	15	15	15	15	19000	5.5
15...	45	15	15	15	14	23000	5.3	2
17...	19	6	6	6	6	20000	6.3
18...	41	13	13	13	11	19000	5.3	2	1
19...	72	21	21	20	1	17	21000	6.7	2	2
20...	70	17	17	17	17	18000	5.4	2
21...	43	13	13	13	12	12500	5.1	1
22...	34	9	9	9	8	15500	5.9	1
23...	55	16	16	16	16	21000	6.1
24...	48	14	14	14	13	21000	6.0	1	1
25...	58	20	20	20	18	23000	5.9	2	1
26...	44	16	16	16	14	23000	6.0	1	1
27...	46	18	18	18	17	29000	6.6
28...	36	10	10	10	10	17500	5.4	1
30...	52	16	16	16	15	22000	5.5	1	1
31...	40	15	15	15	15	14000	5.2
32...	52	16	16	16	14	20000	6.1	2
33...	16	6	6	6	4	1
35...	**23	5	5	5	4	1
36...	46	17	17	17	17	27000	6.6
37...	35	12	12	12	11	21000	5.1
38...	133	42	42	41	1	39	18500	5.7	3	1
39...	74	30	30	30	23	36000	6.1	5	82	3.6	...	1
41...	55	16	16	16	16	30000	6.2	1
42...	44	10	10	10	9	40000	7.6
3-1.....	*2605	1178	867	666	201	304	220	83	1	7	196	10500	5.5	911	65	3.2	2	107
3...	114	49	43	33	10	6	4	2	13	10500	5.8	30	65	3.7	...	3
4...	81	45	37	25	12	8	7	1	5	...	4.2	37	60	2.9	...	4
5...	85	39	32	28	4	7	3	4	8	11500	5.4	31	69	2.9	...	6
6...	*158	51	31	26	5	20	15	5	8	9000	6.1	41	85	4.0	...	3
7...	111	52	20	15	5	27	24	3	...	5	14	13500	4.6	32	78	3.6	1	4
9...	134	80	49	44	5	30	20	10	...	1	13	9500	5.8	65	68	3.4	...	3
10...	118	58	20	17	3	37	29	8	10	14000	4.8	44	65	3.5	...	1
11...	97	40	17	11	6	23	14	9	6	...	5.5	32	63	3.7	...	6
12...	115	47	16	10	6	31	25	6	10	12000	6.6	33	59	3.3	...	3
13...	*165	64	54	51	3	10	10	11	9500	5.8	49	68	4.0	1	4
14...	109	34	24	20	4	10	4	7	...	6.6	26	103	3.7	...	4
15...	154	94	91	48	43	3	2	1	12	7000	4.8	78	60	2.3	...	4
16...	177	69	44	28	16	25	5	20	11	8000	6.0	48	58	3.3	...	18
17...	90	48	23	18	5	25	17	8	10	...	5.6	33	59	3.8	...	1
19...	71	30	16	14	2	14	14	12	12000	7.0	18	65	4.5	...	1
20...	92	48	30	20	10	18	18	9	12500	5.1	38	61	2.7	...	6
21...	259	76	76	76	1	67	45	3.7	...	17
22...	75	36	36	20	16	6	...	4.5	27	56	2.3	...	5
23...	57	26	26	15	11	11	9500	5.1	14	65	2.9	...	1
24...	231	158	157	124	33	1	...	1	9	...	4.0	146	63	2.7	...	4
25...	112	34	25	23	2	9	9	10	9000	6.4	22	89	3.9	...	9
3-2.....	*1780	693	585	517	68	92	79	13	...	16	171	10500	5.6	476	71	3.9	...	65
3...	9	4	2
4...	97	35	25	23	2	9	9	1	7	11000	5.9	25	67	4.5	...	12
5...	253	95	68	61	7	21	17	4	...	6	26	8500	4.8	63	70	4.1	...	10
6...	214	65	31	30	1	25	24	1	...	9	21	10500	5.5	38	73	4.7	...	2
8...	67	23	15	14	1	8	4	7	9000	5.9	14	70	4.4	...	6
9...	111	41	41	41	15	8500	5.7	23	75	4.2	...	5
13...	91	37	19	19	...	18	14	4	3	31	77	3.6	...	4
14...	128	65	65	45	20	8	16000	6.3	51	61	3.2	...	1
15...	115	54	54	51	3	10	11000	6.2	40	89	4.0	...	1

Table 2.—CHARACTERISTICS OF HOUSING UNITS, BY BLOCKS: 1960—Con.

["Total population" contains no persons in group quarters unless preceded by asterisk; one asterisk (*) denotes less than 10 percent; two asterisks (**), 10 percent or more]

Table with columns: Blocks within census tracts, Total population, All housing units by condition and plumbing (Sound, Deteriorating, Dilapidated), Occupied housing units (Owner occupied, Renter occupied), Occupied by non-white, and 1.01 or more persons per room.

Table 2.—CHARACTERISTICS OF HOUSING UNITS, BY BLOCKS: 1960—Con.

["Total population" contains no persons in group quarters unless preceded by asterisk; one asterisk (*) denotes less than 10 percent; two asterisks (**), 10 percent or more]

Blocks within census tracts	Total population	All housing units by condition and plumbing								Occupied housing units								
		Total	Sound			Deteriorating			Dilapidated	Owner occupied			Renter occupied			Occupied by non-white	101 or more persons per room	
			Total	With all plumbing facilities	Lacking some or all facilities	Total	With all plumbing facilities	Lacking some or all facilities		Total	Average value (dollars)	Average number of rooms	Total	Average contract rent (dollars)	Average number of rooms			
								With flush toilet										No flush toilet
42...	89	41	41	41	13	22000	6.2	27	80	4.5	
43...	84	31	31	31	24	24000	7.3	6	94	4.7	
44...	36	9	9	9	9	23000	7.3	
45...	*182	96	96	96	1	76	56	2.1	1	21	
46...	27	8	8	8	8	29000	7.9	
47...	25	9	9	9	8	31000	6.8	1	
48...	32	10	10	10	10	32000	7.5	
49...	52	15	15	15	13	28000	6.4	2	
50...	33	10	10	10	10	23000	5.6	
51...	45	13	13	13	13	29000	6.8	
52...	34	11	11	11	11	33000	7.1	
53...	47	14	14	14	14	26000	6.6	1	
54...	**60	22	22	22	19	24000	7.2	1	
55...	41	17	17	17	10	27000	6.6	6	96	2.7	...	1	
56...	52	31	30	30	...	1	1	5	...	6.0	25	72	3.4	
57...	114	52	52	52	25	19500	6.4	25	101	3.9	
58...	137	52	52	49	3	32	18500	6.5	20	128	4.1	...	2	
59...	47	12	12	12	11	19000	6.7	1	
60...	142	37	37	37	35	19500	7.3	2	1	
61...	116	39	39	39	33	18500	6.8	4	
62...	111	33	33	33	29	21000	6.7	4	
63...	67	20	20	20	19	23000	6.5	
64...	57	17	17	17	13	24000	6.5	3	
65...	83	22	22	22	22	29000	6.5	
66...	80	24	24	24	23	26000	6.6	
67...	50	20	20	20	18	24000	6.2	1	
68...	67	24	24	24	24	22000	5.7	
69...	115	38	38	38	37	24000	6.0	
70...	34	9	9	9	9	29000	6.4	
71...	44	11	11	11	11	26000	6.5	
72...	118	33	33	33	33	20000	5.8	1	
73...	140	42	42	42	41	19500	5.7	1	
74...	68	24	24	24	22	17000	5.3	
75...	96	30	30	30	30	16500	5.2	2	
76...	46	15	15	15	13	22000	5.7	2	
77...	48	18	18	18	17	20000	5.6	
79...	49	22	22	22	19	16000	4.9	2	
80...	133	44	44	44	44	18000	5.7	1	
81...	76	20	20	20	18	17500	6.1	2	1	
82...	51	17	17	17	16	18500	5.8	
83...	112	35	35	35	32	21000	6.1	2	
84...	260	91	91	91	60	16500	6.1	27	74	4.7	
85...	67	19	19	19	19	36000	8.4	1	
86...	56	14	14	14	12	27000	7.4	2	
87...	58	19	19	19	18	21000	7.8	
88...	**72	29	27	25	2	2	2	14	18500	7.1	11	74	2.5	
89...	22	6	6	6	3	3	
90...	34	11	11	11	10	24000	8.8	1	
91...	20	6	6	6	6	36000	8.5	
92...	56	28	28	24	4	15	32000	8.3	12	70	1.8	1	1	
93...	16	4	
94...	148	42	42	42	26	14000	6.1	15	86	5.5	...	2	
95...	93	28	28	28	24	14000	6.3	4	2	
96...	167	46	46	46	34	14000	6.5	11	82	5.5	...	4	
97...	119	35	35	35	23	13000	6.3	12	78	5.8	...	3	
98...	95	31	31	31	28	14000	6.3	3	
99...	124	35	35	35	33	14500	6.1	1	3	
100...	122	36	36	36	31	16000	6.3	4	
101...	46	15	15	14	1	14	16000	5.9	1	
102...	**150	36	36	36	29	14000	6.8	6	86	5.3	...	3	
103...	73	25	25	25	4	20	85	5.5	...	1	
104...	92	46	46	46	14	...	5.4	30	75	4.8	
105...	115	34	33	31	2	1	1	14	9000	6.0	19	79	5.4	...	2	
106...	49	28	28	28	26	80	3.6	
107...	146	82	82	81	1	13	18000	7.5	66	87	3.2	
108...	162	63	50	47	3	13	...	13	...	25	15000	6.5	33	75	4.2	...	1	
6-1.....	*3297	1132	1049	897	152	70	54	16	...	13	294	11000	5.9	761	70	4.0	46	141
2...	105	40	39	33	6	1	1	13	15000	6.1	26	90	3.3	...	3	
3...	114	42	39	39	...	3	3	15	13000	6.1	22	150	4.8	...	2	
6...	62	22	22	18	4	7	12000	6.3	14	73	4.3	...	2	
7...	133	33	32	29	3	1	1	10	9500	6.7	22	72	4.5	...	9	
8...	151	42	38	33	5	4	...	4	...	15	11000	6.3	23	78	4.8	2	6	
9...	230	57	52	49	3	4	3	1	...	14	9000	5.8	39	63	5.0	7	14	
10...	183	68	63	46	17	5	3	2	...	24	11000	5.8	40	105	3.6	...	11	
11...	116	60	53	42	11	7	6	1	...	6	...	6.0	48	60	4.3	...	3	
13...	146	47	47	45	2	21	10000	6.3	22	65	5.0	2	3	
14...	205	59	58	48	10	1	1	18	8500	5.6	41	91	4.4	4	9	
15...	150	48	45	37	8	3	3	18	8500	5.7	30	67	4.5	2	5	
16...	150	45	43	34	9	2	2	12	10500	6.4	29	75	4.3	...	9	
17...	57	20	20	20	6	9500	6.7	13	74	3.6	2	3	
18...	147	55	44	41	3	11	9	2	...	16	11000	6.1	35	70	4.1	10	4	
20...	178	53	45	39	6	7	4	3	...	10	11000	6.6	37	68	4.2	9	9	
21...	46	22	21	21	...	1	1	10	10000	5.3	9	68	3.1	4	2	
22...	33	6	6	6	4	2	2	
24...	4	1	
27...	37	22	21	16	5	1	1	2	18	72	2.6	...	2	

Table 2.—CHARACTERISTICS OF HOUSING UNITS, BY BLOCKS: 1960—Con.

["Total population" contains no persons in group quarters unless preceded by asterisk: one asterisk (*) denotes less than 10 percent; two asterisks (**), 10 percent or more]

Table with columns for Blocks within census tracts, Total population, All housing units by condition and plumbing (Sound, Deteriorating, Dilapidated), and Occupied housing units (Owner occupied, Renter occupied, Occupied by non-white, 1.01 or more persons per room). Rows list census tracts 40-74 and 6-4B.

Dayton, Ohio

Table 2.—CHARACTERISTICS OF HOUSING UNITS, BY BLOCKS: 1960—Con.

["Total population" contains no persons in group quarters unless preceded by asterisk: one asterisk (*) denotes less than 10 percent, two asterisks (**), 10 percent or more]

Table with multiple columns: Blocks within census tracts, Total population, All housing units by condition and plumbing (Sound, Deteriorating, Dilapidated), Occupied housing units (Owner occupied, Renter occupied), and 1.01 or more persons per room.

City Block Characteristics

Table 2.—CHARACTERISTICS OF HOUSING UNITS, BY BLOCKS: 1960—Con.

["Total population" contains no persons in group quarters unless preceded by asterisk; one asterisk (*) denotes less than 10 percent; two asterisks (**), 10 percent or more]

Table with columns for Block, Total population, All housing units by condition and plumbing (Sound, Deteriorating, Dilapidated), and Occupied housing units (Owner occupied, Renter occupied). Rows list various block numbers and their corresponding statistics.

Table 2.—CHARACTERISTICS OF HOUSING UNITS, BY BLOCKS: 1960—Con.

["Total population" contains no persons in group quarters unless preceded by asterisk: one asterisk (*) denotes less than 10 percent; two asterisks (**), 10 percent or more]

Table with columns: Blocks within census tracts, Total population, All housing units by condition and plumbing (Sound, Deteriorating, Dilapidated), Occupied housing units (Owner occupied, Renter occupied), and 1.01 or more persons per room. Rows represent various census tracts and their characteristics.

City Block Characteristics

Table 2.—CHARACTERISTICS OF HOUSING UNITS, BY BLOCKS: 1960—Con.

["Total population" contains no persons in group quarters unless preceded by asterisk; one asterisk (*) denotes less than 10 percent; two asterisks (**), 10 percent or more]

Blocks within census tracts	Total population	All housing units by condition and plumbing								Occupied housing units								
		Total	Sound			Deteriorating			Dilapidated	Owner occupied			Renter occupied			Occupied by non-white	1.01 or more persons per room	
			Total	With all plumbing facilities	Lacking some or all facilities	Total	With all plumbing facilities	Lacking some or all facilities		Total	Average value (dollars)	Average number of rooms	Total	Average contract rent (dollars)	Average number of rooms			
								With flush toilet										No flush toilet
4...	179	44	44	44	40	13500	5.4	4	1	3	
5...	22	7	7	7	5	21000	5.2	1	
6...	101	23	22	22	...	1	1	21	13500	6.0	2	2	
7...	160	38	38	38	38	12500	5.9	2	
8...	161	39	39	39	38	12500	5.9	1	1	
9...	69	17	17	17	16	12500	5.7	1	2	
10...	46	11	11	11	11	12500	6.0	1	
11...	162	40	40	40	36	12500	6.0	3	1	
12...	99	25	25	25	23	12000	5.9	1	1	
13...	152	34	34	34	33	12500	6.0	1	1	
14...	145	35	35	35	35	12500	5.9	3	
15...	189	41	41	41	40	12000	5.9	1	5	
16...	175	40	40	40	39	13000	5.9	1	4	
17...	79	20	20	20	19	16500	5.5	3	
18...	191	46	46	46	45	15000	5.4	1	3	
19...	222	54	54	54	52	13500	5.3	1	6	
20...	148	38	38	38	38	13000	5.1	2	
21...	167	38	38	38	38	12500	5.0	5	
22...	94	22	22	22	22	13500	5.1	3	
23...	106	26	26	26	24	13500	5.0	2	5	
24...	142	31	30	30	...	1	1	30	13000	5.0	1	7	
25...	133	28	28	28	26	15500	5.3	2	5	
26...	137	31	31	31	30	14000	5.1	6	
27...	2	1	
28...	24	6	6	6	5	18500	5.6	1	
29...	15	3	
30...	166	36	35	35	1	33	13000	5.5	2	9	
31...	145	33	32	32	...	1	1	32	13000	4.9	1	9	
32...	163	35	35	35	32	13000	5.3	3	4	
33...	94	21	21	21	19	12000	5.9	2	1	
34...	231	56	56	56	52	13500	5.8	3	4	
35...	64	15	15	15	14	13000	5.4	1	2	
36...	114	23	23	23	20	13500	6.1	3	1	3	
37...	74	18	18	18	18	13500	6.1	1	
38...	174	39	39	39	36	13500	6.0	2	3	

U.S. CENSUS OF HOUSING: 1960

Series HC(3)-313

CITY BLOCKS

Hamilton, Ohio

Prepared under the supervision of
WAYNE F. DAUGHERTY, Chief
Housing Division



U.S. DEPARTMENT OF COMMERCE
Luther H. Hodges, Secretary
BUREAU OF THE CENSUS

Richard M. Scammon, Director (From May 1, 1961)
Robert W. Burgess, Director (To March 3, 1961)

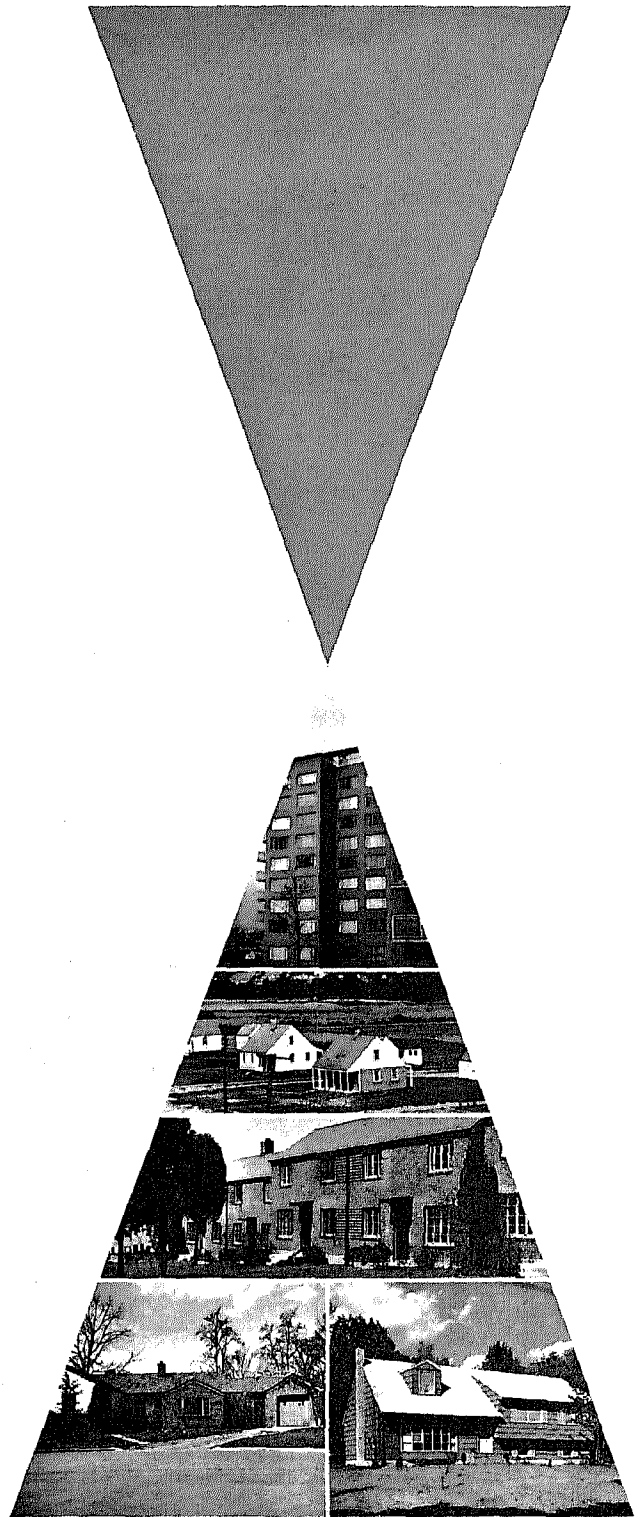



BUREAU OF THE CENSUS

RICHARD M. SCAMMON, *Director* (From May 1, 1961)

ROBERT W. BURGESS, *Director* (To March 3, 1961)

A. ROSS ECKLER, *Deputy Director*
HOWARD C. GRIEVES, *Assistant Director*
CONRAD TABUBER, *Assistant Director*
MORRIS H. HANSEN, *Assistant Director for Statistical Standards*
CHARLES B. LAWRENCE, JR., *Assistant Director for Operations*
WALTER L. KEHRES, *Assistant Director for Administration*
CALVERT L. DEDRICK, *Chief, International Statistical Programs Office*
A. W. VON STRUVE, *Acting Public Information Officer*

Housing Division—

WAYNE F. DAUGHERTY, *Chief*
DANIEL B. RATHBUN, *Assistant Chief*
BEULAH WASHBAUGH, *Special Assistant*
MILTON D. LIEBERMAN, *Chief, Coordination and Research*

Decennial Operations Division—GLEN S. TAYLOR, *Chief*
Electronic Systems Division—ROBERT F. DRURY, *Chief*
Field Division—JEFFERSON D. McPIKE, *Chief*
Geography Division—WILLIAM T. FAY, *Chief*
Population Division—HOWARD G. BRUNSMAN, *Chief*
Statistical Methods Division—JOSEPH STEINBERG, *Chief*

Library of Congress Card Number: A61-9347

SUGGESTED CITATION

U.S. Bureau of the Census. *U.S. Census of Housing: 1960. Vol. III, City Blocks.*
Series HC(3), No. 313.
U.S. Government Printing Office, Washington, D.C., 1961.

For sale by the Superintendent of Documents, U.S. Government Printing Office, Washington 25, D.C.
or any of the Field Offices of the Department of Commerce — Price 25 cents.

Table 1.—CHARACTERISTICS OF HOUSING UNITS, FOR THE CITY: 1960

Subject	Number	Percent	Subject	Number	Percent
All housing units.....	22,761	100.0	Occupied housing units—Con.		
CONDITION AND PLUMBING			COLOR		
Sound.....	19,709	86.6	White.....	20,728	94.8
With all plumbing facilities.....	17,897	78.6	Nonwhite.....	1,126	5.2
Lacking some or all facilities.....	1,812	8.0			
Deteriorating.....	2,422	10.6	PERSONS PER ROOM		
With all plumbing facilities.....	1,490	6.5	1.00 or less.....	18,964	86.8
Lacking some or all facilities.....	932	4.1	1.01 or more.....	2,890	13.2
With flush toilet.....	798	3.5			
No flush toilet.....	134	0.6	AVERAGE NUMBER OF ROOMS		
Dilapidated.....	630	2.8	Owner occupied.....	5.3	...
Occupied housing units.....	21,854	100.0	Renter occupied.....	3.7	...
TENURE			VALUE AND RENT		
Owner occupied.....	14,121	64.6	Average value.....dollars.....	13,600	...
Renter occupied.....	7,733	35.4	Average contract rent.....dollars.....	62	...

NOTE.—On the map for Hamilton approximately 940 blocks are identified.

Table 2.—CHARACTERISTICS OF HOUSING UNITS, BY BLOCKS: 1960

["Total population" contains no persons in group quarters unless preceded by asterisk: one asterisk (*) denotes less than 10 percent; two asterisks (**), 10 percent or more]

Blocks within census tracts	Total population	All housing units by condition and plumbing								Occupied housing units								
		Total	Sound			Deteriorating			Dilapidated	Owner occupied			Renter occupied			Occupied by non-white	1.01 or more persons per room	
			Total	With all plumbing facilities	Lacking some or all facilities	Total	With all plumbing facilities	Lacking some or all facilities		With flush toilet	No flush toilet	Total	Average value (dollars)	Average number of rooms	Total			Average contract rent (dollars)
1.....	*6093	1703	1697	1689	8	5	5	1	1527	14500	5.1	141	84	4.2	1	17.1
2.....	55	16	16	16	15	13500	5.0	1	4
3.....	63	20	20	20	20	13000	4.8
4.....	48	16	16	16	16	13500	5.4	1
5.....	49	20	20	20	19	14000	5.3	1
6.....	46	15	15	15	15	13500	4.5	1
7.....	86	24	24	24	22	13500	5.0	2	1
8.....	220	50	50	50	48	13500	5.2	1	8
9.....	46	17	17	17	16	12500	5.3	1
10.....	51	18	17	17	...	1	1	15	11000	5.1	2	2
11.....	49	17	17	17	13	11500	5.6	3
12.....	58	16	16	16	12	16500	6.0	3	2
13.....	100	31	31	31	26	15500	5.5	5	91	5.8	...	2
14.....	43	14	14	14	12	15000	5.2	1	1
15.....	9	3
16.....	96	27	27	27	23	16000	4.8	3	5
17.....	136	39	39	39	38	16000	5.1	1	1
18.....	72	25	25	25	25	19000	5.2
19.....	55	20	20	20	16	18000	6.4	4	1
20.....	49	17	17	17	16	11500	5.4	1
21.....	84	19	19	19	17	11500	5.5	1	5
22.....	59	19	18	18	1	18	11500	4.7	1
23.....	49	13	13	13	11	15000	5.5	2	1
24.....	66	19	19	15	4	14	14500	5.0	4	2
25.....	61	21	21	21	19	12000	4.6	2	1
26.....	73	19	18	18	...	1	1	18	12000	4.8	1	2
27.....	44	16	16	16	13	11500	4.8	2	1
28.....	81	27	27	27	25	12500	5.1	2	1
29.....	16	8	8	8	7	13000	5.1
30.....	68	18	18	18	18	12000	4.7	1	4
31.....	49	13	13	13	12	13500	4.9	3
32.....	81	20	20	20	20	13500	4.9	1
33.....	125	26	26	26	26	14000	5.1	7
34.....	95	24	24	24	24	13500	4.8	3
35.....	155	41	41	41	38	12500	5.0	3	3
36.....	169	43	43	43	42	12500	5.0	1	5
37.....	74	16	16	16	16	13000	5.1	5
38.....	151	36	36	36	32	12500	5.0	2	5
39.....	107	28	28	28	25	13500	5.0	1	5
40.....	245	55	55	55	52	13000	5.1	3	8
41.....	175	42	42	42	41	13000	4.9	1	6
42.....	*187	38	38	38	34	14500	5.2	3	7
43.....	143	34	34	34	33	16000	5.6	1	5
44.....	182	43	43	43	40	14000	5.2	3	7
45.....	120	32	32	31	1	32	16000	5.1	4
46.....	114	32	32	32	31	16000	5.4	3
47.....	151	34	34	34	32	16000	5.1	1	7
48.....	139	35	35	35	29	15500	5.0	2	6
49.....	209	52	52	52	50	15000	5.1	5
51.....	39	11	11	11	10	9000	4.5	1	1
52.....	60	13	13	13	12	13000	4.6	1	5
53.....	39	12	12	12	10	14000	4.9	2	1

City Block Characteristics

Table 2.—CHARACTERISTICS OF HOUSING UNITS, BY BLOCKS: 1960—Con.

["Total population" contains no persons in group quarters unless preceded by asterisk: one asterisk (*) denotes less than 10 percent; two asterisks (**), 10 percent or more]

Table with columns: Blocks within census tracts, Total population, All housing units by condition and plumbing (Sound, Deteriorating, Dilapidated), Occupied housing units (Owner occupied, Renter occupied), and 1.01 or more persons per room. Rows represent individual blocks with their respective data points.

Table 2.—CHARACTERISTICS OF HOUSING UNITS, BY BLOCKS: 1960—Con.

["Total population" contains no persons in group quarters unless preceded by asterisk; one asterisk (*) denotes less than 10 percent; two asterisks (**), 10 percent or more]

Blocks within census tracts	Total population	All housing units by condition and plumbing								Occupied housing units								
		Sound				Deteriorating				Dilapidated	Owner occupied			Renter occupied			Occupied by non-white	1.01 or more persons per room
		Total	With all plumbing facilities	Lacking some or all facilities	Total	With all plumbing facilities	Lacking some or all facilities		Total		Average value (dollars)	Average number of rooms	Total	Average contract rent (dollars)	Average number of rooms			
							With flush toilet	No flush toilet										
40...	101	25	25	25	24	17500	5.9	1	
41...	51	14	14	14	14	16500	5.6	
42...	95	27	27	26	1	25	14000	4.9	2	5	
43...	141	39	39	39	39	18500	5.8	
44...	75	18	18	18	18	22000	6.1	3	
45...	53	16	16	16	16	14500	5.1	
46...	284	98	98	98	67	16000	5.7	18	101	4.3	...	4	
47...	16	6	3	3	...	2	2	...	1	5	10000	5.4	1	
48...	49	10	10	10	9	14500	5.3	1	1	
49...	47	17	17	17	16	16000	5.3	
50...	35	16	16	16	16	13500	4.6	
51...	107	37	34	34	...	3	3	30	12000	5.1	5	86	4.6	...	1	
52...	57	23	23	23	20	16000	5.5	3	
53...	75	23	23	23	22	16500	5.5	1	1	
54...	67	18	18	18	16	13500	5.1	2	3	
55...	53	18	14	13	1	4	3	1	...	12	17500	5.2	5	62	3.0	...	3	
56...	53	20	18	18	...	2	2	13	15000	5.3	6	76	2.8	...	1	
57...	45	14	14	14	9	15500	5.8	4	1	
58...	227	72	72	72	63	14500	5.7	4	
13...	*2174	716	714	711	3	2	1	...	1	600	27000	6.1	71	88	4.4	...	13	
1...	62	28	28	28	26	13500	4.8	1	
2...	23	9	9	9	8	17500	6.5	1	
3...	87	36	36	36	32	20000	5.3	4	
4...	80	26	26	26	23	29000	6.0	2	
5...	64	20	20	19	1	16	19500	5.6	2	1	
6...	22	7	7	7	6	19500	5.2	1	1	
7...	29	9	9	9	7	19500	5.7	1	1	
8...	34	11	11	11	10	30000	5.8	1	
9...	101	33	33	32	1	27	30000	6.0	5	121	4.0	...	2	
10...	494	172	170	170	...	2	1	...	1	127	28000	6.0	27	86	3.9	...	3	
11...	15	7	7	7	6	27000	5.8	
12...	176	74	74	74	48	19500	5.4	12	83	4.3	
13...	**249	61	61	61	51	20000	5.6	9	105	4.8	...	1	
14...	75	26	26	26	25	35000	7.4	1	
15...	14	5	5	5	4	
16...	72	22	22	22	22	40000	7.5	
17...	28	8	8	8	8	33000	7.0	
18...	20	6	6	6	6	40000	8.2	
19...	45	15	15	15	12	25000	7.3	2	2	
20...	22	5	5	5	5	35000	6.6	
21...	41	13	13	13	13	31000	6.2	
22...	57	16	16	16	16	37000	6.7	
23...	114	37	37	37	37	32000	6.2	
24...	56	16	16	16	16	41000	7.1	
25...	49	13	13	13	13	42000	8.3	
26...	11	4	
27...	2	1	
28...	94	24	24	24	21	26000	6.5	1	1	
29...	38	12	12	11	1	10	19500	5.4	1	1	
14...	1490	413	408	406	2	4	...	4	...	380	20000	5.8	19	105	5.0	1	23	
1...	19	6	6	6	4	1	
2...	20	5	5	5	5	23000	5.8	
3...	33	9	9	9	8	29000	6.9	
4...	390	103	98	96	2	4	...	4	...	91	19000	5.4	10	89	4.3	1	11	
5...	88	26	26	26	25	19500	6.2	1	
6...	75	20	20	20	19	28000	6.6	1	
7...	43	11	11	11	11	25000	6.0	1	
8...	6	2	
9...	92	28	28	28	27	19000	5.8	1	
10...	129	35	35	35	34	21000	5.9	1	
11...	50	16	16	16	14	26000	5.9	
12...	14	4	
13...	26	8	8	8	7	25000	5.9	
14...	38	12	12	12	10	26000	6.5	
15...	110	33	33	33	31	16500	5.1	1	3	
16...	101	26	26	26	25	16000	5.3	1	1	
17...	101	26	26	26	25	19000	5.8	1	2	
18...	150	40	40	40	36	20000	5.7	3	3	
19...	5	3	

U.S. CENSUS OF HOUSING: 1960

Series HC(3)-314

CITY BLOCKS

Kettering, Ohio

Prepared under the supervision of
WAYNE F. DAUGHERTY, Chief
Housing Division



U.S. DEPARTMENT OF COMMERCE

Luther H. Hodges, Secretary

BUREAU OF THE CENSUS

Richard M. Scammon, Director (From May 1, 1961)

Robert W. Burgess, Director (To March 3, 1961)

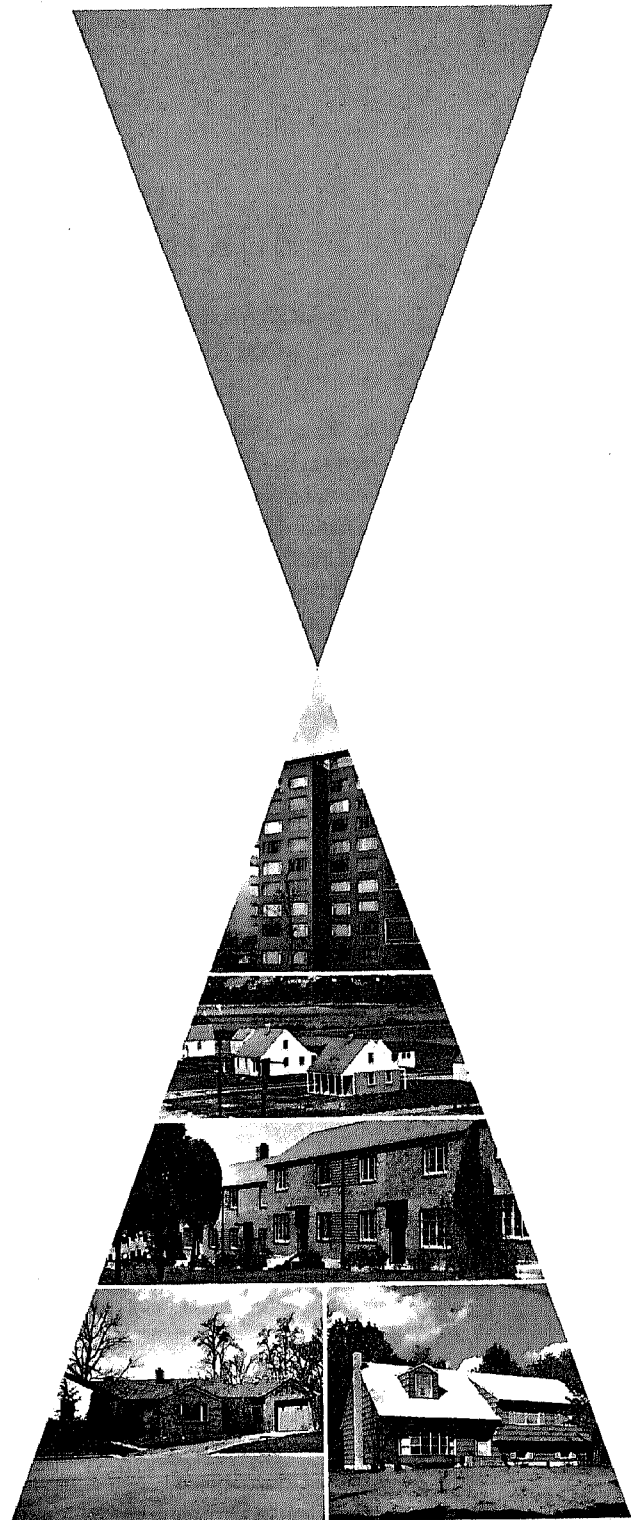



BUREAU OF THE CENSUS

RICHARD M. SCAMMON, *Director* (From May 1, 1961)

ROBERT W. BURGESS, *Director* (To March 3, 1961)

A. ROSS ECKLER, *Deputy Director*
HOWARD C. GRIEVES, *Assistant Director*
CONRAD TAUBER, *Assistant Director*
MORRIS H. HANSEN, *Assistant Director for Statistical Standards*
CHARLES B. LAWRENCE, JR., *Assistant Director for Operations*
WALTER L. KEHRES, *Assistant Director for Administration*
CALVERT L. DEDRICK, *Chief, International Statistical Programs Office*
A. W. VON STRUVE, *Acting Public Information Officer*

Housing Division—

WAYNE F. DAUGHERTY, *Chief*
DANIEL B. RATHBUN, *Assistant Chief*
BEULAH WASHABAUGH, *Special Assistant*
MILTON D. LIEBERMAN, *Chief, Coordination and Research*

Decennial Operations Division—GLEN S. TAYLOR, *Chief*
Electronic Systems Division—ROBERT F. DRURY, *Chief*
Field Division—JEFFERSON D. MCPHIE, *Chief*
Geography Division—WILLIAM T. FAY, *Chief*
Population Division—HOWARD G. BRUNSMAN, *Chief*
Statistical Methods Division—JOSEPH STEINBERG, *Chief*

Library of Congress Card Number: A61-9347

SUGGESTED CITATION

U.S. Bureau of the Census. *U.S. Census of Housing: 1960. Vol. III, City Blocks.*
Series HC(3), No. 314.
U.S. Government Printing Office, Washington, D.C., 1961.

For sale by the Superintendent of Documents, U.S. Government Printing Office, Washington 25, D.C.
or any of the Field Offices of the Department of Commerce — Price 25 cents.

Table 1.—CHARACTERISTICS OF HOUSING UNITS, FOR THE CITY: 1960

Subject	Number	Percent	Subject	Number	Percent
All housing units	16,709	100.0	Occupied housing units—Con.		
CONDITION AND PLUMBING			COLOR		
Sound	16,147	96.6	White	15,880	99.9
With all plumbing facilities	16,098	96.3	Nonwhite	18	0.1
Lacking some or all facilities	49	0.3	PERSONS PER ROOM		
Deteriorating	488	2.9	1.00 or less	15,029	94.5
With all plumbing facilities	458	2.7	1.01 or more	869	5.5
Lacking some or all facilities	30	0.2	AVERAGE NUMBER OF ROOMS		
With flush toilet	24	0.1	Owner occupied	5.7	...
No flush toilet	6	...	Renter occupied	4.2	...
Dilapidated	74	0.4	VALUE AND RENT		
Occupied housing units	15,898	100.0	Average value	12,700	...
TENURE			Average contract rent	93	...
Owner occupied	12,721	80.0			
Renter occupied	3,177	20.0			

NOTE.—On the map for Kettering approximately 620 blocks are identified.

Table 2.—CHARACTERISTICS OF HOUSING UNITS, BY BLOCKS: 1960

["Total population" contains no persons in group quarters unless preceded by asterisk: one asterisk (*) denotes less than 10 percent; two asterisks (**), 10 percent or more]

Blocks within census tracts	Total population	All housing units by condition and plumbing								Occupied housing units								
		Total	Sound			Deteriorating			Dilapidated	Owner occupied			Renter occupied			Occu- pied by non-white	1.01 or more persons per room	
			Total	With all plumbing facilities	Lacking some or all facilities	Total	With all plumbing facilities	Lacking some or all facilities		Total	Average value (dollars)	Average number of rooms	Total	Average contract rent (dollars)	Average number of rooms			
KE-55...	*3651	1345	1271	1267	4	72	70	1	1	2	842	17500	5.7	453	86	4.2	1	33
1...	54	16	16	16	11	13500	6.4	4	1
2...	91	35	35	33	2	17	14500	6.5	17	68	4.4
3...	67	28	28	28	16	13500	5.6	12	62	3.6
4...	64	24	24	24	9	12500	5.8	14	70	3.9
5...	*339	115	86	86	...	27	26	1	...	2	57	13500	5.9	52	83	4.8	...	6
6...	20	7	7	7	6	21000	5.8	1
7...	114	44	44	44	18	27000	6.1	23	107	4.8	...	2
8...	92	37	35	35	...	2	2	25	12500	5.8	9	85	3.4
9...	18	7	7	7	4	2
10...	322	123	122	122	...	1	1	...	77	32000	6.6	40	105	4.3	...	4
11...	51	26	26	26	6	33000	6.8	17	114	4.6
12...	27	9	9	9	7	17000	5.3	2
13...	71	22	15	15	...	7	7	6	12500	5.7	15	78	5.0
14...	47	16	16	16	13	14000	5.6	3
15...	106	39	39	39	20	13500	5.8	17	71	4.8
16...	50	17	17	17	12	18000	6.2	5	...	3.4
17...	55	21	21	21	18	31000	6.1	2
18...	41	11	11	11	11	40000	6.9
19...	10	5	5	5	3	1
20...	44	13	13	13	10	23000	7.4	3
21...	66	19	17	17	...	2	2	17	18000	6.4	2	1
22...	99	27	25	25	...	2	2	19	13000	6.0	8	88	5.0	...	1
23...	92	27	27	27	21	14500	6.1	6	103	5.7	...	2
24...	55	23	23	23	10	19000	6.5	13	79	3.2
25...	64	26	25	25	...	1	1	7	17500	6.3	18	110	4.4
26...	101	26	25	25	...	1	1	21	16500	6.3	5	117	6.6	...	2
27...	111	68	48	48	...	20	20	3	60	80	3.0
28...	72	46	45	45	...	1	1	4	40	72	3.0
29...	106	39	39	39	28	14500	4.9	10	80	4.9	...	2
30...	52	18	18	18	18	20000	6.3
31...	60	25	24	24	...	1	1	24	14000	4.5	1	1	1
32...	41	18	18	18	15	20000	5.5	1
33...	52	19	19	19	18	18000	5.8	1
34...	66	21	21	21	21	13000	5.0
35...	74	29	25	25	...	4	4	18	13500	5.5	9	77	3.9	...	2
36...	43	16	16	16	12	15000	5.7	2
37...	94	32	32	30	2	28	12000	4.8	2	1
38...	59	21	20	20	...	1	1	20	12500	4.8	1
39...	55	20	20	20	20	13500	4.9	2
40...	94	31	31	31	26	13000	5.0	5	72	4.4
41...	87	30	30	30	23	14000	5.3	5	83	4.6	...	1
42...	51	20	18	18	...	2	2	17	18000	5.2	3
43...	9
44...	79	28	28	28	21	14500	5.2	6	76	4.2	...	3
45...	57	22	22	22	21	12500	4.8	1	1
46...	64	23	23	23	18	13000	4.7	5	...	4.2	...	1
47...	15	4
48...	78	28	28	28	24	11000	4.8	4
49...	57	15	15	15	11	13500	5.4	4
50...	15	5	5	5	3	2

City Block Characteristics

Table 2.—CHARACTERISTICS OF HOUSING UNITS, BY BLOCKS: 1960—Con.

["Total population" contains no persons in group quarters unless preceded by asterisk; one asterisk (*) denotes less than 10 percent; two asterisks (**), 10 percent or more]

Blocks within census tracts	Total population	All housing units by condition and plumbing									Occupied housing units								
		Total	Sound			Deteriorating			Dilapidated	Owner occupied			Renter occupied			Occupied by non-white	1.01 or more persons per room		
			Total	With all plumbing facilities	Lacking some or all facilities	Total	With all plumbing facilities	Lacking some or all facilities		Total	Average value (dollars)	Average number of rooms	Total	Average contract rent (dollars)	Average number of rooms				
							With flush toilet	No flush toilet											
46...	45	12	12	12	11	22000	6.2	
KE-61-2.	*7860	1913	1907	1899	8	5	5	1	1784	13500	5.6	108	90	5.3	...	176	
1...	269	72	72	72	65	18000	5.4	5	98	6.8	...	5	
4...	11	4	
6...	38	10	10	10	10	12000	5.4	
8...	47	11	11	11	9	13500	5.4	2	3	
9...	168	41	41	41	40	12500	5.5	1	4	
10...	*1213	272	272	268	4	253	13000	5.7	18	68	4.7	...	24	
11...	162	38	38	38	34	12000	5.3	4	3	
12...	117	28	28	28	26	12500	5.5	2	6	
13...	138	36	36	36	35	12500	5.5	1	3	
14...	*229	55	55	54	1	53	12500	5.5	1	11	
15...	105	26	26	26	25	12500	5.4	1	1	
16...	117	25	25	25	23	13000	5.7	2	4	
17...	281	69	69	69	66	13000	5.8	3	4	
18...	123	30	30	30	27	12500	5.8	1	5	
19...	127	33	33	33	29	13000	5.7	4	1	
20...	186	43	43	43	42	12500	5.5	1	7	
21...	157	39	39	39	37	12500	5.6	2	1	
22...	136	34	34	34	33	12500	6.2	1	
23...	184	45	45	45	43	12000	6.0	2	4	
24...	147	38	38	38	36	12500	6.1	1	
25...	153	42	42	42	42	13000	6.0	1	
26...	168	45	45	45	43	12500	6.0	1	1	
27...	174	41	41	41	41	12500	6.0	4	
28...	137	33	33	33	32	16000	5.6	1	
29...	206	47	47	47	46	14500	5.6	2	
30...	174	41	41	41	34	12500	5.4	7	97	5.6	...	5	
31...	137	33	33	33	30	13000	5.5	3	3	
32...	72	17	16	16	1	16	13000	5.5	2	
33...	113	27	27	27	24	12500	5.3	3	2	
34...	284	67	67	67	61	13000	5.7	5	93	5.2	...	8	
35...	99	26	26	26	24	12000	5.2	2	2	
36...	113	26	26	26	23	13000	5.4	2	3	
37...	30	9	9	9	9	13000	5.4	
38...	104	26	26	26	26	15000	5.3	1	
39...	105	28	28	28	26	15500	5.3	2	2	
40...	54	14	14	14	11	15500	5.6	2	2	
41...	30	8	6	6	...	2	2	6	26000	6.2	1	
42...	103	28	28	28	27	15500	5.5	1	
43...	65	18	18	18	16	15000	5.1	1	3	
44...	159	40	40	40	39	15500	5.7	1	3	
45...	118	30	28	28	...	2	2	29	15000	5.9	1	2	
46...	150	36	36	36	34	15000	5.9	2	2	
47...	157	37	37	37	33	13500	5.0	4	5	
48...	112	25	24	24	...	1	1	25	13500	5.0	6	
49...	117	28	28	28	26	13000	5.7	2	4	
50...	41	12	12	12	12	13000	5.5	
51...	150	35	35	35	35	13000	5.6	5	
52...	150	36	36	36	32	13000	5.7	4	1	
54...	149	37	37	37	34	13000	5.6	2	10	
55...	275	68	68	68	59	15500	5.2	7	104	5.1	...	1	
56...																			

U.S. CENSUS OF HOUSING: 1960

Series HC(3)-315

CITY BLOCKS

Lakewood, Ohio

Prepared under the supervision of
WAYNE F. DAUGHERTY, Chief
Housing Division



U.S. DEPARTMENT OF COMMERCE

Luther H. Hodges, Secretary

BUREAU OF THE CENSUS

Richard M. Scammon, Director (From May 1, 1961)

Robert W. Burgess, Director (To March 3, 1961)

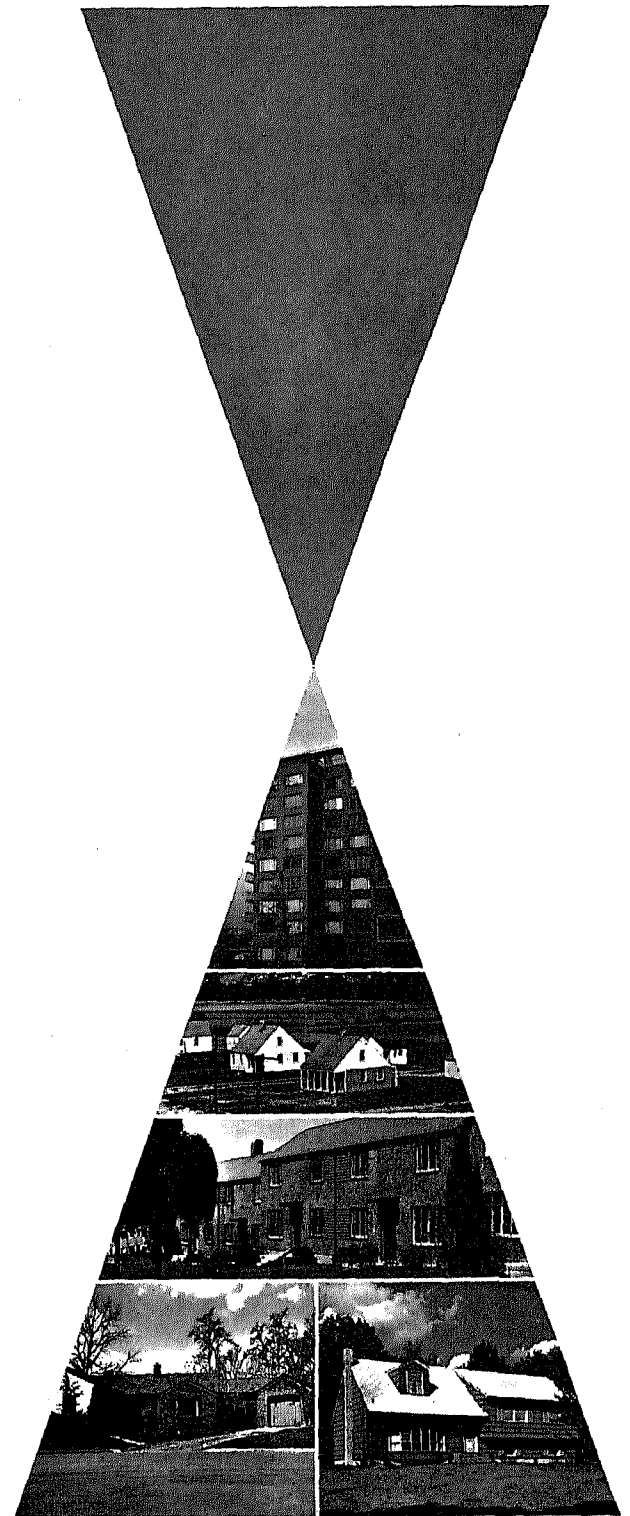



BUREAU OF THE CENSUS

RICHARD M. SCAMMON, *Director* (From May 1, 1961)

ROBERT W. BURGESS, *Director* (To March 3, 1961)

A. ROSS ECKLER, *Deputy Director*
HOWARD C. GRIEVES, *Assistant Director*
CONRAD TAEUBER, *Assistant Director*
MORRIS H. HANSEN, *Assistant Director for Statistical Standards*
CHARLES B. LAWRENCE, JR., *Assistant Director for Operations*
WALTER L. KEHRES, *Assistant Director for Administration*
CALVERT L. DEDRICK, *Chief, International Statistical Programs Office*
A. W. VON STRUVE, *Acting Public Information Officer*

Housing Division—

WAYNE F. DAUGHERTY, *Chief*
DANIEL B. RATHBUN, *Assistant Chief*
BEULAH WASHABAUGH, *Special Assistant*
MILTON D. LIEBERMAN, *Chief, Coordination and Research*

Decennial Operations Division—GLEN S. TAYLOR, *Chief*
Electronic Systems Division—ROBERT F. DRURY, *Chief*
Field Division—JEFFERSON D. MCPHIE, *Chief*
Geography Division—WILLIAM T. FAY, *Chief*
Population Division—HOWARD G. BRUNSMAN, *Chief*
Statistical Methods Division—JOSEPH STEINBERG, *Chief*

Library of Congress Card Number: A61-9347

SUGGESTED CITATION

U.S. Bureau of the Census. *U.S. Census of Housing: 1960. Vol. III, City Blocks.*
Series HC(3), No. 315.
U.S. Government Printing Office, Washington, D.C., 1961.

For sale by the Superintendent of Documents, U.S. Government Printing Office, Washington 25, D.C.
or any of the Field Offices of the Department of Commerce — Price 20 cents.

Table 1.—CHARACTERISTICS OF HOUSING UNITS, FOR THE CITY: 1960

Subject	Number	Percent	Subject	Number	Percent
All housing units	24,214	100.0	Occupied housing units—Con.		
CONDITION AND PLUMBING			COLOR		
Sound	23,159	95.6	White	23,259	99.8
With all plumbing facilities	22,601	93.3	Nonwhite	36	0.2
Lacking some or all facilities	558	2.3	PERSONS PER ROOM		
Deteriorating	915	3.8	1.00 or less	22,683	97.4
With all plumbing facilities	805	3.3	1.01 or more	612	2.6
Lacking some or all facilities	110	0.5	AVERAGE NUMBER OF ROOMS		
With flush toilet	107	0.4	Owner occupied	6.6	...
No flush toilet	3	...	Renter occupied	4.3	...
Dilapidated	140	0.6	VALUE AND RENT		
Occupied housing units	23,295	100.0	Average value	19,400	...
TENURE			Average contract rent	92	...
Owner occupied	11,863	50.9			
Renter occupied	11,432	49.1			

NOTE.—On the map for Lakewood approximately 330 blocks are identified.

Table 2.—CHARACTERISTICS OF HOUSING UNITS, BY BLOCKS: 1960

["Total population" contains no persons in group quarters unless preceded by asterisk; one asterisk (*) denotes less than 10 percent; two asterisks (**), 10 percent or more]

Blocks within census tracts	Total population	All housing units by condition and plumbing								Occupied housing units							
		Total	Sound			Deteriorating			Dilapidated	Owner occupied			Renter occupied			Occupied by non-white	1.01 or more persons per room
			Total	With all plumbing facilities	Lacking some or all facilities	Total	With all plumbing facilities	Lacking some or all facilities		Total	Average value (dollars)	Average number of rooms	Total	Average contract rent (dollars)	Average number of rooms		
LW-1	*2581	794	783	783	...	11	11	610	30000	8.3	170	98	5.5	1	5
1	197	63	63	63	62	37000	8.7	1	1
3	141	45	45	45	44	37000	9.2
6	187	65	65	65	52	38000	9.3	11	140	3.7
7	73	17	17	17	17	37000	10.0
8	100	29	29	29	29	38000	10.4
12	118	33	33	33	32	38000	10.1	1
15	96	24	24	24	20	40000	10.6	4
17	146	47	47	47	46	31000	8.9	1
18	89	23	23	23	22	24000	7.7	1
19	62	19	19	19	17	24000	8.3	2
20	139	43	42	42	...	1	1	22	20000	7.5	18	89	5.8
23	83	25	25	25	21	34000	8.7	4
24	*196	58	58	58	48	27000	8.3	8	124	6.5	1	...
25	159	44	43	43	...	1	1	35	21000	7.1	9	118	6.0
26	166	55	55	55	35	18000	6.5	17	135	5.3
27	264	88	81	81	...	7	7	34	16000	5.7	52	75	5.1	...	3
28	87	28	26	26	...	2	2	19	15500	5.5	9	74	5.7	...	1
29	278	88	88	88	55	18000	7.1	32	96	5.7
LW-2	*2795	1009	1001	988	13	8	7	1	...	452	15500	6.4	521	81	4.3	5	27
1	*80	35	35	35	17	26000	7.6	16	104
2	479	150	150	150	92	15000	6.4	56	84	4.8	2	12
4	427	146	145	141	4	1	1	74	16500	6.8	65	78	4.4	...	3
5	429	160	155	146	9	5	5	68	16000	6.1	88	73	4.5	1	3
6	75	18	18	18	13	13000	6.5	5	87	5.0	...	2
7	89	25	23	23	...	2	2	16	14500	6.3	9	69	5.0
8	78	40	40	40	13	14000	6.1	17	89	4.1	1	1
12	185	50	50	50	27	15000	6.4	21	81	4.9	...	2
13	**88	24	24	24	13	15500	6.3	11	79	5.8	1	...
14	169	88	88	88	11	14500	6.0	76	72	3.3	...	2
15	139	86	86	86	9	12000	5.9	72	93	3.4
17	439	136	136	136	79	15500	6.5	56	85	5.3	...	2
18	128	51	51	51	20	14500	5.8	29	81	3.6
LW-3	2593	917	914	910	4	3	3	539	18500	6.8	351	84	5.0	...	18
1	71	26	25	24	1	1	1	22	21000	6.8	3
2	217	70	70	70	63	30000	8.8	7	118	6.6
5	83	27	27	27	16	25000	7.9	10	119	6.0	...	1
6	45	19	19	19	11	21000	6.7	8	97	5.1
7	65	22	22	22	11	23000	7.3	9	108	6.1
8	36	18	18	18	10	26000	6.6	6	105	4.5
9	374	139	137	137	...	2	2	70	16500	6.6	65	77	4.4	...	4
10	394	147	147	146	1	77	18000	6.4	66	74	5.2	...	1
11	488	185	185	185	87	15500	6.2	93	80	4.8	...	4
12	443	155	155	153	2	88	15000	6.5	60	84	5.3	...	4
13	377	109	109	109	84	14500	6.3	24	90	5.4	...	4
LW-4	*4892	1740	1678	1676	2	52	52	885	20000	6.8	812	98	4.8	5	29
4	82	25	25	25	24	24000	7.4	1
5	75	23	22	22	...	1	1	22	23000	7.6	1

City Block Characteristics

Table 2.—CHARACTERISTICS OF HOUSING UNITS, BY BLOCKS: 1960—Con.

["Total population" contains no persons in group quarters unless preceded by asterisk; one asterisk (*) denotes less than 10 percent; two asterisks (**), 10 percent or more]

Blocks within census tracts	Total population	All housing units by condition and plumbing								Occupied housing units								
		Total	Sound			Deteriorating			Dilapidated	Owner occupied			Renter occupied			Occupied by non-white	1.01 or more persons per room	
			Total	With all plumbing facilities	Lacking some or all facilities	Total	With all plumbing facilities	Lacking some or all facilities		Total	Average value (dollars)	Average number of rooms	Total	Average contract rent (dollars)	Average number of rooms			
								With flush toilet										No flush toilet
11...	210	75	75	75	45	16000	5.8	27	82	4.1	...	4	
12...	188	82	82	82	44	15500	6.0	33	83	3.5	
13...	218	75	75	75	40	20000	7.0	34	75	3.8	
14...	174	65	65	65	38	21000	7.0	26	93	3.7	
15...	156	47	47	46	1	44	19500	7.2	2	
16...	162	47	47	47	41	18500	6.7	6	103	6.0	
17...	151	52	52	51	1	26	17500	5.9	25	91	5.4	
18...	144	56	56	56	32	16500	5.4	22	86	5.1	
19...	110	40	40	40	28	17000	5.8	11	80	5.0	...	1	
20...	150	53	53	53	31	15500	5.5	21	78	5.0	2	2	
21...	225	70	70	70	38	21000	6.4	31	79	5.0	...	1	
22...	56	19	19	19	13	21000	6.4	5	91	5.0	
23...	18	7	7	7	7	21000	6.1	
24...	71	25	25	25	23	20000	6.4	2	
LW-13...	*3965	1323	1299	1290	9	23	23	851	17500	6.6	440	85	4.9	...	37	
1...	181	64	64	62	2	36	15000	7.1	26	83	5.4	
2...	197	81	81	75	6	39	16500	7.0	39	77	4.3	
3...	*137	40	40	40	30	20000	7.6	7	83	6.7	...	1	
4...	*144	41	41	41	35	19500	7.6	5	85	6.0	...	2	
5...	14	5	5	5	4	1	
6...	245	86	86	86	56	20000	6.8	30	85	4.9	...	2	
7...	90	30	30	30	28	19500	6.6	1	
8...	248	69	69	69	62	21000	7.3	7	77	4.9	...	4	
9...	238	70	69	69	...	1	1	64	19500	7.2	6	77	5.2	...	2	
10...	270	79	79	79	60	16500	6.5	17	132	5.5	...	2	
11...	375	143	143	143	60	15000	6.1	78	84	4.0	...	4	
12...	*232	54	52	52	...	2	2	36	18000	6.4	18	89	5.2	...	5	
13...	177	58	57	57	...	4	4	40	17000	6.6	18	70	5.3	
14...	189	67	63	63	...	4	4	28	18000	6.4	37	80	4.5	...	3	
15...	167	61	58	57	1	3	3	38	16000	6.0	22	86	5.0	...	1	
16...	128	38	34	34	...	4	4	30	17000	6.2	8	86	4.9	...	2	
17...	121	45	45	45	28	14000	6.0	14	81	5.0	...	2	
18...	97	28	26	26	...	2	2	24	14500	5.9	3	3	
19...	190	64	64	64	...	1	1	42	16500	6.1	21	87	5.2	...	1	
20...	172	65	63	63	...	2	2	29	17000	5.7	36	82	5.3	...	2	
21...	80	30	29	29	...	1	1	18	16000	5.9	11	93	5.3	...	1	
22...	97	38	36	36	...	2	2	27	16000	5.5	10	87	4.9	
23...	54	23	23	23	14	20000	5.9	5	104	4.6	
24...	122	43	42	42	...	1	1	23	19500	6.1	20	91	4.9	
LW-14...	4806	1609	1517	1503	14	87	85	2	...	5	1004	17500	6.1	577	81	4.8	...	50
1...	197	62	53	53	...	9	9	48	22000	6.2	13	86	5.7	...	1	
2...	243	84	84	83	1	68	23000	6.5	13	71	5.0	...	1	
3...	193	51	40	39	1	10	10	36	15000	6.8	14	78	6.0	...	3	
4...	177	55	39	39	...	12	11	1	...	4	38	15500	6.5	17	76	4.9	...	1
5...	190	52	48	48	...	4	4	45	15500	6.2	7	77	5.6	...	3	
6...	265	91	88	88	...	3	3	57	18000	6.4	30	71	4.9	...	1	
7...	187	48	39	39	...	9	8	1	...	32	15500	7.1	14	76	4.9	...	3	
8...	328	126	126	126	55	15500	6.0	70	83	5.0	
9...	242	84	81	81	...	3	3	48	16500	6.4	30	79	4.5	...	3	
10...	228	95	95	95	42	15000	5.5	50	98	4.6	...	2	
11...	235	86	86	85	1	45	14500	5.8	41	76	4.7	...	1	
12...	209	74	74	71	3	42	15500	5.8	31	70	4.5	...	4	
13...	184	58	56	56	...	2	2	44	16000	5.7	14	89	4.6	...	3	
14...	84	26	26	26	21	18000	6.0	5	95	5.4	
15...	244	99	96	88	8	3	3	40	17500	5.9	58	71	3.6	...	3	
16...	73	25	25	25	19	14000	5.9	6	84	5.0	
17...	180	55	54	54	...	1	1	36	16000	5.8	19	84	4.9	...	3	
18...	185	54	50	50	...	4	4	30	18500	5.7	24	96	5.4	...	5	
19...	79	27	27	27	16	23000	5.7	11	91	4.9	...	1	
20...	47	18	18	18	16	17000	5.1	2	
21...	42	12	12	12	12	17500	6.0	1	
22...	256	84	73	73	...	11	11	57	15000	5.8	27	81	5.1	...	4	
23...	296	96	89	89	...	7	7	61	16000	5.7	33	81	4.8	...	4	
24...	318	103	94	94	...	9	9	53	16500	5.7	47	85	5.0	...	3	
25...	124	44	44	44	43	27000	6.5	1	
LW-15...	*5693	1963	1878	1856	22	85	84	1119	18000	6.2	779	78	4.5	4	56	
1...	**290	93	90	90	...	3	3	41	20000	7.8	50	98	3.8	
2...	126	37	37	37	35	24000	8.4	2	
3...	47	16	16	16	15	26000	7.8	
4...	39	9	9	8	1	8	23000	8.6	1	
5...	*327	132	131	131	...	1	1	64	22000	7.1	63	99	3.4	...	1	
6...	212	60	59	59	...	1	1	50	17000	7.3	7	87	4.4	1	3	
7...	256	82	81	81	...	1	1	60	15000	6.6	19	81	3.6	...	2	
8...	188	57	57	57	52	17500	6.6	5	50	4.8	...	1	
9...	218	68	68	68	50	19000	6.9	17	91	4.4	...	1	
10...	215	79	79	79	45	19500	6.8	29	78	4.5	...	2	
11...	248	88	88	88	45	18500	6.4	38	77	4.1	...	6	
12...	241	84	73	55	18	11	11	46	14500	5.5	36	60	3.8	...	6	
13...	261	87	80	80	...	7	7	44	17000	5.6	38	74	4.8	...	2	
14...	314	122	88	88	...	34	34	43	15500	5.2	71	76	4.2	1	8	
15...	286	114	101	101	...	13	12	44	17000	5.3	66	67	4.4	2	2	
16...	221	87	87	87	39	15500	5.5	41	80	5.0	
17...	215	65	65	65	43	16000	6.1	21	86	4.9	...	1	

Table 2.—CHARACTERISTICS OF HOUSING UNITS, BY BLOCKS: 1960—Con.

["Total population" contains no persons in group quarters unless preceded by asterisk; one asterisk (*) denotes less than 10 percent; two asterisks (**), 10 percent or more]

Blocks within census tracts	Total population	All housing units by condition and plumbing									Occupied housing units							
		Total	Sound			Deteriorating			Dilapidated	Owner occupied			Renter occupied			Occupied by non-white	1.01 or more persons per room	
			Total	With all plumbing facilities	Lacking some or all facilities	Total	With all plumbing facilities	Lacking some or all facilities		Total	Average value (dollars)	Average number of rooms	Total	Average contract (dollars)	Average number of rooms			
								With flush toilet										No flush toilet
18...	193	75	75	75	40	16500	5.9	32	66	4.6	...	1
19...	272	91	88	88	...	3	3	58	16000	5.7	31	81	5.2	...	4
20...	241	79	75	75	...	4	4	55	16500	5.8	22	81	4.9	...	3
21...	259	91	91	90	1	54	16000	5.4	37	78	5.0	...	1
22...	310	106	106	106	49	16000	5.3	55	74	5.1	...	3
23...	307	101	101	101	55	16500	5.5	44	77	4.9	...	4
24...	228	79	78	78	...	1	1	55	13500	5.4	23	77	5.0
25...	179	61	55	53	2	6	6	29	14500	5.2	31	64	4.5	...	4
LW-16...	*2985	970	877	824	53	88	62	26	...	5	444	16500	6.7	497	71	4.3	2	37
1...	446	146	146	146	46	14500	6.3	95	81	4.6	...	7
2...	294	90	90	90	49	15000	7.2	39	76	5.0	...	3
3...	*343	87	86	85	1	1	1	47	18000	7.2	38	92	5.6	...	4
4...	**268	68	68	62	6	39	18500	7.9	25	75	3.7	...	1
5...	*254	89	73	57	16	16	7	9	41	18000	8.6	45	59	2.2	1	4
6...	205	69	68	68	...	1	1	46	17500	6.8	23	81	4.3	...	5
7...	259	86	86	86	49	16500	5.9	37	80	5.4	...	3
8...	317	105	92	92	...	13	10	3	52	15000	5.8	49	73	4.4	...	3
9...	*251	90	62	59	3	28	17	11	36	14500	6.0	49	59	4.5	...	2
10...	348	140	106	79	27	29	26	3	...	5	39	12500	5.1	97	56	3.8	1	5
LW-17...	*2799	991	869	821	48	105	87	18	...	17	411	13000	5.8	534	73	4.3	1	48
1...	393	159	158	158	...	1	1	34	12500	6.2	120	75	4.0	...	2
2...	425	151	142	141	1	8	8	57	13500	6.0	87	77	4.4	...	12
3...	*289	80	69	69	...	11	11	58	13000	6.3	19	70	4.7	...	2
4...	279	87	69	65	4	18	15	3	46	13000	5.9	40	73	4.9	1	3
5...	349	112	96	95	1	14	14	2	42	14000	5.7	67	86	5.0	...	6
6...	262	111	87	70	17	17	11	6	...	7	43	13000	5.0	61	58	4.0	...	4
7...	225	84	76	69	7	8	8	43	12000	5.3	38	60	4.2	...	2
8...	*235	81	59	49	10	15	11	4	...	7	40	11500	5.5	35	62	4.3	...	6
9...	*233	92	85	77	8	7	2	5	27	10500	6.1	55	84	3.7	...	8
10...	109	34	28	28	...	6	6	21	13000	6.1	12	70	5.1	...	3
LW-18...	*2018	813	650	349	301	98	50	48	...	65	220	12000	5.0	539	53	3.5	1	68
2...	95	43	28	17	11	12	2	10	...	3	12	12500	4.7	27	50	3.0	1	4
3...	157	66	30	22	8	14	7	7	...	22	22	...	4.5	41	56	3.6	...	2
4...	214	91	63	25	38	23	10	13	...	5	23	...	4.8	60	58	3.4	...	6
5...	164	80	79	19	60	1	15	...	5.2	60	48	3.0	...	1
6...	*164	68	68	41	27	8	...	4.9	56	50	3.4	...	9
7...	265	99	99	54	45	28	12500	4.9	69	57	3.7	...	6
8...	204	79	68	40	28	11	1	10	24	12000	5.3	51	52	3.6	...	11
9...	115	48	48	29	19	15	11500	5.2	30	52	3.5	...	4
10...	101	51	51	16	35	10	...	4.0	35	54	3.4	...	3
11...	311	116	109	79	30	7	6	1	48	12000	5.0	58	55	3.5	...	12
12...	228	72	7	7	...	31	24	7	...	34	15	10500	6.1	52	51	4.0	...	10

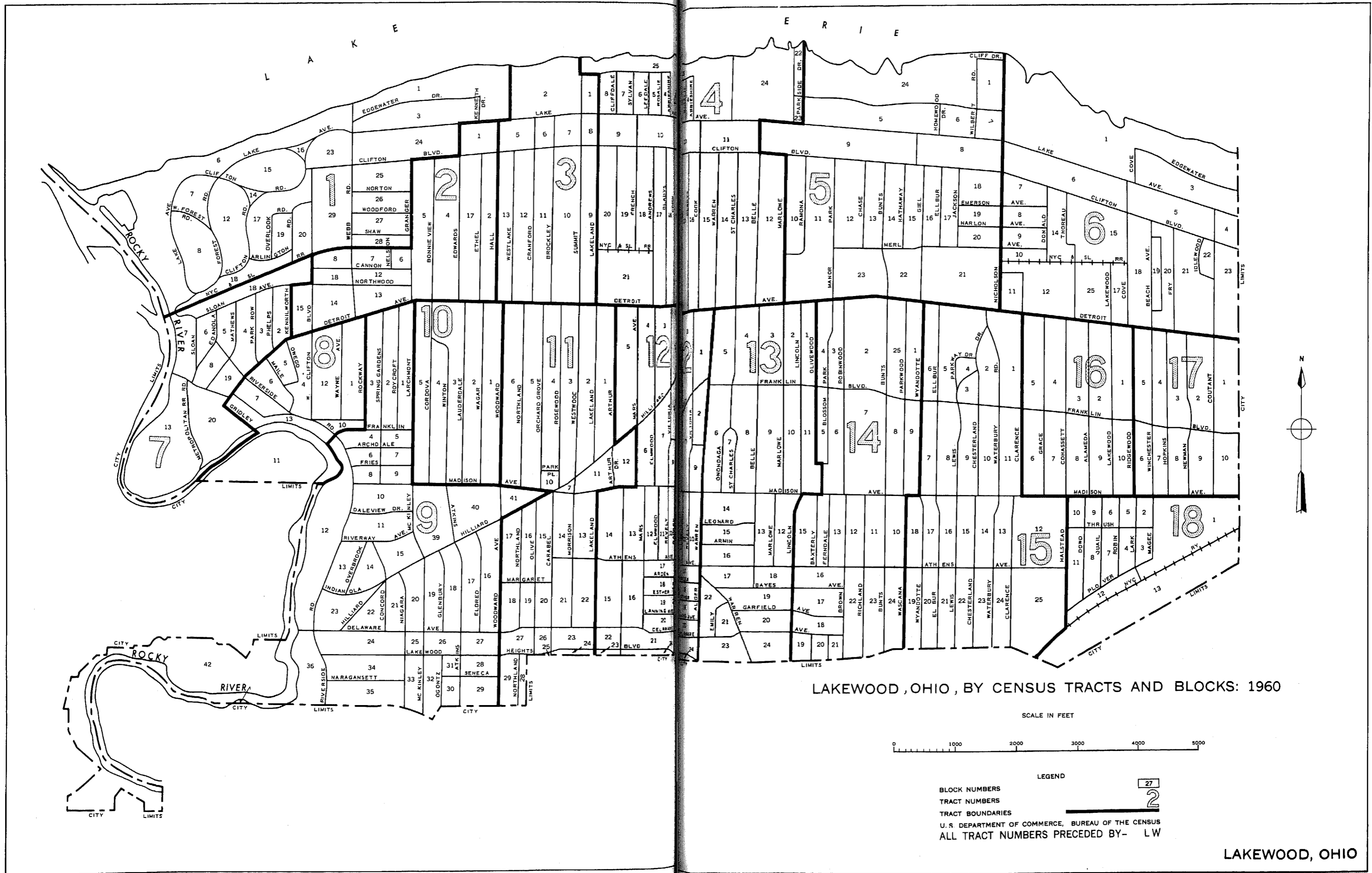

LAKWOOD , OHIO , BY CENSUS TRACTS AND BLOCKS: 1960

SCALE IN FEET

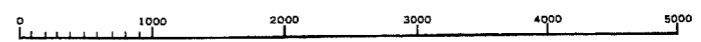

LEGEND

27
2

BLOCK NUMBERS
 TRACT NUMBERS
 TRACT BOUNDARIES
 U.S. DEPARTMENT OF COMMERCE, BUREAU OF THE CENSUS
 ALL TRACT NUMBERS PRECEDED BY- LW

U.S. CENSUS OF HOUSING: 1960

Series HC(3)-316

CITY BLOCKS

Lima, Ohio

Prepared under the supervision of
WAYNE F. DAUGHERTY, Chief
Housing Division



U.S. DEPARTMENT OF COMMERCE
Luther H. Hodges, Secretary

BUREAU OF THE CENSUS

Richard M. Scammon, *Director (From May 1, 1961)*
Robert W. Burgess, *Director (To March 3, 1961)*

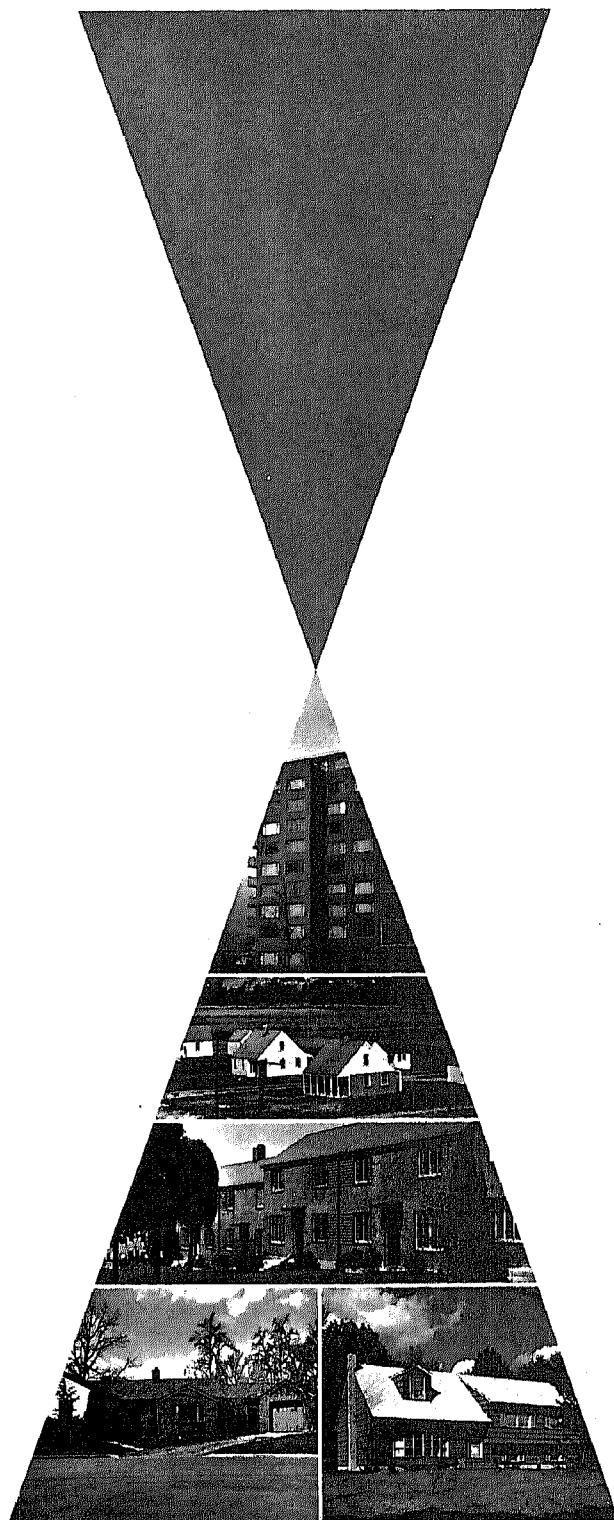



BUREAU OF THE CENSUS

RICHARD M. SCAMMON, *Director* (From May 1, 1961)

ROBERT W. BURGESS, *Director* (To March 3, 1961)

A. ROSS ECKLER, *Deputy Director*
HOWARD C. GRIEVES, *Assistant Director*
CONRAD TAEUBER, *Assistant Director*
MORRIS H. HANSEN, *Assistant Director for Statistical Standards*
CHARLES B. LAWRENCE, JR., *Assistant Director for Operations*
WALTER L. KEHRES, *Assistant Director for Administration*
CALVERT L. DEDRICK, *Chief, International Statistical Programs Office*
A. W. VON STRUVE, *Acting Public Information Officer*

Housing Division—

WAYNE F. DAUGHERTY, *Chief*
DANIEL B. RATHBUN, *Assistant Chief*
BEULAH WASHBAUGH, *Special Assistant*
MILTON D. LIBBERMAN, *Chief, Coordination and Research*

Decennial Operations Division—GLEN S. TAYLOR, *Chief*
Electronic Systems Division—ROBERT F. DRURY, *Chief*
Field Division—JEFFERSON D. MCPIKE, *Chief*
Geography Division—WILLIAM T. FAY, *Chief*
Population Division—HOWARD G. BRUNSMAN, *Chief*
Statistical Methods Division—JOSEPH STEINBERG, *Chief*

Library of Congress Card Number: A61-9347

SUGGESTED CITATION

U.S. Bureau of the Census. *U.S. Census of Housing: 1960. Vol. III, City Blocks.*
Series HC(3), No. 316.
U.S. Government Printing Office, Washington, D.C., 1961.

For sale by the Superintendent of Documents, U.S. Government Printing Office, Washington 25, D.C.
or any of the Field Offices of the Department of Commerce — Price 23 cents.

Table 1.—CHARACTERISTICS OF HOUSING UNITS, FOR THE CITY: 1960

Subject	Number	Percent	Subject	Number	Percent
All housing units.....	17,074	100.0	Occupied housing units—Con.		
CONDITION AND PLUMBING			COLOR		
Sound.....	13,305	77.9	White.....	14,727	92.0
With all plumbing facilities.....	12,832	75.2	Nonwhite.....	1,275	5.0
Lacking some or all facilities.....	473	2.8			
Deteriorating.....	3,150	18.5	PERSONS PER ROOM		
With all plumbing facilities.....	2,739	16.0	1.00 or less.....	14,684	91.8
Lacking some or all facilities.....	411	2.4	1.01 or more.....	1,318	8.2
With flush toilet.....	354	2.1			
No flush toilet.....	57	0.3	AVERAGE NUMBER OF ROOMS		
Dilapidated.....	619	3.6	Owner occupied.....	5.8	...
Occupied housing units.....	16,002	100.0	Renter occupied.....	4.3	...
TENURE			VALUE AND RENT		
Owner occupied.....	9,996	62.5	Average value.....dollars..	10,600	...
Renter occupied.....	6,006	37.5	Average contract rent.....dollars..	53	...

NOTE.—On the map for Lima approximately 690 blocks are identified.

Table 2.—CHARACTERISTICS OF HOUSING UNITS, BY BLOCKS: 1960

["Total population" contains no persons in group quarters unless preceded by asterisk: one asterisk (*) denotes less than 10 percent; two asterisks (**), 10 percent or more]

Blocks within census tracts	Total population	All housing units by condition and plumbing									Occupied housing units							
		Total	Sound			Deteriorating			Dilapidated	Owner occupied			Renter occupied			Occupied by non-white	1.01 or more persons per room	
			Total	With all plumbing facilities	Lacking some or all facilities	Total	With all plumbing facilities	Lacking some or all facilities		Total	Average value (dollars)	Average number of rooms	Total	Average contract rent (dollars)	Average number of rooms			
1.....	2884	920	613	551	62	226	166	49	11	81	476	6500	5.9	359	47	4.3	152	108
2.....	11	3
4.....	76	23	11	7	4	7	3	2	2	5	18	4500	4.9	3	
5.....	17	5	2	...	2	2	2	1	4	1	
6.....	12	6	5	5	...	1	...	1	3	2	
7.....	23	7	5	5	...	2	...	2	4	1	
10.....	48	17	16	16	...	1	1	12	5500	5.5	3	
11.....	40	13	7	6	1	5	5	1	10	7000	5.4	2	2	
12.....	29	9	8	8	...	1	1	8	6500	5.4	
13.....	56	14	11	10	1	3	3	7	8000	5.9	5	36	5.4	...	
14.....	33	11	11	11	9	6500	6.2	2	
15.....	40	10	9	9	...	1	1	9	7500	5.6	1	
16.....	19	6	3	3	...	3	2	1	2	2	
18.....	53	18	14	9	5	3	1	...	2	1	9	7000	5.4	6	41	4.0	...	
19.....	7	2	
20.....	159	51	40	39	1	11	9	1	1	...	32	6500	5.8	14	50	4.3	1	
21.....	6	2	
22.....	51	15	14	14	...	1	1	11	7500	6.0	4	
23.....	31	7	7	7	5	7500	5.8	2	
24.....	53	13	1	1	...	12	12	5	5000	5.0	7	41	5.0	2	
25.....	95	25	14	13	1	11	7	3	1	...	15	5500	5.9	9	43	5.0	1	
26.....	142	34	17	17	...	16	12	3	1	1	23	6500	6.0	10	41	6.1	2	
27.....	140	43	30	30	...	13	11	2	27	7000	5.6	12	49	4.8	1	
28.....	53	20	8	6	2	12	10	2	11	5500	6.1	6	38	3.3	1	
29.....	23	9	9	2	7	8	53	2.8	7	
30.....	55	13	2	2	...	6	4	2	...	5	8	6000	6.1	5	38	4.2	10	
31.....	13	2	
32.....	63	16	2	2	...	3	3	11	9	4000	7.1	5	49	5.0	13	
33.....	72	22	22	7	4000	6.3	13	45	2.9	19	
34.....	64	22	15	15	...	4	4	3	12	5000	6.1	7	48	4.6	3	
35.....	68	18	14	12	2	4	4	13	6500	5.9	5	36	4.4	3	
36.....	89	27	21	20	1	5	4	...	1	1	12	8500	6.2	12	58	3.9	6	
37.....	64	21	9	8	1	10	8	2	...	2	10	4500	6.1	10	32	4.1	8	
38.....	10	4	
39.....	53	15	14	10	4	...	1	3	9	49	4.7	10	
40.....	64	34	29	21	8	5	4	1	11	7000	6.3	17	47	3.4	4	
41.....	45	19	18	18	2	4	4	9	6000	5.4	7	50	4.1	...	
42.....	70	24	20	18	2	4	4	12	7000	6.4	9	51	4.8	...	
43.....	55	19	18	16	2	1	1	17	6000	6.2	2	1	
44.....	44	15	9	7	2	6	13	6000	5.9	1	6	
45.....	110	27	20	20	...	6	6	1	10	5500	5.8	14	50	4.3	9	
46.....	76	21	20	19	1	1	8	6000	6.3	9	49	5.8	8	
47.....	109	42	42	40	2	15	7000	5.9	25	73	4.0	1	
48.....	78	27	26	23	3	1	1	13	6500	6.3	12	43	3.8	...	
49.....	91	42	38	26	12	3	2	1	...	1	15	7000	6.3	23	44	5.2	1	
50.....	81	26	10	9	1	11	7	4	...	5	14	7000	6.8	10	44	4.6	9	
54.....	154	45	15	14	1	21	15	5	1	9	14	6000	6.6	27	44	3.6	23	
55.....	86	37	29	25	4	6	2	4	...	2	15	7500	5.9	18	41	3.6	...	
56.....	53	19	16	13	3	2	2	1	5	...	5.8	13	44	4.0	...	
2.....	*2617	856	639	636	3	210	197	7	6	7	630	10500	5.5	178	74	4.6	3	
3.....	41	12	9	9	...	3	3	5	...	6.2	7	44	4.9	...	

City Block Characteristics

Table 2.—CHARACTERISTICS OF HOUSING UNITS, BY BLOCKS: 1960—Con.

["Total population" contains no persons in group quarters unless preceded by asterisk: one asterisk (*) denotes less than 10 percent; two asterisks (**), 10 percent or more]

Table with columns: Blocks within census tracts, Total population, All housing units by condition and plumbing (Sound, Deteriorating, Dilapidated), Occupied housing units (Owner occupied, Renter occupied), Occupied by non-white, 1.01 or more persons per room.

City Block Characteristics

Table 2.—CHARACTERISTICS OF HOUSING UNITS, BY BLOCKS: 1960—Con.

["Total population" contains no persons in group quarters unless preceded by asterisk; one asterisk (*) denotes less than 10 percent; two asterisks (**), 10 percent or more]

Table with columns: Blocks within census tracts, Total population, All housing units by condition and plumbing (Sound, Deteriorating, Dilapidated), Occupied housing units (Owner occupied, Renter occupied), and I.OI or more persons per room. The table lists data for numerous blocks, including population counts and housing unit characteristics.

Table 2.—CHARACTERISTICS OF HOUSING UNITS, BY BLOCKS: 1960—Con.

["Total population" contains no persons in group quarters unless preceded by asterisk; one asterisk (*) denotes less than 10 percent; two asterisks (**), 10 percent or more]

Blocks within census tracts	Total population	All housing units by condition and plumbing								Occupied housing units								
		Total	Sound			Deteriorating			Dilapidated	Owner occupied			Renter occupied			Occupied by non-white	1.01 or more persons per room	
			Total	With all plumbing facilities	Lacking some or all facilities	Total	With all plumbing facilities	Lacking some or all facilities		Total	Average value (dollars)	Average number of rooms	Total	Average contract rent (dollars)	Average number of rooms			
								With flush toilet										No flush toilet
27...	119	33	31	31	...	2	2	29	10500	5.3	4	1	3
28...	100	31	31	31	25	11500	5.9	6	56	4.7	...	1
29...	130	45	45	45	35	13000	6.3	9	68	3.9	...	2
30...	137	44	44	44	30	12000	6.2	11	66	4.5	...	2
31...	136	44	44	44	27	10500	6.6	17	72	4.8	...	1
32...	50	15	15	15	13	12000	6.5	2
33...	42	17	17	17	16	11500	5.8	1
34...	24	10	10	10	10	13000	5.3
35...	10	5	5	5	4	1
36...	26	10	10	10	10	17000	6.1
38...	3	2
39...	69	23	23	23	23	12500	5.5
40...	96	29	29	29	25	12500	5.9	4	2
41...	9	3
43...	113	52	47	47	...	5	4	1	24	10000	6.0	20	60	4.7	...	1
44...	49	14	10	10	...	3	3	6	10500	6.2	7	132	3.4	3	4
45...	47	14	1	1	...	7	6	1	8	11500	6.9	6	58	5.7	14	...
46...	81	27	22	22	...	3	3	22	11500	5.7	5	57	5.2	15	1
47...	106	30	30	30	27	16000	5.8	3	2
48...	52	19	19	19	16	16000	5.9	2
49...	54	19	19	19	18	14500	5.8	1
50...	117	41	41	41	41	16500	6.6
51...	65	25	20	20	...	5	5	19	10000	5.8	6	67	5.2	12	...
52...	61	18	13	13	...	5	5	18	7000	5.8	13	2
53...	83	23	20	20	...	3	3	9	9500	6.2	14	57	5.1	2	...
54...	138	50	43	43	...	5	5	22	11000	6.7	23	57	4.3	6	1
55...	136	56	49	49	...	7	7	32	13500	6.2	22	66	3.8	...	3
56...	58	18	16	16	...	2	2	8	16000	6.6	8	56	5.1	...	1
57...	72	22	22	22	18	11500	6.2	4	4	...
58...	87	35	30	30	...	5	5	14	8500	6.1	21	63	5.3	8	...
59...	91	30	29	29	...	1	1	25	24000	7.1	3	1
60...	42	11	11	11	11	27000	7.5

U.S. CENSUS OF HOUSING: 1960

Series HC(3)-317

CITY BLOCKS

Lorain, Ohio

Prepared under the supervision of
WAYNE F. DAUGHERTY, Chief
Housing Division



U.S. DEPARTMENT OF COMMERCE

Luther H. Hodges, *Secretary*

BUREAU OF THE CENSUS

Richard M. Scammon, *Director (From May 1, 1961)*

Robert W. Burgess, *Director (To March 3, 1961)*

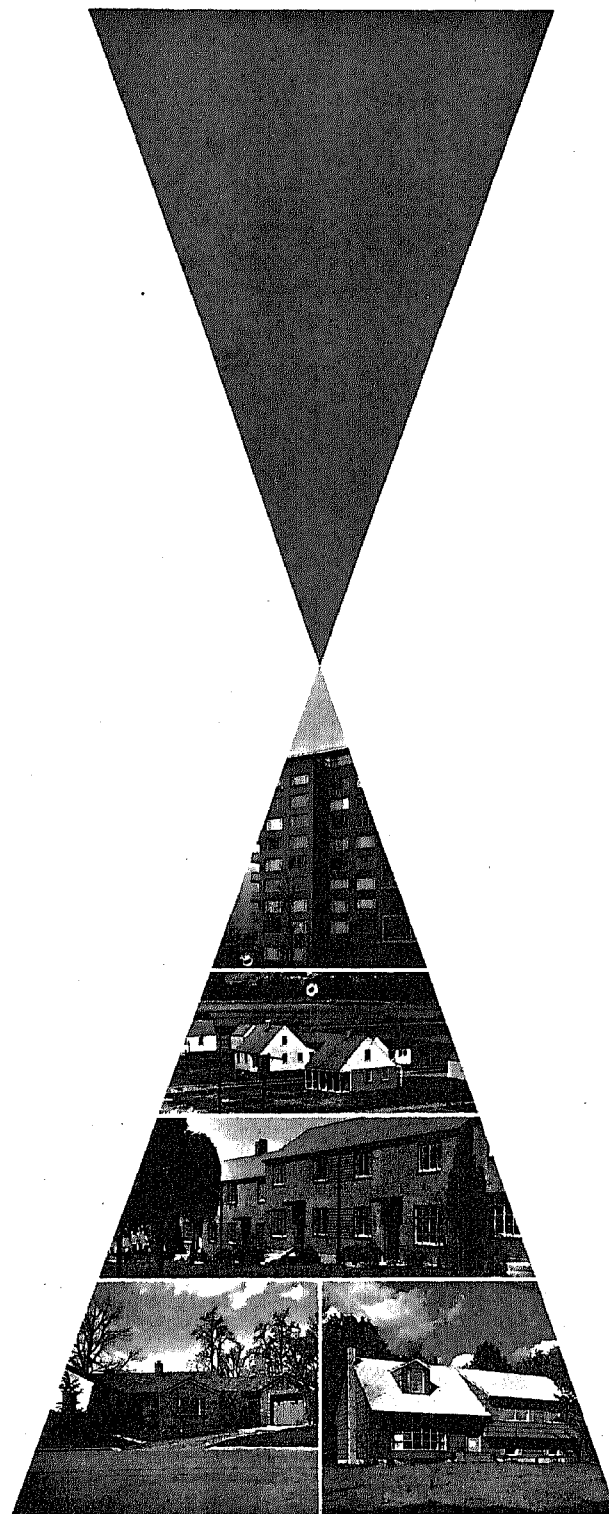



BUREAU OF THE CENSUS

RICHARD M. SCAMMON, *Director* (From May 4, 1961)

ROBERT W. BURGESS, *Director* (To March 1, 1961)

A. ROSS ECKLER, *Deputy Director*
HOWARD C. GRIEVES, *Assistant Director*
CONRAD TABUBER, *Assistant Director*
MORRIS H. HANSEN, *Assistant Director for Statistical Standards*
CHARLES B. LAWRENCE, JR., *Assistant Director for Operations*
WALTER L. KEHRES, *Assistant Director for Administration*
CALVERT L. DEDRICK, *Chief, International Statistical Programs Office*
A. W. VON STRUVE, *Acting Public Information Officer*

Housing Division—

WAYNE F. DAUGHERTY, *Chief*
DANIEL B. RATHBUN, *Assistant Chief*
BEULAH WASHBAUGH, *Special Assistant*
MILTON D. LIBBERMAN, *Chief, Coordination and Research*

Decennial Operations Division—GLEN S. TAYLOR, *Chief*
Electronic Systems Division—ROBERT F. DRURY, *Chief*
Field Division—JEFFERSON D. MCPHIE, *Chief*
Geography Division—WILLIAM T. FAX, *Chief*
Population Division—HOWARD G. BRUNSMAN, *Chief*
Statistical Methods Division—JOSEPH STRINBERG, *Chief*

Library of Congress Card Number: A61-9347

SUGGESTED CITATION

U.S. Bureau of the Census. *U.S. Census of Housing: 1960. Vol. III, City Blocks.*
Series HC(3), No. 317.
U.S. Government Printing Office, Washington, D.C., 1961.

For sale by the Superintendent of Documents, U.S. Government Printing Office, Washington 25, D.C.
or any of the Field Offices of the Department of Commerce—Price 25 cents.

Table 1.—CHARACTERISTICS OF HOUSING UNITS, FOR THE CITY: 1960

Subject	Number	Percent	Subject	Number	Percent
All housing units	19,760	100.0	Occupied housing units—Con.		
CONDITION AND PLUMBING			COLOR		
Sound	17,463	88.4	White	18,232	94.5
With all plumbing facilities	16,742	84.7	Nonwhite	1,066	5.5
Lacking some or all facilities	721	3.6	PERSONS PER ROOM		
Deteriorating	1,967	10.0	1.00 or less	16,893	87.5
With all plumbing facilities	1,460	7.4	1.01 or more	2,407	12.5
Lacking some or all facilities	507	2.6	AVERAGE NUMBER OF ROOMS		
With flush toilet	472	2.4	Owner occupied	5.6	...
No flush toilet	35	0.2	Renter occupied	4.2	...
Dilapidated	330	1.7	VALUE AND RENT		
Occupied housing units	19,300	100.0	Average value.....dollars	14,600	...
TENURE			Average contract rent.....dollars	63	...
Owner occupied	13,107	67.9			
Renter occupied	6,193	32.1			

NOTE.—On the map for Lorain approximately 730 blocks are identified.

Table 2.—CHARACTERISTICS OF HOUSING UNITS, BY BLOCKS: 1960

["Total population" contains no persons in group quarters unless preceded by asterisk: one asterisk (*) denotes less than 10 percent; two asterisks (**), 10 percent or more]

Blocks within census tracts	Total population	All housing units by condition and plumbing								Occupied housing units								
		Total	Sound			Deteriorating			Dilapidated	Owner occupied			Renter occupied			Occupied by non-white	1.01 or more persons per room	
			Total	With all plumbing facilities	Lacking some or all facilities	Total	With all plumbing facilities	Lacking some or all facilities		Total	Average value (dollars)	Average number of rooms	Total	Average contract rent (dollars)	Average number of rooms			
LR-1	3580	1108	1047	1028	25	48	35	3	10	13	862	19000	5.0	204	75	3.8	21	121
1	549	199	180	179	1	17	17	2	152	27000	4.6	43	83	3.6	1	13
2	33	12	9	9	...	2	2	1	9	19500	5.7	3
3	86	30	30	30	20	11500	5.3	10	60	4.3	...	1
4	71	26	26	26	18	12000	5.3	6	73	4.3	...	1
5	63	19	18	18	1	15	13500	5.4	4	2
6	169	51	50	50	1	47	14500	5.1	3	6
7	175	60	60	60	52	26000	4.6	7	67	3.1	...	5
8	168	41	39	39	...	2	1	1	37	10500	5.0	3	7
9	159	43	41	41	...	2	2	37	12000	4.9	6	68	4.5	...	6
10	151	42	42	42	36	12500	4.9	6	72	3.7	...	3
11	103	35	35	35	27	11500	4.6	7	64	3.6	...	9
14	168	50	47	46	1	3	...	2	1	...	38	18500	5.3	8	49	3.9	...	2
15	6	2	9	17000	5.3	2
16	43	9	9	9	16	29000	5.4	2
17	13	4	4	8	84	4.0	...	2
20	61	16	16	16	12	9000	4.3	2
21	30	12	12	12	6	12500	4.5	2	2
22	39	12	12	12	5	...	5.0	6	59	4.2	11	3
23	28	8	7	4	3	1	1	13	20000	5.4	2	1
24	46	11	5	...	5	5	1	6	27000	5.5
25	46	16	10	10	3	5	28000	6.0
26	17	10	10	10	6	22000	5.3
27	22	5	5	4	1	5	24000	5.2	2
28	50	13	13	13	13	19500	5.8	1
29	59	21	21	21	16	25000	6.1	1	4
30	86	19	19	19	19	13500	5.3	2
31	210	52	51	51	...	1	1	51	25000	6.1	4
32	32	8	8	8	8	13500	5.3
33	82	19	19	19	19	14500	5.6	1
34	55	23	23	22	1	15	30000	6.3	4
35	528	190	181	170	11	5	5	4	120	6500	3.7	58	73	3.4	...	36
36	15	3
38	50	14	12	12	2	2	2	9	30000	6.4	4	1
39	4	1
40	67	13	13	13	11	42000	8.5	2
41	10	4
42	68	12	9	9	...	3	2	...	1	...	4	8	62	4.3	...	6
43	18	3
LR-2	1948	641	640	640	...	1	1	600	19500	6.2	36	89	5.0	...	11
2	35	15	15	15	15	32000	6.7
3	13	7	7	7	6	25000	5.8
4	51	22	22	22	21	24000	6.0
6	23	10	10	10	9	16500	6.1	1
7	47	15	15	15	15	18000	6.9
8	65	23	23	23	22	19500	6.2	1
9	93	37	37	37	26	19500	6.4	10	93	4.9
10	129	43	43	43	42	22000	6.7	1	1
12	99	32	32	32	29	21000	6.7	3	1
13	101	34	34	34	28	19000	6.3	5	65	3.8
14	103	31	31	31	30	18000	6.5	1

Table 2.—CHARACTERISTICS OF HOUSING UNITS, BY BLOCKS: 1960—Con.

["Total population" contains no persons in group quarters unless preceded by asterisk; one asterisk (*) denotes less than 10 percent; two asterisks (**), 10 percent or more]

Table with columns: Blocks within census tracts, Total population, All housing units by condition and plumbing (Sound, Deteriorating, Dilapidated), Occupied housing units (Owner occupied, Renter occupied), Occupied by non-white, 1.01 or more persons per room. Rows include block identifiers like 90... and LR-7... with corresponding population and unit statistics.

City Block Characteristics

Table 2.—CHARACTERISTICS OF HOUSING UNITS, BY BLOCKS: 1960—Con.
["Total population" contains no persons in group quarters unless preceded by asterisk: one asterisk (*) denotes less than 10 percent; two asterisks (**), 10 percent or more]

Table with 18 columns: Blocks within census tracts, Total population, All housing units by condition and plumbing (Total, Sound, Deteriorating, Dilapidated), Occupied housing units (Owner occupied, Renter occupied), Occupied by non-white, and 1.01 or more persons per room. Rows include blocks 71-75, LR-11, 13-22, 23-32, 33-42, 43, LR-12, 11-20, 21-30, 31-40.

Table 2.—CHARACTERISTICS OF HOUSING UNITS, BY BLOCKS: 1960—Con.

["Total population" contains no persons in group quarters unless preceded by asterisk: one asterisk (*) denotes less than 10 percent; two asterisks (**), 10 percent or more]

Blocks within census tracts	Total population	All housing units by condition and plumbing								Occupied housing units							
		Sound				Deteriorating				Owner occupied			Renter occupied			Occupied by non-white	1.01 or more persons per room
		Total	With all plumbing facilities	Lacking some or all facilities	Total	With all plumbing facilities	Lacking some or all facilities		Dilapidated	Total	Average value (dollars)	Average number of rooms	Total	Average contract rent (dollars)	Average number of rooms		
							With flush toilet	No flush toilet									
41...	133	40	39	39	1	36	13000	5.9	4	2
42...	24	9	9	9	9	14000	5.2
43...	81	27	27	27	19	12500	5.1	8	61	3.8	...	3
44...	70	20	20	20	18	13500	4.6	2	2
45...	48	13	13	12	1	12	12000	4.9	1
46...	65	19	19	19	18	14000	4.7	1	2
47...	38	13	13	13	12	13500	4.5	1	1
LR-13...	*4681	1141	1138	1138	...	2	2	966	13000	4.9	154	83	4.3	1	215
1...	122	29	29	29	25	13000	5.2	4	4
2...	167	45	45	45	44	15000	4.6	1	5
3...	201	49	49	49	49	13500	4.7	12
4...	176	46	45	45	...	1	1	13	...	4.0	33	82	4.0	...	14
5...	110	26	26	26	6	...	4.0	19	76	4.0	...	9
6...	29	9	9	9	8	12500	4.5	1	1
7...	**47	17	17	17	10	15000	5.7	1	1
8...	14	9	9	9	3	1
9...	55	13	13	13	13	12500	4.9	2
10...	117	28	26	26	...	1	1	20	13500	5.7	7	66	4.4	...	5
11...	85	24	24	24	22	12000	4.4	2	4
12...	156	40	40	40	24	12500	4.3	15	86	4.1	...	10
13...	188	44	44	44	20	12500	4.4	24	81	4.0	...	16
14...	38	7	7	7	1	6	96	4.3	...	4
15...	56	17	17	17	12	14000	4.8	5	98	4.0	...	2
16...	138	37	37	37	32	13000	4.8	5	79	4.0	...	6
17...	166	36	36	36	35	13000	4.9	1	8
18...	26	7	7	7	7	13500	4.9
19...	25	7	7	7	6	13000	5.0	1	1
20...	80	18	18	18	18	12000	5.1	6
21...	49	11	11	11	10	12500	5.3	1	3
22...	81	19	19	19	17	12000	5.4	2	5
23...	103	30	30	30	28	13500	4.8	2	2
24...	177	39	39	39	37	13000	5.2	4
25...	69	16	16	16	15	13000	5.1	1	4
26...	99	21	21	21	21	13000	5.3	4
27...	716	174	174	174	164	13000	5.0	8	85	5.0	...	21
28...	67	14	14	14	13	12500	5.0	1	3
29...	130	28	28	28	25	12000	5.0	3	6
30...	145	32	32	32	31	12500	5.0	1	6
31...	126	32	32	32	30	13000	5.0	1	5
32...	154	34	34	34	32	13500	5.0	1	9
33...	143	33	33	33	31	14500	5.0	1	9
34...	147	34	34	34	33	12500	5.0	1	6
35...	107	24	24	24	23	13000	5.0	1	5
36...	99	24	24	24	22	13000	5.0	2	1	3
37...	121	26	26	26	25	13500	5.0	1	3
38...	90	25	25	25	24	13500	5.0	4
39...	62	17	17	17	17	14000	5.0	2

U.S. CENSUS OF HOUSING: 1960

Series HC(3)-318

CITY BLOCKS

Springfield, Ohio

Prepared under the supervision of
WAYNE F. DAUGHERTY, Chief
Housing Division



U.S. DEPARTMENT OF COMMERCE

Luther H. Hodges, Secretary

BUREAU OF THE CENSUS

Richard M. Scammon, Director (From May 1, 1961)

Robert W. Burgess, Director (To March 3, 1961)





BUREAU OF THE CENSUS

RICHARD M. SCAMMON, *Director* (From May 1, 1961)

ROBERT W. BURGESS, *Director* (To March 3, 1961)

A. ROSS ECKLER, *Deputy Director*
HOWARD C. GRIEVES, *Assistant Director*
CONRAD TAEUBER, *Assistant Director*
MORRIS H. HANSEN, *Assistant Director for Statistical Standards*
CHARLES B. LAWRENCE, JR., *Assistant Director for Operations*
WALTER L. KEHRES, *Assistant Director for Administration*
CALVERT L. DEDRICK, *Chief, International Statistical Programs Office*
A. W. VON STRUVE, *Acting Public Information Officer*

Housing Division—

WAYNE F. DAUGHERTY, *Chief*
DANIEL B. RATHBUN, *Assistant Chief*
BEULAH WASHBAUGH, *Special Assistant*
MILTON D. LIEBERMAN, *Chief, Coordination and Research*

Decennial Operations Division—GLEN S. TAYLOR, *Chief*
Electronic Systems Division—ROBERT F. DRURY, *Chief*
Field Division—JEFFERSON D. MCPHIE, *Chief*
Geography Division—WILLIAM T. FAY, *Chief*
Population Division—HOWARD G. BRUNSMAN, *Chief*
Statistical Methods Division—JOSEPH STEINBERG, *Chief*

Library of Congress Card Number: A61-9347

SUGGESTED CITATION

U.S. Bureau of the Census. *U.S. Census of Housing: 1960. Vol. III, City Blocks.*
Series HC(3), No. 318.
U.S. Government Printing Office, Washington, D.C., 1961.

For sale by the Superintendent of Documents, U.S. Government Printing Office, Washington 25, D.C.
or any of the Field Offices of the Department of Commerce — Price 25 cents.

Table 1.—CHARACTERISTICS OF HOUSING UNITS, FOR THE CITY: 1960

Subject	Number	Percent	Subject	Number	Percent
All housing units	26,717	100.0	Occupied housing units—Con.		
CONDITION AND PLUMBING			COLOR		
Sound	21,226	79.4	White	22,231	87.3
With all plumbing facilities	20,071	75.1	Nonwhite	3,233	12.7
Lacking some or all facilities	1,155	4.3	PERSONS PER ROOM		
Deteriorating	4,529	17.0	1.00 or less	23,121	90.8
With all plumbing facilities	3,217	12.0	1.01 or more	2,343	9.2
Lacking some or all facilities	1,312	4.9	AVERAGE NUMBER OF ROOMS		
With flush toilet	1,085	4.1	Owner occupied	5.6	...
No flush toilet	227	0.8	Renter occupied	4.4	...
Dilapidated	962	3.6	VALUE AND RENT		
Occupied housing units	25,464	100.0	Average value	11,900	...
TENURE			Average contract rent	54	...
Owner occupied	14,400	56.6			
Renter occupied	11,064	43.4			

/ NOTE.—On the map for Springfield approximately 1,020 blocks are identified.

Table 2.—CHARACTERISTICS OF HOUSING UNITS, BY BLOCKS: 1960

["Total population" contains no persons in group quarters unless preceded by asterisk: one asterisk (*) denotes less than 10 percent; two asterisks (**), 10 percent or more]

Blocks within census tracts	Total population	All housing units by condition and plumbing								Occupied housing units								
		Total	Sound			Deteriorating			Dilapidated	Owner occupied			Renter occupied			Occupied by non-white	1.01 or more persons per room	
			Total	With all plumbing facilities	Lacking some or all facilities	Total	With all plumbing facilities	Lacking some or all facilities		With flush toilet	No flush toilet	Total	Average value (dollars)	Average number of rooms	Total			Average contract rent (dollars)
1.....	*3108	1079	496	341	155	538	256	261	21	45	141	8000	6.0	834	42	3.5	168	171
1....	68	18	18	18	12	10000	6.7	6	60	5.0	...	3
2....	*118	27	24	22	2	3	1	2	6	7000	5.8	19	39	5.4	...	8
4....	9	4
5....	*148	36	9	6	3	24	6	17	1	3	1	32	33	4.1	26	11
6....	16	3
9....	19	15	6	6	...	9	9	1	10	47	3.1
10....	12	10	1	...	1	9	...	9	10	37	1.7
11....	22	12	12	5	7	9	42	3.1	...	1
12....	59	25	25	21	4	4	18	44	4.7	...	1
15....	**103	2
16....	*24	3
17....	148	46	37	14	23	8	2	6	...	1	4	36	34	4.0	27	12
18....	21	6	1	1	...	5	3	1	1	...	4	2	1
20....	113	29	29	29	17	9000	6.8	11	57	5.4	...	4
21....	128	42	29	27	2	13	9	...	4	...	12	8000	5.6	28	41	4.4	1	7
22....	26	12	4	1	2	1	2	3	4000	5.4	5	...	4.2	1	1
23....	27	6	2	2	...	2	1	...	1	2	3	2	2
24....	29	10	3	1	2	2	1	1	...	5	9	38	4.4	1	2
25....	17	4
26....	32	11	3	3	...	7	3	4	...	1	3	6	32	4.3	1	1
27....	4	3
28....	89	36	33	10	23	3	1	2	2	28	30	2.8	...	6
29....	46	17	5	3	2	9	3	6	...	3	12	34	4.3	5	2
30....	163	52	27	15	12	25	10	12	3	...	5	...	4.8	41	34	4.1	15	16
31....	**9	1
32....	6	5	5	3	2	5	...	2.4
33....	4	1
34....	8	5	5	5	3	1
35....	82	41	41	17	24	2	34	40	3.0	...	5
36....	20	9	9	5	4	1	8	42	4.1
38....	**46	18	1	1	...	17	7	10	14	46	3.4	1	2
39....	*25	11	2	2	...	9	4	5	10	40	4.7
40....	48	30	16	16	...	14	4	10	24	37	3.8	...	1
41....	**50	14	5	5	...	9	2	7	12	84	2.0
42....	**114	41	33	17	16	8	1	7	34	42	2.9	15	5
43....	105	36	31	15	16	5	...	4	1	...	1	31	43	3.6	2	9
44....	*110	28	24	17	7	2	2	2	11	9500	5.9	14	46	3.9	11	8
45....	72	14	3	1	2	7	5	2	...	4	14	42	4.6	1	7
46....	80	28	6	6	...	16	11	5	...	6	6	4500	5.5	18	42	4.2	3	4
47....	73	19	16	7	9	3	...	3	3	15	47	4.0	...	7
48....	60	24	24	19	5	5	...	4.8	18	55	3.6	4	2
49....	22	7	7	7	3	4
50....	27	6	4	2	2	1	1	4	6	2
51....	144	31	21	10	11	5	2	...	3	5	8	6500	6.9	22	33	4.8	29	9
52....	33	16	16	13	3	1	12	53	3.1	...	4
53....	**54	11	9	9	...	2	2	11	42	4.5	2	...
55....	*23	2
56....	96	89	9	8	1	80	29	51	81	50	1.3	1	3
58....	**26	16	16	1	15	16	48	1.3
59....	5	3
60....	50	38	20	18	2	18	11	7	1	32	45	3.6	2	...

Table 2.—CHARACTERISTICS OF HOUSING UNITS, BY BLOCKS: 1960—Con.

["Total population" contains no persons in group quarters unless preceded by asterisk; one asterisk (*) denotes less than 10 percent; two asterisks (**), 10 percent or more]

Table with columns: Blocks within census tracts, Total population, All housing units by condition and plumbing (Sound, Deteriorating, Dilapidated), Occupied housing units (Owner occupied, Renter occupied), Occu-pied by non-white, 1.01 or more persons per room.

Table 2.—CHARACTERISTICS OF HOUSING UNITS, BY BLOCKS: 1960—Con.

["Total population" contains no persons in group quarters unless preceded by asterisk; one asterisk (*) denotes less than 10 percent; two asterisks (**), 10 percent or more]

Table with 18 columns: Blocks within census tracts, Total population, All housing units by condition and plumbing (Sound, Deteriorating, Dilapidated), Occupied housing units (Owner occupied, Renter occupied), Occupied by non-white, 1.01 or more persons per room.

Table 2.—CHARACTERISTICS OF HOUSING UNITS, BY BLOCKS: 1960—Con.

["Total population" contains no persons in group quarters unless preceded by asterisk (*) one asterisk (*) denotes less than 10 percent; two asterisks (**), 10 percent or more]

Table with columns for housing units by condition and plumbing (Sound, Deteriorating, Dilapidated) and occupied housing units (Owner occupied, Renter occupied). Rows list blocks within census tracts and their characteristics.

Table 2.—CHARACTERISTICS OF HOUSING UNITS, BY BLOCKS: 1960—Con.

["Total population" contains no persons in group quarters unless preceded by asterisk; one asterisk (*) denotes less than 10 percent; two asterisks (**), 10 percent or more]

Blocks within census tracts	Total population	All housing units by condition and plumbing									Occupied housing units							
		Total	Sound			Deteriorating			Dilapidated	Owner occupied			Renter occupied			Occupied by non-white	1.01 or more persons per room	
			Total	With all plumbing facilities	Lacking some or all facilities	Total	With all plumbing facilities	Lacking some or all facilities		Total	Average value (dollars)	Average number of rooms	Total	Average contract rent (dollars)	Average number of rooms			
								With flush toilet										No flush toilet
2...	41	9	9	9	7	19500	5.6	2	2	
3...	45	12	12	12	12	19000	5.3	1	
4...	86	21	21	21	19	17000	5.4	2	3	
5...	143	38	38	38	36	18500	5.7	2	1	
6...	49	12	12	12	12	18000	5.5	
7...	165	47	47	47	45	17500	5.4	2	2	
8...	67	17	17	17	17	17500	5.4	2	
9...	62	19	19	19	18	17500	5.3	1	
10...	153	39	39	38	1	35	18000	5.6	2	4	
11...	109	26	26	26	25	17500	5.8	1	2	
12...	61	20	19	18	1	1	1	17	17000	5.5	2	1	
13...	66	23	23	23	22	19000	5.3	
14...	130	36	36	36	36	18000	5.5	1	
15...	49	12	12	12	11	15000	5.5	1	2	
16...	106	27	27	27	24	16000	5.3	2	6	
17...	41	13	13	13	11	21000	5.9	2	
18...	66	18	18	18	17	20000	5.8	1	
19...	281	81	80	79	1	1	73	19000	5.6	5	111	5.0	...	2	
20...	90	37	37	37	34	20000	5.7	2	
21...	43	11	11	11	10	16000	5.0	1	3	