



1970 CENSUS OF POPULATION

U S DEPARTMENT OF COMMERCE • Social and Economic Statistics Administration • BUREAU OF THE CENSUS

PC(S1)-85

Issued May 1974

SUPPLEMENTARY REPORT

Low-Income Neighborhoods in Large Cities: 1970

Miami, Fla.

This report is one of 39 within the PC(S1) series of 1970 census reports that summarize information on the population and housing characteristics of low-income neighborhoods in the Nation's 50 largest cities.¹ Low-income neighborhoods are subdivisions of low-income areas, which for this report include all census tracts in which 20 percent or more of all persons were below the poverty level in 1969. (See "Definitions.") These low-income neighborhoods generally consist of contiguous census tracts with a combined population of 20,000 or more. The neighborhood boundaries are based on current socioeconomic data and the recommendations of local agencies.

Information is presented here on each of the low-income neighborhoods within the city. The statistics shown in the detailed tables are part of a special tabulation of 1970 census data prepared for the Office of Economic Opportunity to determine the location of low-income areas and their neighborhood subdivisions, to analyze the characteristics of the residents of these neighborhoods, and to compare the residential characteristics of a low-income neighborhood to those of other low-income neighborhoods and those of areas outside such neighborhoods. For further information on this special tabulation, see "Related Materials." Financial support for the preparation of this set of 39 reports was provided by the Office of Assistant Secretary for Planning and Evaluation, Department of Health, Education, and Welfare. Similar data for the entire city, the entire low-income area (without neighborhood subdivisions), and the balance of the city outside the low-income area are published in **1970 Census of Population, Volume II, Subject Reports, Series PC(2)-9B, "Low-Income Areas in Large Cities."**

¹ Except Honolulu, for which no low-income neighborhoods were defined. See list of 39 reports on page ii.

This report was prepared by Donald G. Fowles, Poverty Statistics Program, Population Division.

For sale by the Superintendent of Documents, U.S. Government Printing Office, Washington, D.C. 20402, and U.S. Department of Commerce District Offices. Price 65 cents

OFFICE OF ECONOMIC OPPORTUNITY, U.S. DEPARTMENT OF COMMERCE

PC(S1) REPORTS ON LOW-INCOME NEIGHBORHOODS IN LARGE CITIES

Report number	Cities	Report number	Cities
65	Atlanta, Ga.	85	Miami, Fla.
66	Baltimore, Md.	86	Milwaukee, Wis.
67	Birmingham, Ala.	87	Minneapolis and St. Paul, Minn.
68	Boston, Mass.	88	Newark, N.J.
69	Buffalo and Rochester, N.Y.	89	New Orleans, La.
70	Chicago, Ill.	90	New York, N.Y.
71	Cincinnati, Ohio	91	Norfolk, Va.
72	Cleveland and Toledo, Ohio	92	Oklahoma City and Tulsa, Okla.
73	Columbus, Ohio	93	Omaha, Nebr.
74	Dallas and Fort Worth, Tex.	94	Philadelphia, Pa.
75	Denver, Colo.	95	Phoenix, Ariz.
76	Detroit, Mich.	96	Pittsburgh, Pa.
77	El Paso, Tex.	97	Portland, Oreg.
78	Houston, Tex.	98	St. Louis, Mo.
79	Indianapolis, Ind.	99	San Antonio, Tex.
80	Jacksonville and Tampa, Fla.	100	San Diego and San Jose, Calif.
81	Kansas City, Mo.	101	San Francisco and Oakland, Calif.
82	Los Angeles and Long Beach, Calif.	102	Seattle, Wash.
83	Louisville, Ky.	103	Washington, D.C.
84	Memphis and Nashville-Davidson, Tenn.		

About 148,000 persons resided in the low-income area of Miami, Fla., in 1970 (table A). These low-income area residents constituted 45 percent of the city's population. In the balance of the metropolitan area outside Miami, only 16 percent of the population resided in such areas.

The low-income area of Miami was subdivided into four neighborhoods which varied in size and racial composition. The population of the neighborhoods ranged from 27,000 to 46,000, and the proportion of the population which was Negro ranged from 1 percent to 71 percent. In the low-income area as a whole, Negroes constituted 43 percent of the population, as compared with 6 percent in the balance of the city.

The low-income area also contained 57,000 persons of Spanish language. This ethnic group constituted 38 percent of the low-income area population, as compared with 52 percent in the balance of the city. Neighborhood 4 had the highest proportion of Spanish persons (83 percent) and neighborhood 1 had the lowest proportion (14 percent).

There were 67,000 persons in Miami who were below the poverty level in 1969. Of these, 63 percent lived in the low-income area. About 34 percent of the residents of the low-income area were below the poverty level, as compared with only 18 percent of those living elsewhere in the city. Within the low-income area, this proportion ranged from 25 percent in neighborhood 4 to 31 percent in neighborhood 3.

Although a high proportion of the poor resided in the low-income area, Negroes and white persons of Spanish language who were below the poverty level were more likely to live in this area than whites (other than Spanish) who were poor. About 91 percent of the city's blacks and 47 percent of white persons of Spanish language who were below the poverty level lived in the low-income area, as compared with 30 percent for non-Spanish whites who were poor in 1969.

The population of the low-income area, as well as the balance of the city, contained the whole range of social, economic, and housing characteristics. However, there were generally sharp contrasts between the

proportional distribution of the characteristics of the low-income area population and the population living outside this area. In addition, there was some variation in the characteristics of the individual neighborhoods within the low-income area.

Families within the low-income area were more likely to be headed by females than families outside this area. Such families constituted 22 percent of all low-income area families, as compared with only 13 percent of families living elsewhere in the city (table B). Low-income area families headed by women were also more likely to have children in the home and, moreover, tended to have a larger number of children than families living outside the low-income area. Thus, a considerably higher proportion of children living in the low-income area (37 percent) were in families in which both parents were not present than were children living outside this area (20 percent). This proportion was as high as 41 percent in neighborhood 1.

The generally lower socioeconomic status of the low-income area population was reflected by such characteristics as education, employment, and occupation. For example, about 66 percent of persons 25 years old and over who resided in the low-income area had not completed their high school education, as compared with 50 percent outside this area.

Low-income area families were less likely to contain earners than those living outside this area,

even when families headed by an aged person were excluded. Furthermore, working heads of families were less likely to have worked year round if they lived in the low-income area. Unemployment rates were generally higher in this area than elsewhere, and those persons who were employed were more concentrated in the lower-paying occupations. Only 24 percent of employed males who lived in the low-income area were employed in white-collar occupations, as compared with 44 percent for males living outside this area. This proportion was as low as 20 percent in neighborhood 1. The same relationship was observed for females, although they were more likely to be employed in white-collar occupations (primarily as clerical and sales workers) than males.

The low-income neighborhoods of Miami were clustered around the central business district and therefore contained a disproportionate share of older housing units. The majority of the housing units in the low-income area were occupied by renters, and a higher proportion contained more than one person per room than units outside this area. Low-income area housing tended to be less expensive in terms of average rent but similar in terms of the proportion of a family's income required to cover this expense. About 54 percent of the low-income area households paid more than one-fourth of their income for rent, as compared with 50 percent for households outside this area.

Table A. Poverty Status in 1969 of Persons By Residence in Low-Income Neighborhoods, Race, and Spanish Language, for the Miami, Fla. SMSA: 1970

(See accompanying maps and tract listings for location of low-income neighborhoods)

Area	All income levels					Below poverty level			Percent below poverty level		
	Total	Negro	Spanish language	Percent of total		Total	Negro	Spanish language	Total	Negro	Spanish language
				Negro	Spanish language						
SMSA, total.....	1,248,832	186,279	298,114	14.9	23.9	176,461	58,715	44,913	14.1	31.5	15.1
In low-income area.....	292,623	141,288	67,111	48.3	22.9	87,019	50,282	17,528	29.7	35.6	26.1
Percent in low-income area.....	23.4	75.8	22.5	(X)	(X)	49.3	85.8	39.0	(X)	(X)	(X)
Miami.....	331,703	75,139	151,513	22.7	45.7	67,497	23,730	28,285	20.3	31.6	18.7
In low-income area ¹	148,150	63,664	56,606	43.0	38.2	42,482	21,673	14,561	28.7	34.0	25.7
Percent in low-income area.....	44.7	84.7	37.4	(X)	(X)	62.9	91.3	51.5	(X)	(X)	(X)
Neighborhood 1.....	45,686	32,571	6,583	71.3	14.4	13,444	10,478	1,567	29.4	32.2	23.9
Neighborhood 2.....	27,157	9,984	12,664	36.8	46.6	7,985	3,828	3,234	29.4	38.3	25.5
Neighborhood 3.....	34,585	13,619	11,784	39.4	34.1	10,798	4,941	3,513	31.2	36.3	29.8
Neighborhood 4.....	30,379	189	25,226	0.6	83.0	7,503	68	6,247	24.7	34.9	24.8
Not in low-income area.....	183,553	11,475	94,907	6.3	51.7	25,035	2,057	13,724	13.6	17.9	14.5
Balance of SMSA.....	917,129	111,140	146,601	12.1	16.0	108,964	34,985	16,628	11.9	31.5	11.3
In low-income area.....	144,473	77,624	10,505	53.7	7.3	44,557	28,609	2,967	30.8	36.9	28.2
Percent in low-income area.....	15.8	69.8	7.2	(X)	(X)	40.9	81.8	17.8	(X)	(X)	(X)

(X) Not applicable.

¹Includes several census tracts not included in the neighborhoods.

Table B. Summary of Social, Economic, and Housing Characteristics of the Population By Residence in Low-Income Neighborhoods, for Miami, Fla.: 1970

(See accompanying maps and tract listings for location of low-income neighborhoods)

Area	Families				Persons				Housing units						
	With female head				Percent with no earners ¹	Employed, 16 years old and over—percent in white collar occupations		Males in civilian labor force, 16 to 64 years old—percent unemployed	25 years old and over—percent not high school graduate	Related children under 18 years old—percent not living with both parents	Percent vacant	Occupied—percent			
	Percent of all families	With related children under 18 years old		Head worked in 1969—percent worked 50 to 52 weeks		Male	Female					Renter—occupied	Structure built 1939 or earlier	With 1.01 or more persons per room	Gross rent one-fourth or more of income ²
		Percent	Mean number of children												
Miami, total.....	16.8	58.9	2.09	62.8	4.8	35.6	47.6	56.7	28.2	3.9	64.1	30.3	20.8	52.1	
In low-income area.....	21.7	67.5	2.33	57.6	6.2	23.8	35.7	66.2	36.7	4.6	79.7	38.1	26.3	54.0	
Neighborhood 1.....	27.4	75.0	2.47	58.9	6.9	20.1	35.7	67.5	40.7	3.8	64.7	24.6	23.5	51.1	
Neighborhood 2.....	19.4	72.2	2.48	57.5	6.1	21.6	27.4	72.2	33.5	4.9	77.1	35.1	32.4	49.9	
Neighborhood 3.....	20.8	64.4	2.32	56.2	6.4	26.3	39.4	62.0	39.6	6.9	92.9	50.7	22.4	57.8	
Neighborhood 4.....	15.3	46.0	1.48	57.3	5.6	24.4	34.0	67.1	22.8	2.0	85.7	45.6	33.6	53.5	
Not in low income area.....	13.3	48.7	1.70	66.5	3.7	44.3	56.8	49.8	19.5	3.3	51.5	24.0	16.5	49.8	

¹Excludes families with head 65 years old and over.

²Excludes one-family homes on 10 acres or more, all "no cash rent" units, and units for which the income of the family or primary individual was reported as "none" or "loss."

RELATED MATERIALS

1970 Census

There are three primary sources of 1970 census data on the characteristics of the population residing in low-income areas as defined in this report. The first source is the volume II report, PC(2)-9B, "Low-Income Areas in Large Cities," which presents data for low-income areas (without neighborhood subdivisions) in the Nation's 50 largest cities. The second source, consisting of this report and the other PC(S1) reports listed on page 2, presents data for neighborhood subdivisions of low-income areas in the same 50 cities. The third source, from which the data for these PC(S1) reports were extracted, consists of a special tabulation of 1970 census data prepared for the Office of Economic Opportunity (OEO). This tabulation covers each of the 97 standard metropolitan statistical areas (SMSA's) in which one or more of the central cities had at least one group of contiguous low-income area tracts with a population of 20,000 or more. For each of these 97 SMSA's, the OEO tabulation shows data for the entire SMSA, each component county, and each central city, including the neighborhood subdivisions of the central city low-income area.

In each of the three sources, comparable data are shown for all races, white, Negro, and persons of Spanish language. For SMSA's in California, data also are shown for the Japanese, Chinese, American Indian, and Filipino populations.

Copies of the entire OEO tabulation for each of the 97 SMSA's, including maps and census tract listings which identify the low-income areas and their neighborhood subdivisions, were sent to the appropriate Federal Regional Councils, State Economic Opportunity Offices, and local community action agencies. Copies of these materials can also be obtained by writing to the Chief, Industrial and Social Records Branch, National Archives, Washington, D.C. 20408. Requests for further information about this tabulation, as well as limited requests for copies, should be made in writing to the Chief, Population Division, Bureau of the Census, Washington, D.C. 20233.

Selected summary data for the 50 cities individually and seven tables of detailed data for the 50 cities combined were extracted from the PC(2)-9B report and published separately in **1970 Census of Population, Supplementary Report, Series PC(S1)-56, "Selected Characteristics of the Population in Low-Income Areas of Large Cities."**

Maps of these 50 cities showing the location of census tracts in low-income areas by poverty rate (but without neighborhood subdivisions) are available at cost of reproduction. Requests for these maps, specifying the cities desired, should be made in writing to the Chief, Population Division, Bureau of the Census, Washington, D.C. 20233.

Data for low-income areas as defined for the Census Employment Survey (CES) are available for 60 urban and 7 rural areas in **1970 Census of Population and Housing, Employment Profiles of Selected Low-Income Areas, Series PHC(3)**. The definition of low-income areas used for the CES differs from the definition used for this report. (See "Definitions.") Most of the data in the PHC(3) reports consist of detailed information not available from the 1970 census questionnaire on such subjects as employment, unemployment, training for work, job-seeking methods, job tenure, sources and level of income, residential mobility, transportation to work, and selected factors considered deterrents to employment.

Poverty statistics based on the 20-percent sample for the United States, regions, divisions, States, SMSA's, places with a population of 2,500 or more, and counties were published in chapter C of **1970 Census of Population, Volume I, Characteristics of the Population**. More detailed poverty data cross-classified by such variables as education, employment status, occupation, and income were published in chapter D of the volume I report for the United States, regions, States, SMSA's with a population of 250,000 or more, and central cities of these SMSA's. The statistics shown in each of the State parts of the volume I report are summarized for the United States in Volume I, Part 1, "United States Summary." Chapters C and D were originally published as separate paperbound reports in series PC(1)-C, "General Social and Economic Characteristics," and PC(1)-D, "Detailed Characteristics."

Poverty statistics also are shown for census tracts of 241 SMSA's and selected adjacent areas in **1970 Census of Population and Housing, Census Tracts, Series PHC(1)**. A description of poverty data contained in volume I and census tract reports can be found in Data Access Description No. 29, "Low-Income Data from the 1970 Census."

1960 Census

Statistics for low-income areas as defined by the use of 1960 census data are available for metropolitan

areas and their central cities in **1960 Census of Population, Supplementary Reports, Series PC(S1)-54, "Poverty Areas in the 100 Largest Metropolitan Areas."** The definition of low-income areas based on 1960 census data differs from the definition used in this report. (See "Definitions.") The PC(S1)-54 report contains information on persons and families by age, race, family status, poverty status in 1959, and sex and age of family head. Census tract maps showing the delineation of these low-income areas were published by the Office of Economic Opportunity in a report entitled **Maps of Major Concentrations of Poverty in SMSA's of 250,000 or More Population.**

Special Censuses

Two reports based on special censuses conducted by the Bureau of the Census during the 1960's provide survey data and comparable 1960 census data for what are essentially neighborhood subdivisions of the 1960 census low-income areas. **Current Population Reports, Series P-23, No. 18, "Characteristics of the South and East Los Angeles Areas: November 1965,"** presents social, economic, and housing data for seven neighborhoods in South Los Angeles and three neighborhoods in East Los Angeles. **Current Population Reports, Series P-23, No. 21, "Characteristics of Selected Neighborhoods in Cleveland, Ohio: April 1965,"** presents population characteristics for nine neighborhoods in Cleveland and for the balance of the city, with totals for the city as a whole.

Current Population Survey

Data on the population are collected and published regularly by the Bureau of the Census through its Current Population Survey (CPS), a nationwide survey covering a sample of about 47,000 households. Statistics from the March 1973 CPS for low-income areas based on the 1970 census definition are published in **Current Population Reports, Series P-60, No. 91, "Characteristics of the Low-Income Population: 1972."**

DEFINITIONS

Low-Income Areas

1970 census definition.—For this report, a low-income area consists of all census tracts in which 20

percent or more of all persons were below the poverty level in 1969. This method of defining low-income areas, which differs from other methods used in the past, was developed to provide a statistical index based on income only and to utilize the small-area data on poverty status which were available in 1970 for the first time in a decennial census.

To arrive at this definition, research was conducted by the Bureau's staff that would delineate for a given year low-income areas similar in size and location to those delineated by the 1960 census definition, which was based on an unweighted combination of five poverty-related socioeconomic characteristics. The researchers utilized a special tabulation of 1960 census data for census tracts in a sample of large metropolitan areas. Low-income areas defined by the 1960 census definition were chosen from this sample and were compared to low-income areas defined by aggregating all census tracts with poverty rates above selected cutoff values. This comparison showed that areas consisting of census tracts with poverty rates of 20 percent or more most closely approximated low-income areas defined by the 1960 method.

Although the majority of low-income areas selected by this definition are adjacent to each other, some represent scattered or isolated pockets of poverty. Tracts which contain fewer than 100 persons or which consist entirely of crews of vessels are excluded from low-income areas.

Previous definitions.—The 1960 definition of low-income areas was developed by the Bureau of the Census as part of its work for the Office of Economic Opportunity to identify areas of major concentrations of poverty within large metropolitan areas. This definition consisted of ranking census tracts in metropolitan areas with a 1960 population of 250,000 or more according to the relative presence of each of the following equally weighted poverty-linked characteristics: (1) Families with money incomes below \$3,000; (2) children under 18 years old not living with both parents; (3) persons 25 years and over with less than 8 years of school completed; (4) unskilled males (laborers and service workers) in the civilian labor force; and (5) housing units dilapidated or lacking some or all plumbing facilities. Those tracts falling in the lowest quartile of the ranking were defined as poor tracts and further adjusted for contiguity and minimum size in order to approximate neighborhood concentrations of poverty. For a detailed explanation of this definition, see **Current Population Reports, Series P-23, No. 19, "Characteristics of Families Residing in 'Poverty Areas': March 1966."**

These 1960 low-income areas were revised in 1969 to provide more up-to-date delineations of low-income areas in selected large cities. The revised areas were used as survey areas for the Census Employment Survey. This survey, in which detailed socioeconomic information on employment-related problems was collected in each of 60 urban and 7 rural areas, was conducted as part of the overall program of the 1970 census. Because of the timing of this project, 1970 census data could not be used to select the survey areas. Instead, changes were made to the 1960 low-income areas based on more recent information acquired from a wide variety of sources and corroborated by knowledgeable local experts. For further information on these CES areas, see 1970 Census of Population and Housing, Employment Profiles of Selected Low-Income Areas, Series PHC(3).

ment of 20,000. A few exceptions to this minimum size requirement were made where it was deemed appropriate. It should be noted that detailed sample data become less reliable as the size of the neighborhood decreases.

In some cases, isolated tracts or groups of tracts could not be classified as a neighborhood and were included in a category called "remainder of low-income area." Data were tabulated for these "remainders" if they contained a population of 20,000 or more. Inspection of maps and tract listings is necessary to determine the usefulness of the data for these "remainders."

Poverty Status in 1969

Families and unrelated individuals are classified as being above or below the poverty level using the poverty index adopted by a Federal Interagency Committee in 1969. This index provides a range of income cutoffs or "poverty thresholds" adjusted to take into account such factors as family size, sex and age of family head, number of children, and farm-nonfarm residence. The poverty cutoffs for farm families have been set at 85 percent of the nonfarm levels. These income cutoffs are updated every year to reflect the changes in the Consumer Price Index. The average poverty threshold for a nonfarm family of four was \$3,748 in 1969. (See table C.)

Low-Income Neighborhoods

To provide a more detailed geographic breakdown of large central city low-income areas, these areas were further subdivided into "neighborhoods," which consisted of contiguous census tracts with a combined population of 20,000 or more. The neighborhood boundaries were based on currently available socioeconomic data and on recommendations from representatives of local groups such as community action, model cities, city planning, and welfare agencies. In some cases, it was necessary to combine neighborhoods to meet the minimum size require-

Table C. Weighted Average Thresholds at the Low-Income Level in 1969 By Size of Family Unit, Farm-Nonfarm Residence, and Sex of Head

(Figures in dollars. Based on 5-percent sample)

Size of family unit	Total	Nonfarm			Farm		
		Total	Male head	Female head	Total	Male head	Female head
All unrelated individuals....	1,844	1,849	1,931	1,795	1,570	1,615	1,517
Under 65 years.....	1,897	1,901	1,980	1,830	1,631	1,680	1,550
65 years and over.....	1,749	1,755	1,770	1,750	1,499	1,510	1,490
All families.....	3,380	3,400	3,435	3,124	2,929	2,944	2,610
2 persons.....	2,372	2,388	2,398	2,328	2,017	2,021	1,938
Head under 65 years.....	2,446	2,461	2,474	2,378	2,098	2,102	1,999
Head 65 years and over...	2,200	2,219	2,221	2,204	1,880	1,881	1,871
3 persons.....	2,909	2,927	2,942	2,823	2,478	2,484	2,363
4 persons.....	3,727	3,748	3,750	3,727	3,192	3,193	3,166
5 persons.....	4,385	4,413	4,416	4,372	3,757	3,757	3,747
6 persons.....	4,924	4,958	4,960	4,935	4,224	4,224	4,231
7 or more persons.....	6,058	6,111	6,123	6,009	5,196	5,197	5,152

Source: 1970 Census of Population, Volume II, Subject Reports, Series PC(2)-9A, "Low-Income Population."

The low-income concept has been developed as a tool for measuring the overall economic well-being of the population at the lower end of the income scale. It is an attempt to identify in dollar terms a minimum level of income adequacy for families of different types in keeping with American consumption patterns. Based on an analysis of the percent of income devoted to food expenditures, an estimate was developed which specifies the minimum cost at which an American family, making average choices, can be provided with a diet meeting recommended nutritional goals. Consequently, it is an overall statistical yardstick which reflects the different consumption requirements of families of different size, taking into account family composition (number of adults and number of children) and farm-nonfarm residence. Insofar as individual circumstances or consumption patterns differ, the dollar value of the low-income threshold for a given family size may not represent the money income required by an individual family to maintain a level of economic well-being equivalent to other families with similar incomes. For a detailed explanation of the low-income concept, see appendix B in the volume I reports.

Income in 1969

Income data collected in the census are limited to money income received before payments for personal income taxes and deductions for Social Security, union dues, Medicare, etc. Money income is the sum of the amounts received from earnings; Social Security and public assistance payments; dividends, interest, and rent; unemployment and workmen's compensation; government and private employee pensions; and other periodic income. (Certain money receipts such as capital gains are not included.) Therefore, money income does not reflect the fact that many families receive part of their income in the form of nonmoney transfers such as food stamps, health benefits, and subsidized housing; that many farm families receive nonmoney income in the form of rent-free housing and goods produced and consumed on the farm; or that nonmoney incomes also are received by some nonfarm residents which often take the form of the use of business transportation and facilities, full or partial payments by business for retirement programs, medical and educational expenses, etc. These elements should be considered when comparing income levels.

Since the reporting of income frequently is based on memory rather than on records, there is a tendency to underreport or fail to report some elements of income. Underreporting is especially pronounced for income sources that are not derived

from earnings, such as Social Security and public assistance payments, interest and dividends, etc. For example, in the Current Population Survey it has been determined that income earned from wages or salary tends to be much better reported than other sources of income and is nearly equal to independently derived benchmark estimates. By contrast, recent CPS income data on Social Security and public assistance payments to beneficiaries have averaged approximately 80 and 75 percent, respectively, of their benchmark estimates. In the census the underreporting of these specified types of income and the number of recipients of such income compared with administrative records reflects, for the most part, the failure of some respondents to report them accurately, rather than the failure to enumerate persons receiving them.

Race

Data are shown separately in each table for two racial categories, white and Negro. The category "white" includes persons who indicated their race as white, as well as persons who did not classify themselves in one of the specific race categories on the questionnaire but entered Mexican, Puerto Rican, or a response suggesting Indo-European stock. The category "Negro" includes persons who indicated their race as Negro or black, as well as persons who did not classify themselves in one of the specific race categories on the questionnaire but who had such entries as Jamaican, Trinidadian, West Indian, Haitian, and Ethiopian. The classification of families and households by race refers to the race of the family or household head.

Other races shown separately in table 1 are American Indian, Japanese, Chinese, and Filipino. The category "American Indian" includes persons who indicated their race as American Indian, as well as persons who did not indicate a specific race category but reported the name of an Indian tribe.

Persons of Spanish Language

Persons of Spanish language comprise persons who reported Spanish as their mother tongue (i.e., the language usually spoken in the home when these persons were children) and also include all other persons in families in which the head or wife reported Spanish as his or her mother tongue. Persons of Spanish language may be of any race, although the large majority are white. Table 1 shows the distribution of persons of Spanish language by race.

Standard Metropolitan Statistical Areas

Except in the New England States, a standard metropolitan statistical area (SMSA) is a county or group of contiguous counties which contains at least one city of 50,000 inhabitants or more, or "twin cities" with a combined population of at least 50,000. In addition to the county or counties containing such a city or cities, contiguous counties are included in an SMSA if, according to certain criteria, they are socially and economically integrated with the central city. In the New England States, SMSA's consist of towns and cities instead of counties. Each SMSA must include at least one central city, and the complete title of an SMSA identifies the central city or cities. For a detailed description of the criteria used in defining SMSA's, see the Office of Management and Budget (formerly Bureau of the Budget) publication, *Standard Metropolitan Statistical Areas: 1967*, U.S. Government Printing Office, Washington, D.C. 20402.

Census Tracts

Census tracts are small areas averaging about 4,000 residents into which large cities and adjacent areas have been divided for statistical purposes. Tract boundaries were established cooperatively by local committees and the Bureau of the Census with the intention of maintaining them over a long time so that comparisons could be made from census to census. Generally, tracts were designed to be relatively uniform with respect to population characteristics, economic status, and living conditions. For further information, see *1970 Census of Population and Housing, Census Tracts, Series PHC(1)*.

SAMPLE SIZE

The data presented here are based on a 15-percent sample and are therefore subject to sampling variability. Definitions and technical explanations relating to the statistics in this report, as well as information on sampling variability, may be found in the volume II report, PC(2)-9B, "Low-Income Areas in Large Cities" or in the volume I reports.

Inmates of institutions, members of the Armed Forces living in barracks, college students living in dormitories, and unrelated individuals under 14 years old are excluded from the tabulations. Thus, the number of all persons shown for a given area will not equal the total population counts commonly cited from census reports.

DERIVED FIGURES AND SYMBOLS

Derived Figures

Percents, medians, and means, as well as certain rates and ratios, are used in this report. For all types of derived figures shown, the figure is not presented if the base is smaller than the minimum number (132) prescribed for the 15-percent sample. Instead, a symbol has been inserted.

Symbols



A dash "-" signifies zero. Three dots "..." mean that the data are being withheld to avoid disclosure of information for individuals or households or that the base for the derived figure is too small for it to be shown. Any other symbols used are explained on the individual table in which they occur.

Table D. Census Tract Composition of Low-Income Neighborhoods in Miami, Fla.: 1970

<u>Neighborhood 1</u>		<u>Neighborhood 3</u>		<u>Neighborhood 4</u>
14	19.02	27.01	36.02	52
15.01	20.01	27.02	37.01	53
18.02	22.02	34	37.02	54.02
19.01		36.01		
<u>Neighborhood 2</u>				
25	29			
26	30.01			
28	31			

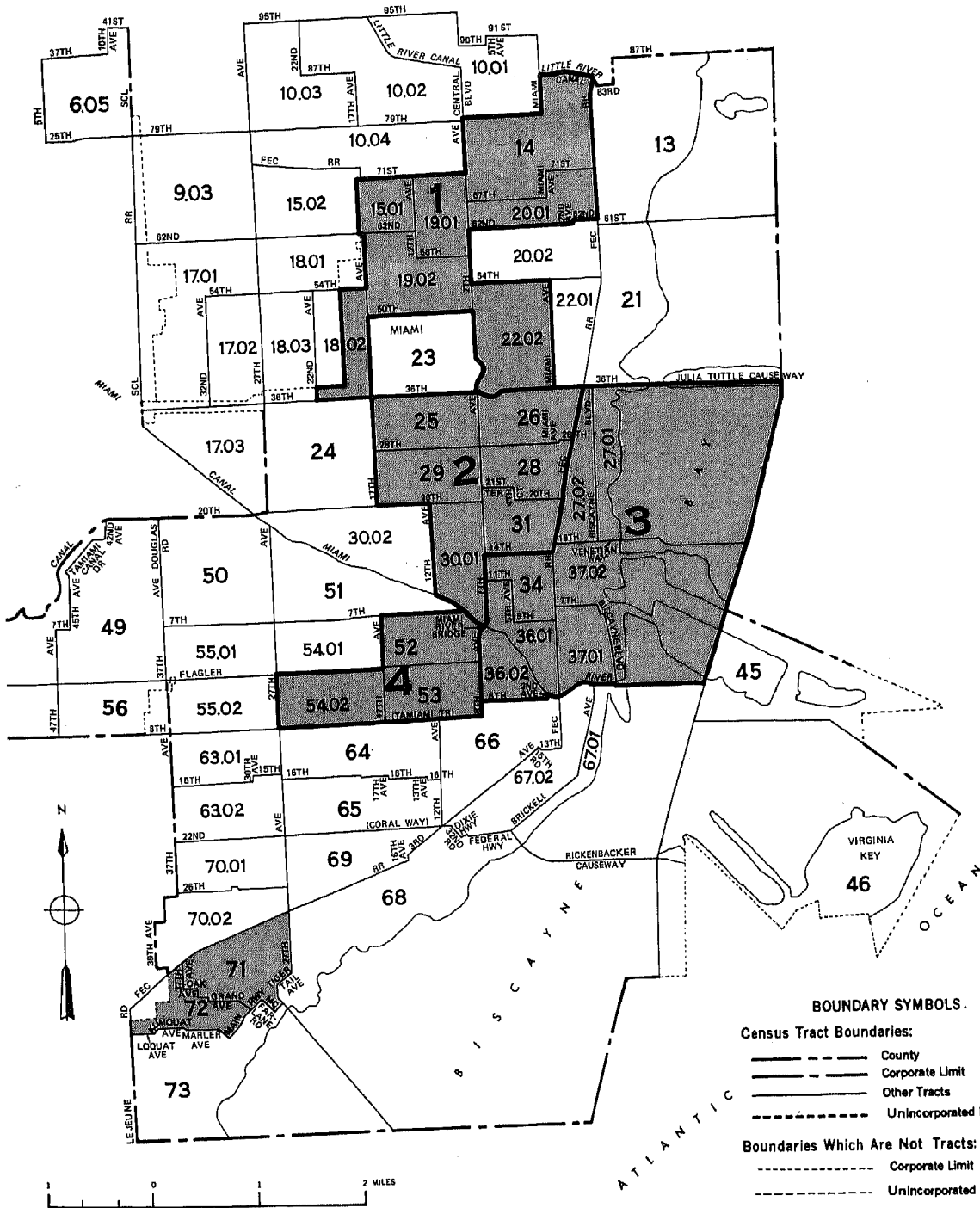
MIAMI, FLORIDA (PART) 1970 LOW-INCOME NEIGHBORHOODS







 **LOW-INCOME NEIGHBORHOOD**
 **LOW-INCOME AREA**

U.S. DEPARTMENT OF COMMERCE
 SOCIAL AND ECONOMIC STATISTICS ADMINISTRATION
 BUREAU OF THE CENSUS

BOUNDARY SYMBOLS.

Census Tract Boundaries:

-  County
-  Corporate Limit
-  Other Tracts
-  Unincorporated Place

Boundaries Which Are Not Tracts:

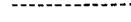
-  Corporate Limit
-  Unincorporated Place

MIAMI, FLORIDA 1970 LOW-INCOME NEIGHBORHOODS

NEIGHBORHOOD 1

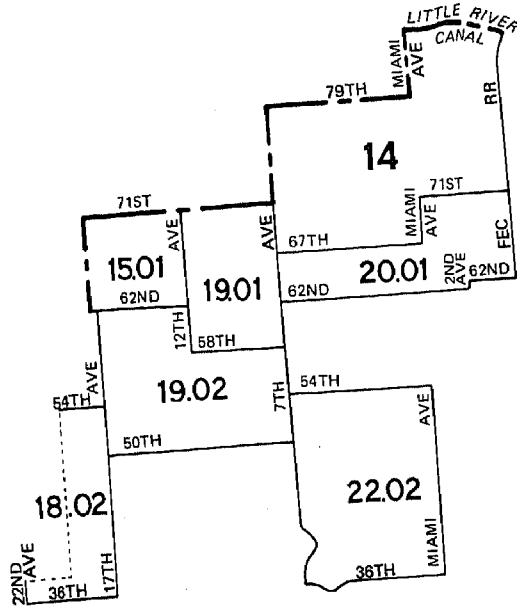

NEIGHBORHOOD 2

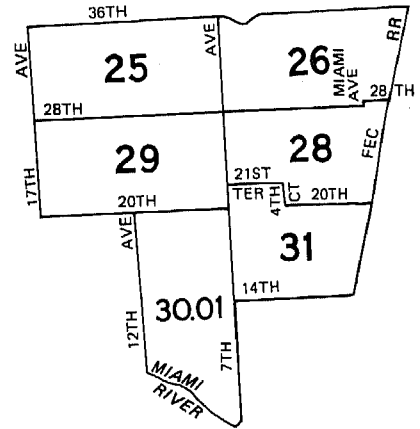

NEIGHBORHOOD 3

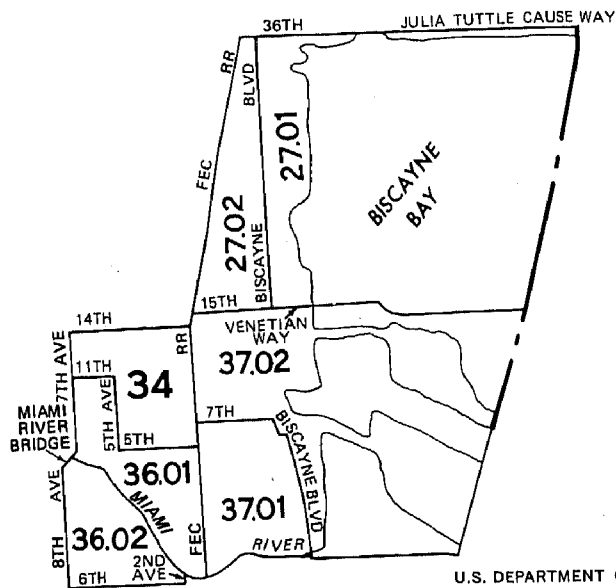

NEIGHBORHOOD 4

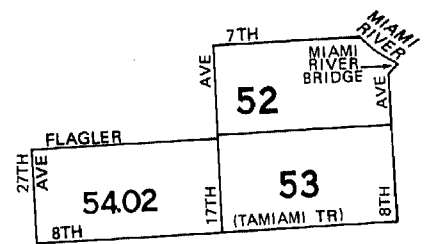

U.S. DEPARTMENT OF COMMERCE
SOCIAL AND ECONOMIC STATISTICS ADMINISTRATION
BUREAU OF THE CENSUS

Table A-1. Selected Characteristics of Persons and Families by Residence in Census Tracts With a Poverty Rate of 20 Percent or More: 1970

(Excludes inmates of institutions, members of Armed Forces living in barracks, college students living in dormitories, and unrelated individuals under 14 years. Data based on 15-percent sample, see text. For minimum base for derived figures (percent, median, etc.) and meaning of symbols, see text)

Miami	Neighborhood 01				Neighborhood 02				Neighborhood 03			
	All races	White	Negro	Persons of Spanish language	All races	White	Negro	Persons of Spanish language	All races	White	Negro	Persons of Spanish language
RACE												
All Income Levels												
All persons	45 686	12 951	32 571	6 563	27 157	17 039	9 984	12 664	34 585	20 794	13 619	11 794
Persons of Spanish language	6 563	5 636	843	6 563	12 664	12 273	298	12 664	11 794	11 144	564	11 794
White	12 951	12 951	-	5 636	17 039	17 039	-	12 273	20 794	20 794	-	11 144
Negro	32 571	-	32 571	843	9 984	-	9 984	298	13 619	-	13 619	564
Other races	164	-	-	84	134	-	-	93	172	-	-	86
American Indian	36	-	-	7	78	-	-	55	8	-	-	-
Japanese	12	-	-	-	26	-	-	26	36	-	-	-
Chinese	7	-	-	-	-	-	-	-	9	-	-	-
Filipino	13	-	-	-	5	-	-	-	26	-	-	8
All other	96	-	-	77	25	-	-	12	93	-	-	78
Percent Below Poverty Level												
All persons	29.4	22.8	32.2	23.9	29.4	24.2	38.3	25.5	31.2	27.9	36.3	29.8
Persons of Spanish language	23.9	23.5	26.5	23.9	25.5	25.2	37.9	25.5	29.8	29.7	33.2	29.8
White	22.8	22.8	-	23.5	24.2	24.2	-	25.2	27.9	27.9	-	29.7
Negro	32.2	-	32.2	28.5	38.3	-	38.3	37.9	36.3	-	36.3	33.2
Other races	7.9	-	-	24.6	-	-	-	...	32.6	-	-	...
American Indian	...	-	-	-	...	-	-	...	-	-	-	-
Japanese	...	-	-	-	-	-	-	-	-	-	-	-
Chinese	...	-	-	-	-	-	-	-	-	-	-	-
Filipino	...	-	-	-	-	-	-	-	-	-	-	-
All other	...	-	-	-	-	-	-	-	-	-	-	-
RELATIONSHIP TO HEAD OF HOUSEHOLD FOR PERSONS BELOW POVERTY LEVEL												
All persons	13 444	2 955	10 476	1 567	7 985	4 124	3 828	3 234	10 798	5 801	4 941	3 513
65 years and over	1 716	980	736	182	1 018	700	318	334	2 523	1 996	495	676
In households	13 290	2 946	10 331	1 567	7 535	3 797	3 705	3 225	10 305	5 438	4 812	3 429
Head of household	4 478	1 491	2 982	430	2 450	1 276	1 166	883	4 670	3 063	1 593	1 390
Family head	2 746	596	2 145	359	1 565	806	751	754	1 897	1 021	862	801
65 years and over	412	191	221	68	256	147	109	114	375	291	70	172
Female	1 385	196	1 184	104	581	181	400	167	727	2 042	731	589
Primary individual	1 732	895	837	71	885	470	415	129	2 773	1 193	319	256
65 years and over	865	563	302	32	417	289	128	61	1 512	1 128	441	378
Female	1 204	628	576	31	570	324	246	87	1 569	983	2 304	986
Related child under 18 years	5 789	658	5 131	635	3 136	1 253	1 866	1 289	3 296	333	873	345
Related child under 6 years	1 838	238	1 600	222	975	447	528	422	1 206	333	681	903
Other relative of head	2 483	630	1 845	440	1 438	967	463	911	1 778	1 064	328	150
Not related to head	540	167	373	62	511	301	210	142	562	328	234	84
In group quarters	154	9	145	-	450	327	123	9	492	363	129	84
AGE												
All males below poverty level												
Under 3 years	5 578	1 188	4 390	724	3 501	1 796	1 697	1 486	5 042	2 773	2 254	1 618
3 to 5 years	480	68	412	74	286	155	131	159	312	85	227	97
6 to 13 years	1 328	146	1 182	140	872	378	494	388	854	252	593	261
14 to 17 years	516	42	474	32	242	72	162	76	312	164	148	161
18 to 21 years	364	67	297	32	122	44	78	38	193	105	88	82
22 to 24 years	154	37	117	23	124	53	36	36	189	62	127	40
25 to 34 years	449	69	380	58	279	124	155	109	392	213	179	189
35 to 44 years	457	85	372	79	419	270	149	261	404	256	148	231
45 to 54 years	353	92	261	72	265	168	97	137	412	259	153	120
55 to 64 years	424	183	241	54	220	142	78	73	621	470	151	179
65 years and over	591	321	270	88	441	279	162	139	1 072	877	189	223
Median age	17.0	44.2	14.8	22.6	20.9	30.9	15.1	22.0	33.7	52.5	14.5	31.0
All females below poverty level												
Under 3 years	7 866	1 767	6 086	843	4 484	2 328	2 131	1 748	5 756	3 028	2 687	1 895
3 to 5 years	481	65	416	57	227	93	134	93	286	98	188	106
6 to 13 years	1 328	146	1 182	140	872	378	494	388	854	252	593	261
14 to 17 years	516	42	474	32	242	72	162	76	312	164	148	161
18 to 21 years	364	67	297	32	122	44	78	38	193	105	88	82
22 to 24 years	154	37	117	23	124	53	36	36	189	62	127	40
25 to 34 years	449	69	380	58	279	124	155	109	392	213	179	189
35 to 44 years	457	85	372	79	419	270	149	261	404	256	148	231
45 to 54 years	353	92	261	72	265	168	97	137	412	259	153	120
55 to 64 years	424	183	241	54	220	142	78	73	621	470	151	179
65 years and over	591	321	270	88	441	279	162	139	1 072	877	189	223
Median age	17.0	44.2	14.8	22.6	20.9	30.9	15.1	22.0	33.7	52.5	14.5	31.0
YEARS OF SCHOOL COMPLETED												
All Income Levels												
Males, 22 years and over	11 720	4 304	7 375	1 783	8 057	5 366	2 649	3 643	12 823	8 943	3 843	4 101
Elementary: 0 to 7 years	3 697	1 180	2 503	720	3 305	2 091	1 214	1 829	3 929	2 350	1 571	1 386
8 years	1 251	564	687	209	1 025	754	262	512	1 570	1 205	356	598
High school: 1 to 3 years	2 681	795	1 886	231	1 259	707	538	372	2 425	1 462	957	574
4 years	2 746	1 094	1 645	374	1 413	925	474	537	2 931	2 195	736	836
College: 1 to 3 years	796	388	408	143	499	357	142	208	969	784	185	300
4 years or more	549	283	246	106	556	532	19	185	999	947	38	407
Median years of school completed	10.0	10.5	9.8	8.8	8.7	8.8	8.4	8.0	10.1	10.9	9.0	9.3

Table A-1. Selected Characteristics of Persons and Families by Residence in Census Tracts With a Poverty Rate of 20 Percent or More: 1970—Continued

[Excludes inmates of institutions, members of Armed Forces living in barracks, college students living in dormitories, and unrelated individuals under 14 years. Data based on 15-percent sample, see text. For minimum base for derived figures (percent, median, etc.) and meaning of symbols, see text.]

Miami	Neighborhood 01				Neighborhood 02				Neighborhood 03			
	All races	White	Negro	Persons of Spanish language	All races	White	Negro	Persons of Spanish language	All races	White	Negro	Persons of Spanish language
YEARS OF SCHOOL COMPLETED—Con.												
All Income Levels—Con.												
Female, 22 years and over	14 690	5 221	9 397	1 980	8 784	5 876	2 864	4 020	12 487	8 400	3 997	4 561
Elementary: 0 to 7 years	4 297	1 481	2 790	826	3 544	2 461	1 049	2 171	3 818	2 257	1 506	1 807
8 years	1 634	760	874	299	1 032	783	249	569	1 532	1 099	427	674
High school: 1 to 3 years	3 627	1 018	2 602	245	1 668	858	805	453	2 074	968	1 098	398
4 years	3 708	1 327	2 389	410	1 708	1 120	588	531	3 481	2 666	794	1 115
College: 1 to 3 years	896	408	488	97	461	346	115	162	904	770	134	265
4 years or more	528	227	284	103	371	308	58	134	678	640	38	303
Median years of school completed	10.2	10.1	10.2	8.5	8.8	8.6	9.5	7.4	10.3	11.6	9.2	8.7
Income Below Poverty Level												
Male, 22 years and over	2 428	787	1 641	374	1 748	1 054	694	755	3 090	2 137	947	941
Less than 8 years	1 020	334	686	191	883	565	318	509	1 273	806	467	424
8 to 11 years	817	228	589	86	535	275	260	134	890	658	226	244
12 years or more	591	225	366	97	330	214	116	112	927	673	254	288
Female, 22 years and over	4 314	1 369	2 940	475	2 491	1 411	1 072	1 020	3 873	2 418	1 414	1 041
Less than 8 years	1 685	478	1 207	203	1 257	737	512	648	1 511	854	624	422
8 to 11 years	1 631	522	1 109	165	776	402	374	276	1 200	632	560	316
12 years or more	998	369	624	107	458	272	186	96	1 162	932	230	433
EMPLOYMENT STATUS AND AGE												
All Income Levels												
Male												
16 to 21 years ¹	1 969	464	1 499	294	972	628	335	528	1 099	502	589	401
Employed	835	251	584	172	500	343	157	304	616	297	319	235
Unemployed	125	9	110	—	59	9	41	18	63	32	31	38
Not in labor force	1 009	204	805	122	413	276	137	206	411	173	230	128
22 to 64 years ¹	9 794	3 069	6 690	1 614	6 877	4 498	2 340	3 250	9 703	6 250	3 400	3 487
Employed	8 166	2 407	5 737	1 367	5 775	3 855	1 881	2 858	7 664	5 048	2 610	2 938
Unemployed	278	125	153	40	249	143	106	104	452	205	238	122
Not in labor force	1 342	529	800	207	853	500	353	288	1 578	997	573	427
Family head, 22 to 64 years ¹	6 639	2 137	4 480	1 307	4 415	3 089	1 298	2 463	4 747	3 015	1 717	2 286
Employed	5 847	1 796	4 029	1 176	3 955	2 774	1 153	2 232	4 014	2 592	1 416	1 971
Unemployed	158	68	70	35	127	92	35	84	160	84	67	76
Not in labor force	626	265	361	96	333	223	110	147	573	339	234	239
Female												
16 to 21 years	2 562	501	2 053	328	1 360	816	530	538	1 222	579	633	445
Employed	1 045	263	782	149	493	313	180	216	474	237	227	165
Unemployed	104	14	90	—	72	41	25	18	57	11	46	11
Not in labor force	1 413	224	1 181	179	795	462	325	304	691	331	360	269
22 to 64 years ¹	11 987	3 546	8 376	1 718	7 295	4 695	2 573	3 512	9 368	5 811	3 493	3 714
Employed	7 214	1 849	5 312	872	4 005	2 394	1 604	1 789	5 232	3 148	2 051	1 927
Unemployed	281	99	170	77	221	168	53	155	229	160	69	104
Not in labor force	4 492	1 598	2 894	769	3 069	2 133	916	1 568	3 907	2 503	1 373	1 683
Family head, 22 to 64 years	2 508	442	2 038	196	1 072	409	656	335	1 343	562	781	352
Employed	1 763	305	1 442	125	739	263	476	209	966	375	591	236
Unemployed	100	11	77	23	24	5	19	5	48	36	12	2
Not in labor force	645	126	519	48	309	141	161	121	329	151	178	114
Wife of head, 22 to 64 years	6 209	2 043	4 148	1 136	4 052	2 876	1 168	2 283	4 638	2 947	1 655	2 112
Employed	3 328	932	2 378	551	2 012	1 348	664	1 093	2 199	1 342	836	922
Unemployed	158	70	88	48	114	86	28	92	86	62	24	48
Not in labor force	2 723	1 041	1 682	537	1 926	1 442	476	1 098	2 353	1 543	795	1 092
Income Below Poverty Level												
Male												
16 to 21 years ¹	608	99	509	59	222	85	137	81	321	168	153	149
Employed	163	6	157	—	96	53	43	47	129	72	57	68
Unemployed	7	—	7	—	27	—	27	—	26	14	12	14
Not in labor force	438	93	345	59	99	32	67	34	157	82	75	67
22 to 64 years ¹	1 837	466	1 371	286	1 307	775	532	616	2 018	1 260	758	759
Employed	1 125	250	875	195	840	520	320	470	1 091	728	363	499
Unemployed	104	34	70	23	62	34	28	17	145	53	92	35
Not in labor force	608	182	426	68	405	221	184	129	773	479	294	225
Family head, 22 to 64 years ¹	1 053	240	813	208	722	479	243	461	835	521	314	484
Employed	764	148	616	154	567	373	194	376	508	323	185	319
Unemployed	50	24	26	18	33	25	8	17	69	34	35	28
Not in labor force	239	68	171	36	122	81	41	68	258	164	94	131

¹Includes members of Armed Forces not living in barracks and not shown separately.

Table A-1. Selected Characteristics of Persons and Families by Residence in Census Tracts With a Poverty Rate of 20 Percent or More: 1970—Continued

(Excludes inmates of institutions, members of Armed Forces living in barracks, college students living in dormitories, and unrelated individuals under 14 years. Data based on 15-percent sample, see text. For minimum base for derived figures (percent, median, etc.) and meaning of symbols, see text)

Miami	Neighborhood 01				Neighborhood 02				Neighborhood 03			
	All races	White	Negro	Persons of Spanish language	All races	White	Negro	Persons of Spanish language	All races	White	Negro	Persons of Spanish language
EMPLOYMENT STATUS AND AGE—Con.												
Income Below Poverty Level—Con.												
Female												
18 to 21 years	821	92	721	83	536	362	174	160	378	149	229	80
Employed	236	31	205	24	144	110	34	53	124	60	64	22
Unemployed	40	14	26	—	36	29	7	—	25	6	19	6
Not in civilian labor force	545	47	490	59	356	223	133	107	229	83	146	52
22 to 64 years	3 189	710	2 474	381	1 914	990	916	825	2 422	1 299	1 108	912
Employed	1 340	212	1 123	109	775	305	470	260	1 011	438	566	337
Unemployed	122	39	83	27	68	36	32	21	92	68	24	35
Not in civilian labor force	1 727	459	1 268	245	1 071	649	414	544	1 319	793	518	540
Family head, 22 to 64 years	1 199	151	1 043	77	524	164	360	155	631	201	430	145
Employed	703	75	623	38	290	77	213	77	374	94	280	69
Unemployed	57	11	46	11	19	—	19	—	37	25	12	—
Not in civilian labor force	439	65	374	28	215	87	128	78	220	82	138	76
Wife of head, 22 to 64 years	1 017	268	749	213	704	466	230	455	815	505	295	436
Employed	303	54	249	57	237	137	100	133	267	138	122	140
Unemployed	48	16	32	16	15	8	7	8	20	14	6	14
Not in civilian labor force	666	198	468	140	452	321	123	314	528	353	167	282
SELECTED OCCUPATIONS												
All Income Levels												
Male employed, 22 to 64 years ²	8 166	2 407	5 737	1 367	5 775	3 855	1 881	2 858	7 664	5 048	2 610	2 938
Prof., tech., and kindred workers	409	108	294	30	490	454	31	158	507	430	77	206
Health workers, exc. practitioners	27	5	22	5	45	39	6	12	24	24	—	16
Teachers, elem. and secondary	114	7	107	—	13	6	7	6	74	59	15	39
Managers and admin., exc. farm	359	146	213	45	221	152	69	80	455	400	55	168
Self-employed	95	33	62	—	47	39	8	32	135	105	30	58
Sales workers	292	147	145	55	204	172	32	106	453	405	48	160
Retail trade	168	75	93	39	70	63	7	49	185	152	33	75
Clerical and kindred workers	535	225	310	122	316	258	58	180	492	367	125	149
Postal clerks and mail carriers	100	15	85	—	28	8	—	—	45	20	25	—
Shipping, receiving, & stock clerks	143	35	108	21	70	63	7	63	98	59	39	24
Bkksprs., cashiers, & bank tellers	77	32	45	16	62	62	—	49	68	62	6	37
Craftsmen and kindred workers	1 633	746	887	400	1 134	966	161	731	1 313	953	360	570
Construction craftsmen	553	204	349	107	435	374	54	318	477	283	194	196
Mechanics and repairmen	407	210	197	139	215	188	27	137	276	228	48	169
Operatives, except transport	837	315	515	237	798	617	167	534	766	567	199	507
Assemblers	51	32	19	32	13	13	—	6	52	52	—	47
Checkers, exam., & inspectors, mfg.	—	—	—	—	—	—	—	—	—	—	—	—
Pkrs. & wrappers, inc. meat & prod.	46	11	35	20	45	30	15	16	39	31	8	24
Sewers, stitchers, & textile oper.	7	—	7	—	15	15	—	15	17	17	—	17
Transport equipment operatives	1 092	159	933	117	474	174	293	120	621	278	343	150
Truck drivers	351	41	310	46	263	98	165	48	175	65	110	38
Laborers, except farm	1 544	136	1 408	84	1 160	444	716	392	1 168	377	791	232
Construction	463	48	415	32	392	213	179	191	251	40	211	32
Freight, material, & stock handlers	361	14	347	6	256	69	187	57	346	120	226	51
Service workers, exc. private hshld. ³	1 352	406	946	263	930	593	337	526	1 828	1 250	572	769
Cleaning service workers	543	103	440	82	326	153	173	139	482	234	248	183
Food service workers	334	132	202	118	386	313	73	305	813	639	174	407
Health service workers	60	20	40	20	19	13	6	6	21	—	15	6
Personal service workers	133	46	87	21	65	58	7	41	254	206	48	120
Protective service workers	116	38	78	—	48	41	7	14	66	52	14	22
Private household workers	41	—	41	—	8	8	—	8	33	—	33	6
Female employed, 22 to 64 yrs. ²	7 214	1 849	5 312	872	4 005	2 394	1 604	1 789	5 232	3 148	2 051	1 927
Prof., tech., and kindred workers	593	135	441	49	314	249	65	43	350	257	93	115
Health workers, exc. practitioners	173	55	107	25	137	119	18	12	75	62	13	19
Teachers, elem. and secondary	242	23	219	11	69	40	29	5	90	48	42	22
Managers and admin., exc. farm	89	61	28	7	47	36	11	—	163	147	16	14
Self-employed	7	—	—	—	6	6	—	—	31	31	—	—
Sales workers	249	119	130	28	117	84	33	68	263	226	37	104
Retail trade	190	98	92	22	84	51	33	45	199	162	37	83
Clerical and kindred workers	1 444	595	842	133	514	354	160	200	1 113	853	246	333
Bkksprs., cashiers, & bank tellers	316	150	166	47	107	92	15	38	224	138	78	46
Secretaries, steno., & typists	324	146	178	7	140	113	27	57	433	399	28	129
Craftsmen and kindred workers	127	28	99	17	77	63	14	44	54	54	—	47
Operatives, except transport	998	455	526	415	1 446	1 149	297	1 082	1 099	895	198	816
Laundry & dry cleaning operatives ⁴	279	29	250	45	296	120	176	115	243	112	131	106
Assemblers	63	34	29	27	37	30	7	30	16	16	—	16
Pkrs. & wrappers, inc. meat & prod.	83	46	37	46	68	68	—	68	58	58	—	58
Sewers, stitchers, & textile oper.	206	159	30	156	534	505	29	511	386	356	30	359
Transport equipment operatives	97	8	89	8	17	—	17	—	5	—	5	—
Laborers, except farm	116	17	99	4	44	26	18	26	8	40	41	40
Service workers, exc. private hshld. ³	2 035	392	1 631	172	888	389	492	288	1 332	626	700	380
Cleaning service workers	546	82	457	53	358	124	234	118	488	209	279	169
Food service workers	565	145	415	48	199	106	86	86	350	205	139	88
Health service workers	348	61	287	13	150	43	107	24	192	47	145	30
Personal service workers	160	61	99	35	66	58	8	31	164	120	44	79
Private household workers	1 452	39	1 413	39	541	44	497	38	772	50	715	78

¹Includes "farm workers" not shown separately. ²Allocated cases are included in the total but not in the distribution. ³Includes "clothing ironers and pressers." ⁴Protective service workers and allocated cases are included in the total but not in the distribution.

Table A-1. Selected Characteristics of Persons and Families by Residence in Census Tracts With a Poverty Rate of 20 Percent or More: 1970—Continued

[Excludes inmates of institutions, members of Armed Forces living in barracks, college students living in dormitories, and unrelated individuals under 14 years. Data based on 15-percent sample, see text. For minimum base for derived figures (percent, median, etc.) and meaning of symbols, see text.]

Miami	Neighborhood 01				Neighborhood 02				Neighborhood 03			
	All races	White	Negro	Persons of Spanish language	All races	White	Negro	Persons of Spanish language	All races	White	Negro	Persons of Spanish language
SELECTED OCCUPATIONS— Con.												
Income Below Poverty Level												
Male employed, 22 to 64 years ²	1 125	250	875	195	840	520	320	470	1 091	728	363	499
Prof., tech., and kindred workers	28	—	28	—	21	21	—	14	48	24	24	9
Managers and admin., exc. farm	36	22	14	6	31	16	15	16	78	61	17	35
Sales workers	35	29	6	12	15	15	—	9	36	36	—	28
Clerical and kindred workers	51	20	31	30	54	46	8	30	59	29	30	11
Craftsmen and kindred workers	202	43	159	26	108	82	26	82	125	111	14	63
Operatives, except transport	149	60	89	59	100	86	14	82	113	71	42	83
Transport equipment operatives	163	10	153	10	57	35	22	35	77	47	30	23
Laborers, except farm	237	16	221	16	238	95	143	90	212	113	99	92
Service workers, exc. private hshld	207	50	157	36	200	115	85	103	329	230	99	149
Private household workers	—	—	—	—	—	—	—	—	8	—	8	—
Female employed, 22 to 64 yrs. ²	1 340	212	1 123	109	775	305	470	260	1 011	438	566	337
Prof., tech., and kindred workers	23	—	23	—	14	14	—	—	16	16	—	10
Managers and admin., exc. farm	24	24	—	—	—	—	—	—	35	35	—	8
Sales workers	47	8	39	—	20	13	7	13	50	34	16	25
Clerical and kindred workers	176	29	147	16	45	28	17	17	94	49	45	28
Craftsmen and kindred workers	20	4	16	4	7	7	—	7	—	—	—	—
Operatives, except transport	178	46	132	49	236	166	70	166	193	154	39	144
Transport equipment operatives	6	—	6	—	—	—	—	—	—	—	—	—
Laborers, except farm	28	4	24	4	11	—	11	—	20	7	13	7
Service workers, exc. private hshld	430	89	336	36	236	58	178	50	358	132	226	84
Private household workers	408	8	400	—	206	19	187	7	245	11	227	31
FAMILY STATUS AND AGE												
All Income Levels												
Both Sexes												
Head of family: 14 to 21 yrs.	263	52	211	13	123	57	58	54	252	67	185	48
22 to 54 yrs.	7 637	1 873	5 722	1 275	4 633	2 872	1 742	2 358	4 782	2 553	2 220	2 031
Wife of head: 14 to 21 yrs.	403	130	273	50	177	80	97	61	326	88	228	60
22 to 54 yrs.	5 315	1 530	3 767	1 058	3 548	2 479	1 061	2 073	3 750	2 191	1 523	1 738
Unrelated indiv.: 14 to 21 yrs.	302	57	245	15	412	282	130	35	450	274	176	165
22 to 54 yrs.	2 457	756	1 694	147	2 054	1 020	1 017	383	4 485	2 864	1 609	1 006
Female												
Head of family: 14 to 21 yrs.	108	17	91	6	30	4	26	—	78	7	71	7
22 to 54 yrs.	2 232	343	1 861	187	943	345	598	297	1 133	414	719	280
Unrelated indiv.: 14 to 21 yrs.	160	15	145	8	322	256	66	31	135	98	37	37
22 to 54 yrs.	1 006	301	698	49	806	402	392	139	1 409	885	512	358
Income Below Poverty Level												
Both Sexes												
Head of family: 14 to 21 yrs.	82	14	68	6	63	16	39	24	56	8	48	—
22 to 54 yrs.	1 934	282	1 647	228	1 125	580	545	562	1 215	543	672	471
Wife of head: 14 to 21 yrs.	80	15	65	6	34	24	10	24	88	35	53	27
22 to 54 yrs.	840	186	654	182	622	421	193	410	607	350	242	346
Unrelated indiv.: 14 to 21 yrs.	188	43	145	15	366	265	101	35	256	167	89	107
22 to 54 yrs.	726	206	520	52	691	303	388	129	1 078	623	455	291
Female												
Head of family: 14 to 21 yrs.	55	6	49	6	20	—	20	—	24	—	26	—
22 to 54 yrs.	1 097	130	962	68	494	157	337	148	575	165	410	109
Unrelated indiv.: 14 to 21 yrs.	115	15	100	8	305	249	56	31	109	84	25	30
22 to 54 yrs.	351	100	251	14	367	154	213	54	447	256	191	118

²Includes "farm workers" not shown separately.

Table A-2. Characteristics of the Population by Residence in Census Tracts With a Poverty Rate of 20 Percent or More: 1970

(Excludes inmates of institutions, members of Armed Forces living in barracks, college students living in dormitories, and unrelated individuals under 14 years. Data based on 15-percent sample, see text. For minimum base for derived figures (percent, median, etc.) and meaning of symbols, see text)

Miami	Neighborhood 01				Neighborhood 02				Neighborhood 03			
	All races	White	Negro	Persons of Spanish language	All races	White	Negro	Persons of Spanish language	All races	White	Negro	Persons of Spanish language
RELATIONSHIP TO HEAD												
All persons	45 686	12 951	32 571	6 563	27 157	17 039	9 984	12 664	34 585	20 794	13 619	11 794
In households	45 394	12 904	32 326	6 563	26 392	16 505	9 753	12 569	33 565	20 023	13 370	11 550
Head of household	14 925	5 598	9 257	1 791	8 492	5 412	3 229	3 421	15 654	10 762	4 849	4 523
Family head	10 908	3 492	7 353	1 636	6 472	4 197	2 229	3 154	7 701	4 822	2 850	3 123
65 years old and over	1 498	861	624	120	1 267	642	217	302	1 359	1 178	187	447
Female	2 993	598	2 360	229	2 220	1 215	1 000	267	7 953	5 940	1 999	1 400
Primary individual	4 017	2 106	1 904	155	1 179	737	442	145	3 421	2 573	842	649
Female	2 329	1 271	1 051	72	8 828	4 883	3 922	4 400	7 570	2 626	4 909	2 533
Related child under 18 years old	16 353	2 757	13 559	2 439	7 937	5 679	2 210	4 495	9 080	5 926	3 066	4 189
Other relative of head	12 885	4 211	8 617	2 220	935	531	392	253	1 261	709	546	305
Not related to head	1 231	338	893	113	765	534	231	95	1 020	771	249	244
In group quarters	292	47	245	-								
AGE												
Male, all ages	21 062	6 074	14 914	3 248	13 025	8 222	4 744	6 215	17 406	10 691	6 648	5 691
Under 3 years	1 419	264	1 149	233	673	358	315	315	788	272	516	272
3 to 5 years	1 240	228	1 012	181	666	365	301	339	713	229	484	205
6 to 13 years	3 865	683	3 161	637	2 245	1 266	979	1 219	1 587	538	1 035	514
14 to 17 years	1 617	304	1 313	239	900	572	320	444	761	331	414	330
18 to 21 years	1 201	291	904	175	484	295	160	255	734	378	356	269
22 to 24 years	973	265	695	139	477	271	206	155	639	279	352	157
25 to 34 years	2 712	606	2 099	389	1 710	1 052	646	737	2 360	1 321	1 039	929
35 to 44 years	2 594	695	1 892	510	1 904	1 276	616	1 010	2 325	1 381	944	901
45 to 54 years	1 764	685	1 079	320	1 673	1 082	591	807	2 115	1 476	630	705
55 to 64 years	1 751	818	925	256	1 113	817	281	541	2 264	1 793	465	795
65 years and over	1 926	1 235	685	169	1 180	868	309	393	3 120	2 693	413	614
Median age	24.8	39.7	20.6	24.5	30.2	33.4	25.1	29.2	38.8	48.2	25.6	35.9
Female, all ages	24 624	6 877	17 657	3 315	14 132	8 817	5 240	6 449	17 179	10 103	6 971	6 103
Under 3 years	1 329	233	1 096	191	706	376	330	280	731	214	517	212
3 to 5 years	1 325	168	1 157	142	760	373	387	357	794	236	558	245
6 to 13 years	3 756	563	3 183	478	1 999	1 097	895	982	1 584	532	1 047	532
14 to 17 years	1 902	343	1 559	338	939	498	425	478	794	352	442	301
18 to 21 years	1 622	349	1 265	188	896	597	339	332	789	369	410	251
22 to 24 years	1 248	275	973	127	603	345	251	223	732	365	367	247
25 to 34 years	3 349	658	2 668	488	1 896	1 152	731	928	2 366	1 219	1 132	987
35 to 44 years	2 790	721	2 057	496	1 956	1 230	726	979	1 850	1 040	775	907
45 to 54 years	2 406	822	1 566	372	1 584	1 014	570	827	2 258	1 475	441	791
55 to 64 years	2 194	1 070	1 112	235	1 256	954	295	555	2 162	1 712	454	848
65 years and over	2 703	1 675	1 021	262	1 489	1 181	291	508	3 119	2 589	504	848
Median age	27.4	45.6	22.8	26.0	29.9	33.7	23.9	30.2	38.3	48.9	25.3	37.5
PLACE OF BIRTH												
Total population	45 686	12 951	32 571	6 563	27 157	17 039	9 984	12 664	34 585	20 794	13 619	11 794
Born in State of residence	21 203	2 019	19 163	1 069	7 730	2 413	5 317	1 308	9 676	1 836	7 822	870
Born in different State	13 613	4 507	9 093	279	5 723	2 682	3 018	324	9 868	5 892	3 954	309
Northwest	2 074	1 806	268	167	1 168	1 019	142	240	3 008	2 884	124	107
North Central	1 394	1 258	136	25	726	711	15	26	1 473	1 392	81	67
South	10 042	1 346	8 683	75	3 750	901	2 833	36	5 191	1 440	3 743	99
West	103	97	6	12	79	51	28	22	196	176	6	36
Puerto Rico and outlying areas	781	767	14	767	1 480	1 467	13	1 471	631	613	18	624
Foreign born	5 967	4 679	1 193	4 179	10 116	9 457	548	9 231	11 544	10 725	709	9 573
Not reported and other	4 122	979	3 108	269	2 108	1 020	1 088	330	2 866	1 728	1 116	418
RESIDENCE IN 1965												
Total, 5 years and over	41 216	12 228	28 830	5 982	24 875	15 842	8 899	11 640	32 092	20 012	11 908	11 025
Same house as in 1970	19 506	4 808	14 656	1 317	8 780	4 700	4 056	2 192	11 975	5 897	6 018	2 409
Different house in United States	15 726	4 329	11 341	2 069	8 162	4 430	3 701	3 009	12 543	7 819	4 650	3 538
Same county	12 730	3 119	9 569	1 696	6 299	3 271	3 004	2 632	8 699	5 319	3 312	2 786
Different county	2 996	1 210	1 772	373	1 863	1 159	697	467	3 844	2 500	1 338	752
Same State	848	216	632	48	546	304	242	48	905	315	590	81
Different State	2 148	994	1 140	325	1 317	855	455	419	2 939	2 185	748	671
Northwest	630	451	179	213	485	434	51	304	1 269	1 179	84	384
North Central	350	291	52	12	212	188	17	57	561	491	70	153
South	1 050	194	849	70	465	109	356	13	942	375	567	62
West	118	58	60	30	155	124	31	45	167	140	27	72
Moved, residence not rptd., abroad	5 984	3 091	2 833	2 596	7 933	6 712	1 142	6 349	7 574	6 296	1 240	5 078
SCHOOL ENROLLMENT												
All Income Levels												
Total enrolled, 3 to 21 yr. old	12 080	2 060	9 989	1 791	6 515	3 681	2 801	3 190	5 165	1 964	3 166	1 788
Nursery school:	133	-	133	-	62	12	50	17	95	35	60	48
Public	118	14	104	20	45	21	24	21	116	48	68	40
Private	405	53	352	55	174	105	69	98	321	78	243	82
Kindergarten:	256	62	187	55	87	34	33	39	116	25	91	16
Public	7 341	1 016	6 301	921	4 053	2 147	1 889	1 982	2 941	907	2 015	874
Private	502	310	192	261	364	345	593	553	1 071	414	641	363
High school (1 to 4 yr.):	2 747	395	2 352	343	1 228	627	33	90	1 44	128	16	99
Public	168	100	68	79	160	127	71	76	186	167	19	117
Private	410	110	300	57	342	263	-	-	-	-	-	-
College	12 080	2 060	9 989	1 791	6 515	3 681	2 801	3 190	5 165	1 964	3 166	1 788
Total enrolled, 3 to 21 yr. old	842	108	734	102	429	178	251	176	537	140	397	140
3 to 5 years old	7 274	1 198	6 045	1 039	3 970	2 221	1 742	2 059	2 971	958	1 954	919
6 to 13 years old	1 647	279	1 368	241	672	396	276	356	614	279	363	285
14 and 15 years old	1 367	268	1 099	119	598	426	164	208	343	258	85	185
16 and 17 years old	950	207	743	-								

Table A-2. Characteristics of the Population by Residence in Census Tracts With a Poverty Rate of 20 Percent or More: 1970—Continued

[Excludes inmates of institutions, members of Armed Forces living in barracks, college students living in dormitories, and unrelated individuals under 14 years. Data based on 15-percent sample, see text. For minimum base for derived figures (percent, median, etc.) and meaning of symbols, see text]

Miami	Neighborhood 01				Neighborhood 02				Neighborhood 03			
	All races	White	Negro	Persons of Spanish language	All races	White	Negro	Persons of Spanish language	All races	White	Negro	Persons of Spanish language
SCHOOL ENROLLMENT—Continued												
All Income Levels—Continued												
Percent enrolled, 3 to 21 yr. old	73.1	70.3	73.7	75.4	72.9	72.7	73.2	72.4	66.6	66.2	66.7	67.5
3 to 5 years old	32.8	27.3	33.8	31.6	30.1	24.1	36.5	25.3	35.6	30.1	38.1	31.1
6 to 13 years old	95.4	96.1	95.3	93.2	93.5	94.0	93.0	93.5	93.7	89.5	95.8	87.9
14 and 15 years old	90.9	86.6	91.9	91.8	90.5	88.8	92.2	88.3	92.5	94.3	90.8	93.4
16 and 17 years old	80.0	82.5	79.5	92.3	74.3	71.7	79.8	74.3	76.9	83.5	71.7	79.4
18 to 21 years old	33.7	32.3	34.3	33.0	41.9	47.8	31.6	35.4	22.5	34.5	11.1	35.6
Income Below Poverty Level												
Total enrolled, 3 to 21 yr. old	4 212	473	3 739	432	2 377	994	1 358	868	2 328	732	1 587	707
Nursery school:												
Public	72	—	72	—	37	6	31	11	53	8	45	21
Private	35	9	26	—	7	—	7	—	34	7	27	7
Kindergarten:												
Public	91	10	81	16	44	18	26	18	167	33	134	37
Private	47	20	27	14	7	—	7	—	27	9	18	—
Elem. (1 to 8 yr.):												
Public	2 826	245	2 581	246	1 626	642	967	656	1 548	467	1 072	470
Private	62	56	6	40	4	4	—	4	17	17	—	13
High school (1 to 4 yr.):												
Public	938	89	849	86	435	132	295	148	430	139	291	120
Private	27	12	15	12	11	—	11	11	39	39	—	32
College	114	32	82	18	206	192	14	20	13	13	—	7
Total enrolled, 3 to 21 yr. old	4 212	473	3 739	432	2 377	994	1 358	868	2 328	732	1 587	707
3 to 5 years old	246	35	211	26	97	12	85	12	232	40	192	44
6 to 13 years old	2 714	291	2 423	281	1 526	625	894	642	1 504	422	1 073	425
14 and 15 years old	513	46	467	32	313	70	225	90	325	137	188	130
16 and 17 years old	403	53	350	59	155	49	106	71	184	84	100	70
18 to 21 years old	336	46	288	34	286	238	48	53	83	49	34	38
Percent enrolled, 3 to 21 yr. old	73.4	71.0	73.8	73.6	73.5	70.4	75.6	71.9	71.9	68.9	73.3	73.4
3 to 5 years old	28.1	...	27.3	...	21.0	6.0	32.3	7.1	38.2	26.7	41.9	31.0
6 to 13 years old	94.9	93.9	95.1	88.6	92.8	93.3	92.5	93.4	95.5	91.9	96.9	92.0
14 and 15 years old	89.1	...	90.5	...	84.8	...	87.9	...	91.5	100.0	86.2	...
16 and 17 years old	70.1	...	68.8	...	76.7	...	76.3	...	68.7	...	62.9	...
18 to 21 years old	39.3	...	39.9	...	51.4	62.0	27.9	34.0	19.3	23.6	15.2	...
YEARS OF SCHOOL COMPLETED												
All Income Levels												
Male, 25 years old and over	10 747	4 039	6 680	1 644	7 580	5 095	2 443	3 488	12 184	8 664	3 491	3 944
Elementary:												
0 to 7 years	3 650	1 157	2 479	691	3 255	2 047	1 208	1 785	3 847	2 316	1 523	1 354
8 years	1 204	564	640	209	1 005	734	262	499	1 529	1 195	325	588
High school:												
1 to 3 years	2 393	757	1 636	207	1 166	673	479	345	2 271	1 405	860	562
4 years	2 355	978	1 370	329	1 229	845	370	495	2 734	2 139	595	796
College:												
1 to 3 years	670	327	343	122	433	315	118	185	843	693	150	245
4 years or more	475	256	212	86	492	481	6	179	960	916	38	399
Median years of school completed	9.7	10.2	9.4	8.6	8.5	8.7	8.1	7.8	9.9	10.8	8.7	9.2
Female, 25 years old and over	13 442	4 946	8 424	1 853	8 181	5 531	2 613	3 797	11 755	8 035	3 630	4 315
Elementary:												
0 to 7 years	4 211	1 444	2 741	794	3 447	2 388	1 032	2 107	3 749	2 228	1 466	1 776
8 years	1 565	739	826	291	973	737	236	523	1 519	1 099	414	674
High school:												
1 to 3 years	3 314	973	2 334	230	1 533	814	714	415	1 922	936	978	379
4 years	3 145	1 238	1 885	361	1 507	1 024	483	470	3 125	2 473	631	978
College:												
1 to 3 years	723	329	394	74	380	290	90	148	813	710	103	228
4 years or more	484	223	244	103	341	278	58	134	627	589	38	280
Median years of school completed	9.9	9.9	9.8	8.5	8.7	8.5	9.2	7.2	10.0	11.2	8.8	8.6
Income Below Poverty Level												
Male, 25 years old and over	2 274	750	1 524	351	1 624	983	641	719	2 901	2 075	820	942
Less than 8 years	1 012	326	686	183	862	544	318	488	1 222	786	436	408
8 to 11 years	741	228	513	86	499	262	237	128	632	648	178	268
12 years or more	521	196	325	82	263	177	86	103	847	641	206	266
Female, 25 years old and over	4 102	1 331	2 766	456	2 352	1 342	1 002	980	3 704	2 360	1 303	1 330
Less than 8 years	1 670	471	1 199	196	1 227	712	507	623	1 481	847	601	615
8 to 11 years	1 489	503	986	158	717	387	330	267	1 145	624	513	310
12 years or more	943	357	581	102	408	243	165	90	1 078	889	189	405
PERSONS 16 TO 21 YEARS OLD NOT IN SCHOOL												
All Income Levels												
Male	872	202	664	112	431	276	146	229	651	292	359	221
Not high school graduate	594	146	448	76	329	219	101	189	423	192	231	183
Employed or in Armed Forces	366	109	257	69	221	154	67	140	278	132	146	142
Unemployed	62	—	62	—	31	9	13	18	34	14	20	14
Not in labor force	166	37	129	7	77	56	21	31	111	46	65	27
High school graduate	278	56	216	36	102	57	45	40	228	100	128	38
Employed or in Armed Forces	181	49	132	29	56	39	17	27	202	74	128	28
Unemployed	21	—	15	—	28	—	28	—	—	—	—	—
Not in labor force	76	7	69	7	18	18	—	13	26	26	—	10
Female	1 342	288	1 046	150	631	346	279	273	713	252	451	181
Not high school graduate	601	128	465	86	332	226	100	201	399	87	312	83
Employed or in Armed Forces	263	85	178	57	163	134	29	113	120	27	93	27
Unemployed	25	—	25	—	23	10	7	6	49	3	46	3
Not in labor force	313	43	262	29	146	82	64	82	230	57	173	53
High school graduate	741	160	581	64	299	120	179	72	314	165	139	98
Employed or in Armed Forces	518	111	407	46	171	63	108	42	191	92	89	49
Unemployed	44	—	44	—	35	17	18	7	3	3	—	3
Not in labor force	179	49	130	18	93	40	53	23	120	70	50	46

Table A-2. Characteristics of the Population by Residence in Census Tracts With a Poverty Rate of 20 Percent or More: 1970—Continued

[Excludes inmates of institutions, members of Armed Forces living in barracks, college students living in dormitories, and unrelated individuals under 14 years. Data based on 15 percent sample, see text. For minimum base for derived figures (percent, median, etc.) and meaning of symbols, see text]

Miami	Neighborhood 01				Neighborhood 02				Neighborhood 03			Persons of Spanish language
	All races	White	Negro	Persons of Spanish language	All races	White	Negro	Persons of Spanish language	All races	White	Negro	
PERSONS 16 TO 21 YEARS OLD NOT IN SCHOOL—Con.												
Income Below Poverty Level												
Male	215	34	181	7	124	48	76	42	172	85	87	76
Not high school graduate	148	27	121	7	93	43	50	37	129	73	56	63
Employed or in Armed Forces	81	6	75	—	60	37	23	37	57	41	16	41
Unemployed	—	—	—	—	6	—	6	—	15	8	7	8
Not in labor force	67	21	46	7	27	6	21	5	57	24	33	14
High school graduate	67	7	60	—	31	5	26	—	43	12	31	13
Employed or in Armed Forces	32	—	32	—	5	—	5	—	39	8	31	9
Unemployed	—	—	—	—	21	—	21	—	4	4	—	4
Not in labor force	35	7	28	—	5	5	—	—	—	—	—	—
Female	475	56	411	42	193	112	81	75	260	99	161	45
Not high school graduate	270	29	233	22	118	77	41	50	158	29	129	22
Employed or in Armed Forces	71	6	65	6	49	41	8	24	34	7	27	7
Unemployed	16	—	16	—	17	10	7	—	22	3	19	3
Not in labor force	183	23	152	16	52	26	26	26	102	19	83	12
High school graduate	205	27	178	20	75	35	40	25	102	70	32	23
Employed or in Armed Forces	111	16	95	9	29	17	12	17	47	29	18	—
Unemployed	10	—	10	—	10	10	—	—	3	3	—	3
Not in labor force	84	11	73	11	36	8	28	8	52	38	14	20
MARRIED COUPLES AND CHILDREN												
All Income Levels												
Married couples	7 640	2 814	4 798	1 420	5 035	3 641	1 360	2 791	5 800	3 928	1 851	2 551
With own household	7 447	2 744	4 675	1 352	4 766	3 412	1 320	2 591	5 675	3 842	1 812	2 477
Without own household	193	70	123	68	269	229	40	200	125	86	39	74
With own children under 18 yr	4 143	1 045	3 085	887	2 815	2 054	746	1 774	2 236	1 204	1 023	1 161
With own children under 6 yr	2 172	483	1 682	397	1 395	960	428	844	1 349	635	714	621
With husband under 45 years	4 219	1 061	3 144	817	2 542	1 720	800	1 385	2 626	1 368	1 258	1 182
With own children under 18 yr	3 190	729	2 454	614	1 889	1 331	543	1 179	1 735	838	897	850
Related child, under 18 yr	16 353	2 757	13 559	2 439	8 828	4 883	3 922	4 400	7 570	2 626	4 909	2 533
Living with both parents	9 704	2 050	7 627	1 940	5 868	4 016	1 835	3 585	4 576	1 990	2 551	1 962
Percent living with both parents	59.3	74.4	56.3	79.5	66.5	82.2	46.8	61.5	60.4	75.8	52.0	77.5
Living with mother only	5 037	582	4 445	334	2 112	633	1 473	578	2 164	326	1 838	280
Living with father only	401	68	333	49	365	62	303	62	282	149	133	148
Living with neither parent	1 211	57	1 154	116	483	172	311	175	548	161	387	143
Income Below Poverty Level												
Related child, under 18 yr	5 789	658	5 131	635	3 136	1 253	1 866	1 289	3 298	983	2 304	986
Living with both parents	2 228	360	1 868	422	1 410	873	520	894	1 380	578	793	617
Percent living with both parents	38.5	54.7	36.4	66.5	45.0	69.7	27.9	69.4	41.9	58.8	34.4	62.6
Living with mother only	2 895	278	2 617	180	1 313	314	999	329	1 469	235	1 234	198
Living with father only	143	—	143	—	219	16	203	16	132	104	28	114
Living with neither parent	523	20	503	33	194	50	144	50	315	66	249	57
FERTILITY BY AGE OF WOMAN												
All Income Levels												
Women ever married:												
15 to 24 years	1 561	357	1 204	179	726	359	353	238	906	302	594	200
25 to 34 years	2 849	537	2 289	440	1 652	1 017	627	894	1 847	972	860	848
35 to 44 years	2 626	670	1 944	475	1 810	1 144	666	929	1 590	865	706	690
Children ever born per 1,000 women ever married:												
15 to 24 years	1 420	1 216	1 481	1 335	1 225	833	1 603	1 071	1 260	397	1 721	565
25 to 34 years	2 578	2 300	2 652	2 293	2 372	1 929	3 094	1 980	2 096	1 546	2 736	1 607
35 to 44 years	2 852	1 928	3 168	2 091	2 659	2 369	3 156	2 477	2 209	1 780	2 769	1 872
Income Below Poverty Level												
Women ever married:												
15 to 24 years	341	52	289	31	197	98	99	67	248	77	171	39
25 to 34 years	736	110	626	86	494	254	232	251	506	259	239	228
35 to 44 years	767	130	632	93	482	253	229	231	420	221	192	182
Children ever born per 1,000 women ever married:												
15 to 24 years	2 006	...	1 990	...	1 563	1 726	...	2 316	...
25 to 34 years	3 101	...	3 153	...	3 095	2 587	3 690	2 498	3 043	2 131	4 067	2 127
35 to 44 years	3 490	...	3 671	...	3 048	2 059	4 140	2 177	3 326	2 801	4 052	2 692

Table A-3. Employment Characteristics of the Population by Residence in Census Tracts With a Poverty Rate of 20 Percent or More: 1970

[Excludes inmates of institutions, members of Armed Forces living in barracks, college students living in dormitories, and unrelated individuals under 14 years. Data based on 15 percent sample, see text. For minimum base for derived figures (percent, median, etc.) and meaning of symbols, see text]

Miami	Neighborhood 01				Neighborhood 02				Neighborhood 03			
	All races	White	Negro	Persons of Spanish language	All races	White	Negro	Persons of Spanish language	All races	White	Negro	Persons of Spanish language
EMPLOYMENT STATUS												
All Income Levels												
Male												
Total, 16 years old and over	13 689	4 768	8 874	2 077	9 029	5 994	2 984	4 171	13 922	9 445	4 432	4 503
Armed Forces	B	8	-	-	-	-	-	-	18	-	-	-
Civilian labor force	9 859	3 074	6 751	1 594	6 894	4 604	2 242	3 429	9 571	6 221	3 335	3 565
Employed	9 429	2 919	6 488	1 554	6 566	4 432	2 095	3 297	9 026	5 954	3 066	3 394
At work	8 941	2 796	6 123	1 507	6 328	4 249	2 040	3 169	8 649	5 732	2 931	3 254
Full time	7 698	2 443	5 233	1 339	5 576	3 853	1 690	2 880	7 549	5 079	2 470	2 981
With a job but not at work	488	123	365	47	238	183	55	128	357	222	135	142
Unemployed	430	155	263	40	328	172	147	132	545	267	269	169
Percent unemployed	4.4	5.0	3.9	2.5	4.8	3.7	3.8	3.6	5.7	4.3	8.1	4.7
Not in labor force	3 822	1 686	2 123	483	2 135	1 390	742	742	4 333	3 224	1 079	937
Enrolled in school	828	197	618	141	447	306	141	192	370	161	193	139
Other	2 994	1 489	1 505	342	1 688	1 084	601	550	3 963	3 063	886	798
65 years old and over	1 471	953	518	154	869	614	252	248	2 336	2 046	276	382
16 to 24 years old¹	2 942	729	2 194	433	1 449	899	541	683	1 738	781	941	558
Employed	1 577	451	1 126	274	821	509	312	423	1 059	513	546	342
Unemployed	178	21	151	-	83	33	41	33	140	39	101	45
Not in labor force	1 179	249	917	159	545	357	188	227	521	229	276	171
25 to 64 years old¹	8 821	2 804	5 995	1 475	6 400	4 227	2 134	3 095	9 064	5 971	3 078	3 330
Employed	7 424	2 207	5 195	1 265	5 454	3 689	1 726	2 739	7 221	4 832	2 383	2 831
Unemployed	225	113	112	40	225	119	106	89	375	198	168	115
Not in labor force	1 172	484	688	170	721	419	302	267	1 468	941	527	384
Family head, 25 to 64 years old¹	6 209	2 002	4 185	1 245	4 200	2 983	1 189	2 398	4 528	2 941	1 572	2 254
Employed	5 458	1 681	3 755	1 114	3 799	2 713	1 058	2 185	3 846	2 518	1 322	1 939
Unemployed	143	62	81	35	121	86	35	78	121	84	28	76
Not in labor force	608	259	349	96	280	184	96	135	561	339	222	239
Female												
Total, 16 years old and over	17 252	5 722	11 450	2 308	10 144	6 692	3 394	4 558	13 709	8 979	4 630	5 087
Civilian labor force	8 956	2 341	6 543	1 118	5 042	3 055	1 962	2 240	6 375	3 831	2 501	2 276
Employed	8 557	2 220	6 277	1 041	4 737	2 841	1 884	2 060	6 072	3 643	2 386	2 154
At work	8 147	2 158	5 929	1 013	4 519	2 744	1 763	1 992	5 733	3 500	2 190	2 097
Full time	6 228	1 749	4 438	823	3 435	2 146	1 289	1 573	4 425	2 769	1 621	1 665
With a job but not at work	410	62	348	28	218	97	78	68	339	143	196	57
Unemployed	399	121	266	77	305	214	121	180	303	188	115	122
Percent unemployed	4.5	5.2	4.1	6.9	6.0	7.0	4.0	8.0	4.8	4.9	4.6	5.4
Not in civilian labor force	8 296	3 381	4 907	1 190	5 102	3 637	1 432	2 318	7 334	5 148	2 129	2 731
Enrolled in school	1 104	180	924	164	642	426	208	228	412	248	164	195
Other	7 192	3 201	3 983	1 026	4 460	3 211	1 224	2 090	6 922	4 900	1 965	2 536
65 years old and over	2 370	1 543	827	242	1 225	1 029	191	446	2 730	2 308	396	779
With own children under 6 years old	3 153	577	2 565	424	1 717	1 020	697	901	1 865	643	1 214	626
Percent in civilian labor force	58.1	48.9	60.0	41.3	48.2	39.6	60.8	38.7	52.2	36.9	60.6	37.3
With own children 6 to 17 years old	4 747	929	3 778	763	2 835	1 764	1 063	1 557	2 236	994	1 236	905
Percent in civilian labor force	67.5	61.2	68.6	57.0	65.4	51.1	65.6	52.5	62.7	56.9	67.1	56.1
16 to 24 years old	3 810	776	3 026	455	1 963	1 161	781	761	1 954	944	1 000	692
Employed	1 913	440	1 473	218	898	532	359	352	990	519	461	373
Unemployed	135	24	111	-	81	50	25	27	78	11	67	11
Not in civilian labor force	1 762	312	1 442	237	984	579	397	382	886	414	472	308
25 to 64 years old	10 739	3 271	7 463	1 591	6 692	4 350	2 322	3 289	8 636	5 446	3 126	3 467
Employed	6 346	1 672	4 621	803	3 600	2 175	1 425	1 653	4 716	2 866	1 817	1 719
Unemployed	250	89	149	77	212	159	53	146	208	160	48	104
Not in civilian labor force	4 143	1 510	2 633	711	2 880	2 016	844	1 490	3 712	2 420	1 261	1 644
Family head, 25 to 64 years old	2 327	412	1 887	184	984	409	568	335	1 247	540	707	330
Employed	1 651	280	1 355	118	669	263	406	209	896	360	536	221
Unemployed	86	11	63	23	24	5	19	5	41	36	5	2
Not in civilian labor force	590	121	469	43	291	141	143	121	310	144	166	107
Wife of head, 25 to 64 years old	5 648	1 897	3 733	1 069	3 800	2 726	1 066	2 187	4 309	2 829	1 444	2 040
Employed	2 970	870	2 082	528	1 863	1 272	591	1 061	2 011	1 272	718	924
Unemployed	141	60	81	48	110	82	28	88	78	62	16	48
Not in civilian labor force	2 537	967	1 570	493	1 827	1 372	447	1 038	2 220	1 495	710	1 068
Income Below Poverty Level												
Male												
Total, 16 years old and over	3 036	886	2 150	433	1 970	1 139	831	836	3 411	2 305	1 106	1 131
Armed Forces	-	-	-	-	-	-	-	-	18	-	-	-
Civilian labor force	1 440	307	1 133	223	1 077	642	435	567	1 502	962	540	658
Employed	1 329	273	1 056	200	978	598	380	540	1 331	895	436	607
At work	1 253	247	1 006	190	965	598	367	540	1 264	858	406	574
Full time	990	211	779	162	782	526	256	490	948	674	274	466
Unemployed	111	34	77	23	99	44	55	27	171	67	104	49
Percent unemployed	7.7	11.1	6.8	10.3	9.2	6.9	12.6	4.8	11.4	7.0	19.3	7.5
Not in labor force	1 596	579	1 017	210	893	497	396	269	1 891	1 343	542	475
Enrolled in school	342	65	277	52	138	73	65	47	120	59	61	49
Other	1 254	514	740	158	755	424	331	222	1 771	1 284	481	426
65 years old and over	550	304	246	83	389	244	145	106	961	782	173	183

¹Includes members of Armed Forces not living in barracks and not shown separately.

Table A-3. Employment Characteristics of the Population by Residence in Census Tracts With a Poverty Rate of 20 Percent or More: 1970—Continued

(Excludes inmates of institutions, members of Armed Forces living in barracks, college students living in dormitories, and unrelated individuals under 14 years. Data based on 15-percent sample, see text. For minimum base for derived figures (percent, median, etc.) and meaning of symbols, see text)

Miami	Neighborhood 01				Neighborhood 02				Neighborhood 03			
	All races	White	Negro	Persons of Spanish language	All races	White	Negro	Persons of Spanish language	All races	White	Negro	Persons of Spanish language
EMPLOYMENT STATUS—Continued												
Income Below Poverty Level—Con.												
Male—Continued												
16 to 24 years old ¹	762	136	626	82	346	156	190	117	510	230	280	189
Employed	230	37	193	17	167	81	86	68	250	129	121	108
Unemployed	45	—	45	—	27	—	27	—	48	14	34	14
Not in labor force	487	99	388	65	152	75	77	49	194	87	107	67
25 to 64 years old ¹	1 683	429	1 254	263	1 183	704	479	580	1 829	1 198	631	719
Employed	1 058	219	839	178	769	492	277	449	970	671	299	459
Unemployed	66	34	32	23	62	34	28	17	123	53	70	35
Not in labor force	559	176	383	62	352	178	174	114	736	474	262	225
Family head, 25 to 64 years old ¹	1 037	240	797	208	694	467	227	455	792	505	287	468
Employed	757	148	609	154	551	373	178	376	487	307	180	303
Unemployed	41	24	17	18	33	25	8	17	53	34	19	28
Not in labor force	239	68	171	36	110	69	41	62	252	164	88	137
Female												
Total, 16 years old and over	5 135	1 461	3 661	558	3 027	1 773	1 246	1 180	4 251	2 567	1 643	1 445
Civilian labor force	1 831	339	1 487	169	1 074	493	581	342	1 325	606	712	413
Employed	1 661	278	1 378	142	965	423	542	321	1 208	532	669	372
At work	1 542	259	1 278	136	898	423	475	321	1 121	493	621	349
Full time	1 027	175	847	101	538	256	282	214	779	382	390	298
With a job but not at work	119	19	100	6	67	70	39	21	117	74	43	23
Unemployed	170	61	109	27	109	14.2	6.7	6.1	8.8	12.2	6.0	9.9
Percent unemployed	9.3	18.0	7.3	16.0	10.1	10.1	6.7	6.1	8.8	12.2	6.0	9.9
Not in civilian labor force	3 304	1 122	2 174	389	1 953	1 250	79	84	99	40	59	28
Enrolled in school	332	20	312	32	309	230	586	754	2 827	1 921	872	1 004
Other	2 972	1 102	1 862	357	1 644	1 050	395	118	1 378	1 085	267	440
65 years old and over	1 027	616	411	85	513	395	118	187	1 378	1 085	267	440
With own children under 6 years old	937	124	808	108	499	284	215	279	670	204	458	201
Percent in civilian labor force	48.1	—	49.4	—	41.5	31.7	54.4	32.3	51.3	32.8	60.5	31.8
With own children 6 to 17 years old	1 389	189	1 195	162	845	390	447	403	845	319	526	276
Percent in civilian labor force	59.5	44.4	61.7	34.6	47.9	32.1	62.6	32.8	58.7	52.4	62.5	49.3
16 to 24 years old	1 033	130	895	102	675	431	244	200	547	207	340	115
Employed	317	57	260	31	217	137	80	66	219	85	134	30
Unemployed	48	14	34	—	36	29	7	—	32	6	26	6
Not in civilian labor force	668	59	601	71	422	265	157	134	296	116	180	79
25 to 64 years old	2 977	672	2 300	362	1 775	921	846	785	2 253	1 241	997	877
Employed	1 259	186	1 068	102	702	278	424	247	916	413	496	329
Unemployed	114	39	75	27	68	36	32	21	85	68	17	35
Not in civilian labor force	1 604	447	1 157	233	1 005	607	390	517	1 252	760	484	513
Family head, 25 to 64 years old	1 090	133	952	65	473	164	309	155	569	194	375	138
Employed	657	62	590	31	257	77	180	77	338	94	244	69
Unemployed	49	11	38	11	19	—	19	—	30	25	5	—
Not in civilian labor force	384	60	324	23	197	87	110	78	201	75	126	69
Wife of head, 25 to 64 years old	987	261	726	206	663	439	216	432	780	493	272	424
Employed	296	54	242	57	217	125	92	125	251	138	106	140
Unemployed	48	16	32	16	15	8	8	8	20	14	6	14
Not in civilian labor force	643	191	452	133	431	306	117	299	509	341	160	270
PLACE OF WORK												
All workers ²	17 198	4 999	12 117	2 552	10 935	7 035	3 849	5 189	14 447	9 232	5 166	5 351
Inside SMSA of residence	14 498	4 374	10 057	2 300	9 314	6 135	3 128	4 541	12 171	8 067	4 068	4 897
In county of residence	14 498	4 374	10 057	2 300	9 314	6 135	3 128	4 541	12 171	8 067	4 068	4 897
In central city	7 847	2 505	5 294	1 274	5 565	3 635	1 890	2 479	7 972	5 300	2 650	2 955
Outside county of residence	—	—	—	—	—	—	—	—	—	—	—	—
In central city	—	—	—	—	—	—	—	—	—	—	—	—
Outside SMSA of residence	296	102	194	51	271	200	71	180	336	203	133	140
Workers below poverty level ²	2 823	515	2 303	326	1 907	1 027	880	861	2 417	1 351	1 059	923
Inside SMSA of residence	2 320	432	1 883	301	1 578	911	667	755	2 005	1 202	803	846
In county of residence	2 320	432	1 883	301	1 578	911	667	755	2 005	1 202	803	846
In central city	1 251	232	1 014	157	982	602	380	476	1 385	907	478	543
Outside county of residence	—	—	—	—	—	—	—	—	—	—	—	—
In central city	—	—	—	—	—	—	—	—	—	—	—	—
Outside SMSA of residence	31	7	24	7	36	31	5	31	56	—	56	—
MEANS OF TRANSPORTATION TO WORK												
All workers	17 198	4 999	12 117	2 552	10 935	7 035	3 849	5 189	14 447	9 232	5 166	5 351
Private automobile, driver	8 949	3 029	5 869	1 414	5 654	4 097	1 536	2 986	5 729	3 962	1 743	2 307
Private automobile, passenger	2 369	643	1 695	423	1 452	1 115	330	961	1 776	1 091	660	842
Bus, streetcar, or subway	4 774	934	3 840	525	2 261	798	1 445	658	4 230	2 250	1 980	1 459
Walked only	603	212	391	74	1 210	774	431	430	1 869	1 323	546	91
Worked at home	146	73	73	53	131	116	15	69	471	386	85	91
Other means	357	108	249	63	227	135	92	85	372	220	152	88
Workers below poverty level	2 823	515	2 303	326	1 907	1 027	880	861	2 417	1 351	1 059	923
Private automobile, driver	1 098	275	823	176	660	418	242	371	714	457	257	359
Private automobile, passenger	358	52	301	42	185	116	69	91	185	96	82	111
Bus, streetcar, or subway	1 124	123	1 001	69	633	200	433	188	794	350	444	294
Walked only	146	52	94	33	332	209	123	140	471	274	197	110
Worked at home	51	13	38	6	65	59	6	52	136	103	33	20
Other means	46	—	46	—	32	25	7	19	117	71	46	29

¹Includes members of Armed Forces not living in barracks and not shown separately. ²Includes "Place of work not reported" not shown separately.

Table A-4. Selected Occupations of Employed Persons by Residence in Census Tracts With a Poverty Rate of 20 Percent or More: 1970

(Excludes inmates of institutions, members of Armed Forces living in barracks, college students living in dormitories, and unrelated individuals under 14 years. Data based on 15-percent sample, see text. For minimum base for derived figures (percent, median, etc.) and meaning of symbols, see text)

Miami	Neighborhood 01				Neighborhood 02				Neighborhood 03			
	All races	White	Negro	Persons of Spanish language	All races	White	Negro	Persons of Spanish language	All races	White	Negro	Persons of Spanish language
ALL INCOME LEVELS												
Total employed, 16 yr. & over ¹	17 986	5 139	12 765	2 595	11 303	7 273	3 979	5 357	15 098	9 597	5 452	5 550
Prof., tech., and kindred workers	1 112	286	802	91	867	759	103	225	980	794	186	375
Health workers, except practitioners	229	60	158	30	210	186	24	32	99	86	13	35
Teachers, elem. and secondary	367	30	337	11	94	58	36	11	208	135	73	77
Managers and admin., exc. farm	469	228	241	66	299	219	80	85	767	688	79	213
Self-employed	102	40	62	-	53	45	8	32	195	157	38	65
Sales workers	722	360	362	106	407	313	94	202	906	797	109	345
Retail trade	482	228	254	75	208	151	57	107	495	418	77	206
Clerical and kindred workers	2 646	1 024	1 615	358	1 144	850	294	523	2 111	1 596	491	677
Postal clerks and mail carriers	130	15	115	-	41	8	33	-	60	28	32	-
Shipping, receiving, and stock clerks	275	64	211	35	122	105	17	105	149	89	60	48
Bkpr., cashiers, & bank tellers	502	254	248	106	208	183	25	101	389	276	105	127
Craftsmen and kindred workers	1 956	879	1 077	437	1 332	1 119	206	847	1 559	1 122	437	650
Construction craftsmen	629	248	381	121	471	403	61	341	543	329	214	228
Mechanics and repairmen	477	251	226	139	234	207	27	156	336	263	73	175
Operatives, except transport	2 091	891	1 176	698	2 543	2 013	516	1 843	2 087	1 594	487	1 381
Assemblers	130	76	54	63	63	56	7	49	76	70	6	65
Checkers, exam., & inspectors; mfg.	35	19	16	12	25	21	4	14	41	34	7	34
Pkrs. & wrappers, inc. meat & prod.	147	64	83	66	134	119	15	105	102	94	8	87
Sewers, stitchers, & textile oper.	244	182	45	171	584	555	29	561	421	391	30	394
Transport equipment operatives	1 297	194	1 103	131	508	185	316	131	696	322	374	187
Truck drivers	387	54	333	52	280	98	182	48	197	72	125	45
Laborers, except farm	1 886	197	1 689	113	1 323	527	796	435	1 405	474	931	314
Construction	499	48	451	32	419	222	197	191	285	57	228	71
Freight, material, and stock handlers	498	49	449	21	331	97	234	78	405	140	265	41
Service workers, exc. private hshld. ²	4 014	997	2 998	529	2 180	1 187	986	970	3 630	2 134	1 484	1 298
Cleaning service workers	1 233	233	993	162	791	303	488	278	1 086	507	579	404
Food service workers	1 121	344	765	214	733	538	188	502	1 349	947	396	554
Health service workers	727	115	612	47	201	56	145	30	262	59	197	48
Personal service workers	327	113	214	56	142	121	21	77	461	358	103	219
Protective service workers	149	58	91	-	75	68	7	14	96	66	30	22
Private household workers	1 678	45	1 633	39	635	67	563	56	924	50	867	84
Female employed, 16 yr. & over¹	8 557	2 220	6 277	1 041	4 737	2 841	1 884	2 060	6 072	3 643	2 386	2 154
Prof., tech., and kindred workers	666	159	490	56	346	281	65	43	392	283	109	115
Health workers, except practitioners	202	55	136	25	157	139	18	12	75	62	13	19
Teachers, elem. and secondary	253	23	230	11	81	52	29	5	118	60	58	22
Managers and admin., exc. farm	89	61	28	7	47	36	11	-	206	190	16	21
Self-employed	7	7	-	-	6	6	-	-	39	39	-	-
Sales workers	323	149	174	42	159	109	50	85	337	293	44	135
Retail trade	258	128	130	36	122	72	50	58	243	199	44	98
Clerical and kindred workers	1 980	753	1 220	212	744	521	223	284	1 458	1 110	324	486
Bkpr., cashiers, & bank tellers	418	215	203	83	142	117	25	48	307	200	99	84
Secretaries, steno., & typists	466	194	272	20	197	149	48	75	541	491	34	184
Craftsmen and kindred workers	141	36	105	17	107	93	14	62	64	64	-	47
Operatives, except transport	1 120	522	581	439	1 578	1 264	314	1 186	1 167	943	218	837
Laundry & dry cleaning operatives ³	311	37	274	45	321	134	187	129	257	112	145	106
Assemblers	69	34	35	27	37	30	7	30	16	16	-	16
Pkrs. & wrappers, inc. meat & prod.	101	53	48	46	68	68	-	68	58	58	-	58
Sewers, stitchers, & textile oper.	237	182	38	171	569	540	29	546	398	368	30	371
Transport equipment operatives	110	8	102	8	17	-	17	-	19	7	12	7
Laborers, except farm	116	17	99	4	59	34	25	34	81	40	41	40
Service workers, exc. private hshld. ⁴	2 379	470	1 890	217	1 053	444	602	318	1 465	663	796	388
Cleaning service workers	589	93	489	64	425	138	287	127	524	220	304	174
Food service workers	657	160	485	63	231	125	99	97	388	228	154	88
Health service workers	646	89	557	27	182	43	139	24	229	47	182	30
Personal service workers	194	67	127	35	72	58	14	31	167	123	44	82
Private household workers	1 619	45	1 574	39	627	59	563	48	883	50	826	78
INCOME BELOW POVERTY LEVEL												
Total employed, 16 yr. & over ¹	2 990	551	2 434	342	1 943	1 021	922	861	2 539	1 427	1 105	979
Prof., tech., and kindred workers	60	-	60	-	60	53	7	22	92	68	24	33
Managers and admin., exc. farm	60	46	14	6	31	16	15	16	126	109	17	43
Sales workers	104	43	61	12	49	42	7	22	102	86	16	61
Clerical and kindred workers	355	62	293	46	170	133	37	77	235	121	114	68
Craftsmen and kindred workers	253	47	206	46	136	105	31	105	160	141	19	70
Operatives, except transport	401	144	257	126	424	311	113	305	345	240	105	230
Transport equipment operatives	184	10	174	10	63	35	28	35	129	87	42	56
Laborers, except farm	311	26	285	20	269	103	166	98	269	142	127	113
Service workers, exc. private hshld.	789	165	619	92	483	185	298	165	784	416	368	268
Private household workers	446	8	438	-	242	29	213	7	291	11	273	31
Female employed, 16 yr. & over¹	1 661	278	1 378	142	965	423	542	321	1 208	532	669	372
Prof., tech., and kindred workers	32	-	32	-	24	24	-	-	24	24	-	10
Managers and admin., exc. farm	24	24	-	-	-	-	-	-	41	41	-	8
Sales workers	69	14	55	-	28	21	7	13	58	42	16	25
Clerical and kindred workers	285	42	243	16	105	76	29	36	159	86	73	51
Craftsmen and kindred workers	20	4	16	4	15	15	-	15	-	-	-	-
Operatives, except transport	215	72	143	67	262	192	70	192	212	161	51	144
Transport equipment operatives	6	-	6	-	-	-	-	-	14	7	7	7
Laborers, except farm	28	4	24	4	26	8	18	8	20	7	13	7
Service workers, exc. private hshld.	536	110	421	51	263	58	205	50	397	153	244	89
Private household workers	446	8	438	-	242	29	213	7	283	11	265	31

¹Includes "farm workers" not shown separately, included in total but not in distribution. ²Allocated cases included in total but not in distribution. ³Includes "clothing ironers and pressers." ⁴"Protective service workers" and allocated cases included in total but not in distribution.

Table A-5. Income Characteristics in 1969 of Families and Unrelated Individuals by Residence in Census Tracts With a Poverty Rate of 20 Percent or More: 1970

[Excludes inmates of institutions, members of Armed Forces living in barracks, college students living in dormitories, and unrelated individuals under 14 years. Data based on 15-percent sample, see text. For minimum base for derived figures (percent, median, etc.) and meaning of symbols, see text]

Miami	Neighborhood O1				Neighborhood O2				Neighborhood O3			
	All races	White	Negro	Persons of Spanish language	All races	White	Negro	Persons of Spanish language	All races	White	Negro	Persons of Spanish language
INCOME OF FAMILIES AND UNRELATED INDIVIDUALS	10 908	3 492	7 353	1 636	6 472	4 197	2 229	3 154	7 701	4 822	2 850	3 123
All families	10 908	3 492	7 353	1 636	6 472	4 197	2 229	3 154	7 701	4 822	2 850	3 123
Less than \$2,000	1 389	369	1 020	217	767	414	345	368	985	606	365	468
\$2,000 to \$3,999	2 058	645	1 399	258	1 107	579	521	467	1 548	829	719	561
\$4,000 to \$5,999	2 101	733	1 340	333	1 355	812	529	681	1 763	1 016	741	759
\$6,000 to \$7,999	1 860	583	1 270	307	1 221	795	421	569	1 205	740	465	555
\$8,000 to \$9,999	1 270	438	825	233	760	534	226	365	682	399	283	225
\$10,000 to \$11,999	950	293	657	153	533	430	94	320	576	385	182	232
\$12,000 to \$14,999	667	182	485	65	330	283	47	196	418	361	57	164
\$15,000 to \$19,999	440	160	273	47	269	233	36	134	256	247	9	60
\$20,000 to \$24,999	113	63	50	12	74	70	4	35	108	90	18	36
\$25,000 or more	60	26	34	11	56	47	6	19	160	149	11	63
Median family income	\$5 911	\$5 997	\$5 877	\$6 085	\$6 011	\$6 738	\$4 940	\$6 214	\$5 495	\$5 921	\$4 920	\$5 403
Mean family income	\$6 620	\$6 942	\$6 469	\$6 599	\$6 837	\$7 593	\$5 374	\$6 980	\$6 894	\$7 766	\$5 437	\$6 386
Families with female head	2 993	598	2 360	229	1 257	511	739	379	1 603	698	897	447
Less than \$1,000	394	48	346	43	163	59	104	60	183	79	104	84
\$1,000 to \$1,999	329	79	250	33	158	70	88	59	225	103	114	84
\$2,000 to \$2,999	496	113	383	35	224	53	171	42	311	103	208	79
\$3,000 to \$3,999	461	95	366	31	171	66	98	57	335	126	209	67
\$4,000 to \$5,999	339	68	264	17	114	81	33	20	127	68	59	34
\$6,000 to \$7,999	137	32	105	9	96	29	67	17	64	28	36	22
\$8,000 to \$9,999	239	69	170	15	41	26	15	7	84	80	4	39
\$10,000 to \$14,999	73	22	51	5	24	16	8	—	45	39	6	25
\$15,000 and over	\$3 602	\$3 621	\$3 549	\$3 113	\$3 488	\$4 135	\$3 066	\$3 500	\$3 529	\$3 922	\$3 353	\$3 538
Median family income	\$4 547	\$5 130	\$4 392	\$4 027	\$4 165	\$4 728	\$3 787	\$3 952	\$4 353	\$5 353	\$3 603	\$4 929
Mean family income	\$5 540	\$2 491	\$3 042	\$2 268	\$3 920	\$2 280	\$1 623	\$1 615	\$2 234	\$7 420	\$2 794	\$1 949
All unrelated individuals	5 412	2 491	801	110	1 199	773	426	105	2 051	1 452	599	535
Less than \$1,000	1 412	611	801	110	731	359	372	105	2 055	1 471	584	343
\$1,000 to \$1,999	1 165	585	580	23	381	134	247	34	1 703	1 128	561	298
\$2,000 to \$2,999	846	349	497	40	451	215	191	89	1 272	851	421	256
\$3,000 to \$3,999	591	208	383	15	451	215	191	89	1 565	1 184	381	315
\$4,000 to \$5,999	757	320	430	47	518	320	117	71	810	609	195	20
\$6,000 to \$7,999	435	187	248	16	310	188	22	51	228	192	36	14
\$8,000 to \$9,999	167	107	60	7	155	133	17	7	314	306	8	40
\$10,000 to \$14,999	110	44	13	—	49	109	—	—	236	227	9	22
\$15,000 and over	\$2 228	\$2 142	\$2 282	\$2 025	\$2 079	\$2 060	\$2 055	\$2 809	\$2 594	\$2 698	\$2 381	\$2 324
Median income	\$3 210	\$3 602	\$2 885	\$2 576	\$3 044	\$3 440	\$2 468	\$3 195	\$3 553	\$3 886	\$2 668	\$2 963
Mean income												
TYPE OF INCOME FOR FAMILIES AND UNRELATED INDIVIDUALS	10 908	3 492	7 353	1 636	6 472	4 197	2 229	3 154	7 701	4 822	2 850	3 123
All families	10 908	3 492	7 353	1 636	6 472	4 197	2 229	3 154	7 701	4 822	2 850	3 123
With earnings	9 605	2 858	6 684	1 491	5 792	3 745	2 009	2 887	6 582	3 972	2 595	2 725
Mean earnings	\$6 755	\$7 123	\$6 602	\$6 828	\$6 911	\$7 674	\$5 426	\$7 289	\$6 905	\$7 765	\$5 577	\$6 643
Percent below poverty level	20.2	11.2	24.2	16.2	19.3	14.2	29.0	17.9	18.7	14.4	25.4	18.3
Head 65 years and over	847	431	403	55	522	387	132	199	646	670	74	208
Mean earnings	\$5 500	\$5 779	\$5 217	\$5 630	\$6 211	\$6 211	\$2 684	\$8 502	\$6 322	\$6 672	...	\$4 248
With Social Security income	2 247	1 069	1 172	190	1 106	752	351	331	1 512	1 153	353	335
Mean Social Security income	\$1 395	\$1 467	\$1 336	\$1 002	\$1 287	\$1 260	\$1 339	\$802	\$1 425	\$1 468	\$1 282	\$1 016
Percent below poverty level	23.2	18.3	27.7	18.4	24.6	18.4	38.2	29.9	23.2	18.9	36.0	20.0
Head 65 years and over	1 128	694	428	70	554	363	188	82	918	793	119	169
Mean Social Security income	\$1 692	\$1 729	\$1 654	...	\$1 695	\$1 760	\$1 565	...	\$1 629	\$1 651	...	\$1 326
With public assistance income	1 483	415	1 063	262	960	535	420	481	1 108	640	460	579
Mean public assistance income	\$862	\$908	\$844	\$806	\$871	\$868	\$871	\$891	\$980	\$1 084	\$831	\$1 079
Percent below poverty level	46.4	30.4	52.4	35.5	46.5	38.5	57.1	41.6	46.1	44.5	47.4	48.2
Head 65 years and over	322	148	174	66	245	135	110	112	295	239	48	195
Mean public assistance income	\$910	\$1 076	\$768	...	\$1 100	\$1 270	\$1 185	\$1 232	...	\$1 345
With other income	1 886	1 152	727	...	\$2 037	\$2 185	\$1 435	\$871	\$2 875	\$3 257	\$784	\$2 632
Mean other income	\$1 545	\$1 683	\$1 341	\$865	\$2 037	\$2 185	\$1 435	\$871	\$2 875	\$3 257	\$784	\$2 632
Percent below poverty level	15.9	10.1	25.3	11.7	12.0	7.0	36.3	11.3	8.6	6.3	21.1	5.4
Head 65 years and over	660	550	110	31	318	275	43	51	613	589	24	72
Mean other income	\$1 958	\$2 077	\$2 287	\$2 334	\$4 784	\$4 919
Families with female head	2 993	598	2 360	229	1 257	511	739	379	1 603	698	897	447
With earnings	2 552	497	2 020	193	1 046	406	633	282	1 328	547	781	349
Mean earnings	\$4 533	\$4 802	\$4 460	\$4 454	\$4 315	\$5 167	\$3 783	\$4 625	\$4 400	\$5 441	\$3 671	\$5 621
Percent below poverty level	40.0	26.8	43.8	35.2	37.9	20.0	49.8	26.6	39.1	27.8	47.0	34.7
Head 65 years and over	254	96	151	20	133	76	57	27	72	54	18	32
Mean earnings	\$4 813	...	\$4 942	...	\$4 787	291	181	110	61
With Social Security income	679	211	468	20	268	114	154	37	\$1 206	\$1 081
Mean Social Security income	\$1 268	\$1 179	\$943	...	\$928	...	31.6	24.3
Percent below poverty level	28.4	25.1	29.9	15	28.0	...	30.5	14	102	74	28	33
Head 65 years and over	245	113	132	15	113	63	50
Mean Social Security income	\$1 265	...	\$1 095
With public assistance income	745	102	638	41	400	145	255	127	365	131	226	103
Mean public assistance income	\$674	...	\$853	...	\$830	\$795	\$850	...	\$961	...	\$879	...
Percent below poverty level	62.7	...	64.9	...	62.5	55.9	66.3	...	50.4	...	55.3	...
Head 65 years and over	95	25	70	12	30	23	7	23	105	69	28	61
Mean public assistance income
With other income	374	168	206	24	130	79	51	33	\$2 493	\$2 956
Mean other income	\$1 524	\$1 854	\$1 256	26.4	22.4
Percent below poverty level	33.2	23.8	40.8	7	29	23	6	12	19
Head 65 years and over	113	71	42
Mean other income

Table A-5. Income Characteristics in 1969 of Families and Unrelated Individuals by Residence in Census Tracts With a Poverty Rate of 20 Percent or More: 1970—Continued

[Excludes inmates of institutions, members of Armed Forces living in barracks, college students living in dormitories, and unrelated individuals under 14 years. Data based on 15-percent sample, see text. For minimum base for derived figures (percent, median, etc.) and meaning of symbols, see text]

	Neighborhood 01				Neighborhood 02				Neighborhood 03			
	All races	White	Negro	Persons of Spanish language	All races	White	Negro	Persons of Spanish language	All races	White	Negro	Persons of Spanish language
Miami												
TYPE OF INCOME FOR FAMILIES AND UNRELATED INDIVIDUALS—Continued												
All unrelated individuals	5 540	2 491	3 042	268	3 920	2 280	1 623	615	10 234	7 420	2 794	1 949
With earnings	3 352	1 223	2 122	161	2 518	1 411	1 090	439	6 230	4 288	1 930	1 335
Mean earnings	\$4 031	\$4 861	\$3 549	\$4 051	\$3 976	\$4 582	\$3 178	\$4 046	\$4 278	\$4 709	\$3 319	\$3 744
Percent below poverty level	23.3	20.5	24.9	19.9	26.4	27.9	24.9	25.5	19.3	19.4	19.3	24.3
65 years and over	306	220	86	11	178	95	83	8	780	601	179	118
Mean earnings	\$3 615	\$4 249	\$2 274	\$2 701	\$2 778	\$2 442	...
Percent below poverty level	22.9	15.5	19.7	18.5	18.5	18.4	...
With Social Security income	1 780	1 235	545	17	765	499	266	59	3 072	2 483	581	175
Mean Social Security income	\$1 006	\$1 007	\$1 001	...	\$977	\$1 048	\$845	...	\$1 124	\$1 151	\$1 008	\$1 046
Percent below poverty level	58.0	49.4	77.6	...	59.6	57.7	63.2	...	47.2	45.1	56.8	45.1
65 years and over	1 353	1 014	339	11	643	454	189	44	2 541	2 132	401	125
Mean Social Security income	\$1 072	\$1 065	\$1 092	...	\$992	\$1 054	\$843	...	\$1 155	\$1 174	\$1 054	...
With public assistance income	496	135	361	24	356	148	208	70	1 004	601	403	242
Mean public assistance income	\$634	\$514	\$679	...	\$602	\$541	\$645	...	\$693	\$627	\$791	\$614
Percent below poverty level	74.2	74.8	74.0	...	78.1	85.8	72.6	...	74.2	84.9	63.3	90.9
65 years old and over	321	103	218	24	209	81	128	25	648	468	180	181
Mean public assistance income	\$412	...	\$637	...	\$553	\$702	\$685	\$744	\$639
With other income	1 282	1 027	255	28	830	681	149	94	2 488	2 274	206	256
Mean other income	\$1 690	\$1 668	\$1 777	...	\$1 155	\$1 138	\$1 235	...	\$2 237	\$2 379	\$704	\$1 739
Percent below poverty level	32.7	29.4	45.9	...	35.2	28.3	66.4	...	17.2	17.3	17.0	30.1
65 years old and over	690	662	28	7	255	239	16	21	1 321	1 248	65	100
Mean other income	\$1 901	\$1 964	\$1 454	\$1 512	\$2 368	\$2 429
WEEKS WORKED												
All Income Levels												
Male family heads												
Worked in 1969	7 915	2 894	4 993	1 407	5 215	3 686	1 490	2 775	6 098	4 124	1 953	2 676
50 to 52 weeks	6 593	2 192	4 373	1 257	4 531	3 239	1 264	2 544	4 894	3 168	1 711	2 224
40 to 49 weeks	4 108	1 353	2 727	820	2 726	1 829	888	1 408	2 917	1 891	1 020	1 371
27 to 39 weeks	1 754	466	1 288	299	1 143	867	271	761	1 226	732	485	510
26 weeks or less	286	163	123	51	251	205	46	174	307	162	145	85
Did not work in 1969	445	210	235	87	411	338	59	201	444	383	61	258
	1 322	702	620	150	684	447	226	231	1 204	956	242	452
Female family heads												
Worked in 1969	2 993	598	2 360	229	1 257	511	739	379	1 603	698	897	447
50 to 52 weeks	2 225	391	1 799	178	888	295	586	225	1 129	424	705	258
40 to 49 weeks	1 090	221	852	88	391	107	284	60	468	180	288	122
27 to 39 weeks	584	64	509	51	253	95	158	90	389	148	241	88
26 weeks or less	221	35	179	9	104	44	60	21	132	39	93	19
Did not work in 1969	330	71	259	30	140	49	84	54	140	57	83	29
	768	207	561	51	369	216	153	154	474	274	192	189
Income Below Poverty Level												
Male family heads												
Worked in 1969	1 361	400	961	255	984	625	351	587	1 170	775	389	617
50 to 52 weeks	840	177	663	177	637	427	210	424	617	372	245	330
40 to 49 weeks	429	56	373	65	255	125	130	138	225	124	101	118
Did not work in 1969	521	223	298	78	347	198	141	163	553	403	144	287
Female family heads												
Worked in 1969	1 385	196	1 184	104	581	181	400	167	727	246	473	184
50 to 52 weeks	916	112	799	63	353	61	292	66	449	100	349	69
40 to 49 weeks	346	32	309	21	110	12	98	12	137	33	104	27
Did not work in 1969	469	84	385	41	228	120	108	101	278	146	124	115
FAMILIES BY NUMBER OF EARNERS												
No earners	1 303	634	669	145	680	452	220	267	1 119	850	255	398
Mean family income	\$2 253	\$3 049	\$1 499	\$1 359	\$2 219	\$2 620	\$1 478	\$1 252	\$3 308	\$3 875	\$1 525	\$2 036
Percent below poverty level	61.6	43.4	78.9	80.7	66.2	60.6	76.4	88.8	59.4	52.7	79.6	76.1
1 earner	3 821	1 290	2 526	573	2 453	1 518	911	1 093	3 106	1 835	1 271	1 171
Mean family income	\$4 883	\$6 152	\$4 237	\$5 477	\$5 266	\$5 801	\$4 129	\$4 908	\$5 948	\$7 065	\$4 336	\$5 367
Percent below poverty level	33.2	16.4	41.7	25.1	32.4	25.5	44.8	34.3	29.3	22.3	39.4	30.6
2 earners	4 446	1 248	3 140	660	2 411	1 534	870	1 242	2 901	1 727	1 159	1 198
Mean family income	\$8 109	\$8 311	\$8 058	\$7 076	\$7 627	\$8 220	\$6 604	\$7 801	\$8 302	\$9 342	\$6 748	\$7 577
Percent below poverty level	12.8	7.8	15.1	12.9	11.4	8.1	17.4	9.2	9.8	8.6	11.8	10.4
3 or more earners	1 338	320	1 018	258	928	693	228	552	575	410	165	356
Mean family income	\$10 882	\$12 500	\$10 374	\$10 817	\$12 324	\$13 376	\$9 412	\$12 006	\$11 874	\$12 330	\$10 742	\$10 599
Percent below poverty level	7.8	4.1	8.9	5.0	4.8	3.0	10.5	5.1	6.3	3.7	12.7	4.2
SIZE OF FAMILY												
2 persons	3 850	1 866	1 962	422	2 128	1 408	704	737	3 833	2 794	1 025	1 250
Mean family income	\$5 387	\$5 874	\$4 919	\$4 720	\$5 555	\$6 286	\$4 036	\$5 317	\$6 703	\$7 425	\$4 808	\$5 086
Percent below poverty level	22.9	18.0	27.9	31.0	21.9	17.2	31.8	26.2	20.2	20.5	18.1	27.7
3 persons	2 258	587	1 635	317	1 327	823	487	667	1 490	897	587	802
Mean family income	\$7 198	\$7 642	\$7 044	\$6 038	\$6 733	\$7 077	\$5 892	\$6 201	\$6 524	\$7 690	\$4 749	\$6 807
Percent below poverty level	18.1	12.4	20.5	12.6	21.1	19.4	24.6	22.9	20.3	14.6	29.1	15.6
4 persons	1 736	498	1 238	425	1 170	814	343	711	993	598	395	538
Mean family income	\$7 392	\$7 838	\$7 213	\$7 486	\$7 728	\$8 511	\$6 065	\$7 800	\$6 752	\$7 114	\$6 230	\$6 938
Percent below poverty level	22.2	13.7	25.6	14.6	17.9	12.8	28.3	15.6	25.9	19.9	34.9	19.9
5 and 6 persons	2 031	423	1 603	355	1 359	912	447	827	1 068	430	629	430
Mean family income	\$6 995	\$8 622	\$6 575	\$7 268	\$7 518	\$8 478	\$5 557	\$7 494	\$8 163	\$10 803	\$6 324	\$8 121
Percent below poverty level	33.5	18.0	37.4	21.1	31.7	25.8	43.8	28.1	35.0	34.2	36.1	40.0
7 persons or more	1 033	118	915	117	488	240	248	212	317	103	214	103
Mean family income	\$7 913	...	\$7 574	...	\$8 683	\$10 563	\$6 864	\$10 456	\$7 076	...	\$6 261	...
Percent below poverty level	37.8	...	37.8	...	36.7	27.1	46.0	30.7	60.3	...	65.4	...

Table A-6. Persons by Family Status and Age and Families by Income Deficit by Residence in Census Tracts With a Poverty Rate of 20 Percent or More: 1970

[Excludes inmates of institutions, members of Armed Forces living in barracks, college students living in dormitories, and unrelated individuals under 14 years. Data based on 15-percent sample, see text. For minimum base for derived figures (percent, median, etc.) and meaning of symbols, see text.]

Miami	Neighborhood 01				Neighborhood 02				Neighborhood 03			
	All races	White	Negro	Persons of Spanish language	All races	White	Negro	Persons of Spanish language	All races	White	Negro	Persons of Spanish language
ALL INCOME LEVELS												
All Persons												
Total	45 686	12 951	32 571	6 563	27 157	17 039	9 984	12 664	34 585	20 794	13 619	11 794
In families	40 146	10 460	29 529	6 295	23 237	14 759	8 361	12 049	24 351	13 374	10 825	9 845
Head	10 908	3 492	7 353	1 636	6 472	4 197	2 229	3 154	7 701	4 822	2 850	3 123
With related children under 18	6 772	1 439	5 292	1 108	4 052	2 494	1 536	2 168	3 487	1 580	1 898	1 451
Mean number of related children under 18	2.46	2.01	2.58	2.14	2.32	2.07	2.74	2.10	2.21	1.87	2.50	1.93
With related children under 6	3 432	620	2 800	468	2 006	1 146	853	1 010	2 019	743	1 276	697
14 to 24 years	874	217	657	87	426	163	255	119	567	163	404	102
25 to 54 years	7 026	1 708	5 276	1 201	4 330	2 766	1 545	2 293	4 467	2 457	2 001	1 977
55 to 64 years	1 510	706	796	228	854	426	212	440	1 308	1 024	278	607
65 years and over	1 498	861	624	120	862	642	217	302	1 359	1 178	167	437
Wife of head	7 330	2 649	4 663	1 218	4 557	3 224	1 320	2 447	5 802	3 771	1 977	2 413
14 to 24 years	964	276	688	117	429	230	199	157	655	206	439	132
25 to 54 years	4 754	1 384	3 352	991	3 296	2 329	959	1 977	3 421	2 073	1 312	1 666
55 to 64 years	894	513	381	78	504	397	107	210	888	756	132	374
65 years and over	718	476	242	32	328	268	55	103	838	736	94	241
Other family members	21 908	4 319	17 513	3 441	12 208	7 338	4 812	6 448	10 848	4 781	5 998	4 309
Under 3 years	2 748	497	2 245	424	1 379	734	486	595	1 519	486	1 033	484
3 to 5 years	2 565	396	2 169	323	1 426	738	688	696	1 507	465	1 042	450
6 to 13 years	7 621	1 246	6 344	1 115	4 244	2 363	1 874	2 201	3 171	1 070	2 082	1 046
14 to 17 years	3 419	618	2 801	577	1 779	1 048	715	908	1 373	605	752	553
18 to 21 years	1 955	430	1 511	283	776	495	311	451	677	396	281	325
22 to 54 years	2 427	568	1 846	361	1 568	1 051	517	852	1 628	948	665	840
55 to 64 years	476	194	270	133	420	381	33	331	331	268	54	238
65 years and over	697	370	327	225	616	528	76	414	642	543	89	373
Mean size of family	3.68	3.00	4.02	3.85	3.59	3.52	3.75	3.82	3.16	2.77	3.80	3.15
Unrelated individuals	5 540	2 491	3 042	268	3 920	2 280	1 623	615	10 234	7 420	2 794	1 949
14 to 24 years	611	160	451	32	608	412	189	79	848	526	322	273
25 to 54 years	2 148	653	1 488	130	1 858	890	958	339	4 087	2 612	1 463	898
55 to 64 years	1 065	475	590	52	591	367	224	115	1 899	1 457	442	367
65 years and over	1 716	1 203	513	54	863	611	252	82	3 400	2 825	567	411
Persons in Families With Female Head and Female Unrelated Individuals												
Total	13 930	3 067	10 780	1 017	6 419	2 847	3 538	1 592	9 264	4 700	4 518	2 080
In families	11 013	1 677	9 260	898	4 420	1 561	2 837	1 302	5 269	1 773	3 462	1 242
Head	2 993	598	2 360	229	1 257	511	739	379	1 603	698	897	447
With related children under 18	2 244	331	1 885	184	908	282	619	249	1 033	256	777	181
Mean number of related children under 18	2.47	1.60	2.63	1.76	2.48	1.93	2.75	2.00	2.32	1.48	2.60	1.66
With related children under 6	993	125	863	67	414	117	297	102	530	47	483	29
14 to 24 years	289	47	242	18	118	4	114	-	174	29	145	29
25 to 54 years	2 051	313	1 710	175	855	345	510	297	1 037	392	645	258
55 to 64 years	276	99	177	9	129	64	58	38	210	148	62	72
65 years and over	377	139	231	27	155	98	57	44	182	129	45	88
Other family members	8 020	1 079	6 900	669	3 163	1 050	2 098	923	3 666	1 075	2 565	795
Under 3 years	819	104	715	102	376	166	210	158	439	44	395	34
3 to 5 years	759	79	680	33	271	54	217	38	416	36	380	20
6 to 13 years	2 712	253	2 449	178	1 038	228	810	223	1 106	171	935	151
14 to 17 years	1 247	152	1 095	98	505	114	385	124	478	114	364	93
18 to 21 years	854	121	727	72	240	103	128	102	291	136	155	95
22 to 54 years	1 196	223	960	118	527	236	291	173	614	328	279	245
55 to 64 years	195	50	133	36	89	59	30	27	78	62	7	59
65 years and over	238	97	141	32	117	90	27	67	244	184	50	98
Mean size of family	3.68	2.80	3.92	3.92	3.52	3.05	3.84	3.44	3.29	2.54	3.86	2.78
Female unrelated individuals	2 917	1 390	1 520	119	1 999	1 286	701	290	3 995	2 927	1 056	838
14 to 24 years	314	60	254	8	425	339	79	60	288	197	91	80
25 to 54 years	852	256	589	49	703	319	379	110	1 256	786	458	315
55 to 64 years	660	296	364	30	314	198	116	61	859	637	222	198
65 years and over	1 091	778	313	32	557	430	127	59	1 592	1 307	285	245

Table A-6. Persons by Family Status and Age and Families by Income Deficit by Residence in Census Tracts With a Poverty Rate of 20 Percent or More: 1970-Continued

[Excludes inmates of institutions, members of Armed Forces living in barracks, college students living in dormitories, and unrelated individuals under 14 years. Data based on 15-percent sample, see text. For minimum base for derived figures (percent, median, etc.) and meaning of symbols, see text]

Miami	Neighborhood 01				Neighborhood 02				Neighborhood 03			
	All races	White	Negro	Persons of Spanish language	All races	White	Negro	Persons of Spanish language	All races	White	Negro	Persons of Spanish language
INCOME BELOW POVERTY LEVEL												
All Persons												
Total	13 444	2 955	10 476	1 567	7 985	4 124	3 828	3 234	10 798	5 801	4 941	3 513
Percent below poverty level	29.4	22.8	32.2	23.9	29.4	24.2	38.3	25.5	31.2	27.9	36.3	29.8
In families	11 018	1 884	9 121	1 434	6 139	3 026	3 080	2 954	6 971	3 068	3 847	2 690
Head	2 746	596	2 145	359	1 565	806	751	754	1 897	1 021	862	801
Percent below poverty level	25.2	17.1	29.2	21.9	24.2	19.2	33.7	23.9	24.6	21.2	30.2	25.6
With related children under 18	1 991	254	1 732	207	1 163	571	584	580	1 211	470	741	434
Mean number of related children under 18	2.93	2.59	2.97	2.94	2.85	2.31	3.38	2.29	2.72	2.34	2.96	2.50
With related children under 6	1 089	138	946	121	596	305	291	297	735	222	513	223
14 to 24 years	207	32	175	18	142	28	106	30	161	31	130	23
25 to 54 years	1 809	264	1 540	216	1 046	568	478	556	1 110	520	590	448
55 to 64 years	318	109	209	57	121	63	58	54	251	179	72	158
65 years and over	412	191	221	68	256	147	109	114	375	291	70	172
Wife of head	1 274	392	882	241	829	560	261	527	1 123	721	379	563
14 to 24 years	110	22	88	13	75	51	24	47	123	47	76	39
25 to 54 years	810	179	631	175	581	394	179	387	572	338	219	334
55 to 64 years	177	82	95	31	82	45	37	45	208	155	53	90
65 years and over	177	109	68	22	91	70	21	48	220	181	31	100
Other family members	6 998	896	6 094	834	3 745	1 660	2 068	1 673	3 951	1 326	2 606	1 326
Under 3 years	861	133	828	131	513	248	265	252	598	183	415	203
3 to 5 years	877	105	772	91	462	199	263	170	608	150	458	142
6 to 13 years	2 859	310	2 549	317	1 644	670	967	687	1 575	459	1 107	462
14 to 17 years	1 092	110	982	96	517	136	371	180	515	191	324	179
18 to 21 years	563	69	486	56	147	101	46	87	139	53	86	46
22 to 54 years	450	90	360	81	252	126	126	119	295	134	161	138
55 to 64 years	84	13	71	13	93	80	13	80	57	42	15	49
65 years and over	112	66	46	49	117	100	17	98	164	114	40	107
Mean size of family	4.01	3.16	4.25	3.99	3.92	3.75	4.10	3.92	3.67	3.00	4.46	3.36
Unrelated individuals	2 426	1 071	1 355	133	1 846	1 098	748	280	3 827	2 733	1 094	823
Percent below poverty level	43.8	43.0	44.5	49.6	47.1	48.2	46.1	45.5	37.4	36.8	39.2	42.2
14 to 24 years	277	79	198	24	454	333	121	56	394	236	158	131
25 to 54 years	637	170	467	43	603	235	368	108	940	554	386	267
55 to 64 years	497	208	289	23	235	147	88	42	729	533	196	128
65 years and over	1 015	614	401	43	554	383	171	74	1 764	1 410	354	297
Persons in Families With Female Head and Female Unrelated Individuals												
Total	6 940	1 303	5 632	502	3 442	1 336	2 106	752	4 549	1 985	2 546	971
Percent below poverty level	49.8	42.5	52.2	49.4	53.6	46.9	59.5	47.2	49.1	42.2	56.4	46.7
In families	5 422	611	4 806	442	2 283	595	1 688	573	2 654	629	2 007	514
Head	1 385	196	1 184	104	581	181	400	167	727	246	473	184
Percent below poverty level	46.3	32.8	50.2	45.4	46.2	35.4	54.1	44.1	45.4	35.2	52.7	41.2
With related children under 18	1 168	119	1 044	69	506	141	365	139	617	156	461	107
Mean number of related children under 18	2.80	...	2.87	...	2.92	2.21	3.19	2.15	2.59	1.71	2.89	...
With related children under 6	573	57	511	41	252	70	182	72	347	41	306	23
14 to 24 years	164	24	140	18	71	...	71	...	88	7	81	7
25 to 54 years	988	112	871	56	443	157	286	148	513	158	355	102
55 to 64 years	102	21	81	9	30	7	23	7	56	36	20	36
65 years and over	131	39	92	21	37	17	20	12	70	45	17	39
Other family members	4 037	415	3 622	338	1 702	414	1 288	406	1 927	383	1 534	330
Under 3 years	467	82	385	87	234	101	133	105	283	38	245	28
3 to 5 years	467	29	438	14	207	41	166	38	283	36	247	20
6 to 13 years	1 704	137	1 567	101	715	143	572	143	811	120	691	107
14 to 17 years	654	42	612	43	285	29	256	43	253	57	196	50
18 to 21 years	312	12	300	6	74	35	39	21	87	26	61	19
22 to 54 years	302	63	239	54	143	45	98	38	109	49	60	49
55 to 64 years	66	13	53	13	20	7	13	7	14	14	...	14
65 years and over	65	37	28	20	24	13	11	11	87	43	34	43
Mean size of family	3.91	3.12	4.06	...	3.93	3.29	4.22	3.43	3.65	2.56	4.24	2.79
Female unrelated individuals	1 518	692	826	60	1 159	741	418	179	1 895	1 356	539	457
Percent below poverty level	52.0	49.8	54.3	...	58.0	57.6	59.6	61.7	47.4	46.3	51.0	54.5
14 to 24 years	143	28	115	8	336	280	56	37	160	107	53	30
25 to 54 years	323	87	236	14	336	123	213	48	396	233	163	118
55 to 64 years	316	113	203	17	131	80	51	35	326	221	105	86
65 years and over	736	464	272	21	356	258	98	59	1 013	795	218	223

Table A—6. Persons by Family Status and Age and Families by Income Deficit by Residence in Census Tracts With a Poverty Rate of 20 Percent or More: 1970—Continued

(Excludes inmates of institutions, members of Armed Forces living in barracks, college students living in dormitories, and unrelated individuals under 14 years. Data based on 15-percent sample, see text. For minimum base for derived figures (percent, median, etc.) and meaning of symbols, see text)

Miami	Neighborhood 01				Neighborhood 02				Neighborhood 03			
	All races	White	Negro	Persons of Spanish language	All races	White	Negro	Persons of Spanish language	All races	White	Negro	Persons of Spanish language
RATIO OF INCOME TO POVERTY LEVEL												
Families												
Percent with income:												
Less than .50 of poverty level	10.9	6.8	12.9	10.1	8.2	6.9	10.3	8.6	8.8	7.7	10.9	9.5
.50 to .74	6.8	3.8	8.3	6.2	7.5	5.4	11.5	6.5	6.7	5.9	7.7	8.0
.75 to .99	7.5	6.5	8.0	5.6	8.5	6.9	11.9	8.8	9.1	7.6	11.6	8.2
1.00 to 1.24	10.7	10.2	11.0	12.2	9.5	7.3	13.5	9.2	7.6	6.0	10.5	7.0
1.25 to 1.49	8.3	9.5	7.6	11.8	8.8	8.9	8.8	9.2	7.2	6.6	8.3	8.8
1.50 to 1.99	13.6	13.5	13.5	13.8	15.0	14.4	16.0	15.7	17.4	15.6	20.7	18.3
2.00 to 2.99	22.8	23.6	22.6	26.1	22.3	24.3	18.8	24.9	20.7	20.7	20.5	22.9
3.00 or more	19.5	26.2	16.2	14.2	20.2	26.0	9.2	17.1	22.4	30.0	9.7	17.3
Unrelated Individuals												
Percent with income:												
Less than .50 of poverty level	22.9	21.9	23.7	38.8	29.1	31.9	25.3	28.5	18.5	18.3	19.2	26.3
.50 to .74	11.4	11.8	11.0	10.8	12.6	10.1	16.3	11.7	10.5	9.5	13.2	7.3
.75 to .99	9.5	9.3	9.8	—	5.4	6.1	4.4	5.4	8.4	9.0	6.7	8.7
1.00 to 1.24	10.3	10.5	10.3	5.6	6.6	3.5	10.9	2.8	9.9	8.6	13.2	10.5
1.25 to 1.49	4.7	4.5	4.8	5.2	4.5	2.7	7.0	1.5	7.7	7.1	8.9	5.6
1.50 to 1.99	12.1	9.4	14.4	7.1	10.9	9.4	12.8	14.8	12.9	12.0	15.5	14.7
2.00 to 2.99	14.3	14.3	14.1	20.1	13.6	13.3	13.6	14.5	15.7	16.3	14.1	16.1
3.00 or more	14.8	18.3	11.9	12.3	17.4	22.9	9.6	21.0	16.5	19.2	9.2	10.8
DIFFERENCE BETWEEN FAMILY INCOME AND POVERTY LEVEL												
Families below poverty level	2 746	596	2 145	359	1 565	806	751	754	1 897	1 021	862	801
\$1 to \$249	295	97	198	36	155	78	77	66	260	128	132	53
\$250 to \$499	211	60	151	12	141	79	62	66	209	132	77	114
\$500 to \$999	418	130	283	72	373	198	175	197	395	231	150	171
\$1,000 to \$1,999	856	138	718	97	457	221	236	205	485	277	208	225
\$2,000 and over	966	171	795	142	439	230	201	220	548	253	295	238
Median income deficit	\$1 525	\$1 080	\$1 614	\$1 613	\$1 248	\$1 217	\$1 261	\$1 234	\$1 174	\$1 070	\$1 346	\$1 278
Mean income deficit	\$1 678	\$1 354	\$1 770	\$1 755	\$1 545	\$1 548	\$1 518	\$1 568	\$1 445	\$1 356	\$1 560	\$1 519
Families above poverty level	8 162	2 896	5 208	1 277	4 907	3 391	1 478	2 400	5 804	3 801	1 988	2 322
\$0 to \$249	410	118	292	40	160	71	89	66	151	84	67	46
\$250 to \$499	358	158	200	94	215	121	87	118	230	117	113	81
\$500 to \$999	524	147	363	83	307	184	123	126	392	210	182	178
\$1,000 to \$1,999	1 036	426	610	176	750	433	310	357	938	550	388	426
\$2,000 and over	5 834	2 047	3 743	884	3 475	2 582	869	1 733	4 093	2 840	1 238	1 591
Median income surplus	\$2000+	\$2000+	\$2000+	\$2000+	\$2000+	\$2000+	\$2000+	\$2000+	\$2000+	\$2000+	\$2000+	\$2000+
Mean income surplus	\$4 744	\$4 952	\$4 638	\$4 302	\$4 877	\$5 459	\$3 466	\$4 828	\$5 464	\$6 504	\$3 479	\$4 817

Table A-7. Selected Housing Characteristics of Housing Units by Location in Census Tracts With a Poverty Rate of 20 Percent or More: 1970.

[Excludes inmates of institutions, members of Armed Forces living in barracks, college students living in dormitories, and unrelated individuals under 14 years. Data based on 15-percent sample, see text. For minimum base for derived figures (percent, median, etc.) and meaning of symbols, see text]

Miami	Neighborhood 01				Neighborhood 02				Neighborhood 03			
	All races	White	Negro	Persons of Spanish language	All races	White	Negro	Persons of Spanish language	All races	White	Negro	Persons of Spanish language
TENURE AND VACANCY STATUS												
Total, all units	15 450	5 495	9 293	1 686	8 983	5 272	3 215	3 306	16 766	10 692	4 871	4 349
Occupied	14 859	5 495	9 293	1 686	8 542	5 272	3 215	3 306	15 606	10 692	4 871	4 349
Population in units	45 109	12 765	32 151	6 238	26 425	16 261	10 014	12 265	33 229	19 976	13 149	11 193
Population per unit	3.04	2.32	3.46	3.70	3.09	3.08	3.11	3.71	2.13	1.87	2.70	2.57
Owner occupied	5 249	2 224	3 009	390	1 958	1 630	305	679	1 114	1 028	86	268
Population per unit	3.14	2.19	3.84	4.06	3.12	2.98	3.90	3.80	2.49	2.44	...	3.37
1-person households	1 084	770	314	30	346	283	63	40	328	303	25	34
65 years and over	633	550	83	12	164	153	11	8	175	158	17	-
Renter occupied	9 610	3 271	6 284	1 296	6 584	3 642	2 910	2 627	14 492	9 664	4 785	4 081
Population per unit	2.98	2.42	3.28	3.59	3.09	3.13	3.03	3.69	2.10	1.81	2.69	2.52
1-person households	2 458	1 147	1 304	96	1 479	681	792	157	6 918	5 337	1 572	1 196
65 years and over	796	461	335	18	303	172	131	44	2 820	2 407	404	341
Available vacant year-round	439	-	-	-	284	-	-	-	785	-	-	-
For rent	350	-	-	-	264	-	-	-	762	-	-	-
For sale only	89	-	-	-	20	-	-	-	23	-	-	-
Other vacant	152	-	-	-	157	-	-	-	375	-	-	-
YEAR STRUCTURE BUILT												
Owner occupied	5 249	2 224	3 009	390	1 958	1 630	305	679	1 114	1 028	86	268
1960 to March 1970	765	306	451	78	126	97	29	63	26	14	12	7
1950 to 1959	1 610	600	1 010	120	347	283	64	200	194	170	24	40
1940 to 1949	1 561	540	1 013	109	515	407	94	206	133	117	16	57
1939 or earlier	1 313	778	535	83	970	843	118	210	761	727	34	164
Renter occupied	9 610	3 271	6 284	1 296	6 584	3 642	2 910	2 627	14 492	9 664	4 785	4 081
1960 to March 1970	1 883	542	1 284	201	1 171	818	346	418	1 672	1 203	453	338
1950 to 1959	3 098	935	2 152	412	2 168	705	1 449	568	3 258	1 147	2 091	481
1940 to 1949	2 288	914	1 362	408	1 219	622	597	504	2 412	1 446	966	768
1939 or earlier	2 341	880	1 447	275	2 026	1 497	518	1 137	7 150	5 868	1 275	2 494
Owner occ. below poverty level	1 327	594	733	81	431	359	63	116	204	171	33	19
1960 to March 1970	177	77	100	7	40	25	15	13	8	-	8	-
1950 to 1959	428	209	219	23	31	31	-	12	28	15	13	-
1940 to 1949	425	132	293	17	110	77	24	40	14	14	-	-
1939 or earlier	297	176	121	34	250	226	24	51	154	142	12	19
Renter occ. below poverty level	3 178	895	2 278	350	1 933	870	1 063	738	4 492	2 871	1 607	1 298
1960 to March 1970	416	105	311	45	216	122	94	112	305	175	130	53
1950 to 1959	915	282	628	134	715	148	567	159	905	237	654	129
1940 to 1949	914	311	603	129	399	156	243	148	723	369	354	228
1939 or earlier	933	197	736	42	603	444	159	319	2 559	2 090	469	888
UNITS IN STRUCTURE												
All occupied units	14 859	5 495	9 293	1 686	8 542	5 272	3 215	3 306	15 606	10 692	4 871	4 349
1	7 923	2 606	5 276	922	3 533	2 721	794	1 630	2 033	1 370	643	868
2 to 4	2 760	1 249	1 493	531	1 640	1 294	330	1 036	1 565	1 305	253	681
5 to 9	1 136	512	612	134	949	566	375	437	1 683	1 356	327	715
10 to 49	2 142	445	1 697	79	2 090	437	1 640	187	6 542	3 815	2 720	1 610
50 or more	332	139	193	8	324	254	70	16	3 768	2 831	928	467
Mobile home or trailer	566	544	22	12	6	-	6	-	15	15	-	8
YEAR HEAD MOVED INTO UNIT												
All occupied units	14 859	5 495	9 293	1 686	8 542	5 272	3 215	3 306	15 606	10 692	4 871	4 349
1968 to March 1970	4 765	2 034	2 695	883	3 819	2 642	1 146	2 000	7 172	5 427	1 745	2 436
1965 to 1967	4 128	1 156	2 944	503	2 083	1 094	989	814	4 039	2 698	1 313	1 281
1960 to 1964	2 986	919	2 060	227	1 110	543	567	332	2 130	1 366	755	500
1959 or earlier	2 980	1 386	1 594	73	1 530	993	513	160	2 265	1 201	1 058	132
Occ. units below poverty level	4 505	1 489	3 011	431	2 364	1 229	1 126	854	4 696	3 042	1 640	1 317
1968 to March 1970	1 454	520	929	273	1 057	660	388	612	1 999	1 496	503	843
1965 to 1967	1 179	270	909	88	559	225	334	158	1 226	765	453	296
1960 to 1964	815	233	582	43	303	86	217	51	711	411	300	139
1959 or earlier	1 057	466	591	27	445	258	187	33	760	370	384	39
SELECTED EQUIPMENT												
All occupied units	14 859	5 495	9 293	1 686	8 542	5 272	3 215	3 306	15 606	10 692	4 871	4 349
Percent with air conditioning	28.4	44.1	18.9	44.1	36.0	51.0	11.2	46.7	34.2	45.6	8.9	40.5
Percent with automobile	62.1	65.8	59.7	75.1	66.4	77.6	48.1	78.0	43.3	44.8	39.5	50.6
Percent with telephone	67.0	70.7	64.7	71.8	61.3	72.6	42.5	69.7	57.3	64.2	42.0	60.8
Percent with all plumbing facilities	96.9	95.6	97.7	97.3	93.3	95.0	90.6	94.6	83.1	82.5	84.3	84.1
Occ. units below poverty level	4 505	1 489	3 011	431	2 364	1 229	1 126	854	4 696	3 042	1 640	1 317
Percent with air conditioning	16.0	30.2	9.1	29.9	19.2	30.2	6.6	25.4	20.5	27.6	7.4	26.8
Percent with automobile	40.3	42.2	39.5	48.5	44.2	54.3	32.9	59.3	22.2	20.4	24.7	22.1
Percent with telephone	58.4	59.8	57.6	55.0	47.5	59.5	34.9	59.0	46.9	52.3	36.9	49.3
Percent with all plumbing facilities	95.1	92.3	96.5	97.4	90.8	91.4	90.1	93.7	77.2	74.5	81.8	76.8
PERSONS PER ROOM												
Owner occupied	5 249	2 224	3 009	390	1 958	1 630	305	679	1 114	1 028	86	268
1.00 or fewer persons per room	4 305	2 078	2 211	269	1 593	1 369	210	449	963	895	68	189
1.01 to 1.50 persons per room	576	99	477	68	236	147	80	125	80	80	-	47
1.51 or more persons per room	368	47	321	53	129	114	15	105	71	53	18	32
Owner occ. below poverty level	1 327	594	733	81	431	359	63	116	204	171	33	19
1.00 or fewer persons per room	1 104	582	522	67	363	313	50	75	182	157	25	13
1.01 to 1.50 persons per room	143	5	138	-	42	20	13	23	8	8	-	-
1.51 or more persons per room	80	7	73	14	26	26	-	18	14	6	8	6

Table A-7. Selected Housing Characteristics of Housing Units by Location in Census Tracts With a Poverty Rate of 20 Percent or More: 1970—Continued

[Excludes inmates of institutions, members of Armed Forces living in barracks, college students living in dormitories, and unrelated individuals under 14 years. Data based on 15-percent sample, see text. For minimum base for derived figures (percent, median, etc.) and meaning of symbols, see text.]

Miami	Neighborhood 01				Neighborhood 02				Neighborhood 03			
	All races	White	Negro	Persons of Spanish language	All races	White	Negro	Persons of Spanish language	All races	White	Negro	Persons of Spanish language
PERSONS PER ROOM—Con.												
Renter occupied	9 610	3 271	6 284	1 296	6 584	3 642	2 910	2 627	14 492	9 664	4 785	4 081
1.00 or fewer persons per room	7 065	2 677	4 344	834	4 182	2 233	1 925	1 269	11 148	7 933	3 192	2 587
1.01 to 1.50 persons per room	1 293	289	999	228	904	555	349	523	1 017	415	602	373
1.51 or more persons per room	1 252	305	941	234	1 498	854	636	835	2 327	1 316	991	1 121
Renter occ. below poverty level	3 178	895	2 278	350	1 933	870	1 063	738	4 492	2 871	1 607	1 298
1.00 or fewer persons per room	2 269	766	1 503	226	1 148	515	633	386	3 317	2 310	993	801
1.01 to 1.50 persons per room	461	73	383	68	265	127	138	127	317	102	215	102
1.51 or more persons per room	448	56	392	56	520	228	292	225	858	459	399	395
VALUE OF PROPERTY												
Specified owner occupied ¹	4 045	1 350	2 679	276	1 502	1 246	242	439	549	497	52	170
Less than \$5,000	74	41	33	—	67	54	13	14	81	81	—	8
\$5,000 to \$9,999	830	290	540	44	360	323	28	111	43	35	8	8
\$10,000 to \$12,499	811	258	553	37	263	227	31	71	44	36	8	13
\$12,500 to \$14,999	866	280	578	49	312	231	81	91	44	35	21	32
\$15,000 to \$17,499	728	278	442	76	228	170	58	50	92	71	4	43
\$17,500 to \$19,999	362	90	272	28	97	73	24	24	72	68	5	24
\$20,000 to \$24,999	211	70	141	27	90	90	—	25	88	83	—	—
\$25,000 to \$34,999	118	27	91	15	48	48	—	7	55	55	—	—
\$35,000 or more	45	16	29	—	37	30	—	—	66	60	—	—
Median value of property	\$13 400	\$13 300	\$13 400	\$15 300	\$13 000	\$12 700	\$14 000	\$13 100	\$17 700	\$18 100	...	\$17 800
Mean value of property	\$14 000	\$13 700	\$14 200	\$15 500	\$14 000	\$13 900	\$14 500	\$13 700	\$21 000	\$21 000	...	\$20 300
Specified owner occupied below poverty level ¹	964	327	637	52	312	256	56	73	78	62	16	12
Less than \$5,000	20	15	5	—	14	14	—	—	—	—	—	—
\$5,000 to \$9,999	276	86	190	19	96	91	5	12	8	—	8	—
\$10,000 to \$12,499	235	88	147	—	62	55	7	16	24	16	8	—
\$12,500 to \$14,999	190	62	128	—	64	39	25	14	13	13	—	—
\$15,000 to \$17,499	85	23	62	5	32	20	12	—	6	6	—	6
\$17,500 to \$19,999	83	39	44	22	19	19	—	19	6	6	—	6
\$20,000 to \$24,999	26	6	20	6	8	8	—	8	21	21	—	—
\$25,000 or more	49	8	41	—	17	10	7	4	—	—	—	—
Median value of property	\$12 000	\$11 800	\$12 100	...	\$11 900	\$11 000
Mean value of property	\$13 500	\$12 600	\$13 900	...	\$13 300	\$12 000
GROSS RENT												
Specified renter occupied ²	9 438	3 205	6 184	1 255	6 476	3 547	2 897	2 532	14 435	9 621	4 771	4 038
Less than \$40	893	269	617	65	135	43	92	23	337	278	59	105
\$40 to \$59	593	257	336	51	386	179	207	83	1 794	1 296	498	398
\$60 to \$79	1 013	430	583	111	1 435	447	981	307	3 229	1 660	1 563	629
\$80 to \$99	2 292	773	1 519	291	1 802	906	881	785	3 364	1 824	1 540	1 028
\$100 to \$119	2 143	548	1 588	251	1 031	614	413	514	2 112	1 266	823	656
\$120 to \$149	1 772	508	1 252	323	791	582	209	479	1 461	1 302	152	567
\$150 to \$199	571	327	221	157	651	561	90	299	1 121	1 046	68	453
\$200 to \$249	63	22	41	6	159	144	—	20	362	362	—	50
\$250 or more	—	—	—	—	17	—	—	—	427	427	—	84
No cash rent	98	71	27	—	69	54	15	22	228	160	68	68
Median gross rent	\$99	\$96	\$100	\$109	\$94	\$106	\$84	\$102	\$102	\$96	\$83	\$97
Mean gross rent	\$97	\$98	\$97	\$108	\$102	\$113	\$87	\$108	\$101	\$110	\$84	\$105
Specified renter occupied below poverty level ²	3 101	878	2 218	333	1 920	857	1 063	725	4 464	2 857	1 593	1 284
Less than \$40	694	183	511	60	77	24	53	23	237	192	45	74
\$40 to \$59	259	88	171	19	184	87	97	45	629	626	203	219
\$60 to \$79	360	126	234	27	442	97	345	74	1 254	722	526	273
\$80 to \$99	715	181	534	50	595	264	331	247	988	506	482	245
\$100 to \$119	461	115	346	47	267	121	146	107	491	246	237	162
\$120 to \$149	477	122	355	104	174	146	28	131	359	298	61	157
\$150 to \$199	85	45	35	26	155	100	55	86	209	184	25	129
\$200 to \$249	18	—	18	—	5	5	—	5	25	38	—	19
\$250 or more	—	—	—	—	—	—	—	—	38	38	—	—
Median gross rent	\$86	\$84	\$87	\$104	\$88	\$96	\$82	\$98	\$78	\$77	\$81	\$86
Mean gross rent	\$83	\$83	\$83	\$98	\$92	\$101	\$84	\$103	\$84	\$86	\$81	\$93
GROSS RENT AS PERCENTAGE OF INCOME BY POVERTY STATUS IN 1969												
Specified renter occupied ²	9 031	3 028	5 954	1 198	6 229	3 386	2 811	2 436	13 646	9 098	4 505	3 769
Less than 20 percent	3 144	1 082	2 055	495	2 317	1 377	929	984	4 110	2 587	1 516	1 245
20 to 24 percent	1 276	514	756	180	801	459	342	316	1 646	1 040	600	378
25 to 34 percent	1 499	476	1 004	192	1 157	633	509	475	2 264	1 460	804	536
35 to 49 percent	1 268	373	878	135	706	370	336	255	2 334	1 676	651	645
50 percent or more	1 844	583	1 261	196	1 248	547	695	406	3 292	2 335	934	965
Specified renter occupied below poverty level ²	2 760	754	2 001	276	1 721	737	984	644	3 869	2 474	1 381	1 077
Less than 20 percent	155	20	135	6	23	—	23	—	50	—	50	—
20 to 24 percent	166	44	122	26	24	—	15	9	98	44	54	13
25 to 34 percent	305	59	246	19	189	91	98	98	275	120	155	38
35 to 49 percent	604	162	437	55	353	146	207	131	796	503	293	217
50 percent or more	1 530	469	1 061	170	1 132	491	641	406	2 650	1 807	829	809

¹Limited to one-family homes on less than 10 acres and no business on property. Cooperatives, condominiums, mobile homes, and trailers are excluded. ²Excludes one-family homes on 10 acres or more. Specified renter occupied units below poverty level include "no cash rent" units not shown separately. ³Excludes one-family homes on 10 acres or more, all "no cash rent" units, and units for which the income of the family or primary individual was reported as "none" or "loss."

Table A-1. Selected Characteristics of Persons and Families by Residence in Census Tracts With a Poverty Rate of 20 Percent or More: 1970

[Excludes inmates of institutions, members of Armed Forces living in barracks, college students living in dormitories, and unrelated individuals under 14 years. Data based on 15-percent sample, see text. For minimum base for derived figures (percent, median, etc.) and meaning of symbols, see text]

Miami	Neighborhood 04				All races	White	Negro	Persons of Spanish language	All races	White	Negro	Persons of Spanish language	All races	White	Negro	Persons of Spanish language
	All races	White	Negro	Persons of Spanish language												
RACE																
All Income Levels																
All persons	30 379	29 938	189	25 226												
Persons of Spanish language	25 226	24 885	160	25 226												
White	29 938	29 938	-	24 885												
Negro	189	-	189	160												
Other races	252	-	-	181												
American Indian	18	-	-	-												
Japanese	27	-	-	14												
Chinese	90	-	-	55												
Filipino	5	-	-	-												
All other	112	-	-	112												
Percent Below Poverty Level																
All persons	24.7	24.5	34.9	24.8												
Persons of Spanish language	24.8	24.5	36.3	24.8												
White	24.5	24.5	-	24.5												
Negro	34.9	-	34.9	36.3												
Other races	39.7	-	-	52.5												
American Indian	-	-	-	-												
Japanese	-	-	-	-												
Chinese	...	-	-	...												
Filipino	...	-	-	-												
All other	...	-	-	...												
RELATIONSHIP TO HEAD OF HOUSEHOLD FOR PERSONS BELOW POVERTY LEVEL																
All persons	7 503	7 337	66	6 247												
65 years and over	1 734	1 718	-	1 000												
In households	7 326	7 160	66	6 167												
Head of household	2 765	2 674	46	2 040												
Family head	1 795	1 729	26	1 618												
65 years and over	517	512	-	407												
Female	463	433	13	438												
Primary individual	970	945	20	422												
65 years and over	593	588	-	175												
Female	700	680	20	304												
Related child under 18 years	1 941	1 905	-	1 901												
Related child under 6 years	558	534	-	553												
Other relative of head	2 239	2 203	17	1 979												
Not related to head	381	378	3	247												
In group quarters	177	177	-	80												
AGE																
All males below poverty level	3 030	2 976	13	2 549												
Under 3 years	107	107	-	107												
3 to 5 years	128	120	-	123												
6 to 13 years	485	480	-	473												
14 to 17 years	178	178	-	178												
18 to 21 years	108	108	-	68												
22 to 24 years	40	40	-	30												
25 to 34 years	306	299	-	272												
35 to 44 years	512	512	-	462												
45 to 54 years	255	255	-	213												
55 to 64 years	322	293	13	249												
65 years and over	589	584	-	374												
Median age	37.2	37.0	...	34.5												
All females below poverty level	4 473	4 361	53	3 698												
Under 3 years	146	130	-	146												
3 to 5 years	177	177	-	177												
6 to 13 years	538	531	-	515												
14 to 17 years	224	224	-	224												
18 to 21 years	104	104	-	86												
22 to 24 years	62	54	8	27												
25 to 34 years	480	467	5	457												
35 to 44 years	506	501	-	461												
45 to 54 years	403	349	34	369												
55 to 64 years	688	670	6	610												
65 years and over	1 145	1 134	-	626												
Median age	44.0	43.9	...	38.7												
YEARS OF SCHOOL COMPLETED																
All Income Levels																
Male, 22 years and over	9 907	9 768	55	7 839												
Elementary: 0 to 7 years	3 699	3 637	36	3 209												
8 years	1 464	1 452	6	1 150												
High school: 1 to 3 years	1 187	1 167	-	876												
4 years	2 026	2 008	-	1 414												
College: 1 to 3 years	747	738	-	548												
4 years or more	784	766	13	642												
Median years of school completed	8.9	8.9	...	8.6												

Table A-1. Selected Characteristics of Persons and Families by Residence in Census Tracts With a Poverty Rate of 20 Percent or More: 1970—Continued

[Excludes inmates of institutions, members of Armed Forces living in barracks, college students living in dormitories, and unrelated individuals under 14 years. Data based on 15-percent sample, see text. For minimum base for derived figures (percent, median, etc.) and meaning of symbols, see text]

Miami	Neighborhood 04				All races	White	Negro	Persons of Spanish language	All races	White	Negro	Persons of Spanish language
	All races	White	Negro	Persons of Spanish language								
YEARS OF SCHOOL COMPLETED—												
Con.												
All Income Levels— Con.												
Female, 22 years and over	12 552	12 340	117	10 017								
Elementary: 0 to 7 years	5 045	4 940	49	4 458								
8 years	1 932	1 922	5	1 514								
High school: 1 to 3 years	1 469	1 448	7	984								
4 years	2 694	2 665	16	2 008								
College: 1 to 3 years	720	700	20	495								
4 years or more	692	665	20	558								
Median years of school completed	8.6	8.6	...	8.4								
Income Below Poverty Level												
Male, 22 years and over	2 024	1 983	13	1 600								
Less than 8 years	1 057	1 045	—	880								
8 to 11 years	448	448	—	339								
12 years or more	519	490	13	381								
Female, 22 years and over	3 284	3 195	53	2 550								
Less than 8 years	1 666	1 637	6	1 448								
8 to 11 years	789	786	3	473								
12 years or more	829	772	44	629								
EMPLOYMENT STATUS AND AGE												
All Income Levels												
Male												
16 to 21 years ¹	1 070	1 059	—	912								
Employed	577	572	—	525								
Unemployed	13	13	—	13								
Not in labor force	480	474	—	374								
22 to 64 years ¹	8 072	7 951	49	6 789								
Employed	6 960	6 867	30	5 973								
Unemployed	214	201	13	199								
Not in labor force	898	883	6	617								
Family head, 22 to 64 years ¹	5 827	5 723	43	5 217								
Employed	5 258	5 176	30	4 743								
Unemployed	173	160	13	167								
Not in labor force	396	387	—	307								
Female												
16 to 21 years	1 165	1 165	—	1 086								
Employed	529	529	—	501								
Unemployed	21	21	—	21								
Not in civilian labor force	615	615	—	564								
22 to 64 years	10 012	9 824	117	8 623								
Employed	5 371	5 267	83	4 646								
Unemployed	335	326	9	323								
Not in civilian labor force	4 306	4 231	25	3 654								
Family head, 22 to 64 years	1 008	981	15	912								
Employed	705	690	15	627								
Unemployed	54	54	—	49								
Not in civilian labor force	249	237	—	236								
Wife of head, 22 to 64 years	5 671	5 584	47	5 040								
Employed	2 791	2 750	34	2 544								
Unemployed	184	184	—	184								
Not in civilian labor force	2 696	2 650	13	2 312								
Income Below Poverty Level												
Male												
16 to 21 years ¹	172	172	—	132								
Employed	52	52	—	52								
Unemployed	—	—	—	—								
Not in labor force	120	120	—	80								
22 to 64 years ¹	1 435	1 399	13	1 226								
Employed	954	940	—	869								
Unemployed	46	33	13	46								
Not in labor force	435	426	—	311								
Family head, 22 to 64 years ¹	930	894	13	872								
Employed	728	714	—	691								
Unemployed	46	33	13	46								
Not in labor force	156	147	—	135								

¹Includes members of Armed Forces not living in barracks and not shown separately.

Table A-1. Selected Characteristics of Persons and Families by Residence in Census Tracts With a Poverty Rate of 20 Percent or More: 1970—Continued

[Excludes inmates of institutions, members of Armed Forces living in barracks, college students living in dormitories, and unrelated individuals under 14 years. Data based on percent sample, see text. For minimum base for derived figures (percent, median, etc.) and meaning of symbols, see text.]

Miami	Neighborhood 04				Persons of Spanish language	All races	White	Negro	Persons of Spanish language	All races	White	Negro	Persons of Spanish language
	All races	White	Negro	Persons of Spanish language									
EMPLOYMENT STATUS AND AGE—Con.													
Income Below Poverty Level—Con.													
Female													
16 to 21 years -----	187	187	--	169									
Employed -----	31	31	--	27									
Unemployed -----	7	7	--	7									
Not in civilian labor force -----	149	149	--	135									
22 to 64 years -----	2 139	2 061	53	1 924									
Employed -----	681	643	38	638									
Unemployed -----	102	93	9	90									
Not in civilian labor force -----	1 356	1 325	6	1 196									
Family head, 22 to 64 years -----	325	300	13	316									
Employed -----	193	180	13	189									
Unemployed -----	11	11	--	6									
Not in civilian labor force -----	121	109	--	121									
Wife of head, 22 to 64 years -----	974	949	17	936									
Employed -----	275	258	17	263									
Unemployed -----	47	47	--	47									
Not in civilian labor force -----	652	644	--	626									
SELECTED OCCUPATIONS													
All income levels													
Male employed, 22 to 64 years²													
Prof., tech., and kindred workers -----	6 960	6 867	30	5 973									
Health workers, exc. practitioners -----	439	439	--	357									
Teachers, elem. and secondary -----	50	50	--	42									
Managers and admin., exc. farm -----	36	36	--	24									
Self-employed -----	292	292	--	253									
Sales workers -----	75	75	--	68									
Retail trade -----	323	323	--	290									
Clerical and kindred workers -----	230	230	--	213									
Postal clerks and mail carriers -----	588	582	--	435									
Shipping, receiving & stock clerks -----	16	16	--	--									
Bkpr., cashiers, & bank tellers -----	162	162	--	133									
Craftsmen and kindred workers -----	122	116	--	114									
Construction craftsmen -----	1 689	1 653	5	1 467									
Mechanics and repairmen -----	594	587	--	541									
Operatives, except transport -----	390	378	--	333									
Assemblers -----	1 366	1 366	--	1 311									
Checkers, exam., & inspectors; mfg -----	158	158	--	158									
Pkrs. & wrappers, inc. meat & prod -----	33	33	--	33									
Sewers, stitchers, & textile oper -----	50	50	--	50									
Transport equipment operatives -----	49	49	--	49									
Truck drivers -----	487	479	8	347									
Laborers, except farm -----	117	109	8	96									
Construction -----	557	540	17	484									
Freight, material, & stock handlers -----	169	169	--	149									
Service workers, exc. private hshld. ³ -----	87	70	17	81									
Cleaning service workers -----	1 169	1 143	--	999									
Food service workers -----	383	378	--	320									
Health service workers -----	577	556	--	548									
Personal service workers -----	20	20	--	20									
Protective service workers -----	72	72	--	58									
Private household workers -----	54	54	--	33									
Female employed, 22 to 64 yrs.²													
Prof., tech., and kindred workers -----	5 371	5 267	83	4 646									
Health workers, exc. practitioners -----	255	253	2	178									
Teachers, elem. and secondary -----	95	93	2	70									
Managers and admin., exc. farm -----	26	26	--	13									
Self-employed -----	135	135	--	107									
Sales workers -----	28	28	--	21									
Retail trade -----	192	192	--	146									
Clerical and kindred workers -----	159	159	--	119									
Bkpr., cashiers, & bank tellers -----	1 023	1 002	21	706									
Secretaries, steno., & typists -----	216	216	--	154									
Craftsmen and kindred workers -----	218	218	--	133									
Operatives, except transport -----	159	159	--	135									
Laundry & dry cleaning operatives ⁴ -----	2 549	2 513	22	2 467									
Assemblers -----	130	130	--	130									
Pkrs. & wrappers, inc. meat & prod -----	51	51	--	51									
Sewers, stitchers, & textile oper -----	257	257	--	257									
Transport equipment operatives -----	1 135	1 116	5	1 114									
Laborers, except farm -----	7	7	--	7									
Service workers, exc. private hshld. ⁵ -----	59	59	--	51									
Cleaning service workers -----	910	883	27	786									
Food service workers -----	319	308	11	314									
Health service workers -----	236	236	--	183									
Personal service workers -----	36	24	12	29									
Private household workers -----	204	204	--	197									
	56	47	9	44									

¹Includes "farm workers" not shown separately. cases are included in the total but not in the distribution.

²Allocated cases are included in the total but not in the distribution.

⁴Includes "clothing ironers and pressers."

⁵"Protective service workers" and

Table A-1. Selected Characteristics of Persons and Families by Residence in Census Tracts With a Poverty Rate of 20 Percent or More: 1970—Continued

[Excludes inmates of institutions, members of Armed Forces living in barracks, college students living in dormitories, and unrelated individuals under 14 years. Data based on 15-percent sample, see text. For minimum base for derived figures (percent, median, etc.) and meaning of symbols, see text]

Miami	Neighborhood 04											
	All races	White	Negro	Persons of Spanish language	All races	White	Negro	Persons of Spanish language	All races	White	Negro	Persons of Spanish language
SELECTED OCCUPATIONS—Con.												
Income Below Poverty Level												
Male employed, 22 to 64 yrs. ²	954	940	—	869								
Prof., tech., and kindred workers	27	27	—	19								
Managers and admin., exc. farm	24	24	—	16								
Sales workers	21	21	—	21								
Clerical and kindred workers	33	33	—	14								
Craftsmen and kindred workers	264	264	—	257								
Operatives, except transport	210	210	—	191								
Transport equipment operatives	37	37	—	37								
Laborers, except farm	163	163	—	156								
Service workers, exc. private hshld	175	161	—	158								
Private household workers	—	—	—	—								
Female employed, 22 to 64 yrs. ²	681	643	38	638								
Prof., tech., and kindred workers	19	19	—	—								
Managers and admin., exc. farm	3	3	—	3								
Sales workers	28	28	—	28								
Clerical and kindred workers	57	36	21	45								
Craftsmen and kindred workers	—	—	—	345								
Operatives, except transport	350	350	—	—								
Transport equipment operatives	—	—	—	14								
Laborers, except farm	14	14	17	182								
Service workers, exc. private hshld	189	172	—	15								
Private household workers	15	15	—	—								
FAMILY STATUS AND AGE												
All Income Levels												
Both Sexes												
Head of family: 14 to 21 yrs.	83	83	—	75								
22 to 54 yrs.	5 094	5 010	40	4 738								
Wife of head: 14 to 21 yrs.	188	188	—	175								
22 to 54 yrs.	4 460	4 384	42	4 042								
Unrelated indiv.: 14 to 21 yrs.	163	163	—	99								
22 to 54 yrs.	1 517	1 472	33	917								
Female												
Head of family: 14 to 21 yrs.	5	5	—	5								
22 to 54 yrs.	740	720	15	667								
Unrelated indiv.: 14 to 21 yrs.	55	55	—	42								
22 to 54 yrs.	758	724	27	483								
Income Below Poverty Level												
Both Sexes												
Head of family: 14 to 21 yrs.	23	23	—	23								
22 to 54 yrs.	967	942	13	929								
Wife of head: 14 to 21 yrs.	21	21	—	21								
22 to 54 yrs.	753	728	17	722								
Unrelated indiv.: 14 to 21 yrs.	84	84	—	63								
22 to 54 yrs.	421	404	17	268								
Female												
Head of family: 14 to 21 yrs.	—	—	—	—								
22 to 54 yrs.	234	216	13	230								
Unrelated indiv.: 14 to 21 yrs.	26	26	—	22								
22 to 54 yrs.	226	209	17	152								

¹Includes "farm workers" not shown separately.

Table A-2. Characteristics of the Population by Residence in Census Tracts With a Poverty Rate of 20 Percent or More: 1970

[Excludes inmates of institutions, members of Armed Forces living in barracks, college students living in dormitories, and unrelated individuals under 14 years. Data based on 15-percent sample, see text. For minimum base for derived figures (percent, median, etc.) and meaning of symbols, see text.]

Miami	Neighborhood 04				Persons of Spanish language	All races			Persons of Spanish language	All races			Persons of Spanish language
	All races	White	Negro	Persons of Spanish language		All races	White	Negro		All races	White	Negro	
RELATIONSHIP TO HEAD													
All persons	30 379	29 938	189	25 226									
In households	30 060	29 630	183	25 099									
Head of household	11 000	10 819	84	8 254									
Family head	8 378	8 235	58	7 106									
65 years old and over	1 460	1 448	15	1 106									
Female	1 284	1 252	15	1 148									
Primary individual	2 622	2 584	26	2 666									
Female	1 595	1 562	26	1 699									
Related child under 18 years old	6 491	6 407	17	6 099									
Other relative of head	11 864	11 716	65	10 316									
Not related to head	705	688	17	430									
In group quarters	319	308	6	127									
AGE													
Male, all ages	13 834	13 644	72	11 447									
Under 3 years	389	389	—	369									
3 to 5 years	461	453	—	446									
6 to 13 years	1 565	1 538	17	1 487									
14 to 17 years	935	925	—	826									
18 to 21 years	577	571	—	480									
22 to 24 years	348	348	—	300									
25 to 34 years	1 459	1 452	—	1 270									
35 to 44 years	2 189	2 135	23	1 952									
45 to 54 years	2 111	2 091	8	1 817									
55 to 64 years	1 965	1 925	18	1 450									
65 years and over	1 835	1 817	6	1 050									
Median age	39.4	39.4	...	36.8									
Female, all ages	16 545	16 294	117	13 779									
Under 3 years	355	323	—	338									
3 to 5 years	479	479	—	458									
6 to 13 years	1 541	1 534	—	1 462									
14 to 17 years	838	838	—	777									
18 to 21 years	780	780	—	727									
22 to 24 years	514	502	12	456									
25 to 34 years	1 818	1 798	5	1 692									
35 to 44 years	2 549	2 508	17	2 318									
45 to 54 years	2 501	2 431	56	2 052									
55 to 64 years	2 630	2 585	27	2 125									
65 years and over	2 540	2 516	—	1 394									
Median age	41.6	41.5	...	38.3									
PLACE OF BIRTH													
Total population	30 379	29 938	189	25 226									
Born in State of residence	2 007	1 963	—	1 397									
Born in different State	2 669	2 640	29	382									
Northeast	1 145	1 145	—	238									
North Central	495	495	—	65									
South	948	919	29	59									
West	81	81	—	20									
Puerto Rico and outlying areas	178	178	—	178									
Foreign born	23 645	23 318	156	22 680									
Not reported and other	1 880	1 839	4	589									
RESIDENCE IN 1965													
Total, 5 years and over	29 033	28 632	189	23 944									
Same house as in 1970	6 376	6 242	46	3 298									
Different house in United States	8 594	8 510	36	7 383									
Same county	7 181	7 119	26	6 235									
Different county	1 413	1 391	10	1 148									
Same State	113	113	—	87									
Different State	1 300	1 278	10	1 061									
Northeast	693	681	—	623									
North Central	250	250	—	183									
South	183	173	10	122									
West	174	174	—	133									
Moved, residence not rpid., abroad	14 063	13 880	107	13 263									
SCHOOL ENROLLMENT													
All Income Levels													
Total enrolled, 3 to 21 yr. old	5 321	5 271	17	5 013									
Nursery school:	29	29	—	29									
Private	77	77	—	77									
Kindergarten:	115	115	—	115									
Private	94	94	—	94									
Elem. (1 to 8 yr.):	2 778	2 744	17	2 673									
Private	466	466	—	435									
High school (1 to 4 yr.):	1 283	1 273	—	1 156									
Private	175	175	—	150									
College	304	298	—	284									
Total enrolled, 3 to 21 yr. old	5 321	5 271	17	5 013									
3 to 5 years old	219	219	—	219									
6 to 13 years old	2 880	2 846	17	2 782									
14 and 15 years old	852	847	—	776									
16 and 17 years old	762	757	—	675									
18 to 21 years old	608	602	—	561									

Table A-2. Characteristics of the Population by Residence in Census Tracts With a Poverty Rate of 20 Percent or More: 1970—Continued

[Excludes inmates of institutions, members of Armed Forces living in barracks, college students living in dormitories, and unrelated individuals under 14 years. Data based on 15-percent sample, see text. For minimum base for derived figures (percent, median, etc.) and meaning of symbols, see text]

Miami	Neighborhood 04											
	All races	White	Negro	Persons of Spanish language	All races	White	Negro	Persons of Spanish language	All races	White	Negro	Persons of Spanish language
SCHOOL ENROLLMENT—												
Continued												
All Income Levels—Continued												
Percent enrolled, 3 to 21 yr. old	74.1	74.1	...	75.2								
3 to 5 years old	23.3	23.5	...	24.2								
6 to 13 years old	92.7	92.6	...	94.3								
14 and 15 years old	95.2	95.2	...	95.6								
16 and 17 years old	86.8	86.7	...	85.3								
18 to 21 years old	44.8	44.6	...	46.5								
Income Below Poverty Level												
Total enrolled, 3 to 21 yr. old	1 442	1 430	—	1 419								
Nursery school:												
Public	5	5	—	5								
Private	31	31	—	31								
Kindergarten:												
Public	52	52	—	52								
Private	17	17	—	17								
Elem. (1 to 8 yr.):												
Public	1 002	990	—	990								
Private	42	42	—	42								
High school (1 to 4 yr.):												
Public	251	251	—	244								
Private	8	8	—	8								
College												
Public	34	34	—	30								
Total enrolled, 3 to 21 yr. old	1 442	1 430	—	1 419								
3 to 5 years old	75	75	—	75								
6 to 13 years old	929	917	—	917								
14 and 15 years old	241	241	—	241								
16 and 17 years old	127	127	—	127								
18 to 21 years old	70	70	—	59								
Percent enrolled, 3 to 21 yr. old	74.3	74.4	—	77.0								
3 to 5 years old	24.6	25.3	—	25.0								
6 to 13 years old	90.8	90.7	—	92.8								
14 and 15 years old	94.5	94.5	—	94.5								
16 and 17 years old	86.4	86.4	—	86.4								
18 to 21 years old	33.0	33.0	—	38.3								
YEARS OF SCHOOL COMPLETED												
All Income Levels												
Male, 25 years old and over	9 559	9 420	55	7 539								
Elementary:												
0 to 7 years	3 677	3 615	36	3 187								
8 years	1 431	1 419	6	1 117								
High school:												
1 to 3 years	1 110	1 090	—	799								
4 years	1 869	1 851	—	1 277								
College:												
1 to 3 years	688	679	—	517								
4 years or more	784	766	13	642								
Median years of school completed	8.8	8.8	...	8.5								
Female, 25 years old and over	12 038	11 838	105	9 581								
Elementary:												
0 to 7 years	5 000	4 895	49	4 417								
8 years	1 868	1 858	5	1 457								
High school:												
1 to 3 years	1 404	1 387	3	939								
4 years	2 453	2 424	16	1 784								
College:												
1 to 3 years	642	622	20	439								
4 years or more	671	652	12	545								
Median years of school completed	8.5	8.6	...	8.3								
Income Below Poverty Level												
Male, 25 years old and over	1 984	1 943	13	1 570								
Less than 8 years	1 043	1 031	—	866								
8 to 11 years	440	440	—	331								
12 years or more	501	472	13	373								
Female, 25 years old and over	3 222	3 141	45	2 523								
Less than 8 years	1 659	1 630	6	1 441								
8 to 11 years	755	752	3	466								
12 years or more	808	759	36	616								
PERSONS 16 TO 21 YEARS OLD NOT IN SCHOOL												
All Income Levels												
Male	306	306	—	247								
Not high school graduate	191	191	—	166								
Employed or in Armed Forces	126	126	—	126								
Unemployed	7	7	—	7								
Not in labor force	58	58	—	33								
High school graduate	115	115	—	81								
Employed or in Armed Forces	92	92	—	66								
Unemployed	—	—	—	—								
Not in labor force	23	23	—	15								
Female	559	559	—	515								
Not high school graduate	321	321	—	285								
Employed or in Armed Forces	168	168	—	161								
Unemployed	7	7	—	7								
Not in labor force	146	146	—	117								
High school graduate	238	238	—	230								
Employed or in Armed Forces	166	166	—	158								
Unemployed	—	—	—	—								
Not in labor force	72	72	—	72								

Table A-2. Characteristics of the Population by Residence in Census Tracts With a Poverty Rate of 20 Percent or More: 1970—Continued

[Excludes inmates of institutions, members of Armed Forces living in barracks, college students living in dormitories, and unrelated individuals under 14 years. Data based on 15-percent sample, see text. For minimum base for derived figures (percent, median, etc.) and meaning of symbols, see text.]

Miami	Neighborhood 04											
	All races	White	Negro	Persons of Spanish language	All races	White	Negro	Persons of Spanish language	All races	White	Negro	Persons of Spanish language
PERSONS 16 TO 21 YEARS OLD NOT IN SCHOOL—Con.												
Income Below Poverty Level												
Male	61	61	—	28								
Not high school graduate	38	38	—	13								
Employed or in Armed Forces	6	6	—	6								
Unemployed	—	—	—	—								
Not in labor force	32	32	—	7								
High school graduate	23	23	—	15								
Employed or in Armed Forces	—	—	—	—								
Unemployed	—	—	—	—								
Not in labor force	23	23	—	15								
Female	101	101	—	87								
Not high school graduate	54	54	—	40								
Employed or in Armed Forces	5	5	—	5								
Unemployed	7	7	—	7								
Not in labor force	42	42	—	28								
High school graduate	47	47	—	47								
Employed or in Armed Forces	8	8	—	8								
Unemployed	—	—	—	—								
Not in labor force	39	39	—	39								
MARRIED COUPLES AND CHILDREN												
All Income Levels												
Married couples	7 076	6 965	43	6 026								
With own household	6 669	6 558	43	5 643								
Without own household	407	407	—	383								
With own children under 18 yr	3 070	3 020	17	2 910								
With own children under 6 yr	1 187	1 160	—	1 130								
With husband under 45 years	2 725	2 681	17	2 566								
With own children under 18 yr	2 016	1 972	17	1 922								
Related child, under 18 yr	6 491	6 407	17	6 099								
Living with both parents	5 008	4 942	17	4 727								
Percent living with both parents	77.2	77.1	...	77.5								
Living with mother only	883	878	—	835								
Living with father only	207	207	—	180								
Living with neither parent	393	380	—	357								
Income Below Poverty Level												
Related child, under 18 yr	1 941	1 905	—	1 901								
Living with both parents	1 358	1 340	—	1 335								
Percent living with both parents	70.0	70.3	—	70.2								
Living with mother only	395	390	—	385								
Living with father only	45	45	—	38								
Living with neither parent	143	130	—	143								
FERTILITY BY AGE OF WOMAN												
All Income Levels												
Women ever married:												
15 to 24 years	583	579	4	503								
25 to 34 years	1 483	1 463	5	1 405								
35 to 44 years	2 244	2 210	17	2 040								
Children ever born per 1,000 women ever married:												
15 to 24 years	496	492	...	513								
25 to 34 years	1 493	1 498	—	1 516								
35 to 44 years	1 681	1 680	...	1 673								
Income Below Poverty Level												
Women ever married:												
15 to 24 years	79	79	—	62								
25 to 34 years	398	385	5	394								
35 to 44 years	448	443	—	409								
Children ever born per 1,000 women ever married:												
15 to 24 years	—	...								
25 to 34 years	1 899	1 922	—	1 898								
35 to 44 years	2 462	2 467	—	2 521								

Table A-3. Employment Characteristics of the Population by Residence in Census Tracts With a Poverty Rate of 20 Percent or More: 1970

[Excludes inmates of institutions, members of Armed Forces living in barracks, college students living in dormitories, and unrelated individuals under 14 years. Data based on 15-percent sample, see text. For minimum base for derived figures (percent, median, etc.) and meaning of symbols, see text]

Miami	Neighborhood 04											
	All races	White	Negro	Persons of Spanish language	All races	White	Negro	Persons of Spanish language	All races	White	Negro	Persons of Spanish language
EMPLOYMENT STATUS												
All Income Levels												
Male												
Total, 16 years old and over	10 977	10 827	55	8 751								
Armed Forces	-	-	-	-								
Civilian labor force	8 274	8 156	43	7 079								
Employed	8 003	7 898	30	6 837								
At work	7 803	7 716	30	6 709								
Full time	6 830	6 748	30	5 930								
With a job but not at work	200	182	-	128								
Unemployed	271	258	13	242								
Percent unemployed	3.3	3.2	...	3.4								
Not in labor force	2 703	2 671	12	1 672								
Enrolled in school	409	403	-	336								
Other	2 294	2 268	12	1 336								
65 years old and over	1 322	1 311	6	678								
16 to 24 years old ¹	1 418	1 407	-	1 212								
Employed	888	883	-	804								
Unemployed	26	26	-	26								
Not in labor force	504	498	-	382								
25 to 64 years old ¹	7 724	7 603	49	6 489								
Employed	6 649	6 556	30	5 694								
Unemployed	201	188	13	186								
Not in labor force	874	859	6	609								
Family head, 25 to 64 years old ¹	5 678	5 574	43	5 068								
Employed	5 130	5 048	30	4 615								
Unemployed	160	147	13	154								
Not in labor force	388	379	-	299								
Female												
Total, 16 years old and over	13 717	13 505	117	11 103								
Civilian labor force	6 509	6 396	92	5 575								
Employed	6 127	6 023	83	5 231								
At work	5 987	5 883	83	5 114								
Full time	4 847	4 747	79	4 212								
With a job but not at work	140	140	-	344								
Unemployed	382	373	9	62								
Percent unemployed	5.9	5.8	...	5.28								
Not in civilian labor force	7 208	7 109	25	5 528								
Enrolled in school	452	452	-	411								
Other	6 756	6 657	25	5 117								
65 years old and over	2 272	2 248	-	1 307								
With own children under 6 years old	1 362	1 335	-	1 293								
Percent in civilian labor force	46.3	47.3	-	47.6								
With own children 6 to 17 years old	2 892	2 852	30	2 735								
Percent in civilian labor force	58.2	58.0	...	59.7								
16 to 24 years old ¹	1 679	1 667	12	1 522								
Employed	924	912	12	849								
Unemployed	21	21	-	21								
Not in civilian labor force	734	734	-	652								
25 to 64 years old ¹	9 498	9 322	105	8 187								
Employed	4 976	4 884	71	4 298								
Unemployed	335	326	9	323								
Not in civilian labor force	4 187	4 112	25	3 566								
Family head, 25 to 64 years old ¹	979	952	15	893								
Employed	676	661	15	608								
Unemployed	54	54	-	49								
Not in civilian labor force	249	237	-	236								
Wife of head, 25 to 64 years old ¹	5 447	5 360	47	4 844								
Employed	2 629	2 588	34	2 403								
Unemployed	184	184	-	184								
Not in civilian labor force	2 634	2 588	13	2 257								
Income Below Poverty Level												
Male												
Total, 16 years old and over	2 196	2 155	13	1 732								
Armed Forces	-	-	-	-								
Civilian labor force	1 098	1 071	13	1 007								
Employed	1 039	1 025	-	948								
At work	1 013	1 006	-	934								
Full time	772	765	-	720								
Unemployed	59	46	13	59								
Percent unemployed	5.4	4.3	...	5.9								
Not in labor force	1 098	1 084	-	725								
Enrolled in school	65	65	-	58								
Other	1 033	1 019	-	667								
65 years old and over	543	538	-	334								

¹Includes members of Armed Forces not living in barracks and not shown separately.

Table A-3. Employment Characteristics of the Population by Residence in Census Tracts With a Poverty Rate of 20 Percent or More: 1970—Continued

[Excludes inmates of institutions, members of Armed Forces living in barracks, college students living in dormitories, and unrelated individuals under 14 years. Data based on 15-percent sample, see text. For minimum base for derived figures (percent, median, etc.) and meaning of symbols, see text]

Miami	Neighborhood 04											
	All races	White	Negro	Persons of Spanish language	All races	White	Negro	Persons of Spanish language	All races	White	Negro	Persons of Spanish language
EMPLOYMENT STATUS—Continued												
Income Below Poverty Level—Con.												
Male—Continued												
16 to 24 years old ¹	212	212	—	162								
Employed	74	74	—	74								
Unemployed	—	—	—	—								
Not in labor force	138	138	—	88								
25 to 64 years old ¹	1 395	1 359	13	1 196								
Employed	932	918	—	847								
Unemployed	46	33	13	46								
Not in labor force	417	408	—	303								
Family head, 25 to 64 years old ¹ ..	914	878	13	856								
Employed	720	706	—	683								
Unemployed	46	33	13	46								
Not in labor force	148	139	—	127								
Female												
Total, 16 years old and over	3 471	3 382	53	2 719								
Civilian labor force	859	812	47	773								
Employed	750	712	38	676								
At work	722	684	38	653								
Full time	591	553	38	539								
With a job but not at work	28	28	—	23								
Unemployed	109	100	9	97								
Percent unemployed	12.7	12.3	...	12.5								
Not in civilian labor force	2 612	2 570	6	1 946								
Enrolled in school	92	92	—	86								
Other	2 520	2 478	6	1 860								
65 years old and over	1 101	1 090	—	615								
With own children under 6 years old ..	407	399	—	396								
Percent in civilian labor force	36.6	37.3	—	36.6								
With own children 6 to 17 years old ..	709	691	13	693								
Percent in civilian labor force	45.7	45.0	...	46.2								
16 to 24 years old	249	241	8	196								
Employed	58	50	8	46								
Unemployed	7	7	—	7								
Not in civilian labor force	184	184	—	143								
25 to 64 years old	2 077	2 007	45	1 897								
Employed	654	624	30	619								
Unemployed	102	93	9	90								
Not in civilian labor force	1 321	1 290	6	1 188								
Family head, 25 to 64 years old	325	300	13	316								
Employed	193	180	13	189								
Unemployed	11	11	—	6								
Not in civilian labor force	121	109	—	121								
Wife of head, 25 to 64 years old	940	915	17	909								
Employed	256	239	17	244								
Unemployed	47	47	—	47								
Not in civilian labor force	637	629	—	618								
PLACE OF WORK												
All workers ²	13 831	13 640	113	11 864								
Inside SMSA of residence	12 112	11 944	104	10 770								
In county of residence	12 112	11 944	104	10 770								
In central city	6 695	6 608	57	5 767								
Outside county of residence	—	—	—	—								
In central city	—	—	—	—								
Outside SMSA of residence	376	369	—	335								
Workers below poverty level ²	1 750	1 705	38	1 602								
Inside SMSA of residence	1 498	1 453	38	1 408								
In county of residence	1 498	1 453	38	1 408								
In central city	886	868	18	830								
Outside county of residence	—	—	—	—								
In central city	—	—	—	—								
Outside SMSA of residence	28	28	—	20								
MEANS OF TRANSPORTATION TO WORK												
All workers	13 831	13 640	113	11 864								
Private automobile, driver	7 197	7 111	44	6 151								
Private automobile, passenger	2 832	2 795	37	2 610								
Bus, streetcar, or subway	2 608	2 557	22	2 199								
Walked only	799	787	5	611								
Worked at home	169	169	—	101								
Other means	226	221	5	192								
Workers below poverty level	1 750	1 705	38	1 602								
Private automobile, driver	717	689	21	653								
Private automobile, passenger	320	308	12	308								
Bus, streetcar, or subway	452	452	—	416								
Walked only	214	209	5	185								
Worked at home	15	15	—	8								
Other means	32	32	—	32								

¹Includes members of Armed Forces not living in barracks and not shown separately. ²Includes "Place of work not reported" not shown separately.

Table A-4. Selected Occupations of Employed Persons by Residence in Census Tracts With a Poverty Rate of 20 Percent or More: 1970

(Excludes inmates of institutions, members of Armed Forces living in barracks, college students living in dormitories, and unrelated individuals under 14 years. Data based on 15-percent sample, see text. For minimum base for derived figures (percent, median, etc.) and meaning of symbols, see text)

Miami

	Neighborhood 04				All races	White	Negro	Persons of Spanish language	All races	White	Negro	Persons of Spanish language
	All races	White	Negro	Persons of Spanish language								
ALL INCOME LEVELS												
Total employed, 16 yr. & over¹	14 130	13 921	113	12 068								
Prof., tech., and kindred workers	781	772	2	607								
Health workers, except practitioners	160	158	2	127								
Teachers, elem. and secondary	74	74	-	42								
Managers and admin., exc. farm	497	497	-	418								
Self-employed	109	109	-	89								
Sales workers	647	647	-	538								
Retail trade	489	489	-	414								
Clerical and kindred workers	2 111	2 084	21	1 541								
Postal clerks and mail carriers	22	22	-	-								
Shipping, receiving, and stock clerks	269	261	8	225								
Bkksprs., cashiers, & bank tellers	459	453	-	364								
Craftsmen and kindred workers	1 949	1 913	5	1 678								
Construction craftsmen	637	630	-	573								
Mechanics and repairmen	395	383	-	338								
Operatives, except transport	4 228	4 192	22	4 032								
Assemblers	231	231	-	231								
Checkers, exam., & inspectors; mfg.	84	84	-	84								
Pkrs. & wrappers, inc. meat & prod.	339	339	-	339								
Sewers, stitchers, & textile oper.	1 215	1 196	5	1 194								
Transport equipment operatives	597	589	8	434								
Truck drivers	138	130	8	111								
Laborers, except farm	707	690	17	620								
Construction	207	207	-	207								
Freight, material, and stock handlers	128	111	17	122								
Service workers, exc. private hshld. ²	2 443	2 385	27	2 075								
Cleaning service workers	795	779	11	709								
Food service workers	966	940	-	866								
Health service workers	72	60	12	65								
Personal service workers	331	331	-	289								
Protective service workers	65	65	9	38								
Private household workers	63	54	9	51								
Female employed, 16 yr. & over¹	6 127	6 023	83	5 231								
Prof., tech., and kindred workers	276	274	2	192								
Health workers, except practitioners	95	93	2	70								
Teachers, elem. and secondary	33	33	-	13								
Managers and admin., exc. farm	154	154	-	120								
Self-employed	34	34	-	21								
Sales workers	264	264	-	200								
Retail trade	231	231	-	173								
Clerical and kindred workers	1 390	1 369	21	994								
Bkksprs., cashiers, & bank tellers	312	312	-	232								
Secretaries, steno., & typists	337	337	-	232								
Craftsmen and kindred workers	178	178	-	147								
Operatives, except transport	2 659	2 623	22	2 566								
Laundry & dry cleaning operatives ³	134	134	-	134								
Assemblers	51	51	-	51								
Pkrs. & wrappers, inc. meat & prod.	271	271	-	271								
Sewers, stitchers, & textile oper.	1 166	1 147	5	1 145								
Transport equipment operatives	7	7	-	7								
Laborers, except farm	59	59	-	51								
Service workers, exc. private hshld. ⁴	1 029	1 002	27	868								
Cleaning service workers	352	341	11	329								
Food service workers	257	257	-	199								
Health service workers	52	40	12	45								
Personal service workers	226	226	-	212								
Private household workers	63	54	9	51								
INCOME BELOW POVERTY LEVEL												
Total employed, 16 yr. & over¹	1 789	1 737	38	1 624								
Prof., tech., and kindred workers	57	57	-	30								
Managers and admin., exc. farm	27	27	-	19								
Sales workers	82	82	-	77								
Clerical and kindred workers	125	104	21	84								
Craftsmen and kindred workers	269	269	-	262								
Operatives, except transport	572	572	-	543								
Transport equipment operatives	57	57	-	57								
Laborers, except farm	188	188	-	175								
Service workers, exc. private hshld	391	360	17	356								
Private household workers	15	15	-	15								
Female employed, 16 yr. & over¹	750	712	38	676								
Prof., tech., and kindred workers	19	19	-	-								
Managers and admin., exc. farm	3	3	-	3								
Sales workers	40	40	-	35								
Clerical and kindred workers	87	66	21	65								
Craftsmen and kindred workers	-	-	-	-								
Operatives, except transport	355	355	-	345								
Transport equipment operatives	-	-	-	-								
Laborers, except farm	14	14	-	14								
Service workers, exc. private hshld	211	194	17	193								
Private household workers	15	15	-	15								

¹Includes "farm workers" not shown separately. ²Allocated cases included in total but not in distribution. ³Includes "clothing ironers and pressers." ⁴"Protective service workers" and allocated cases included in total but not in distribution.

Table A-5. Income Characteristics in 1969 of Families and Unrelated Individuals by Residence in Census Tracts With a Poverty Rate of 20 Percent or More: 1970

(Excludes inmates of institutions, members of Armed Forces living in barracks, college students living in dormitories, and unrelated individuals under 14 years. Data based on 15-percent sample, see text. For minimum base for derived figures (percent, median, etc.) and meaning of symbols, see text)

Miami	Neighborhood 04											
	All races	White	Negro	Persons of Spanish language	All races	White	Negro	Persons of Spanish language	All races	White	Negro	Persons of Spanish language
INCOME OF FAMILIES AND UNRELATED INDIVIDUALS												
All families	8 378	8 235	58	7 106								
Less than \$2,000	1 266	1 221	26	1 141								
\$2,000 to \$3,999	1 296	1 273	2	983								
\$4,000 to \$5,999	1 725	1 696	22	1 540								
\$6,000 to \$7,999	1 382	1 357	-	1 223								
\$8,000 to \$9,999	1 187	1 173	8	1 031								
\$10,000 to \$11,999	707	707	-	582								
\$12,000 to \$14,999	514	507	-	405								
\$15,000 to \$19,999	219	219	-	157								
\$20,000 to \$24,999	49	49	-	38								
\$25,000 or more	33	33	-	6								
Median family income	\$5 886	\$5 915	...	\$5 856								
Mean family income	\$6 488	\$6 526	...	\$6 261								
Families with female head	1 284	1 252	15	1 106								
Less than \$1,000	142	137	-	142								
\$1,000 to \$1,999	203	185	13	192								
\$2,000 to \$2,999	167	160	-	135								
\$3,000 to \$3,999	158	156	2	128								
\$4,000 to \$5,999	262	262	-	226								
\$6,000 to \$7,999	165	165	-	129								
\$8,000 to \$9,999	86	86	-	63								
\$10,000 to \$14,999	98	98	-	88								
\$15,000 and over	3	3	-	3								
Median family income	\$3 823	\$3 923	...	\$3 656								
Mean family income	\$4 397	\$4 469	...	\$4 248								
All unrelated individuals	3 646	3 580	49	1 705								
Less than \$1,000	961	945	11	540								
\$1,000 to \$1,999	655	639	16	245								
\$2,000 to \$2,999	526	521	5	284								
\$3,000 to \$3,999	548	530	6	292								
\$4,000 to \$5,999	475	464	11	211								
\$6,000 to \$7,999	269	269	-	94								
\$8,000 to \$9,999	113	113	-	24								
\$10,000 to \$14,999	76	76	-	15								
\$15,000 and over	23	23	-	-								
Median income	\$2 394	\$2 395	...	\$2 238								
Mean income	\$2 957	\$2 967	...	\$2 445								
TYPE OF INCOME FOR FAMILIES AND UNRELATED INDIVIDUALS												
All families	8 378	8 235	58	7 106								
With earnings	7 352	7 235	58	6 418								
Mean earnings	\$6 706	\$6 735	...	\$6 512								
Percent below poverty level	14.3	14.0	...	15.3								
Head 65 years and over	819	812	-	548								
Mean earnings	\$5 782	\$5 784	-	\$5 120								
With Social Security income	1 385	1 363	2	765								
Mean Social Security income	\$1 151	\$1 166	...	\$738								
Percent below poverty level	19.0	18.3	-	19.1								
Head 65 years and over	656	656	-	194								
Mean Social Security income	\$1 581	\$1 581	-	\$1 212								
With public assistance income	1 536	1 513	2	1 457								
Mean public assistance income	\$884	\$878	...	\$881								
Percent below poverty level	41.9	41.2	-	43.5								
Head 65 years and over	496	491	-	436								
Mean public assistance income	\$1 112	\$1 109	-	\$1 138								
With other income	1 497	1 485	-	864								
Mean other income	\$1 403	\$1 409	-	\$981								
Percent below poverty level	12.1	11.7	-	14.5								
Head 65 years and over	553	553	-	176								
Mean other income	\$2 039	\$2 039	-	\$1 403								
Families with female head	1 284	1 252	15	1 106								
With earnings	1 017	1 002	15	879								
Mean earnings	\$4 666	\$4 711	...	\$4 602								
Percent below poverty level	22.1	21.2	...	24.0								
Head 65 years and over	140	140	-	85								
Mean earnings	\$3 632	\$3 632	-	...								
With Social Security income	255	246	2	174								
Mean Social Security income	\$900	\$924	...	\$715								
Percent below poverty level	19.2	17.1	-	19.0								
Head 65 years and over	95	95	-	33								
Mean Social Security income	-	...								
With public assistance income	412	398	2	383								
Mean public assistance income	\$909	\$898	...	\$903								
Percent below poverty level	55.8	54.8	-	59.0								
Head 65 years and over	144	139	-	126								
Mean public assistance income	\$994	\$978	-	...								
With other income	239	232	-	164								
Mean other income	\$1 239	\$1 248	-	\$1 112								
Percent below poverty level	23.8	21.6	-	28.7								
Head 65 years and over	80	80	-	30								
Mean other income	-	...								

Table A-5. **Income Characteristics in 1969 of Families and Unrelated Individuals by Residence in Census Tracts With a Poverty Rate of 20 Percent or More: 1970—Continued**

(Excludes inmates of institutions, members of Armed Forces living in barracks, college students living in dormitories, and unrelated individuals under 14 years. Data based on 15-percent sample, see text. For minimum base for derived figures (percent, median, etc.) and meaning of symbols, see text)

Miami	Neighborhood 04											
	All races	White	Negro	Persons of Spanish language	All races	White	Negro	Persons of Spanish language	All races	White	Negro	Persons of Spanish language
TYPE OF INCOME FOR FAMILIES AND UNRELATED INDIVIDUALS — Continued												
All unrelated individuals	3 646	3 580	49	1 705								
With earnings	2 045	2 004	29	1 081								
Mean earnings	\$3 846	\$3 854	...	\$3 324								
Percent below poverty level	13.8	13.9	...	17.0								
65 years and over	269	269	—	57								
Mean earnings	\$2 798	\$2 798	—	...								
Percent below poverty level	14.9	14.9	—	...								
With Social Security income	1 071	1 066	—	193								
Mean Social Security income	\$981	\$982	—	\$858								
Percent below poverty level	53.3	53.1	—	56.0								
65 years and over	765	760	—	85								
Mean Social Security income	\$1 038	\$1 039	—	...								
With public assistance income	427	421	6	275								
Mean public assistance income	\$576	\$574	...	\$607								
Percent below poverty level	77.0	76.7	...	83.6								
65 years old and over	221	221	—	124								
Mean public assistance income	\$607	\$607	—	...								
With other income	920	908	12	203								
Mean other income	\$1 762	\$1 772	...	\$1 194								
Percent below poverty level	24.0	23.0	...	36.9								
65 years old and over	457	457	—	70								
Mean other income	\$1 595	\$1 595	—	...								
WEEKS WORKED												
All Income Levels												
Male family heads	7 094	6 983	43	6 000								
Worked in 1969	5 943	5 854	30	5 263								
50 to 52 weeks	3 481	3 447	8	3 095								
40 to 49 weeks	1 185	1 159	5	1 008								
27 to 39 weeks	449	425	17	414								
26 weeks or less	828	823	—	746								
Did not work in 1969	1 151	1 129	13	737								
Female family heads	1 284	1 252	15	1 106								
Worked in 1969	819	804	15	717								
50 to 52 weeks	397	397	—	347								
40 to 49 weeks	183	170	13	163								
27 to 39 weeks	81	81	—	60								
26 weeks or less	158	156	2	147								
Did not work in 1969	465	448	—	389								
Income Below Poverty Level												
Male family heads	1 332	1 296	13	1 180								
Worked in 1969	778	764	—	727								
50 to 52 weeks	186	186	—	156								
Did not work in 1969	554	532	13	453								
Female family heads	463	433	13	438								
Worked in 1969	178	165	13	169								
50 to 52 weeks	55	55	—	55								
Did not work in 1969	285	268	—	269								
FAMILIES BY NUMBER OF EARNERS												
No earners	1 026	1 000	—	688								
Mean family income	\$1 922	\$1 938	—	\$965								
Percent below poverty level	72.3	71.6	—	92.6								
1 earner	2 808	2 742	31	2 285								
Mean family income	\$5 082	\$5 127	...	\$4 398								
Percent below poverty level	26.6	25.8	...	30.0								
2 earners	3 470	3 426	25	3 130								
Mean family income	\$7 463	\$7 463	...	\$7 214								
Percent below poverty level	8.0	8.1	—	8.5								
3 or more earners	1 074	1 067	2	1 003								
Mean family income	\$11 373	\$11 412	...	\$11 155								
Percent below poverty level	2.8	2.8	—	3.0								
SIZE OF FAMILY												
2 persons	3 279	3 203	39	2 384								
Mean family income	\$5 354	\$5 393	...	\$4 754								
Percent below poverty level	24.4	23.5	...	28.5								
3 persons	2 231	2 200	19	2 032								
Mean family income	\$6 647	\$6 680	...	\$6 368								
Percent below poverty level	15.5	15.5	—	15.7								
4 persons	1 610	1 586	—	1 508								
Mean family income	\$7 281	\$7 325	...	\$7 075								
Percent below poverty level	17.1	16.6	—	17.8								
5 and 6 persons	1 051	1 039	—	1 020								
Mean family income	\$7 786	\$7 788	...	\$7 699								
Percent below poverty level	28.6	29.0	—	29.5								
7 persons or more	207	207	—	162								
Mean family income	\$9 973	\$9 973	...	\$10 452								
Percent below poverty level	34.8	34.8	—	30.9								

Table A-6. Persons by Family Status and Age and Families by Income Deficit by Residence in Census Tracts With a Poverty Rate of 20 Percent or More: 1970

[Excludes inmates of institutions, members of Armed Forces living in barracks, college students living in dormitories, and unrelated individuals under 14 years. Data based on 15 percent sample, see text. For minimum base for derived figures (percent, median, etc.) and meaning of symbols, see text]

Miami	Neighborhood 04											
	All races	White	Negro	Persons of Spanish language	All races	White	Negro	Persons of Spanish language	All races	White	Negro	Persons of Spanish language
ALL INCOME LEVELS												
All Persons												
Total	30 379	29 938	189	25 226								
In families	26 733	26 358	140	23 521								
Head	8 378	8 235	58	7 106								
With related children under 18	3 923	3 850	30	3 681								
Mean number of related children under 18	1.65	1.65	...	1.65								
With related children under 6	1 414	1 387	-	1 349								
14 to 24 years	261	261	-	243								
25 to 54 years	4 916	4 832	40	4 570								
55 to 64 years	1 741	1 694	18	1 391								
65 years and over	1 460	1 448	-	902								
Wife of head	6 566	6 466	47	5 586								
14 to 24 years	412	412	-	371								
25 to 54 years	4 236	4 160	42	3 846								
55 to 64 years	1 211	1 200	5	998								
65 years and over	707	694	-	371								
Other family members	11 789	11 657	35	10 829								
Under 3 years	744	712	-	707								
3 to 5 years	940	932	-	904								
6 to 13 years	3 106	3 072	17	2 949								
14 to 17 years	1 701	1 691	-	1 539								
18 to 21 years	995	989	-	922								
22 to 54 years	2 418	2 399	6	2 140								
55 to 64 years	851	840	6	790								
65 years and over	1 034	1 022	6	878								
Mean size of family	3.19	3.20	...	3.31								
Unrelated individuals	3 646	3 580	49	1 705								
14 to 24 years	226	218	8	118								
25 to 54 years	1 454	1 417	25	898								
55 to 64 years	792	776	16	396								
65 years and over	1 174	1 169	-	293								
Persons in Families With Female Head and Female Unrelated Individuals												
Total	5 651	5 547	64	4 105								
In families	3 535	3 481	21	3 115								
Head	1 284	1 252	15	1 106								
With related children under 18	590	567	13	532								
Mean number of related children under 18	1.48	1.49	...	1.50								
With related children under 6	137	137	-	129								
14 to 24 years	34	34	-	24								
25 to 54 years	711	691	15	648								
55 to 64 years	268	261	-	245								
65 years and over	271	266	-	189								
Other family members	2 251	2 229	6	2 009								
Under 3 years	74	74	-	74								
3 to 5 years	96	96	-	81								
6 to 13 years	390	385	-	361								
14 to 17 years	344	344	-	311								
18 to 21 years	192	192	-	184								
22 to 54 years	690	684	6	600								
55 to 64 years	199	194	-	188								
65 years and over	266	260	-	210								
Mean size of family	2.75	2.78	...	2.82								
Female unrelated individuals	2 116	2 066	43	990								
14 to 24 years	83	75	8	42								
25 to 54 years	730	704	19	483								
55 to 64 years	490	474	16	261								
65 years and over	813	813	-	204								

Table A-6. Persons by Family Status and Age and Families by Income Deficit by Residence in Census Tracts With a Poverty Rate of 20 Percent or More: 1970—Continued

[Excludes inmates of institutions, members of Armed Forces living in barracks, college students living in dormitories, and unrelated individuals under 14 years. Data based on 15-percent sample, see text. For minimum base for derived figures (percent, median, etc.) and meaning of symbols, see text.]

Miami

	Neighborhood 04				All races	White	Negro	Persons of Spanish language	All races	White	Negro	Persons of Spanish language
	All races	White	Negro	Persons of Spanish language								
INCOME BELOW POVERTY LEVEL												
All Persons												
Total	7 503	7 337	66	6 247								
Percent below poverty level	24.7	24.5	34.9	24.8								
In families	5 975	5 837	43	5 498								
Head	1 795	1 729	26	1 618								
Percent below poverty level	21.4	21.0	...	22.8								
With related children under 18	954	924	13	924								
Mean number of related children under 18	1.96	1.98	...	1.96								
With related children under 6	410	403	—	399								
14 to 24 years	39	39	—	39								
25 to 54 years	951	926	13	913								
55 to 64 years	288	252	13	259								
65 years and over	517	512	—	407								
Wife of head	1 254	1 229	17	1 128								
14 to 24 years	55	55	—	48								
25 to 54 years	719	694	17	695								
55 to 64 years	221	221	—	214								
65 years and over	259	259	—	171								
Other family members	2 926	2 879	—	2 752								
Under 3 years	253	237	—	253								
3 to 5 years	305	297	—	300								
6 to 13 years	1 023	1 011	—	988								
14 to 17 years	360	360	—	360								
18 to 21 years	126	126	—	89								
22 to 54 years	423	423	—	372								
55 to 64 years	185	180	—	185								
65 years and over	251	245	—	205								
Mean size of family	3.33	3.38	...	3.40								
Unrelated individuals	1 528	1 500	23	749								
Percent below poverty level	41.9	41.9	...	43.9								
14 to 24 years	136	128	8	77								
25 to 54 years	369	360	9	254								
55 to 64 years	316	310	6	201								
65 years and over	707	702	—	217								
Persons in Families With Female Head and Female Unrelated Individuals												
Total	2 283	2 214	36	1 708								
Percent below poverty level	40.4	39.9	...	41.6								
In families	1 259	1 213	13	1 203								
Head	463	433	13	438								
Percent below poverty level	36.1	34.6	...	39.6								
With related children under 18	237	214	13	233								
Mean number of related children under 18	1.64	1.69	...	1.64								
With related children under 6	69	69	—	65								
14 to 24 years	—	—	—	—								
25 to 54 years	234	216	13	230								
55 to 64 years	91	84	—	86								
65 years and over	138	133	—	122								
Other family members	796	780	—	765								
Under 3 years	46	46	—	46								
3 to 5 years	40	40	—	35								
6 to 13 years	180	175	—	175								
14 to 17 years	126	126	—	126								
18 to 21 years	43	43	—	43								
22 to 54 years	176	176	—	164								
55 to 64 years	90	85	—	90								
65 years and over	95	89	—	86								
Mean size of family	2.72	2.80	...	2.75								
Female unrelated individuals	1 024	1 001	23	505								
Percent below poverty level	48.4	48.5	...	51.0								
14 to 24 years	54	46	8	22								
25 to 54 years	198	189	9	152								
55 to 64 years	224	218	6	158								
65 years and over	548	548	—	173								

Table A-6. Persons by Family Status and Age and Families by Income Deficit by Residence in Census Tracts With a Poverty Rate of 20 Percent or More: 1970—Continued

[Excludes inmates of institutions, members of Armed Forces living in barracks, college students living in dormitories, and unrelated individuals under 14 years. Data based on 15-percent sample, see text. For minimum base for derived figures (percent, median, etc.) and meaning of symbols, see text]

Miami	Neighborhood 04											
	All races	White	Negro	Persons of Spanish language	All races	White	Negro	Persons of Spanish language	All races	White	Negro	Persons of Spanish language
RATIO OF INCOME TO POVERTY LEVEL												
Families												
Percent with income:												
Less than .50 of poverty level	10.2	10.1	...	11.3								
.50 to .74	6.0	5.8	...	6.2								
.75 to .99	5.2	5.1	—	5.2								
1.00 to 1.24	7.6	7.7	—	7.1								
1.25 to 1.49	7.0	7.0	...	7.7								
1.50 to 1.99	16.2	16.0	...	16.2								
2.00 to 2.99	27.0	27.3	—	28.2								
3.00 or more	20.8	20.9	...	18.1								
Unrelated Individuals												
Percent with income:												
Less than .50 of poverty level	25.5	25.5	...	31.7								
.50 to .74	9.4	9.4	...	6.9								
.75 to .99	7.0	7.0	...	5.4								
1.00 to 1.24	7.5	7.4	...	8.6								
1.25 to 1.49	7.9	8.0	—	7.9								
1.50 to 1.99	13.4	13.3	...	17.7								
2.00 to 2.99	14.7	14.6	...	13.3								
3.00 or more	14.6	14.7	...	8.5								
DIFFERENCE BETWEEN FAMILY INCOME AND POVERTY LEVEL												
Families below poverty level												
\$1 to \$249	1 795	1 729	26	1 618								
\$250 to \$499	140	126	—	127								
\$500 to \$999	199	192	—	151								
\$1,000 to \$1,999	314	301	13	269								
\$2,000 and over	470	461	—	434								
Median income deficit	672	649	13	637								
Mean income deficit	\$1 520	\$1 533	...	\$1 604								
	\$1 671	\$1 687	...	\$1 704								
Families above poverty level												
\$0 to \$249	6 583	6 506	32	5 488								
\$250 to \$499	138	138	—	103								
\$500 to \$999	236	236	—	183								
\$1,000 to \$1,999	449	447	2	381								
\$2,000 and over	920	897	17	782								
Median income surplus	4 840	4 788	13	4 039								
Mean income surplus	\$4 669	\$4 683	...	\$4 394								

Table A-7. Selected Housing Characteristics of Housing Units by Location in Census Tracts With a Poverty Rate of 20 Percent or More: 1970

[Excludes inmates of institutions, members of Armed Forces living in barracks, college students living in dormitories, and unrelated individuals under 14 years. Data based on 15-percent sample, see text. For minimum base for derived figures (percent, median, etc.) and meaning of symbols, see text]

Miami

	Neighborhood 04				All races	White	Negro	Persons of Spanish language	All races	White	Negro	Persons of Spanish language
	All races	White	Negro	Persons of Spanish language								
TENURE AND VACANCY STATUS												
Total, all units.....	11 148	10 761	65	8 210								
Occupied.....	10 928	10 761	65	8 210								
Population in units.....	29 940	29 516	117	25 013								
Population per unit.....	2.74	2.74	...	3.05								
Owner occupied.....	1 566	1 560	—	552								
Population per unit.....	2.82	2.81	—	4.03								
1-person households.....	371	371	—	47								
65 years and over.....	224	224	—	12								
Renter occupied.....	9 362	9 201	65	7 658								
Population per unit.....	2.73	2.73	...	2.98								
1-person households.....	1 958	1 917	26	954								
65 years and over.....	739	732	—	224								
Available vacant year-round.....	174	—	—	—								
For rent.....	168	—	—	—								
For sale only.....	6	—	—	—								
Other vacant.....	46	—	—	—								
YEAR STRUCTURE BUILT												
Owner occupied.....	1 566	1 560	—	552								
1960 to March 1970.....	62	56	—	39								
1950 to 1959.....	234	234	—	129								
1940 to 1949.....	361	361	—	140								
1939 or earlier.....	909	909	—	244								
Renter occupied.....	9 362	9 201	65	7 658								
1960 to March 1970.....	1 703	1 661	13	1 482								
1950 to 1959.....	1 671	1 628	6	1 322								
1940 to 1949.....	1 912	1 884	12	1 593								
1939 or earlier.....	4 076	4 028	34	3 261								
Owner occ. below poverty level.....	300	300	—	67								
1960 to March 1970.....	12	12	—	6								
1950 to 1959.....	17	17	—	6								
1940 to 1949.....	51	51	—	11								
1939 or earlier.....	220	220	—	44								
Renter occ. below poverty level.....	2 527	2 448	32	2 003								
1960 to March 1970.....	343	330	13	284								
1950 to 1959.....	425	396	6	328								
1940 to 1949.....	555	538	6	458								
1939 or earlier.....	1 204	1 184	13	933								
UNITS IN STRUCTURE												
All occupied units.....	10 928	10 761	65	8 210								
1.....	2 453	2 413	13	1 503								
2 to 4.....	2 015	2 002	6	1 431								
5 to 9.....	2 030	1 984	7	1 710								
10 to 49.....	4 140	4 080	39	3 333								
50 or more.....	279	271	—	228								
Mobile home or trailer.....	11	11	—	5								
YEAR HEAD MOVED INTO UNIT												
All occupied units.....	10 928	10 761	65	8 210								
1968 to March 1970.....	5 428	5 356	40	4 803								
1965 to 1967.....	2 995	2 917	13	2 433								
1960 to 1964.....	1 192	1 180	12	750								
1959 or earlier.....	1 313	1 308	—	224								
Occ. units below poverty level.....	2 827	2 748	32	2 070								
1968 to March 1970.....	1 588	1 550	13	1 399								
1965 to 1967.....	620	585	13	472								
1960 to 1964.....	318	312	6	155								
1959 or earlier.....	301	301	—	44								
SELECTED EQUIPMENT												
All occupied units.....	10 928	10 761	65	8 210								
Percent with air conditioning.....	50.4	50.3	...	52.4								
Percent with automobile.....	63.6	63.7	...	67.4								
Percent with telephone.....	72.5	72.5	...	72.6								
Percent with all plumbing facilities.....	95.6	95.6	...	95.5								
Occ. units below poverty level.....	2 827	2 748	32	2 070								
Percent with air conditioning.....	29.8	29.3	...	30.8								
Percent with automobile.....	35.6	35.4	...	39.2								
Percent with telephone.....	60.5	60.6	...	58.3								
Percent with all plumbing facilities.....	94.4	94.5	...	94.2								
PERSONS PER ROOM												
Owner occupied.....	1 566	1 560	—	552								
1.00 or fewer persons per room.....	1 347	1 341	—	381								
1.01 to 1.50 persons per room.....	122	122	—	87								
1.51 or more persons per room.....	97	97	—	84								
Owner occ. below poverty level.....	300	300	—	67								
1.00 or fewer persons per room.....	271	271	—	52								
1.01 to 1.50 persons per room.....	13	13	—	6								
1.51 or more persons per room.....	16	16	—	9								

Table A-7. Selected Housing Characteristics of Housing Units by Location in Census Tracts With a Poverty Rate of 20 Percent or More: 1970—Continued

[Excludes inmates of institutions, members of Armed Forces living in barracks, college students living in dormitories, and unrelated individuals under 14 years. Data based on 15-percent sample, see text. For minimum base for derived figures (percent, median, etc.) and meaning of symbols, see text]

Miami	Neighborhood 04											
	All races	White	Negro	Persons of Spanish language	All races	White	Negro	Persons of Spanish language	All races	White	Negro	Persons of Spanish language
PERSONS PER ROOM—Con.												
Renter occupied.....	9 362	9 201	65	7 658								
1.00 or fewer persons per room.....	5 913	5 806	65	4 364								
1.01 to 1.50 persons per room.....	1 199	1 194	—	1 156								
1.51 or more persons per room.....	2 250	2 201	—	2 138								
Renter occ. below poverty level.....	2 327	2 448	32	2 003								
1.00 or fewer persons per room.....	1 558	1 506	32	1 067								
1.01 to 1.50 persons per room.....	306	301	—	293								
1.51 or more persons per room.....	663	641	—	643								
VALUE OF PROPERTY												
Specified owner occupied ¹	1 037	1 031	—	355								
Less than \$5,000.....	6	6	—	—								
\$5,000 to \$9,999.....	149	149	—	30								
\$10,000 to \$12,499.....	133	133	—	68								
\$12,500 to \$14,999.....	195	195	—	50								
\$15,000 to \$17,499.....	178	178	—	64								
\$17,500 to \$19,999.....	143	143	—	53								
\$20,000 to \$24,999.....	127	127	—	57								
\$25,000 to \$34,999.....	77	77	—	27								
\$35,000 or more.....	29	23	—	6								
Median value of property.....	\$15 500	\$15 500	—	\$16 200								
Mean value of property.....	\$16 800	\$16 600	—	\$17 000								
Specified owner occupied below poverty level ¹	200	200	—	44								
Less than \$5,000.....	—	—	—	—								
\$5,000 to \$9,999.....	36	36	—	5								
\$10,000 to \$12,499.....	46	46	—	11								
\$12,500 to \$14,999.....	65	65	—	13								
\$15,000 to \$17,499.....	38	38	—	5								
\$17,500 to \$19,999.....	15	15	—	10								
\$20,000 to \$24,999.....	—	—	—	—								
\$25,000 or more.....	—	—	—	—								
Median value of property.....	\$13 200	\$13 200	—	...								
Mean value of property.....	\$13 100	\$13 100	—	...								
GROSS RENT												
Specified renter occupied ²	9 317	9 156	65	7 621								
Less than \$40.....	168	168	—	50								
\$40 to \$59.....	397	383	7	252								
\$60 to \$79.....	1 361	1 341	13	961								
\$80 to \$99.....	2 015	1 974	20	1 575								
\$100 to \$119.....	1 881	1 850	12	1 587								
\$120 to \$149.....	1 622	1 589	13	1 459								
\$150 to \$199.....	1 581	1 559	—	1 501								
\$200 to \$249.....	141	141	—	125								
\$250 or more.....	20	20	—	20								
No cash rent.....	131	131	—	91								
Median gross rent.....	\$107	\$107	...	\$112								
Mean gross rent.....	\$112	\$112	...	\$117								
Specified renter occupied below poverty level ²	2 511	2 432	32	1 995								
Less than \$40.....	124	124	—	28								
\$40 to \$59.....	187	173	7	107								
\$60 to \$79.....	541	521	13	421								
\$80 to \$99.....	595	576	6	465								
\$100 to \$119.....	384	377	—	339								
\$120 to \$149.....	342	330	6	310								
\$150 to \$199.....	268	261	—	261								
\$200 to \$249.....	29	29	—	29								
\$250 or more.....	7	7	—	7								
Median gross rent.....	\$93	\$93	...	\$98								
Mean gross rent.....	\$99	\$99	...	\$106								
GROSS RENT AS PERCENTAGE OF INCOME BY POVERTY STATUS IN 1969												
Specified renter occupied ³	8 837	8 688	58	7 215								
Less than 20 percent.....	2 649	2 631	6	2 240								
20 to 24 percent.....	1 463	1 442	14	1 167								
25 to 34 percent.....	1 776	1 732	7	1 486								
35 to 49 percent.....	1 041	1 021	13	804								
50 percent or more.....	1 908	1 862	18	1 518								
Specified renter occupied below poverty level ³	2 128	2 061	25	1 652								
Less than 20 percent.....	16	16	—	16								
20 to 24 percent.....	22	22	—	7								
25 to 34 percent.....	110	103	—	64								
35 to 49 percent.....	307	293	7	244								
50 percent or more.....	1 673	1 627	18	1 321								

¹Limited to one-family homes on less than 10 acres and no business on property. Cooperatives, condominiums, mobile homes, and trailers are excluded. ²Excludes one-family homes on 10 acres or more. Specified renter occupied units below poverty level include "no cash rent" units not shown separately. ³Excludes one-family homes on 10 acres or more, all "no cash rent" units, and units for which the income of the family or primary individual was reported as "none" or "loss."